

GROUND FOR FOUNDATION

720 SQUARE FEET

FROM MY HOUSE TO THE CROSSING STREAM MEASURES 160 FEET AWAY

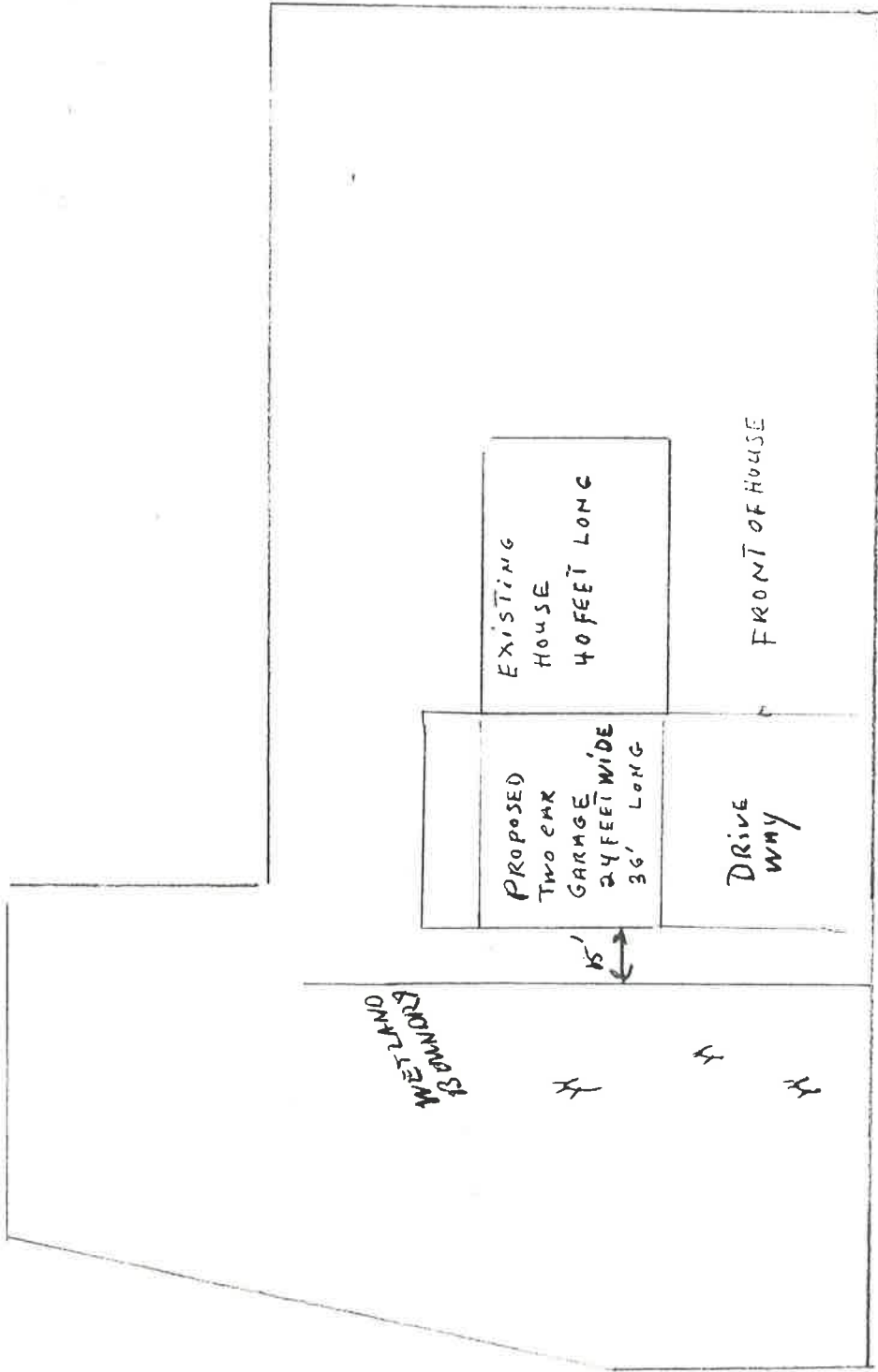

TOTAL GROUND SPACE

32,790 SQUARE FEET

69-142

ABOUT 20 FEET FROM MY PROPERTY LINE

WHILE STREAM GOING BY