

**BENCHMARK**  
 TOP WELL HEAD IN FRONT OF  
 HOUSE #99 WILLARD AVENUE,  
 CO. & MATHEWS BACK OF POLE # 536  
 WEST SIDE OF MILLER STREET.  
 DATUM 1929 ELEV. 48.055

**BENCHMARK**  
 TOP BOLT IN HYDRANT BETWEEN  
 CO. & MATHEWS BACK OF POLE # 536  
 WEST SIDE OF MILLER STREET.  
 DATUM 1929 ELEV. 52.243

**NOTE: SECTION II AMENDED**  
 WETLAND FILL / CUT AREA = 3,722 SF.  
 VOLUME OF FILL IN THE WETLAND = 196 CU. YDS.  
 VOLUME OF CUT IN THE WETLAND = 97 CU. YDS.

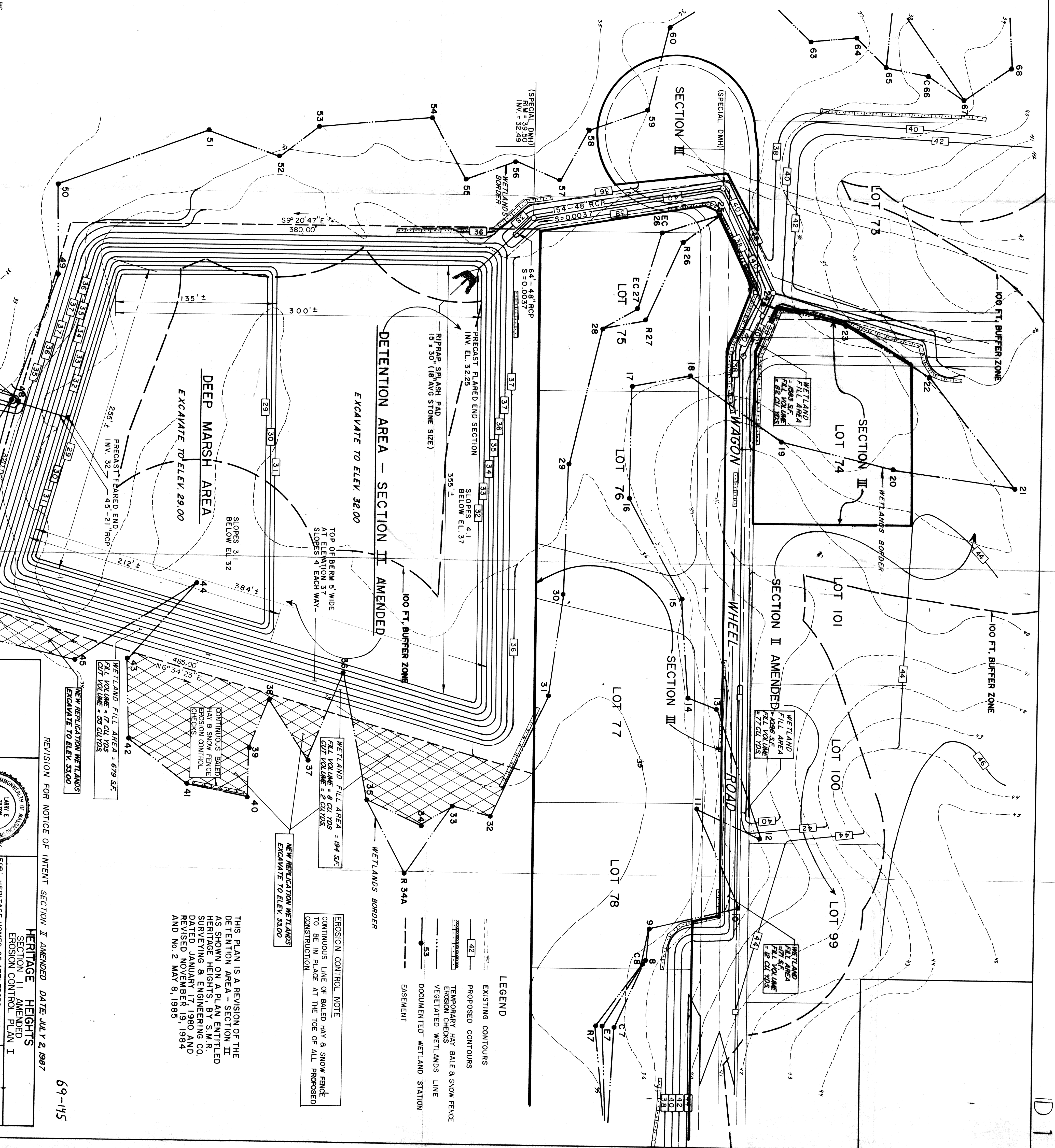
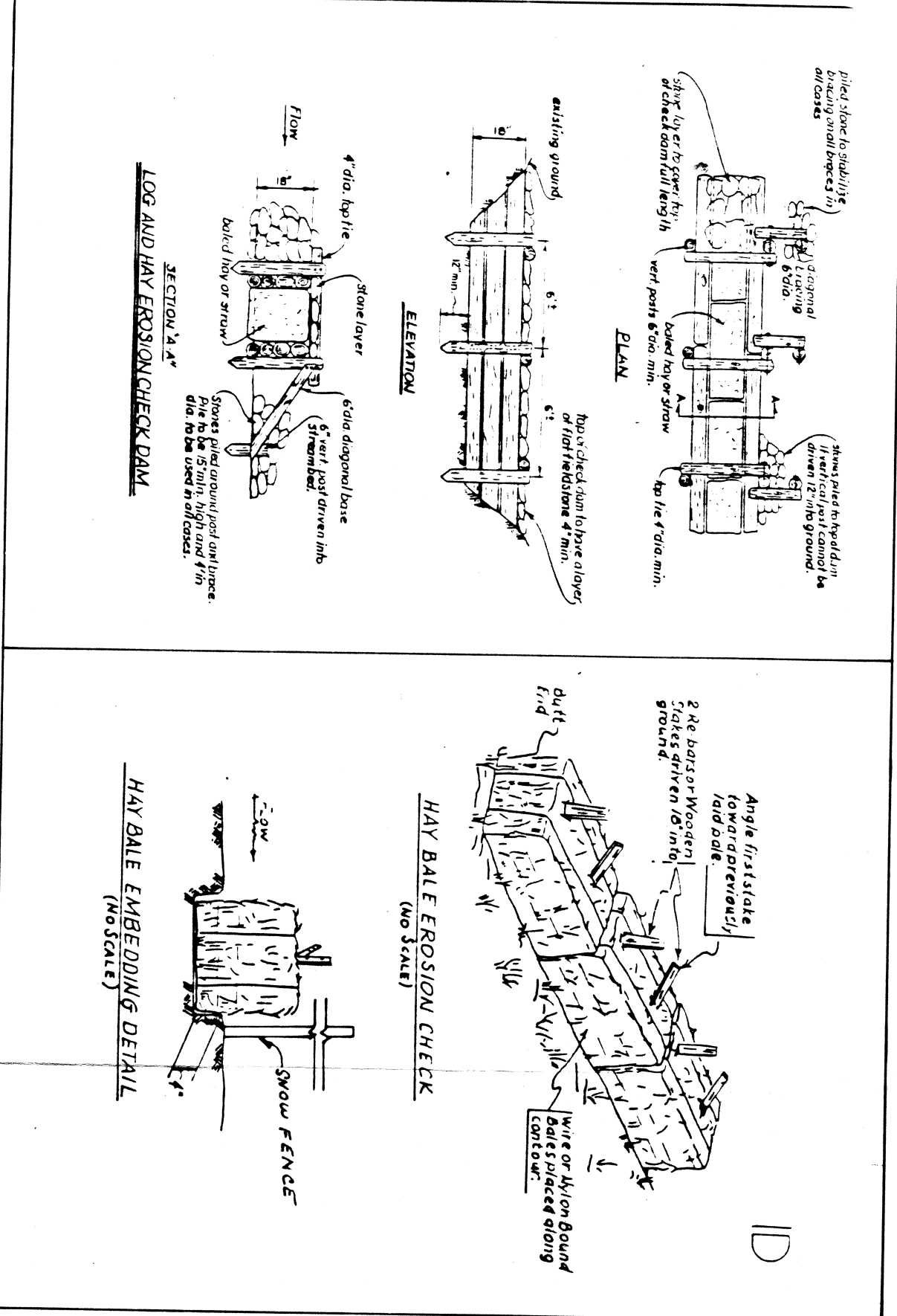
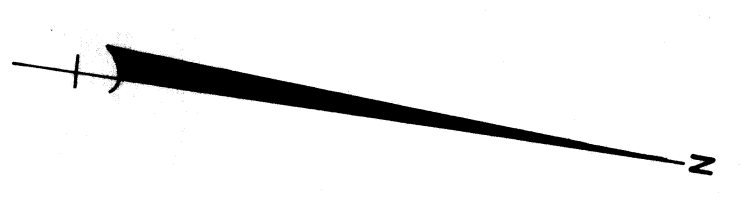

- LEGEND**
- 42 — EXISTING CONTOURS
  - 42 — PROPOSED CONTOURS
  - 42 — TEMPORARY HAY BALE & SNOW FENCE
  - 42 — EROSION CHECKS
  - 42 — VEGETATED WETLANDS LINE
  - 53 — DOCUMENTED WETLAND STATION
  - — — EASEMENT

**EROSION CONTROL NOTE**  
 CONTINUOUS LINE OF BALED HAY & SNOW FENCE  
 TO BE IN PLACE AT THE TOE OF ALL PROPOSED  
 CONSTRUCTION

THIS PLAN IS A REVISION OF THE  
 DETENTION AREA - SECTION II  
 AS SHOWN ON A PLAN ENTITLED  
 HERITAGE HEIGHTS, BY S.M.R.  
 SURVEYING & ENGINEERING CO.  
 DATED JANUARY 17, 1980 AND  
 REVISED NOVEMBER 19, 1984  
 AND NO. 2 MAY 8, 1985

REVISION FOR NOTICE OF INTENT SECTION II AMENDED DATE: JULY 2, 1987

**HERITAGE HEIGHTS**  
 SECTION II AMENDED  
 EROSION CONTROL PLAN I