

**CAPUTO  
AND  
WICK LTD.**

CIVIL ENGINEERING AND SURVEYING  
ARCHITECTURAL ENGINEERING  
TRAFFIC ENGINEERING

RECORD LOT NO. 5

1150 PAWTUCKET AVENUE  
RUMFORD, RHODE ISLAND 02916-1897  
401-454-8880

SCALE: 1" = 40'

**EXHIBIT A**

4/1/87

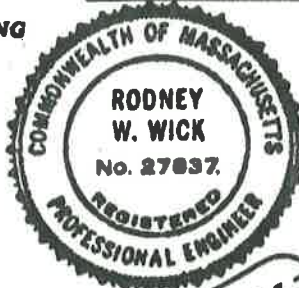

EDWARD C. and  
JOHN N. COLE  
LOT 274

THIS AREA TO  
REMAIN NATURAL

LOT 275

EXISTING STAKED  
HAY BALES AT  
LIMIT OF WORK

APPROXIMATE  
EDGE OF 100 YR.  
FLOODPLAIN  
EL. 47.00 ±

T.P. No. 1  
6" LOAM &  
SEED

330 C.Y.  
OF FILL TO  
BE PLACED  
WITHIN 100'  
OF DITCH

TEST PIT NO. 1  
WATER @ 45.4  
4/24/79

PROPOSED  
HORSE BARN

MARIA L. &  
LUIS H. RAMOS  
LOT 23

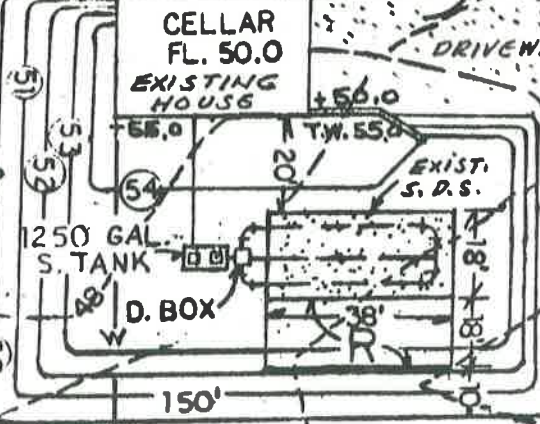

EXIST. CULVERT

BENCH MARK  
SPIKE IN POLE  
EL. 50.70

69-125

**NOTE:**  
ADD 20.0' TO ALL  
ELEVATIONS TO  
OBTAIN M.S.L.

THOMAS & JOAN GIBBONS  
SEEKONK, MASS.  
PLAT 25  
LOT 275  
AREA = 86,200

76 BROWN AVENUE

ZONE R/2