

U.S. WEATHER BUREAU
TECHNICAL PAPER NO. 25
PROVIDENCE, R.I.

50 YR. STORM

30 MIN. DURATION

I = 3.3 A.F.

C = 85%

WIND VOL. = 36 C.F.F.

DETENTION RESERVOIR

(30)(190) = 5700 C.F.F.

2 FT. DEPTH, VOL. = 49,400 C.F.F.

100 YR. STORM

30 MIN. DURATION

I = 3.6 A.F.

C = 85%

WIND VOL. = 28 C.F.F.

DETENTION RESERVOIR

(30)(190) = 5700 C.F.F.

2 FT. DEPTH, VOL. = 54,340 C.F.F.

SEWER WORK
TOP OF INV.
ELEV. 26.78

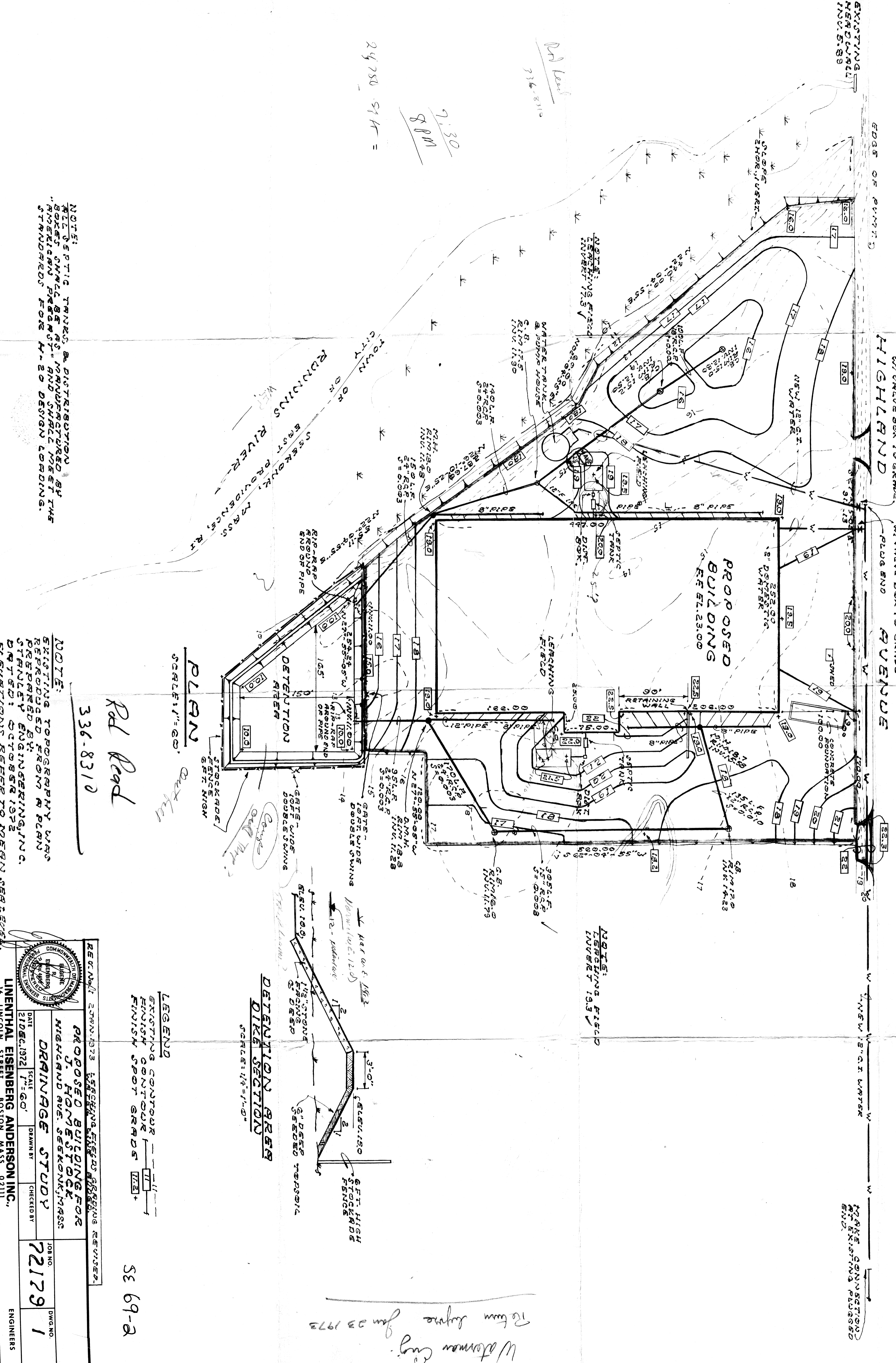
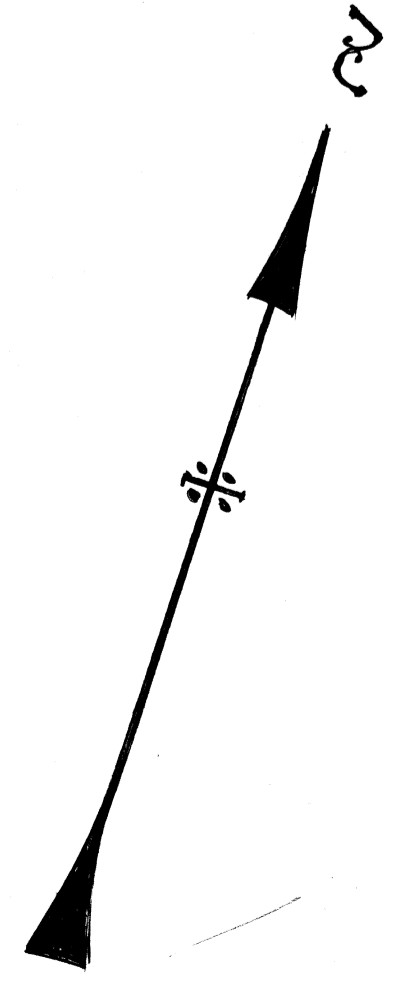

24750 STA =
7.30
8 PM

NOTE: P.T.C. TRAKS & DISTRIBUTION BY
M.C. & S.M. SHALL BE SUPERSEDED BY THE
"PROVIDENCE BRIST" AND SHALL MEET THE
STANDARDS FOR A-20 DESIGN LOADING.

NOTE:
EXISTING TOPOGRAPHY WAS
RECORDED BY STANLEY
ENGINEERING, INC.
DATED: OCTOBER 1972
ELEVATIONS REFER TO MEAN SEA LEVEL

PLAN
SCALE: 1" = 60'

Red Lead

336-8310

DETENTION AREA
DIKE SECTION
SCALE: 1/4" = 1'-0"

LEGEND
EXISTING CONTOUR
FINISHED CONTOUR
FINISH SPOT GRADES

REVISION	DATE	BY	REVISION
1	21 DEC 1972	J. H. ANDERSON	PROPOSED BUILDING FOR J. H. ANDERSON
2			HIGHLAND AVE. SSEKONKI, MASS
3			DRAINAGE STUDY
4			ENGINEERS

LINENTHAL EISENBERG ANDERSON INC.
 10 LINCOLN STREET BOSTON MASS 02111

SC 69-2

Waterman Eng.
R. L. Payne Jan 23 1973