

SCALE: 1" = 30'

PLAT 10, LOT 256  
RECORDED  
AREA 165,590 S.F.  
ZONE R-3

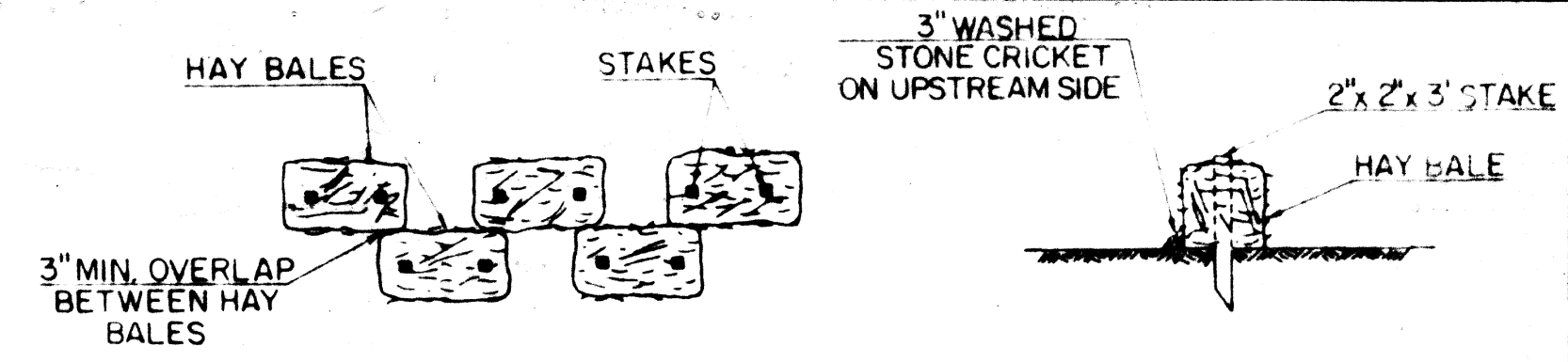

**NOTE:**  
1. PLACE STAKED HAY BALES PRIOR TO GRADING & MAINTAIN IN PLACE UNTIL AN APPROVED GROUND COVER IS ESTABLISHED.  
2. LOAM & SEED ALL AREAS DISTURBED BY GRADING.

**DESIGN DATA**  
4 BEDROOMS = 660 G.P.D.  
PERC RATE = 2 MINS/INCH  
USE 84 L.F. OF TRENCH 3' WIDE W/12" OF STONE BELOW SIDE.  
84' x 2' x 1' x 2.5' = 420 GALS.  
BOTTOM: 84' x 3' x 1.0' = 252 GALS.  
TOTAL = 672 GALS.

STRIP ALL TOP & SUBSOIL IN THE AREA OF THE TRENCH & 10' BEYOND IN ALL DIRECTIONS & REPLACE WITH BANK RUN GRAVEL.

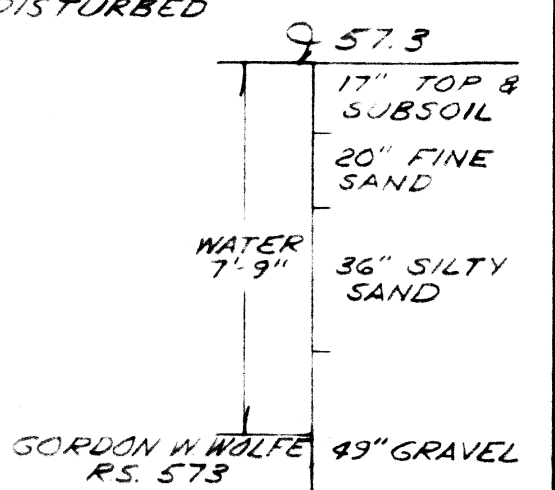

**TEST PIT**  
4-30-86  
WATER @ 7'-9"  
FACTOR 1.0"  
WATER @ 6'-3" (50.60)

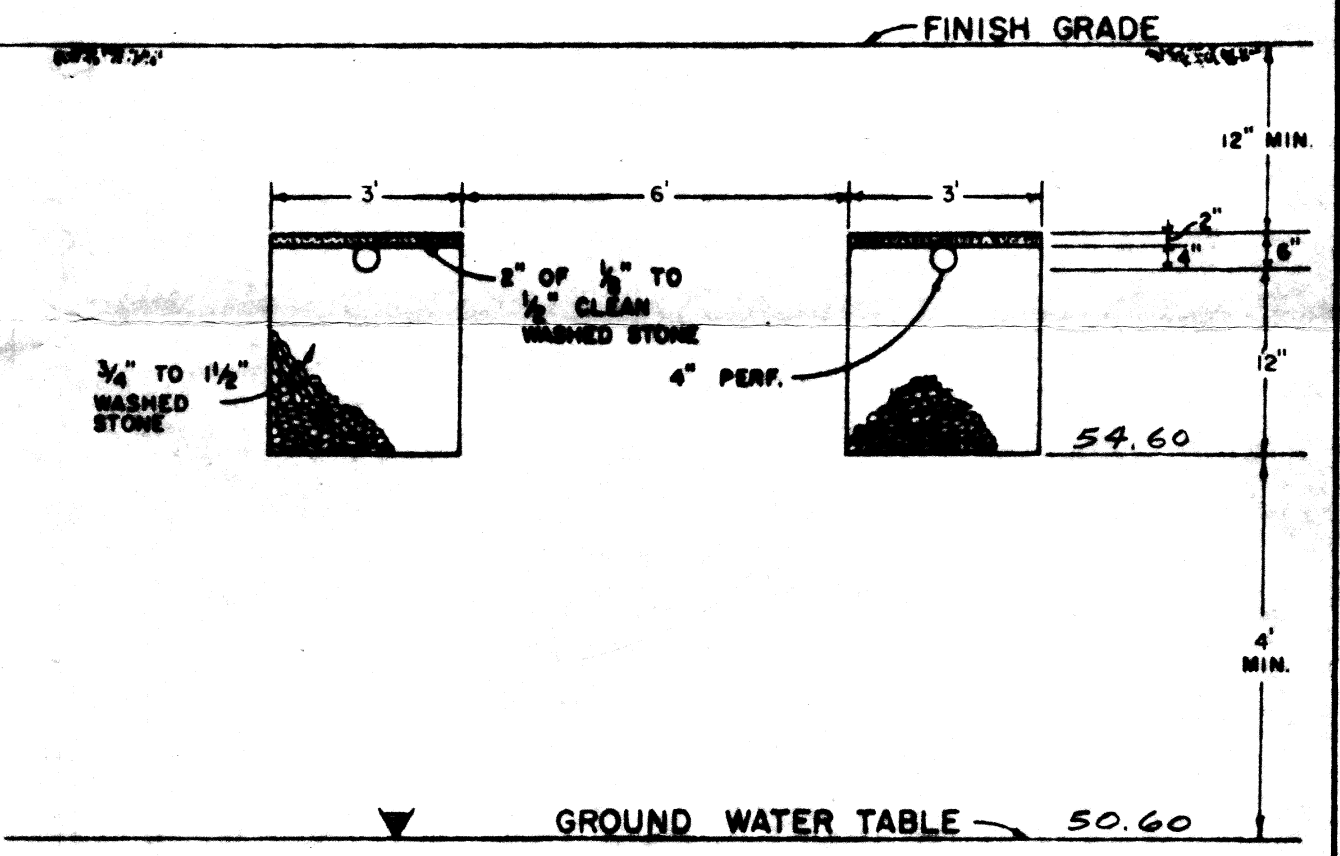

**TRENCH SECTION**  
NOT TO SCALE

# SE 69-146

EXHIBIT A

SITE PLAN  
RECORD LOT NO. 6  
EVERGREEN ESTATES  
SEEKONK, MASSACHUSETTS  
FOR  
BALLOU ENTERPRISES INC.

CAPUTO AND WICK LTD.  
1150 PAWTUCKET AVE.  
RUMFORD, R.I. 02916  
401-434-8880

DATE  
NOV, 1987  
SHEET  
1 OF 1

