

- GENERAL NOTES**
- ALL CONSTRUCTION SHALL CONFORM TO THE TOWN OF SEEKONK BOARD OF HEALTH RULES AND REGULATIONS AND TITLE 5, THE STATE ENVIRONMENTAL CODE.
 - THIS PLAN IS TO BE USED ONLY FOR THE CONSTRUCTION OF THE DESIGN DISPOSAL SYSTEM AND DOES NOT REPRESENT ACTUAL AS-BUILT CONDITIONS UNLESS OTHERWISE NOTED.
 - THE PROPOSED SYSTEM SHOWN HEREON IS NOT DESIGNED FOR THE USE OF A GARBAGE DISPOSAL AND SAID USE IS NOT ALLOWED.
 - THE SEPTIC TANK SHOULD BE PUMPED OUT EVERY ONE TO TWO YEARS DEPENDING ON USE.
 - ALL BASE AGGREGATE FOR LEACHING STRUCTURES SHALL CONSIST OF DOUBLE WASHED STONE FREE OF IRON, FINES, AND DUST IN PLACE.
 - TIGHT JOINT PIPING (PVC) SCHEDULE 40, UNLESS OTHERWISE NOTED.
 - NO PERMANENT STRUCTURE MAY BE CONSTRUCTED OVER THE CONSTRUCTION AREA.
 - BEFORE BEGINNING ANY EXCAVATION OR DEMOLITION CALL 'DIG SAFE' AT 1-888-344-7233 TO NOTIFY MEMBER UTILITIES.
 - THE GRADE ABOVE AND ADJACENT TO THE LEACHING FACILITY SHALL BE SLOPED TO PREVENT THE ACCUMULATION OF SURFACE DRAINAGE (2% MINIMUM SLOPE).
 - IF SOILS ASSOCIATED WITH FAILED LEACHING SYSTEMS ARE ENCOUNTERED DURING CONSTRUCTION, CONTRACTOR SHALL REMOVE AND REPLACE WITH CLEAN GRANULAR MATERIAL MEETING THE SPECIFICATIONS OF 310 CMR 15.255(3).
 - THE OVER-DIG AREA (D) AS SHOWN HEREON IS TO BE STRIPPED OF ALL TREES, BRUSH, STUMPS, TOPSOIL, PEAT OR OTHER IMPERVIOUS MATERIALS. THE (D) AREA EXTENDS 5 FEET HORIZONTALLY AROUND THE PROPOSED SYSTEM AND TO THE DEPTH SPECIFIED. THE REPLACEMENT MATERIAL SHALL MEET SPECIFICATIONS OF 310 CMR 15.255 OF THE STATE ENVIRONMENTAL CODE.
 - WATER TABLES FLUCTUATE ANNUALLY. NO GUARANTEE OF A DRY CELLAR IS EXPRESSED OR IMPLIED.

CONSTRUCTION NOTE:
OSD engineering & associates TO BE NOTIFIED BY THE INSTALLING CONTRACTOR OF THE START OF CONSTRUCTION AND TO BE GIVEN 24 HOUR NOTICE FOR AS-BUILT.

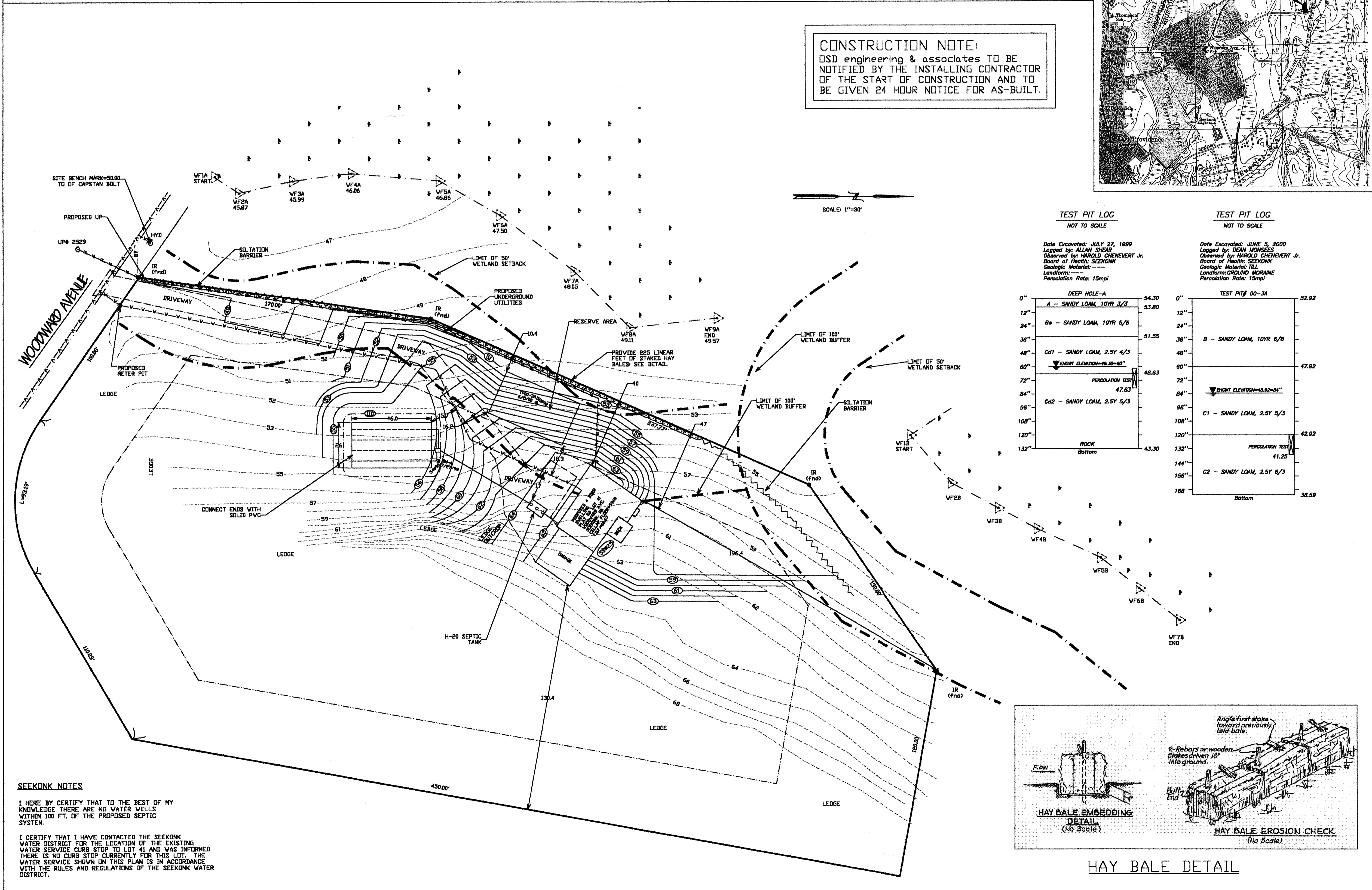

TEST PIT LOG
NOT TO SCALE

Date Excavated: JULY 27, 1999
Logged by: ALLAN SHEA
Observed by: HAROLD CHEREVERT Jr.
Board of Health: SEEKONK
Geologic Material: TLL
Lithology: GRUND MORANE
Percolation Rate: 15mpd

0"	DEEP HOLE-A	54.30
12"	A - SANDY LOAM, 10YR 3/3	53.80
24"	Bw - SANDY LOAM, 10YR 5/6	51.55
36"		51.55
48"	Ct1 - SANDY LOAM, 2.5Y 4/3	48.63
60"	PERCOLATION TEST	47.63
72"		47.63
84"	Ct2 - SANDY LOAM, 2.5Y 5/3	47.63
96"		47.63
108"		47.63
120"	ROCK	43.30
132"	Bottom	43.30

TEST PIT LOG
NOT TO SCALE

Date Excavated: JUNE 5, 2000
Logged by: DEAN WOODS
Observed by: HAROLD CHEREVERT Jr.
Board of Health: SEEKONK
Geologic Material: TLL
Lithology: GRUND MORANE
Percolation Rate: 15mpd

0"	TEST PIT# 00-3A	52.82
12"		52.82
24"	B - SANDY LOAM, 10YR 6/8	51.55
36"		51.55
48"		51.55
60"	PERCOLATION TEST	47.63
72"		47.63
84"		47.63
96"		47.63
108"		47.63
120"		47.63
132"	PERCOLATION TEST	42.92
144"		42.92
156"	C2 - SANDY LOAM, 2.5Y 6/3	41.25
168"	Bottom	38.59

DESIGN CALCULATIONS

FLOW:
(4BDRM)(110gpd/BDRM) = 440 GPD 880 PEAK

SEPTIC TANK: H-20
NEW 1500 GAL. TANK > 880

LEACHING FIELD:
RATE = (1/0.56) sf/gpd FOR PERC = 15mpd
MINIMUM SIZE: (440GPD)/(1/0.56)sf/GPD = 786 sf
786sf + 50% SEEKONK UPSIZE=1179sf
USE 26' x 46' = 1196 sf > 1179 sf

LEGEND

TEST PIT	TP#1	EXISTING CONTOURS	64
DISTRIBUTION BOX		EXISTING SPOT GRADE	47#38
SEPTIC TANK		PROPOSED CONTOURS	63
WATER SERVICE		PROPOSED SPOT GRADE	58#25
UTILITY LINES		WETLAND FLAG	57#
OVER-DIG		WETLAND SETBACKS	62#
EDGE OF DRIVEWAY		SILTATION BARRIER	63#
		HAY BALES	64

REVISIONS

10/25/00	ADD STAKED HAY BALES AT TOE OF SLOPE PER CONSERVATION COMMISSION MEETING 10/16/00
DATE	DESCRIPTION

SITE DEVELOPMENT AND SEWAGE DISPOSAL SYSTEM PLAN

LOT NUMBER: 41 AREA OF LOT: 14,506sf PLAT NO: 23
LOT ADDRESS: WOODWARD AVENUE
IN SEEKONK, MASS.
PREPARED FOR:
AL MONTIJO
1294 NEWMAN AVE.
SEEKONK, MA 02771

SCALE: AS SHOWN
DATE: SEPTEMBER 12, 2000

DESIGNED BY: DRM
JOB NO: 00-151
FILE: WOODWARDLOT41.dwg

OSD engineering & associates
CIVIL ENGINEERS
45 ASTRAL AVENUE
RIVERSIDE, R.I.
(401) 438-6216

69-478

OSD

SEEKONK NOTES

I HEREBY CERTIFY THAT TO THE BEST OF MY KNOWLEDGE THERE ARE NO WATER WELLS WITHIN 100 FT. OF THE PROPOSED SEPTIC SYSTEM.

I CERTIFY THAT I HAVE CONTACTED THE SEEKONK WATER DISTRICT FOR THE LOCATION OF THE EXISTING WATER SERVICE CURB STOP TO LOT 41 AND WAS INFORMED THERE IS NO CURB STOP CURRENTLY FOR THIS LOT. THE WATER SERVICE SHOWN ON THIS PLAN IS IN ACCORDANCE WITH THE RULES AND REGULATIONS OF THE SEEKONK WATER DISTRICT.

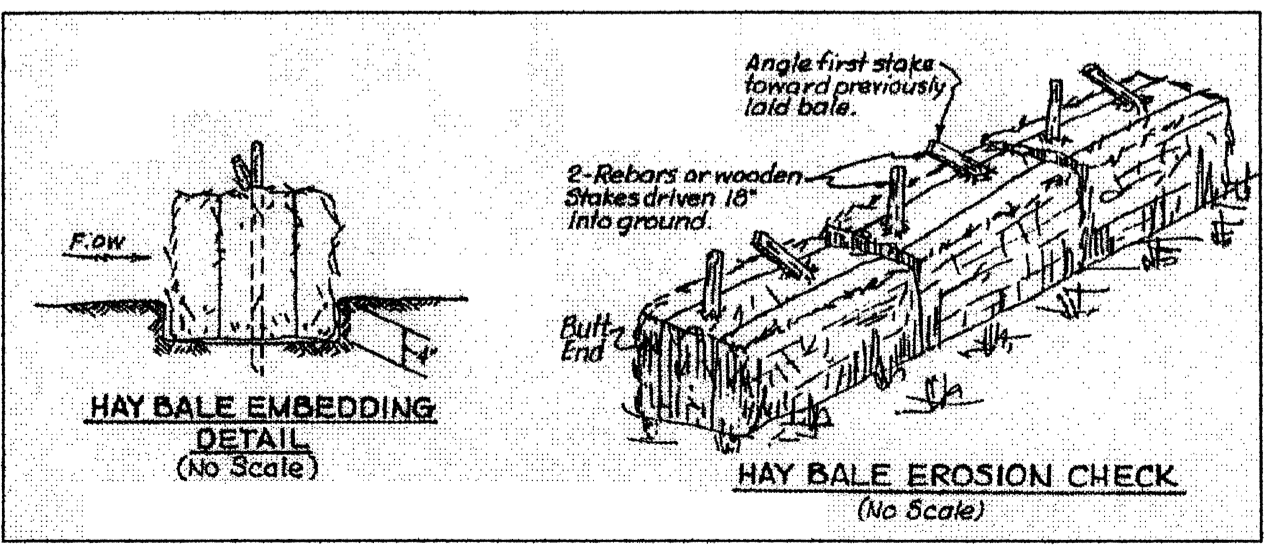

HAY BALE DETAIL

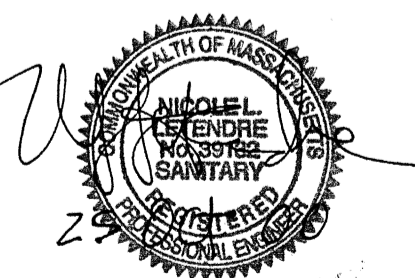

Received
OCT 30 2000
Con. Comm.