

DESIGN CRITERIA: NO GARB. ALLOWED.
 1-36" X 18" W FIELD
 4 BED. X 110 GAL/BED = 440 GPD
 BOT. 648 S.F. X 0.7F = 479.52

PROVIDED

D. BOX: 5 OUTLETS WITH BAI
 SEPTIC TANK: GALLONS = 1
 TANK TO HAVE 3-20" ACCES
 COVERS AND ONE BROUGHT TO

**SITE PREPARATION NOTES:
 (CHECK IF APPLICABLE)**

TOP, SUBSOIL AND C
 DELETERIOUS MATERIALS I
 AND WITHIN 5 FEET OF TH
 LEACH SYSTEM ARE TO BE
 REMOVED PRIOR TO
 CONSTRUCTION AND REPLAC
 WITH SUITABLE MATERIAL A
 REQUIRED UNDER SECTION
 15.256 OF TITLE V. STRIP:
 ELEV. 95.0 ± ANA REPHUE
 ELEV. 99.50 ± WITH 2 IN P
 MATERIAL AS NEEDED

LEGEND:
 PERCOLATION TEST ⊕
 TEST HOLE ⊕
 EXISTING CONTOUR — 100—
 PROPOSED CONTOUR — 100—

CONCOM APPROVAL REQUIRED

APPROVED
[Signature]

Herold E. Chenevert
 Health Agent

AS-BUILT PLAN
 KSD NTS.

- CONSTRUCTION NOTES:**
- ALL WORK SHALL CONFORM TO 816 CMR 10.00 STATE ENVIRONMENTAL CODE TITLE 8 RULES AND REGULATIONS ESTABLISHING MINIMUM STANDARDS RELATING TO LOCAL DESIGN, CONSTRUCTION AND MAINTENANCE OF INDIVIDUAL SEWAGE DISPOSAL SYSTEMS AS OF THE LATEST AMENDMENT AND WITH THE REGULATIONS OF THE SEERONK BOARD OF HEALTH.
 - THERE ARE NO KNOWN WELLS WITHIN 100' OF THE PROPOSED SEEPAGE FIELD; THERE ARE NO KNOWN ISDS FOUND WITHIN 100'.
 - THE INSTALLER SHALL VERIFY ALL ELEVATIONS AND DIMENSIONS PRIOR TO STARTING WORK. THE INSTALLER SHALL NOTIFY THE ENGINEER OF ANY DEVIATION FROM THE PLANS IN WRITING 10 DAYS BEFORE BEGINNING WORK.
 - MINIMUM DISTANCE FROM EDGE OF SEEPAGE FIELD TO PRESSURE WATER LINE = 10' AND 100' FROM A WELL.
 - CARE SHALL BE TAKEN TO ASSURE THAT THE SOIL AT THE BOTTOM OF THE EXCAVATION IS NOT COMPACTED OR SWEARED.
 - SUB-SURFACE DRAINS, FOUNDATION DRAINS AND STORM DRAINS SHALL BE 5' MINIMUM FROM THE SEPTIC TANK, 10' FROM THE SEEPAGE FIELD
 - IT IS THE RESPONSIBILITY OF THE INSTALLER TO CONTACT THE ENGINEER 24 HOURS PRIOR TO BACKFILLING OF ANY PART OF THE SEPTIC SYSTEM SO THAT AN AS-BUILT CAN BE OBTAINED FOR THE BOARD OF HEALTH.
 - NO PERMANENT STRUCTURE MAY BE CONSTRUCTED OVER 100% EXPANSION AREAS
 - DROWN ENVIRONMENTAL SERVICES WILL NOT BE RESPONSIBLE FOR THE PERFORMANCE OF THE SYSTEM UNLESS CONSTRUCTED AS SHOWN. ANY ALTERATIONS MUST BE APPROVED IN WRITING BY DROWN.
 - LOT LINES SHALL BE VERIFIED BY A REGISTERED LAND SURVEYOR.
 - TIGHT JOINT PIPING TO CONSIST OF POLYVINYL CHLORIDE PIPE (P.V.C.) S 40 UNLESS OTHERWISE NOTED.

ELEV.'S & INV.'S	PROPOSED	AS-BUILT	TEST PIT NO. 1	TEST PIT NO. 2	TEST PIT NO. 3	PERCOLATION TEST DATA
TOP OF FOUNDATION		EXISTING 102.26	0' 78.22			DATE OF TEST
FINISHED BASEMENT FLOOR			20' 96.55			8/30/01
INV. OF PIPE AT FND.	99.75		36' 95.22			PERCOLATION RATE 2 MIN/IN CLASS I
INV. AT SEPTIC INLET	99.55					ELEV. OF BOT. OF PERC TEST HOLE 95.82
INV. AT SEPTIC OUTLET	99.50					
INV. AT D. BOX INLET	99.25					
INV. AT D. BOX OUTLET	99.05					
INV. AT END OF PIPES	98.75					
ELEV. AT BOT. OF STONE	98.25					

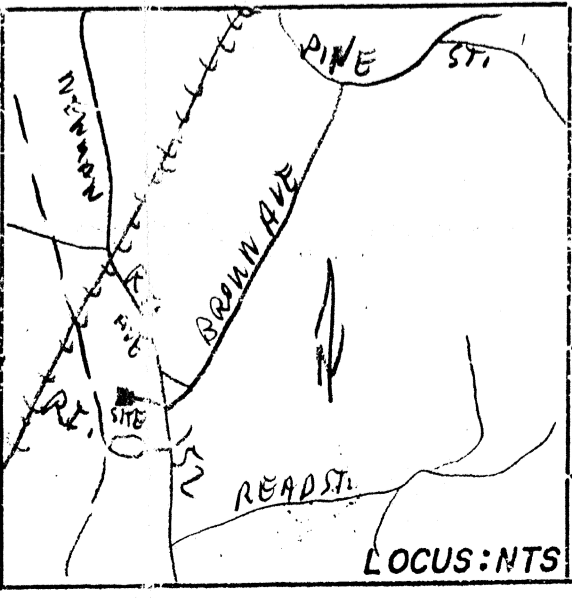

DROWN ENVIRONMENTAL SERVICES
 P. O. BOX 263
 REHOBOTH, MASSACHUSETTS 02769
 (508) 252-6274

"REPAIR" ASSESSOR MAP 25 LOT 252
PROPOSED SEWAGE DISPOSAL SYSTEM
 40 ERMILINDA DRIVE

APPLICANT: MR. OLIVEIRA
 40 ERMILINDA DRIVE
 SEERONK, MA

SCALE: 1" = 30'
 DRAWN BY: KSD
 REVISED

DATE: 2/19/01
 APPROVED BY: KSD
 JOHN
 01-017R