

HIGH POINT ELEV = 207.23  
 HIGH POINT STA = 3+41.81  
 PVI STA = 4+21.36  
 PVI ELEV = 211.05  
 A.D. = -11.00  
 K = 31.82

EXISTING GRADE 25' LT = SHORT DASH  
 EXISTING GRADE CENTER = LONG DASH  
 EXISTING GRADE 25' RT = DASH-DOT

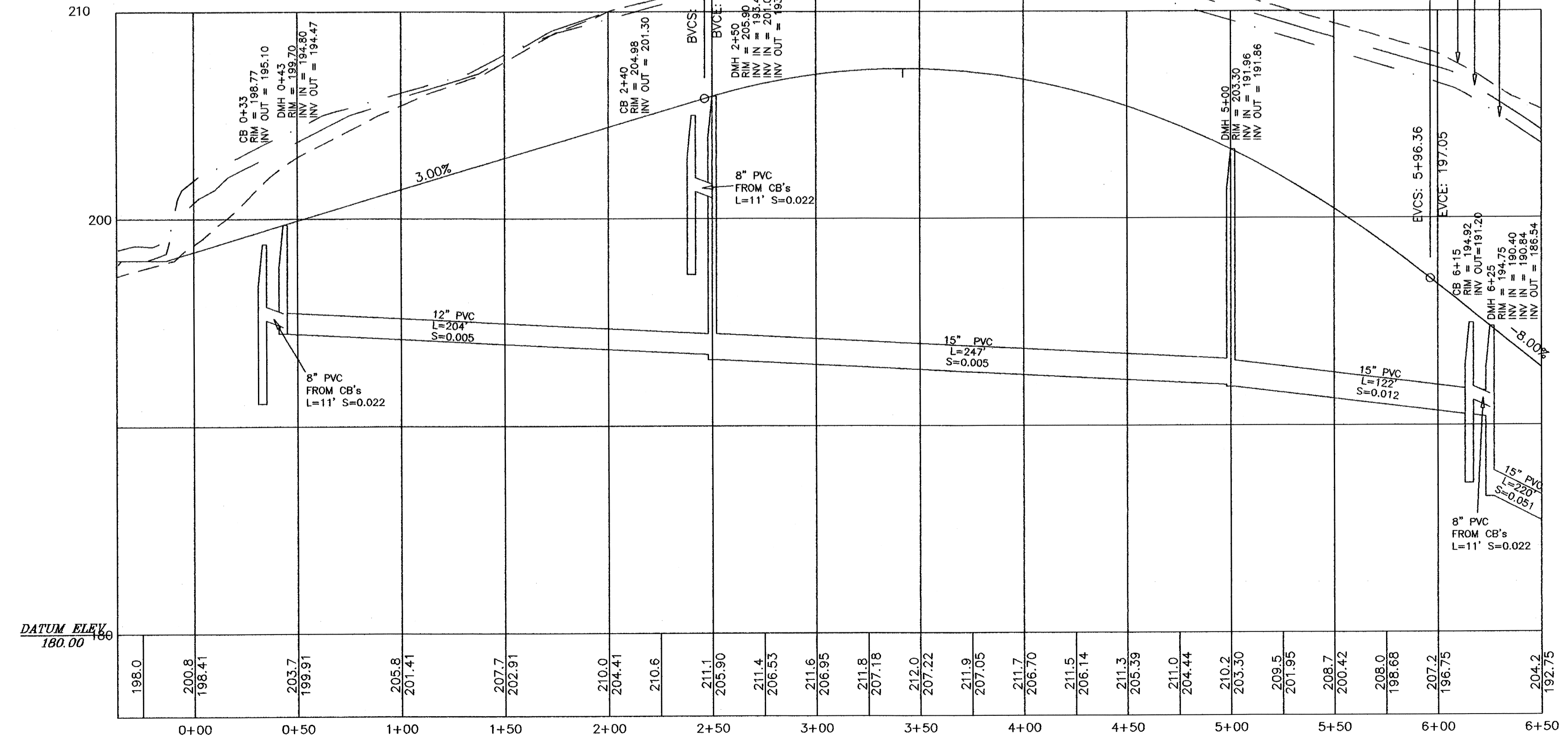

**NOTE:**  
 PRIOR TO CONSTRUCTION OF THE ROADWAY, AT LEAST TWO PERMANENT BENCHMARKS SHALL BE PLACED IN AREAS WHICH WILL REMAIN UNDISTURBED THROUGHOUT THE CONSTRUCTION PROCESS.

PRIOR TO THE BEGINNING OF CONSTRUCTION, THE CONTRACTOR SHALL COORDINATE THE METHODS AND LOCATIONS OF PROPOSED FIRE PREVENTION/CONTROL SYSTEM WITH THE TOWN OF SEEKONK'S FIRE CHIEF. DETAILS OF SAID FIRE PREVENTION SHALL BE SUBMITTED TO THE DESIGN ENGINEER FOR REVIEW OF POSSIBLE SITE DESIGN CONFLICTS PRIOR TO THE INSTALLATION OF SAID SYSTEM.

**DIG SAFE:**  
 EXCEPT FOR VISIBLE STRUCTURES (MANHOLES, GATES, POLES, ETC.) LOCATED BY JOHN HALNON, PLS INC., ALL UNDERGROUND UTILITIES SHOWN WERE COMPILED ACCORDING TO AVAILABLE RECORD PLANS FROM THE VARIOUS UTILITY COMPANIES AND PUBLIC AGENCIES AND ARE APPROXIMATE ONLY. ACTUAL LOCATIONS MUST BE DETERMINED IN THE FIELD BEFORE DESIGNING, EXCAVATING, BLASTING OR INSTALLING, BACKFILLING, GRADING, PAVEMENT RESTORATION, OR REPAIRING.

ALL UTILITY COMPANIES, PUBLIC & PRIVATE, MUST BE CONTACTED, INCLUDING THOSE IN CONTROL OF UTILITIES NOT SHOWN ON THIS PLAN.

OSD engineering & associates ASSUMES NO RESPONSIBILITY FOR DAMAGES INCURRED AS A RESULT OF UTILITIES OMITTED OR INACCURATELY SHOWN. CALL "DIG SAFE" AT 1-888-344-7233

**NOTE:**  
 ALL ROADWAY FILLS SHALL BE BROUGHT UP IN UNIFORM ONE FOOT LAYERS AND SHALL BE COMPACTED TO A RELATIVE COMPACTION OF NOT LESS THAN 95% AS DETERMINED BY AASHTO TEST DESIGNATION T-99, METHOD C. MATERIAL SHALL BE TESTED FOR COMPLIANCE TO ABOVE REGULATION BY A MATERIALS AND TESTING FIRM. COPIES OF THE TEST RESULTS SHALL BE SUBMITTED TO THE TOWN IN REPORT FORM.

**LEGEND**

- ⊙ PROPOSED TEMPORARY SEDIMENT SUMP
- ⊙ PROPOSED STONE LINED SEDIMENT SUMP
- TOC= TOP OF CONCRETE FOUNDATION ELEVATION
- GF= GARAGE FLOOR ELEVATION
- BF= BASEMENT FLOOR ELEVATION
- ⊙ PROPOSED CATCH BASIN
- PROPOSED DRAIN LINE AND MANHOLES
- ⊙ PROPOSED DRY WELL
- PROPOSED UNDERGROUND ELEC/CABLE/TELE
- ▬▬▬▬ PROPOSED SEDIMENT CONTROL BARRIER
- ▬▬▬▬ PROPOSED RIP-RAP APRON
- 123-45 PROPOSED SPOT GRADE
- 123.4 PROPOSED FOUNDATION DRAIN INVERTS
- ⊙ PROPOSED STREET TREE
- 123— PROPOSED CONTOUR AND LABEL
- ⊙ EXISTING UTILITY POLE
- — — EXISTING WETLAND LINE
- — — EXISTING 100' WETLAND BUFFER
- A1 EXISTING WETLAND FLAG LOCATION
- 123 — EXISTING 2' CONTOUR AND LABEL
- 123 — EXISTING 10' CONTOUR AND LABEL



*James A. Bernardino* 5-25-02  
*Don Moran* 5-25-02

OSD engineering & associates  
 CIVIL ENGINEERS  
 45 ASTRAL AVENUE  
 RIVERSIDE, R.I. 02915  
 (401) 438-6216



CLT. NO.	971.A10	JOB NO.	01-301
DATE:	1/10/02	DWG NO.	

REVISIONS	
DATE	DESCRIPTION
5/25/02	ROADWAY CHANGES PER PLANNING BOARD MEETING
5/25/02	WETLAND LINE PER CONSERVATION COMMISSION

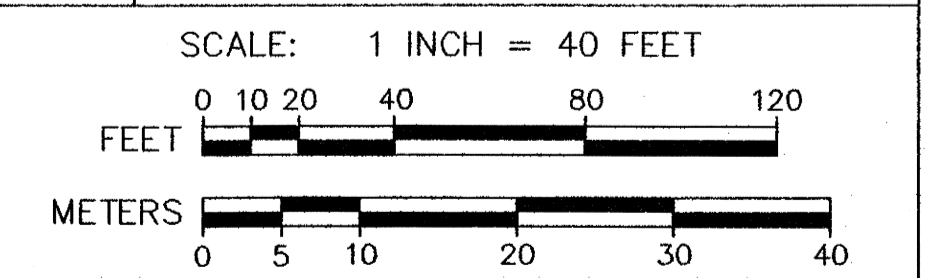

"DEFINITIVE SUBDIVISION OF LAND"  
 "GRASSY HILL FARM"  
 PLAN AND PROFILE OF LETENDRE ROAD  
 IN  
 SEEKONK, MASSACHUSETTS  
 PREPARED FOR  
 GENE BAASCH  
 62 BLANDING ROAD  
 REHOBOTH, MA 02769