

DRIVEWAY PROFILE

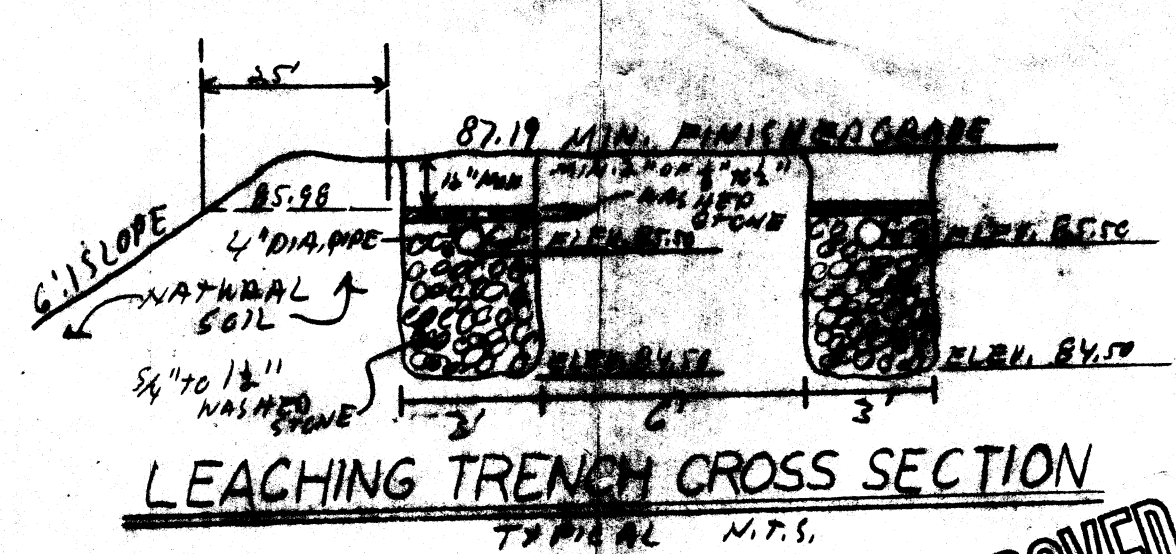
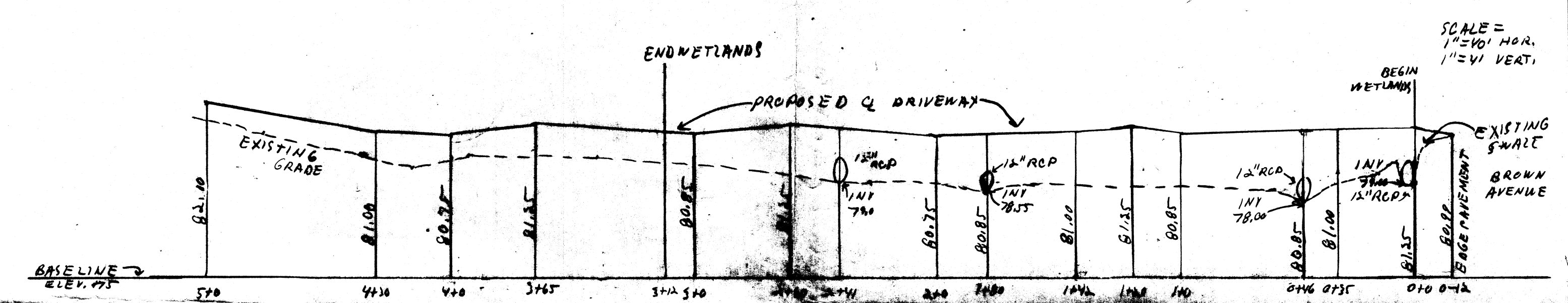

DESIGN CRITERIA (NO GARAGE SEPTIC)
 480RM x 110" x 150" ISOR = 600 G.P.O.
 2- 30' x 12' x 10' TRENCHES
 BOT. 4' x 3' x 2' = 240 SF x 12 = 2880
 SIDE 3' x 12' x 10' = 360 SF x 12 = 4320
 414 SF. 670 GAL. PROVIDED
 SEPTIC TANK Gals = 1250 GAL.

LEGEND:
 WETLAND PLANNING NUMBERS
 PERCOLATION TEST
 GROUND WATER TEST PIT
 EXISTING CONTOUR
 PROPOSED CONTOUR
 WETLAND EDGE
 HAYSTACKS

PROFILE OF SEWAGE DISPOSAL FACILITY

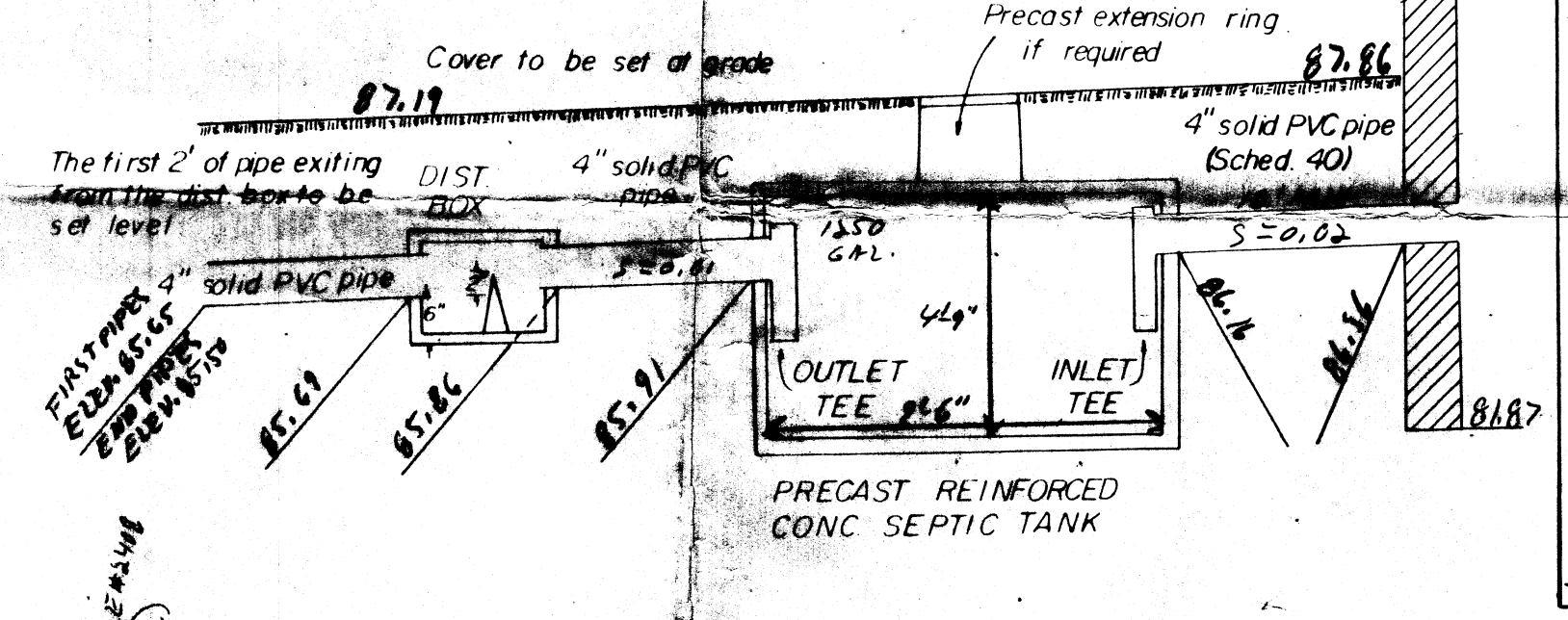

CONSTRUCTION NOTES:

- ALL WORK SHALL CONFORM TO THE 310 CMR 15.00 STATE ENVIRONMENTAL CODE TITLE 5 RULES AND REGULATIONS ESTABLISHING MINIMUM STANDARDS RELATING TO LOCATION, DESIGN, CONSTRUCTION AND MAINTENANCE OF INDIVIDUAL SEWAGE DISPOSAL SYSTEMS AS OF LATEST AMENDMENT & WITH THE REGULATIONS OF THE SEEKONK BOARD OF HEALTH.
- THERE ARE NO KNOWN WELLS WITHIN 100' OF PROPOSED SEEPAGE FIELD; NO OTHER ISDS WERE FOUND WITHIN 100', AND NO SUBDRAINS OR DRAINS WERE FOUND WITHIN 50' EXCEPT AS NOTED ON PLAN.
- THE CONTRACTOR SHALL VERIFY ALL ELEVATIONS AND DIMENSIONS PRIOR TO STARTING WORK. HE SHALL NOTIFY THE ENGINEER OF ANY DEVIATIONS FROM THE PLANS IN WRITING TEN (10) DAYS BEFORE BEGINNING WORK.
- MINIMUM DISTANCE FROM EDGE OF SEEPAGE FIELD TO PRESSURE WATER LINE = 10' AND 100' FOR SUCTION LINE.
- CARE SHALL BE TAKEN TO ASSURE THAT THE SOIL AT THE BOTTOM OF THE EXCAVATION IS NOT COMPACTED OR SMEARED.
- 300 SURFACE DRAINS, FOUNDATION DRAINS AND STORM DRAINS SHALL BE 25' FROM SEPTIC TANK, 25' FROM SEEPAGE FIELD.
- TIGHT JOINT PIPING TO CONSIST OF POLYVINYL CHLORIDE PIPE (PVC) SCHEDULE 40, UNLESS OTHERWISE NOTED.
- NO PERMANENT STRUCTURE MAY BE CONSTRUCTED OVER 100% EXPANSION AREA.
- DROWN ENVIRONMENTAL SERVICES WILL NOT BE RESPONSIBLE FOR THE PERFORMANCE OF THIS SYSTEM UNLESS CONSTRUCTED AS SHOWN. ANY ALTERATIONS MUST BE APPROVED IN WRITING BY DROWN.

DRIVEWAY:
 3 1/2' L x 16' W INCLUDES GRADING = 4992 S.F. OF WETLAND FILLING
COMPENSATORY AREA:
 AREA A 4050 S.F.
 AREA B 1050 S.F.
 PROVIDED 5100 S.F.
 *COMPENSATORY AREAS WILL HAVE A BOTTOM ELEVATION OF 79.40 MNN.

ELEVATIONS AND INVERTS		TEST PIT NO. 1	TEST PIT NO.	TEST PIT NO.	PERCOLATION TEST DATA
TOP OF FOUNDATION	88.70	5072 200	5071 206		DATE OF TEST
FINISHED BASEMENT FLOOR	81.82				4/29/07
INVERT OF PIPE AT FOUNDATION	86.36				PERCOLATION RATE 2 MIN/IN
INVERT AT SEPTIC TANK INLET	86.16				ELEV. OF BOTTOM OF PERC TEST HOLE 79.16
INVERT AT SEPTIC TANK OUTLET	85.91				
INVERT AT DISTRIBUTION BOX INLET	85.86				
INVERT AT DISTRIBUTION BOX OUTLET	85.69				
INVERT AT END OF PIPE	85.00				
ELEVATION AT BOTTOM OF TRENCH	81.52				



LOT 1, BROWN AVENUE
PROPOSED SEWAGE DISPOSAL SYSTEM AND CONSERVATION PLAN

APPLICANT: ADRIANO AND TERESA REYES
 121 CLAREMONT AVENUE
 NORTH BARNSTABLE, MA 01703

DESIGNED BY: KSD
 DATE: 8/22/08
 APPROVED BY: KSD

REVISION: MASSACHUSETTS 02769

JOB NUMBER: 88-38N
 LOT: 1