

**RUNNINS RIVER**

WATER ELEV.: 62.6  
3/2/95

SCALE: 1" = 30'

TEST PIT 1-1A		TEST PIT 2	
0	72.8	0	74.1
2.0	TOP and SUBSOIL 24"	3.0	TOP and SUBSOIL 36"
7.0	PACKED SILTY SAND AND GRAVEL BOULDERS 60"	7.0	PACKED SILTY SAND AND GRAVEL 48"
		9.5	FINE TO MED. GRAVEL TR. OF SILT 30"

**WATER TABLE DATA**  
 DATE DUG: 11/17/94  
 DATE READ: 2/16/95  
 W.T. DEPTH: 6'0"  
 PERC RATE: 5 M.P.H.  
 PERC DEPTH: 36"-48"  
 WITNESS: HAROLD CHENEVERT

- NOTES**
- ALL WORK SHALL CONFORM TO THE 310 CMR 1500 STATE ENVIRONMENTAL CODE TITLE 5 RULES AND REGULATIONS AND THE RULES AND REGULATIONS OF THE LOCAL BOARD OF HEALTH.
  - STRIP ALL TOP SOIL, SUB SOIL AND ANY OTHER IMPERVIOUS SOIL IN THE AREA OF THE SYSTEM AND 15 FEET BEYOND IN ALL DIRECTIONS WHERE POSSIBLE. REPLACE WITH GRAVEL.
  - ALL PIPING TO BE 4" P.V.C. SCH. 40 UNLESS OTHERWISE NOTED.
  - THE CELLAR FLOOR ELEVATION SHOWN HAS BEEN SUGGESTED AS A MINIMUM BASED UPON OBSERVED GROUNDWATER CONDITIONS. SINCE GROUNDWATER LEVELS FLUCTUATE ANNUALLY, NO WARRANTY OF A DRY CELLAR IS EXPRESSED OR IMPLIED.
  - IF CONDITIONS ENCOUNTERED DURING CONSTRUCTION VARY SUBSTANTIALLY FROM THOSE SHOWN ON THIS PLAN, NOTIFY CAPUTO AND WICK LTD. BEFORE PROCEEDING WITH CONSTRUCTION.

**DESIGN DATA**  
 DAILY SEWAGE FLOW  
 5 BEDROOMS x 110 G.P.D x 150% = 825 G.P.D.

- SEPTIC TANK REQUIREMENTS**
- USE 1,500 GALLON SEPTIC TANK
  - SHOULD BE CLEANED AT LEAST ANNUALLY
- LEACHING AREA REQUIREMENTS**
- USE BED 18'x30' WITH 6" OF STONE BELOW.  
 BOTTOM 18'x30' x 0.60 G/S.F. = 864 G.P.D.

- NOTES:**
- EXISTING CESSPOOLS TO BE CLEANED AND FILLED WITH SAND
  - INVERTS EXISTING DWELLING ARE TO BE DETERMINED DURING CONSTRUCTION BUT PRIOR TO INSTALLATION OF ANY SYSTEM COMPONENTS, CONTACT ENGINEER WHEN INFORMATION IS AVAILABLE.
  - THIS SYSTEM IS NOT DESIGNED FOR THE USE OF A GARBAGE GRINDER

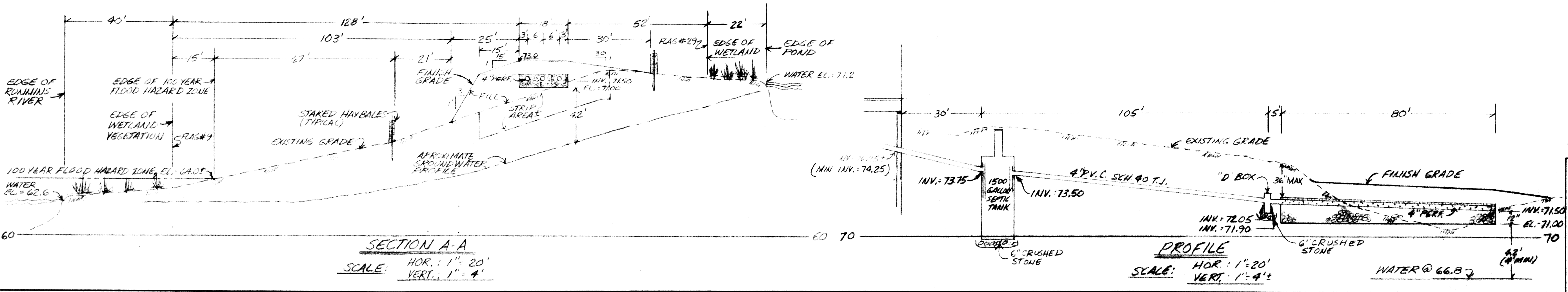
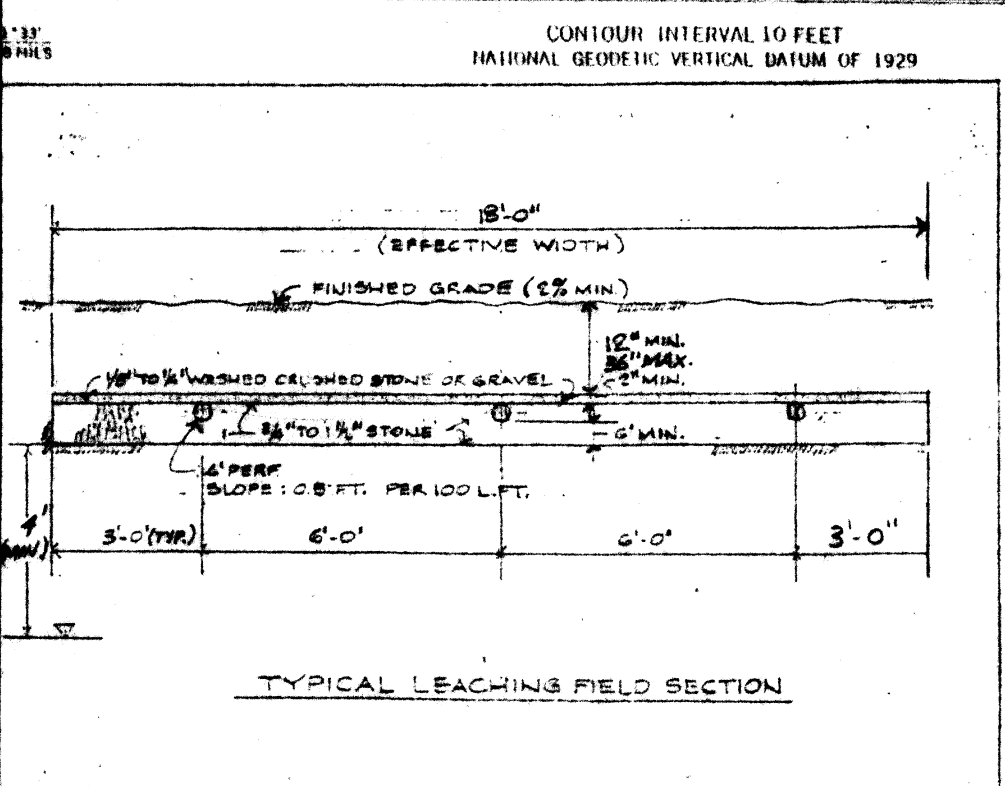
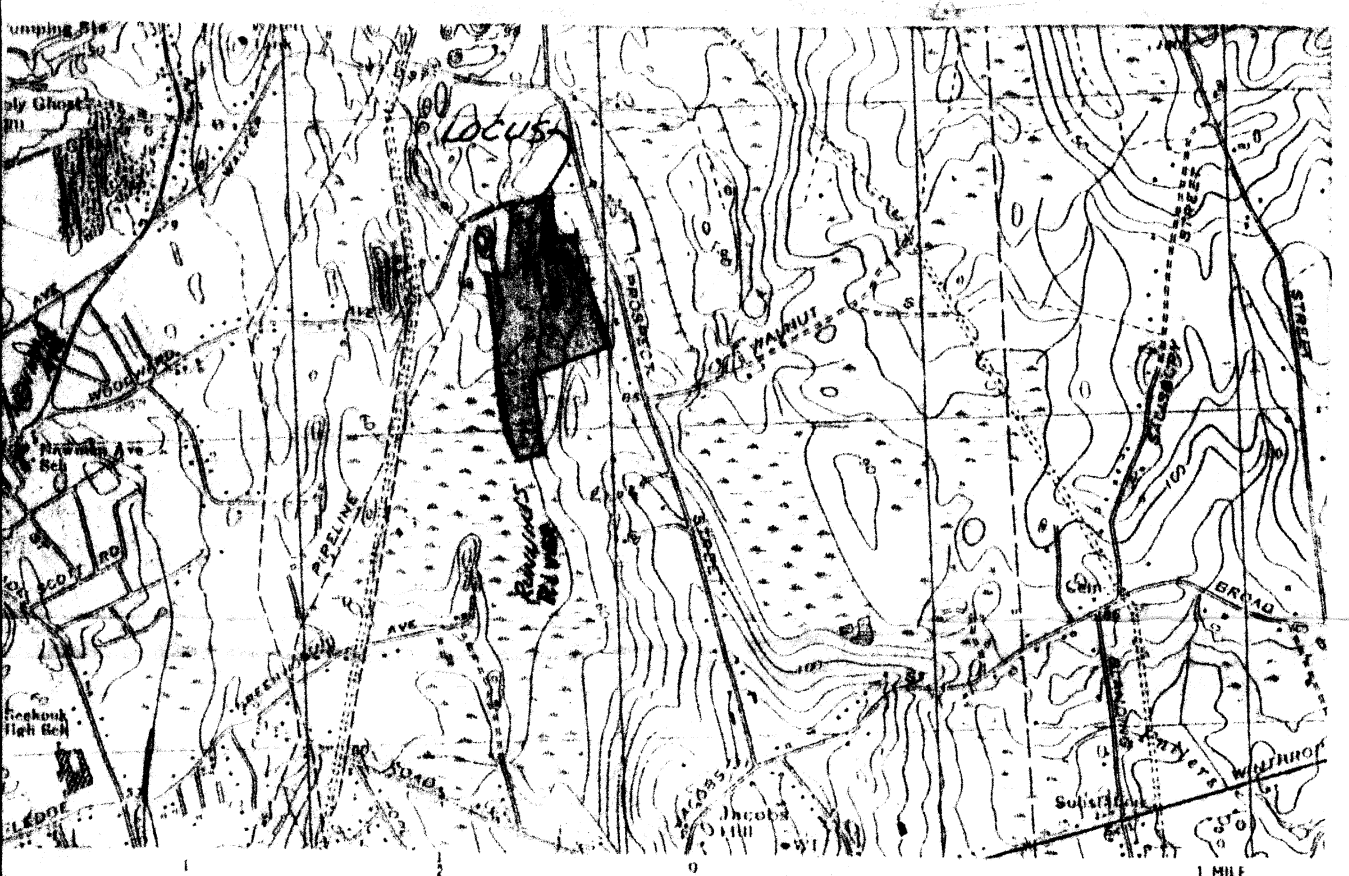
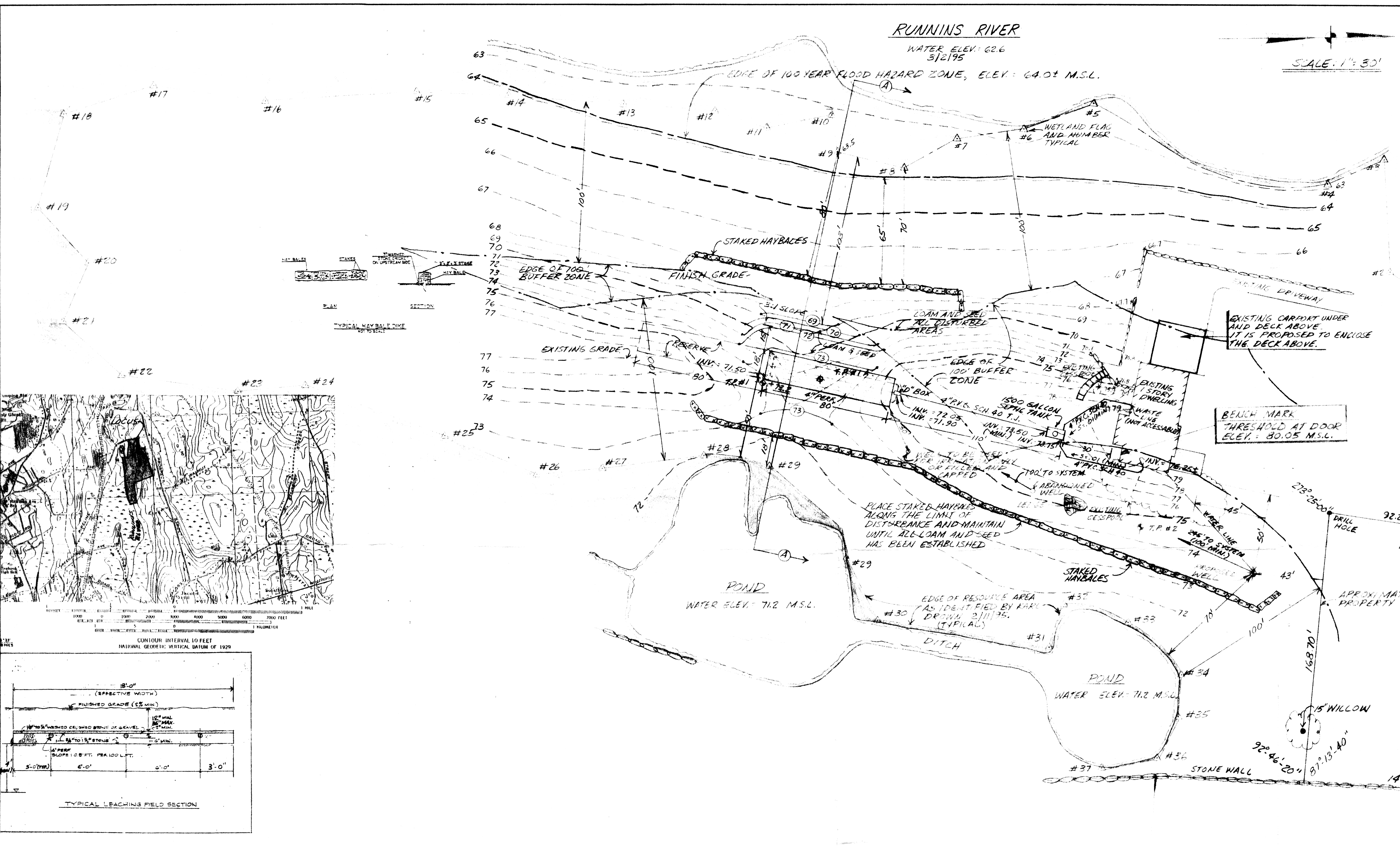

FLAT 22 LOT 2 ZONE R-4 AREA 32.34 ACRES

**SITE PLAN**  
 WILLIAM and CYNTHIA MASON  
 501 WOODWARD AVENUE  
 SEEKONK, MASSACHUSETTS

**CAPUTO AND WICK LTD.**  
 1150 PAWTUCKET AVE  
 RUMFORD, R.I. 02916  
 401-434-8880

DATE: 3/9/95  
 REV: 6/23/95  
 SHEET: 1 OF 1