

LOCATION MAP

1000 0 1000 2000 3000

FALL RIVER AVENUE (U.S. ROUTE 6)

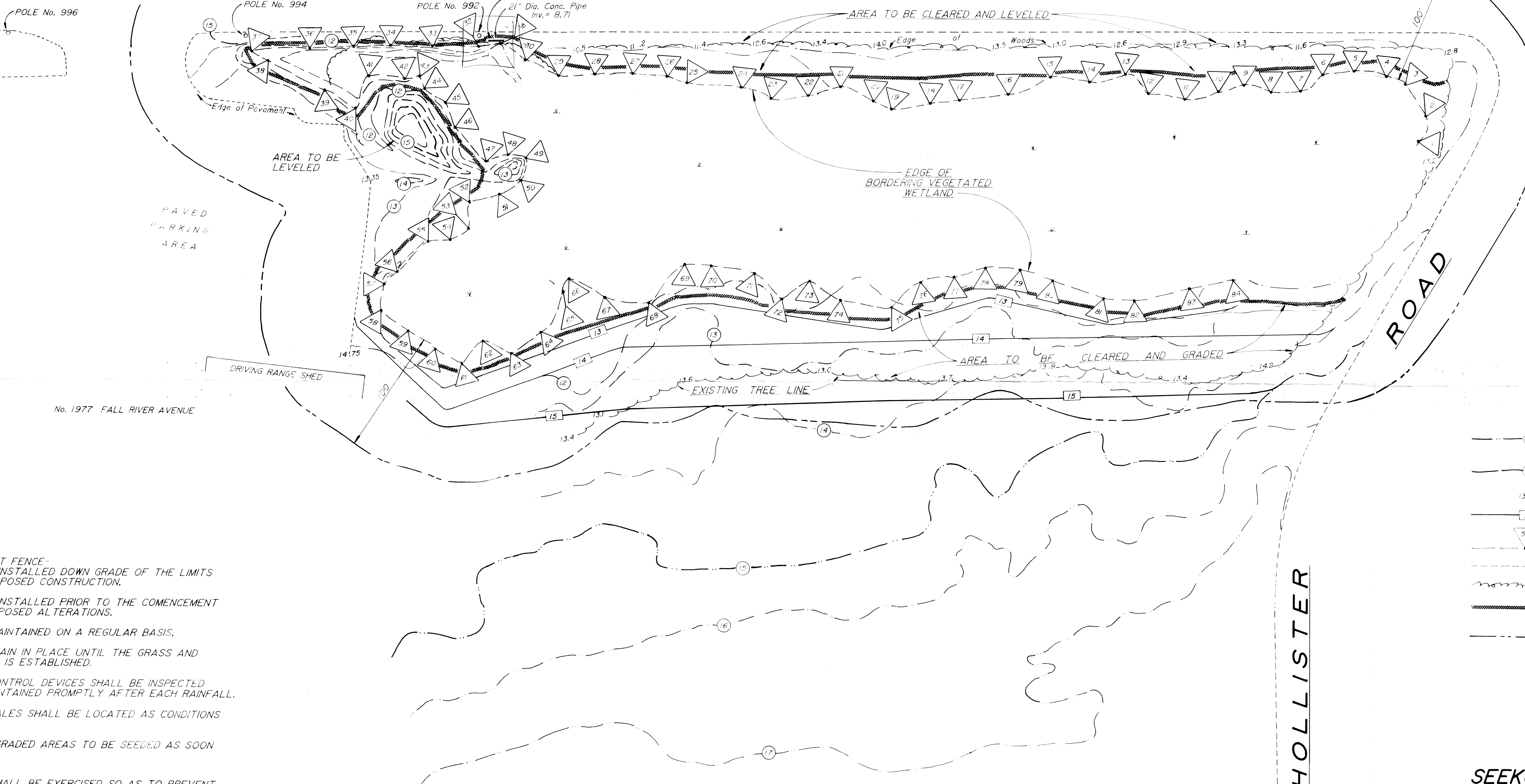

GENERAL NOTES:

1. HAY BALES OR SILT FENCE-
 - A. ARE TO BE INSTALLED DOWN GRADE OF THE LIMITS OF ANY PROPOSED CONSTRUCTION.
 - B. ARE TO BE INSTALLED PRIOR TO THE COMMENCEMENT OF THE PROPOSED ALTERATIONS.
 - C. SHALL BE MAINTAINED ON A REGULAR BASIS.
 - D. ARE TO REMAIN IN PLACE UNTIL THE GRASS AND VEGETATION IS ESTABLISHED.
2. SEDIMENTATION CONTROL DEVICES SHALL BE INSPECTED CLOSELY AND MAINTAINED PROMPTLY AFTER EACH RAINFALL.
3. ADDITIONAL HAY BALES SHALL BE LOCATED AS CONDITIONS WARRANT.
4. ALL FILLED AND GRADED AREAS TO BE SEEDED AS SOON AS PRACTICABLE.
5. EXTREME CARE SHALL BE EXERCISED SO AS TO PREVENT UNSUITABLE MATERIAL FROM ENTERING THE WETLANDS.

NOTES:

BASE OF ELEVATIONS IS NATIONAL GEODETIC VERTICAL DATUM OF 1929 (NGVD 1229).

WETLAND FLAGGING WAS PERFORMED BY NATURAL RESOURCE SERVICES, INC.

THIS SITE IS NOT WITHIN THE REACH OF THE HUNDRED YEAR FREQUENCY STORM, BASED ON THE NATIONAL FLOOD INSURANCE PROGRAM - FIRM (FLOOD INSURANCE RATE MAP) FOR THE TOWN OF SEEKONK, MASSACHUSETTS, PANEL 5 OF 10 DATED SEPTEMBER 5, 1979.

PROPERTY BEING SHOWN ON ASSESSOR PLAT 1 AS LOT 32.

LEGEND:

- EXISTING CONTOURS FROM AERIAL MAPPING
- EXISTING CONTOURS FROM ON-SITE SURVEY
- EXISTING SPOT ELEVATIONS
- PROPOSED CONTOURS
- FLAG LOCATION - EDGE OF BORDERING VEGETATED WETLAND
- EDGE OF PAVEMENT
- EDGE OF WOODED AREA
- HAY BALES OR SILT FENCE LIMIT OF VEGETATIVE CLEARING
- 100 FOOT BUFFER ZONE

SEEKONK DRIVING RANGE TOPOGRAPHICAL SURVEY

SEEKONK, MASSACHUSETTS

CUDDIGAN REALTY, INC.

PREPARED BY STANLEY ENGINEERING, INC. 33 ALEXANDER AVENUE EAST PROVIDENCE, R.I. 02914

SCALE: 1"=50'

DECEMBER, 1994

