

BY

STANLEY ENGINEERING, INC.

SCALE: 1" = 80' OCTOBER, 1973

NOTE

Topographical information taken from
piano-filled Type Survey in Seabrook, Mass.
for Tom McHale by Waterman Engineering Co.
April, 1965

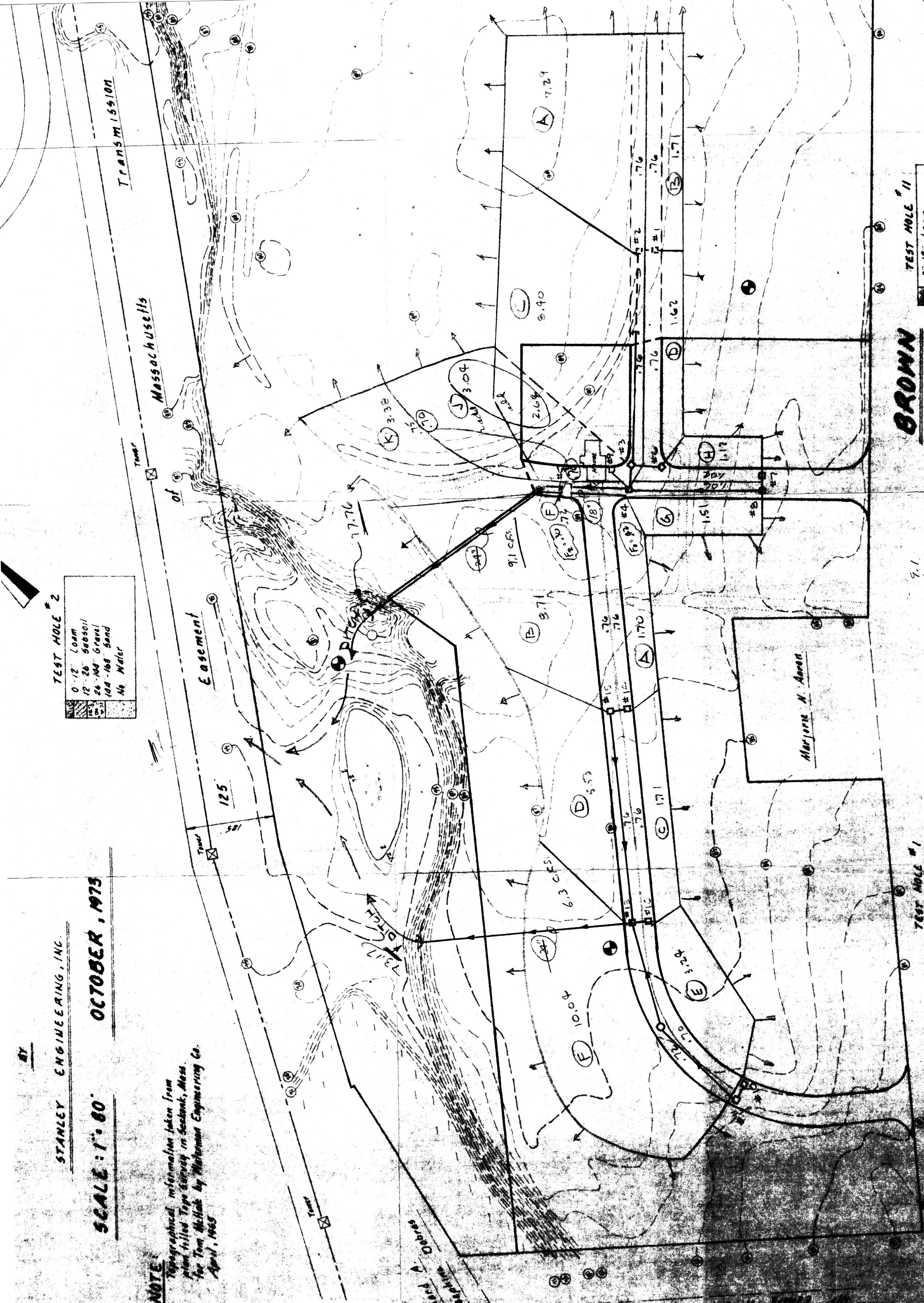

TEST HOLE # 2

| | |
|---------|----------|
| 0-12" | Loam |
| 12-26" | Sandsoil |
| 26-44" | Gravel |
| 44-108" | Sand |
| No | Water |

TEST HOLE # 11

| | |
|----------|-----------|
| 0-12" | Loam |
| 12-22" | Sandsoil |
| 22-47" | Sand silt |
| 47-108" | Gravel |
| 108-140" | Sand |

9.1
6.3
15.4 C.F.S.
3.9
19.3 C.F.S.

overhead

TEST HOLE # 1

| | |
|---------|----------|
| 0-8" | Loam |
| 8-12" | Sandsoil |
| 12-44" | Gravel |
| 44-108" | Sand |
| No | Water |

BROWN