

T:\GIS\XMEMPCO\PipelineRepairs\SEEKONK\SEEKONK\_WRAP.mxd

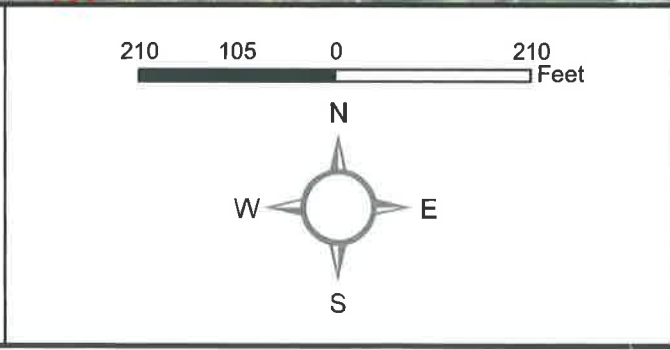

Legend	
	Pipeline
	Pipeline Easement
	Stream
	100-Foot BVW Buffer Zone
	100-Foot Bank Buffer Zone
	Limits to 200-Foot River Front Area (RFA)
	Shrub Swamp
	Wooded Swamp
	Shallow Marsh
	FEMA 500 Year Flood Zone
	Proposed Work Area

**Notes**  
 All features shown are approximate.  
 The MassDEP Priority Resource (21E) Map MassGIS Data Viewer (<http://www.mass.gov/mgis/mapping.htm>) was reviewed in order to identify resource areas in proximity to the proposed work area.  
 Sources:  
 1) Topographic and aerial images were obtained from Massachusetts GIS website at <http://www.mass.gov/mgis/>



Title:			
<b>PROPOSED WORK AREA</b>			
<b>STATION IDS: 388+00 TO 394+00</b>			
69-736			
E. PROVIDENCE TO SPRINGFIELD PRODUCTS E. PROVIDENCE - DOUGLAS S-243-1			
Prepared For:			
<b>ExxonMobil Pipeline Company</b>			
 ROUX ASSOCIATES, INC. Environmental Consulting & Management	Compiled By: CW	Date: 7/30/12	FIGURE <b>2</b>
	Prepared By: CC	Scale: AS SHOWN	
	Project Mgr.: IR	Office: MA	
	File No.: SEEK_WRAP	Project: 0172_0221M004	