

NOTES:

1. NEW MEASUREMENTS ARE BASED ON FIELD REVIEW CONDUCTED SEPTEMBER 9, 2002 BY CAPUTO AND WICK LTD. REVISED WETLAND RESOURCE AREA LOCATIONS ARE BASED ON SAID SITE VISIT.
2. BASE DRAWING IS TAKEN FROM PLAN PREPARED BY MILLER ENGINEERING, 21 BROOK STREET, SEEKONK, MA AND TITLED "NOTICE OF INTENT, LOTS 462 AND 463 SAGAMORE ROAD, SEEKONK, MA. PREPARED FOR CLAUDIO & MARIA AMARAL, 109 NORWOOD AVENUE, CRANSTON, RI 02905" AND DATED DECEMBER 18, 2000. PLAN WAS STAMPED RECEIVED BY THE TOWN OF SEEKONK CONSERVATION COMMISSION FEBRUARY 5, 2001.
3. WETLANDS LOCATED ON LOT 463 WERE NOT REVIEWED BY CAPUTO AND WICK LTD.

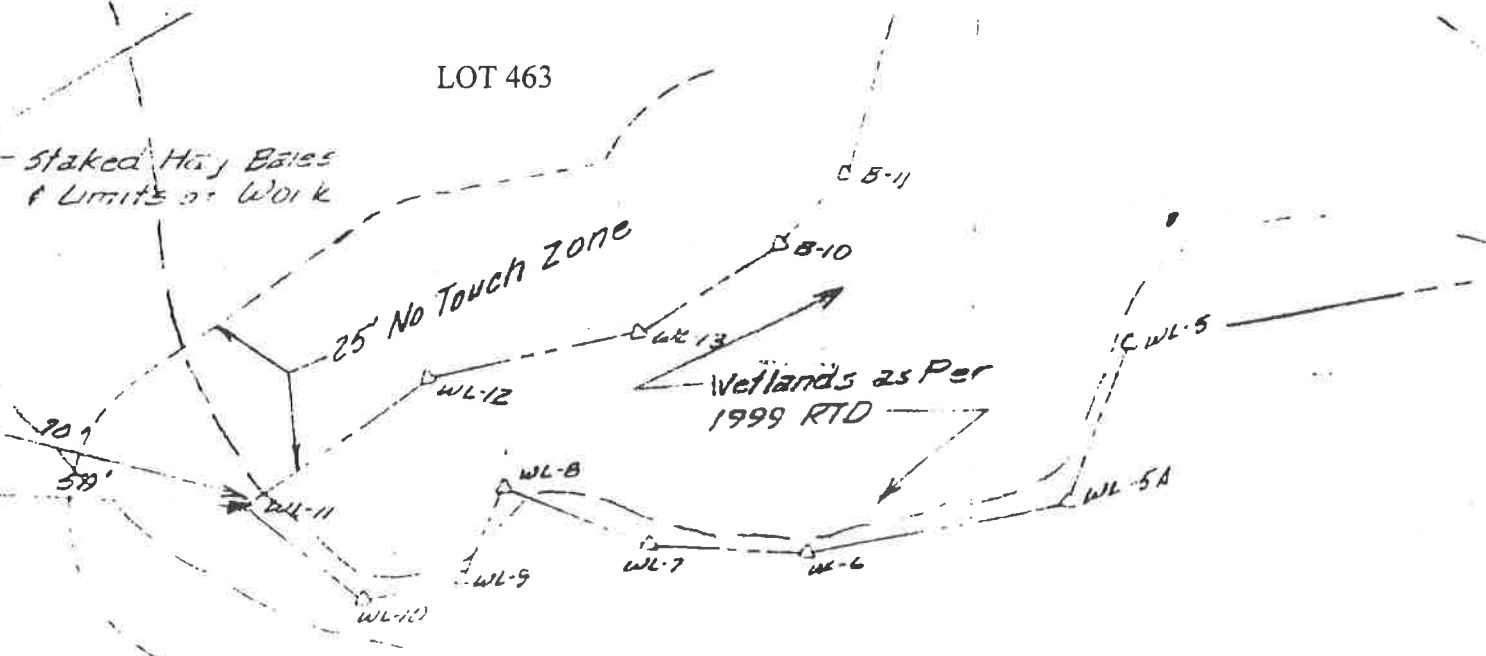

SKETCH OF EXISTING CONDITIONS & WETLAND RESOURCE AREAS

AP 6, LOT 462
155 SAGAMORE ROAD
SEEKONK, MA

69-456

SCALE: 1" = 30'

AMENDED DECEMBER 2002
CAPUTO AND WICK LTD.

Sagamore Road