

**INVERTS**

OUT-HOUSE	33.25
INTO TANK	33.15
OUT. TANK	32.90
INTO D-BOX	32.85
OUT. D-BOX	32.70
END TRENCH	32.50
G.W. ± 27.0 ± 10' ± 28.00	

ASSUMPTION: FILE NO. 4  
 271 43.255 2410 P.M.  
 AREA: 8.10 ACRES

**SEWAGE DISPOSAL DATA**

3 BEDROOMS = 495 G.P.D. (PCR. RATE) 2 MIN. L.I.C.H.  
 USE 90 L.F. OF TRENCH 36" WIDE WITH 6" OF STONE BELOW  
 SIDE 90" x 2 SIDES x 0.5 = 225 GALS PER L.F. = 225 GALS  
 BOTTOM: 30" x 36" WIDE x 1.0 GALS PER L.F. = 270 GALS  
 TOTAL = 495 GALS

STEP ALL TOP & SUBSOIL & ALL HARD COMPACTED SAND  
 IN THE AREA OF THE SITES #1 & 25 BEYOND & REPLACE  
 WITH CLEAN GRAVEL.

**TEST PIT NO. 1**

310	4" TOPSOIL
	12" SUBSOIL
WATER 4'-0"	12" HARD COMP. SAND
	24" CRSE. SAND
	36" FINE SAND
ELEV. 27.00	
ELEV. 28.00 (WATER)	

TEST PITS 4/28/86  
 WITNESS: M. NELLO

**TEST PIT NO. 2**

303	4" TOPSOIL
	24" SANDY SUBSOIL
WATER 3'-8"	
	60" FINE MED. SAND
ELEV. 26.6	
ELEV. 27.6 (WATER)	

- NOTES**
- THIS LAND IS NOT BOUNDARY OF THE FIELD AS INDICATED BY THE FENCED IN PLANCE MAP OF THE TOWN OF SEEKONK. (FILE NO. 150069 0000 A)
  - DO NOT USE ANY TOOLS DISTURBED BY TOWN
  - DO NOT TAKE ANY BARRIERS TO CONSTRUCTION
  - MAINTAIN IN PLACE UNTIL CONSTRUCTION IS COMPLETED & FILL & CELL HAS STABILIZED

**NOTE:**  
 THE EXISTING GRAVEL DRIVE & TWIN 24" CULVERTS WERE CONSTRUCTED UNDER A VALID ORDER OF CONDITIONS ISSUED BY THE SEEKONK CONSERVATION COMMISSION DATED AUG. 28, 1986. (FILE NO. SE 69-114)

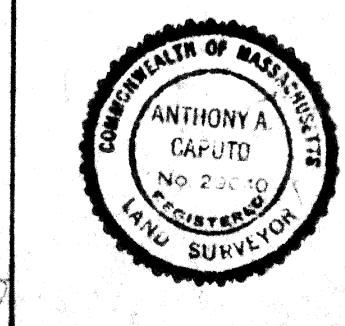
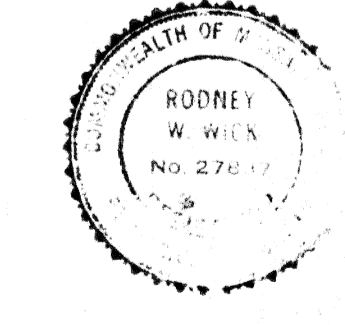
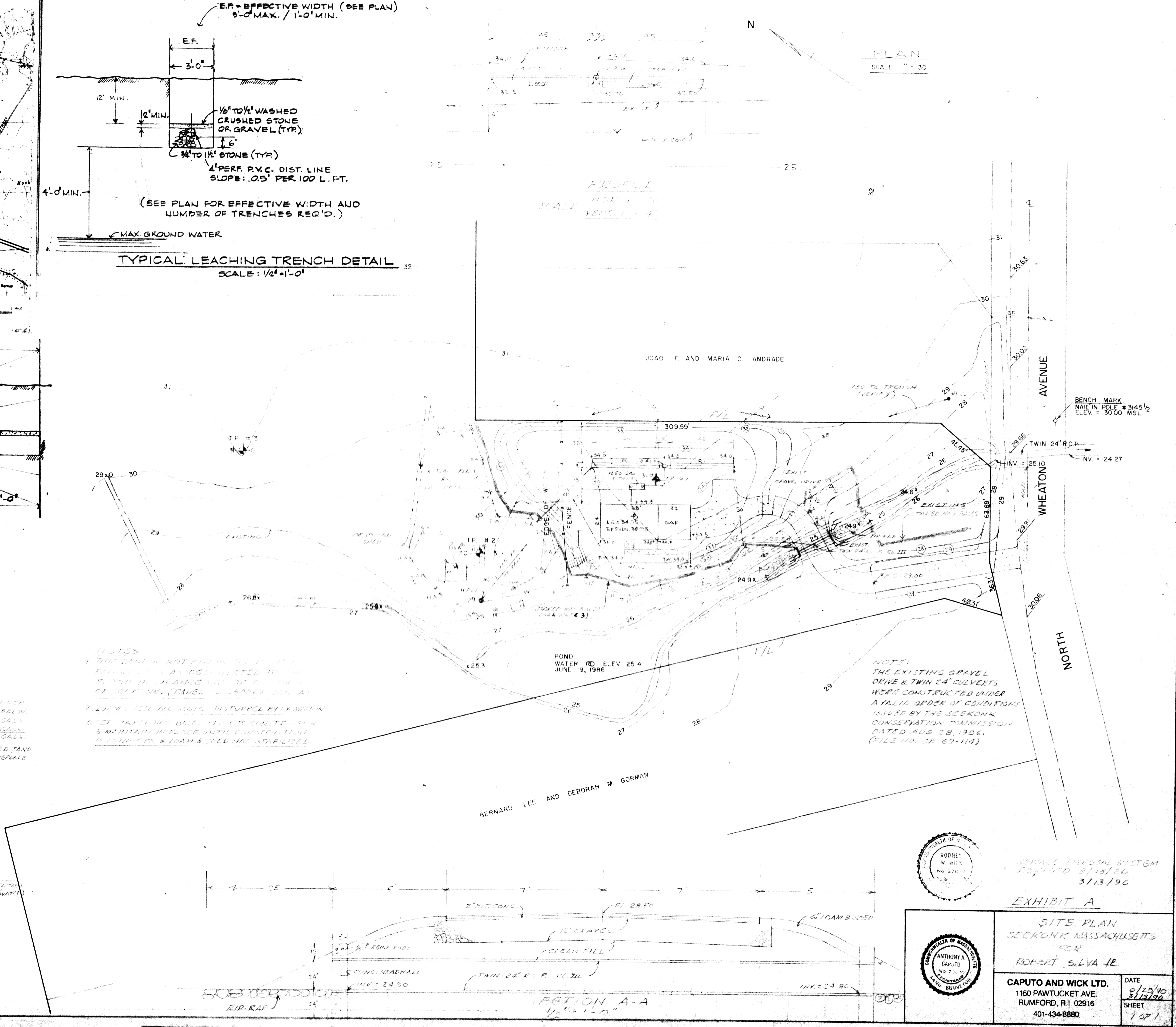

SEWAGE DISPOSAL SYSTEM  
 DESIGNED 2/15/86  
 3/13/90

**EXHIBIT A**

SITE PLAN  
 SEEKONK MASSACHUSETTS  
 FOR  
 ROBERT SILVA JR.

**CAPUTO AND WICK LTD.**  
 1150 PAWTUCKET AVE.  
 RUMFORD, R.I. 02916  
 401-434-8880

DATE: 6/28/90  
 3/13/90  
 SHEET: 1 OF 1