

APPLICANT:
 Manoel DaSilva
 200 Post Road
 Warwick, R.I. 02888

INVERT		SCHEDULE			
No.	Invert	Location	No.	Invert	Location
1	90.92	at Dwelling	4	89.95	into Dist. Box
2	90.82	into Tank	5	89.78	out Dist. Box
3	90.57	out Tank	6	89.68	Begin Trench
			7	89.50	End Trench
			8		Distribution Box
			9		1500 Gal. Septic Tank

John Small, Jr.
 Lot 641 on Assessors Plat 24

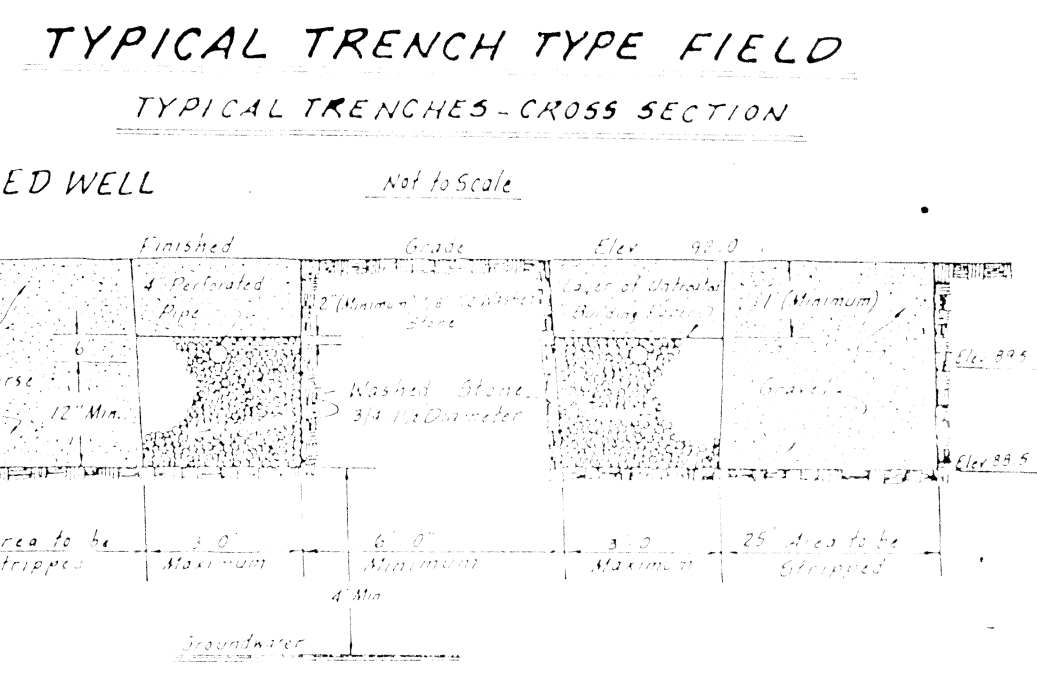
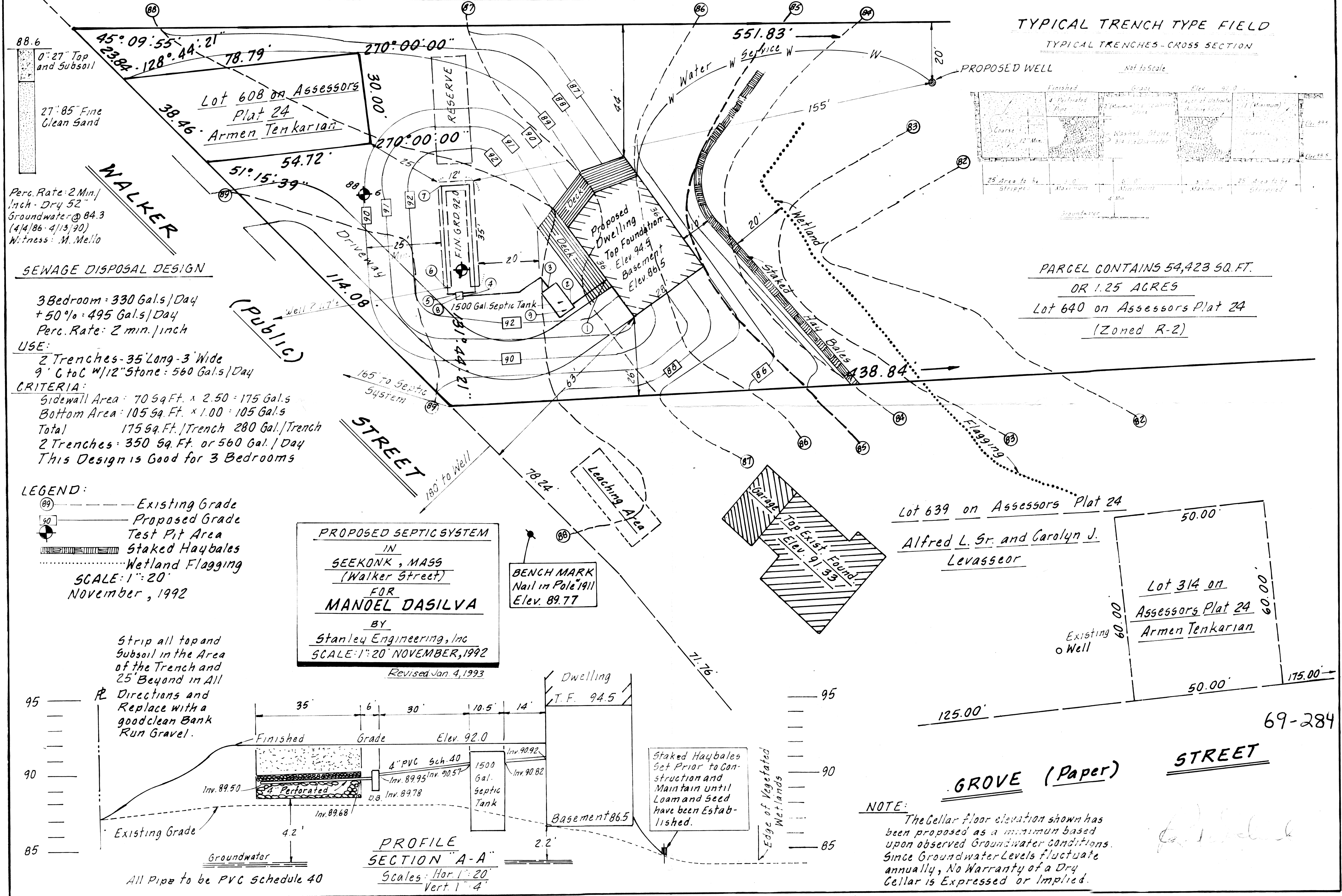
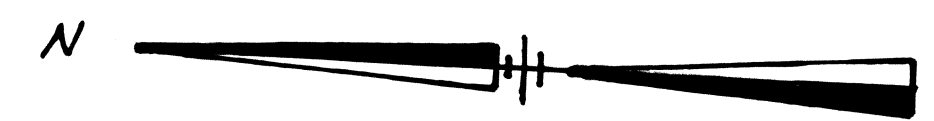

PARCEL CONTAINS 54,423 SQ. FT.
 OR 1.25 ACRES
 Lot 640 on Assessors Plat 24
 (Zoned R-2)

SEWAGE DISPOSAL DESIGN

3 Bedroom = 330 Gals./Day
 + 50% = 495 Gals./Day
 Perc. Rate: 2 min./inch

USE:
 2 Trenches - 35' Long - 3' Wide
 9" C to C w/ 12" Stone = 560 Gals./Day

CRITERIA:
 Sidewall Area: 70 Sq. Ft. x 2.50 = 175 Gal.s
 Bottom Area: 105 Sq. Ft. x 1.00 = 105 Gal.s
 Total: 175 Sq. Ft./Trench = 280 Gal./Trench
 2 Trenches = 350 Sq. Ft. or 560 Gal./Day
 This Design is Good for 3 Bedrooms

LEGEND:
 --- Existing Grade
 --- Proposed Grade
 [Symbol] Test Pit Area
 [Symbol] Staked Haybales
 [Symbol] Wetland Flagging
 SCALE: 1" = 20'
 November, 1992

PROPOSED SEPTIC SYSTEM
 IN
 SEEKONK, MASS
 (Walker Street)
 FOR
MANOEL DASILVA
 BY
 Stanley Engineering, Inc
 SCALE: 1" = 20' NOVEMBER, 1992
 Revised Jan 4, 1993

BENCHMARK
 Nail in Pole 1911
 Elev. 89.77

Strip all top and subsoil in the Area of the Trench and 25' Beyond in All Directions and Replace with a good clean Bank Run Gravel.

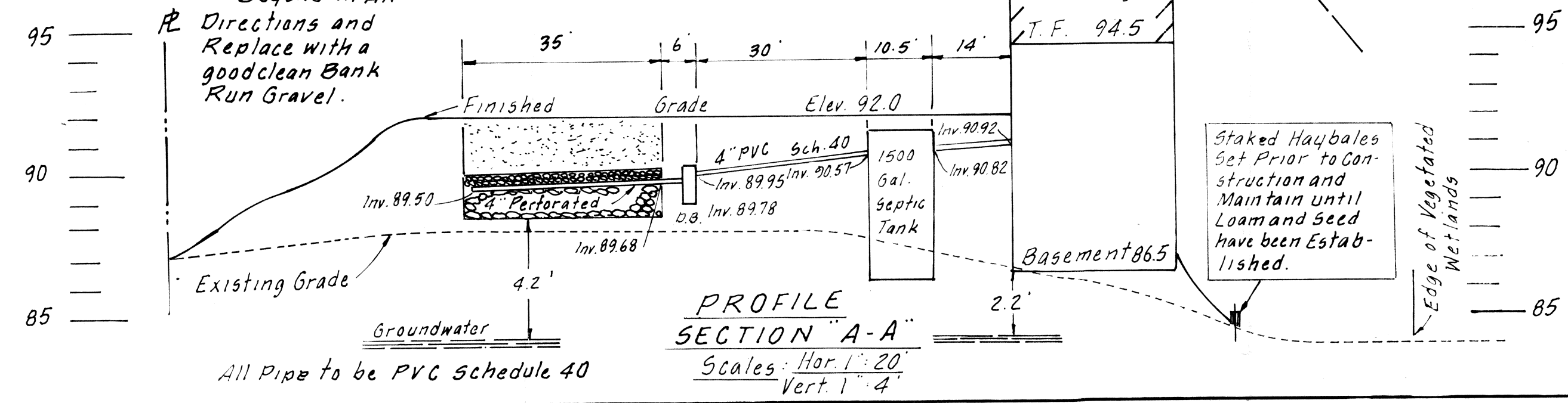

Staked Haybales Set Prior to Construction and Maintain until Loam and Seed have been Established.

NOTE:
 The Cellar floor elevation shown has been proposed as a minimum based upon observed Groundwater conditions. Since Groundwater Levels fluctuate annually, No Warranty of a Dry Cellar is Expressed or Implied.

GROVE (Paper)

STREET

69-284