

- 1) TO REDUCE DISTANCE S.A.S. TO FOUNDATION FROM 20' TO 7' PER 510 CMR 15.405(1)(2).
- 2) TO REDUCE DISTANCE S.A.S. TO LOT LINE FROM 10' TO 5' PER 510 CMR 15.405(1)(2).
- 3) TO REDUCE DISTANCE S.A.S. OVER WATER (RUST) FROM 1' TO 5' PER 510 CMR 15.405(1)(1)(2).

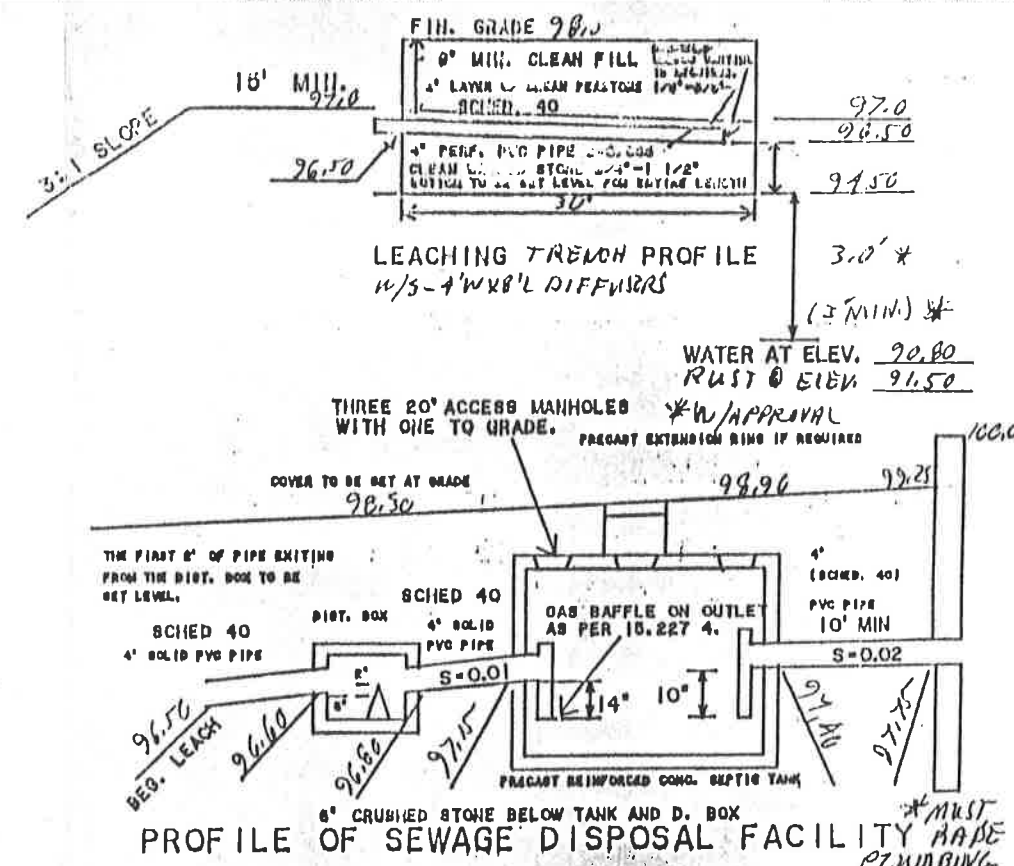
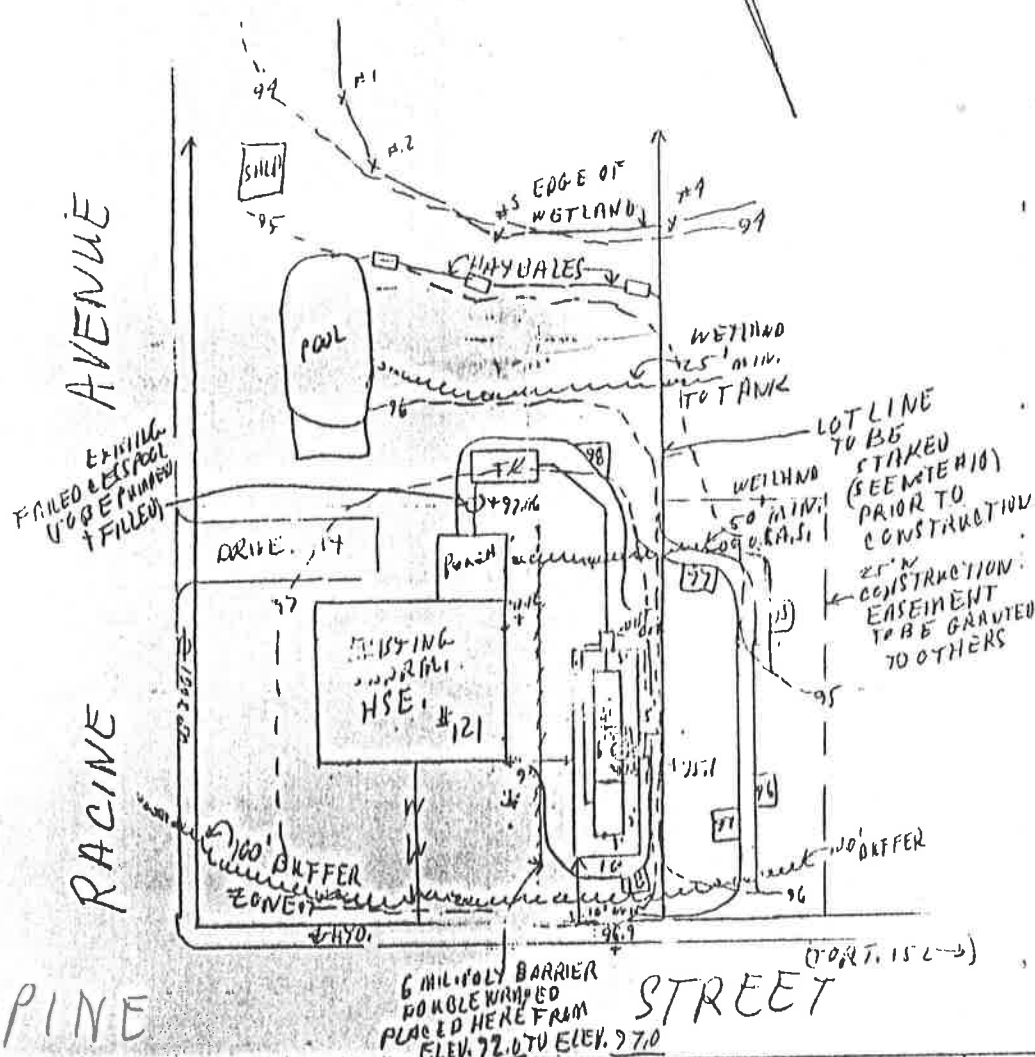

1-30248 W/2" DRAINAGE W/3" DIFFUSERS  
3 BED. X 110 GAL/BED = 330 GPD  
BOT. 300 SF. X 0.75" = 222 GAL  
SIDE 160 SF. X 0.75" = 118.4 GAL  
460 SF. 390.4 GAL

PROVIDED

D. BOX: 5 OUTLETS WITH BAFFLE  
SEPTIC TANK: GALLONS = 1500  
TANK TO HAVE 3-20" ACCESS  
COVERS AND ONE BROUGHT TO GRADE

SITE PREPARATION NOTES:  
(CHECK IF APPLICABLE)

TOP, SUBSOIL AND OTHER  
DELETERIOUS MATERIALS III,  
AND WITHIN 5 FEET OF THE  
LEACH SYSTEM ARE TO BE  
REMOVED PRIOR TO  
CONSTRUCTION AND REPLACED  
WITH SUITABLE MATERIAL AS  
REQUIRED UNDER SECTION  
15.250 OF TITLE V. STRIP TO  
ELEV. 86.50 & ANV. REPH. TO  
ELEV. 87.0 WITH 2" MPI  
MATERIAL AS NEEDED

LEGEND:  
PERCOLATION TEST  $\square \oplus$   
TEST HOLE  $\square$   
EXISTING CONTOUR -100-  
PROPOSED CONTOUR -100-

CONSTRUCTION NOTES:  
1. ALL WORK SHALL CONFORM TO 310 CMR 15.00 STATE ENVIRONMENTAL CODE TITLE 8 RULES AND REGULATIONS ESTABLISHING MINIMUM STANDARDS RELATING TO LOCATION, DESIGN, CONSTRUCTION AND MAINTENANCE OF INDIVIDUAL SEWAGE DISPOSAL SYSTEMS AS OF THE LATEST AMENDMENT AND WITH THE REGULATIONS OF THE SEEKONK BOARD OF HEALTH.

2. THERE ARE NO KNOWN WELLS WITHIN 100' OF THE PROPOSED SEEPAGE FIELD; THERE ARE NO KNOWN CDS FOUND WITHIN 100'.

3. THE INSTALLER SHALL VERIFY ALL ELEVATIONS AND DIMENSIONS PRIOR TO STARTING WORK. THE INSTALLER SHALL NOTIFY THE ENGINEER OF ANY DEVIATIONS FROM THE PLANS IN WRITING 10 DAYS BEFORE BEGINNING WORK.

4. MINIMUM DISTANCE FROM EDGE OF SEEPAGE FIELD TO PRESSURE WATER LINE = 10' AND 100' FROM A WELL.

5. CARE SHALL BE TAKEN TO ASSURE THAT THE SOIL AT THE BOTTOM OF THE EXCAVATION IS NOT COMPACTED OR BREARED.

6. SUB-SURFACE DRAINS, FOUNDATION DRAINS AND STORM DRAINS SHALL BE 5' MINIMUM FROM THE SEPTIC TANK, 10' FROM THE SEEPAGE FIELD.

7. IT IS THE RESPONSIBILITY OF THE INSTALLER TO CONTACT THE ENGINEER 24 HOURS PRIOR TO BACKFILLING OF ANY PART OF THE SEPTIC SYSTEM SO THAT AN AS-BUILT CAN BE OBTAINED FOR THE BOARD OF HEALTH.

8. NO PERMANENT STRUCTURE MAY BE CONSTRUCTED OVER 100% EXPANSION AREA.

9. DROWN ENVIRONMENTAL SERVICES WILL NOT BE RESPONSIBLE FOR THE PERFORMANCE OF THE SYSTEM UNLESS CONSTRUCTED AS SHOWN. ANY ALTERATIONS MUST BE APPROVED IN WRITING BY DROWN.

10. LOT LINES SHALL BE VERIFIED BY A REGISTERED LAND SURVEYOR.

11. TIGHT JOINT PIPING TO CONSIST OF POLYVINYL CHLORIDE PIPE (P.V.C.) SCHEDULE 40 UNLESS OTHERWISE NOTED.

\*MUST HAVE PLUMBING CONNECT ALL PLUMBING TO NEW TANK

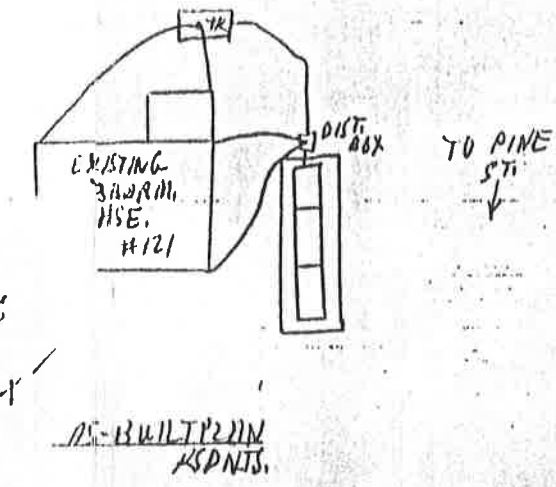

ELEV. 'S & INV. 'S	PROPOSED	AS-BUILT	TEST PIT NO. 1	TEST PIT NO. 2	TEST PIT NO. 3	PERCOLATION TEST DATA
TOP OF FOUNDATION		100.0	0			DATE OF TEST
FINISHED BASEMENT FLOOR			48" FILL			5/24/00
INV. OF PIPE AT FND.	97.75		MIXED FILL			PERCOLATION RATE 3 MIN/IN CLASS I
INV. AT SEPTIC INLET	97.40		PERF. TUBES			ELEV. OF BOT. OF PERC TEST HOLE N/R
INV. AT SEPTIC OUTLET	97.15		SAND			
INV. AT D. BOX INLET	96.50		10YR15/S			
INV. AT D. BOX OUTLET	96.60					
INV. AT END OF PIPES	96.50					
ELEV. AT BOT. OF STONE	94.50					

CON. COM. APPROVAL KSD

REMOVE TO 13'

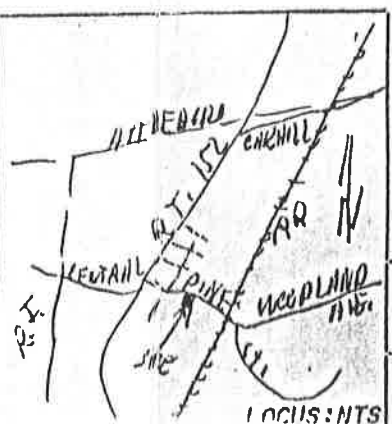

69-478 APPROVED

KARL S. DROWN No. 948 REGISTERED SANITARIAN

"REPAIR"

PROPOSED SEWAGE DISPOSAL SYSTEM  
121 PINE STREET

APPLICANT: MR. HALLAL  
121 PINE STREET  
SEEKONK, MA.

SCALE: 1"=20'

DRAWN BY: KSD

REVIEWED:

DATE: 6/11/00

APPROVED BY: KSD

JOB# 00-050R

LOT#

DROWN ENVIRONMENTAL SERVICES  
P.O. BOX 263  
REHOBOTH, MASSACHUSETTS 02789  
(508) 252-6274