

REQUEST FOR LOCAL SYSTEM UPGRADE
 1) TO REDUCE THE DISTANCE OF S.A.S. TO FOUNDATION FROM 20' TO 16' PER 310CMR 15.405(1)(d).

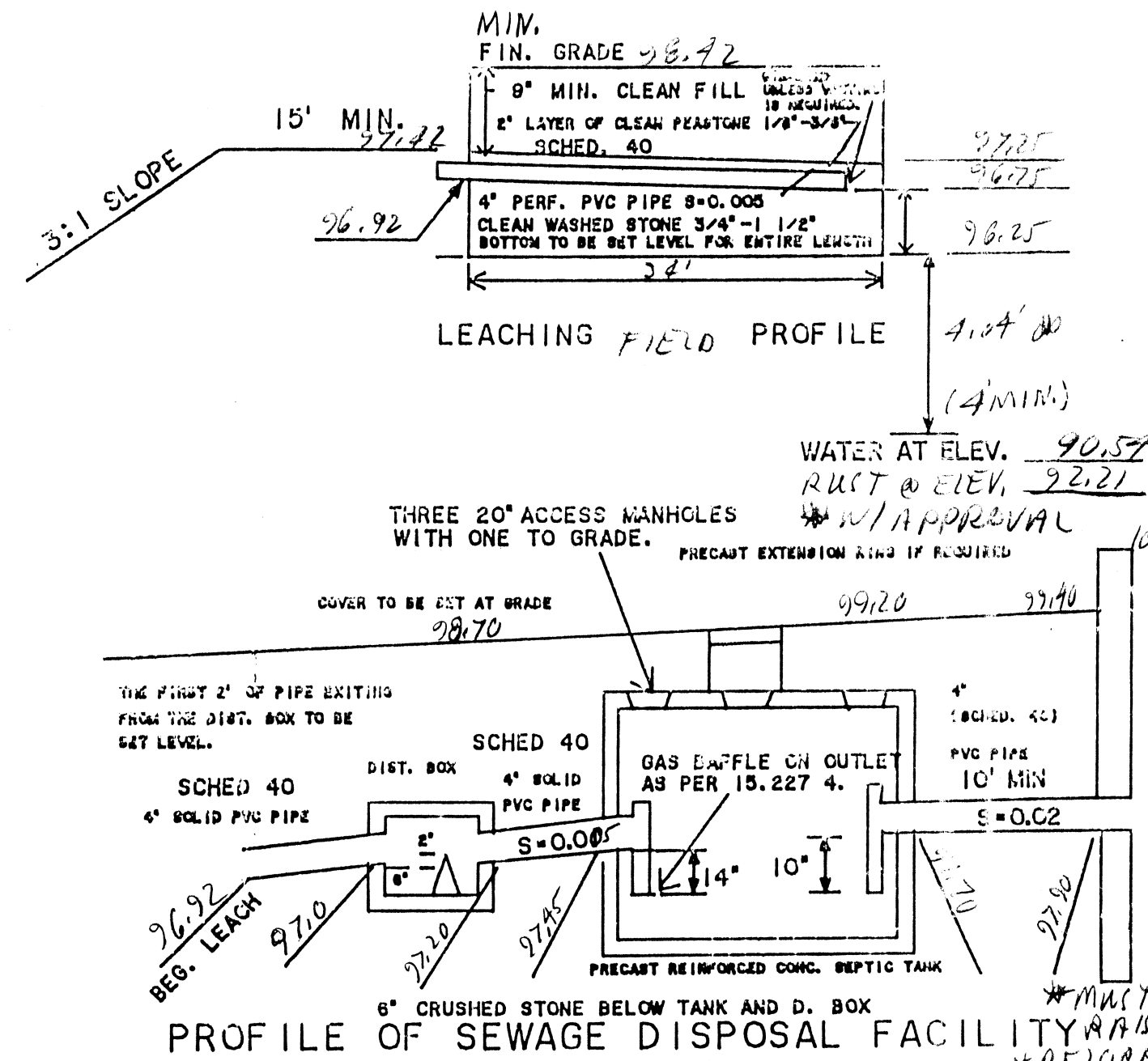
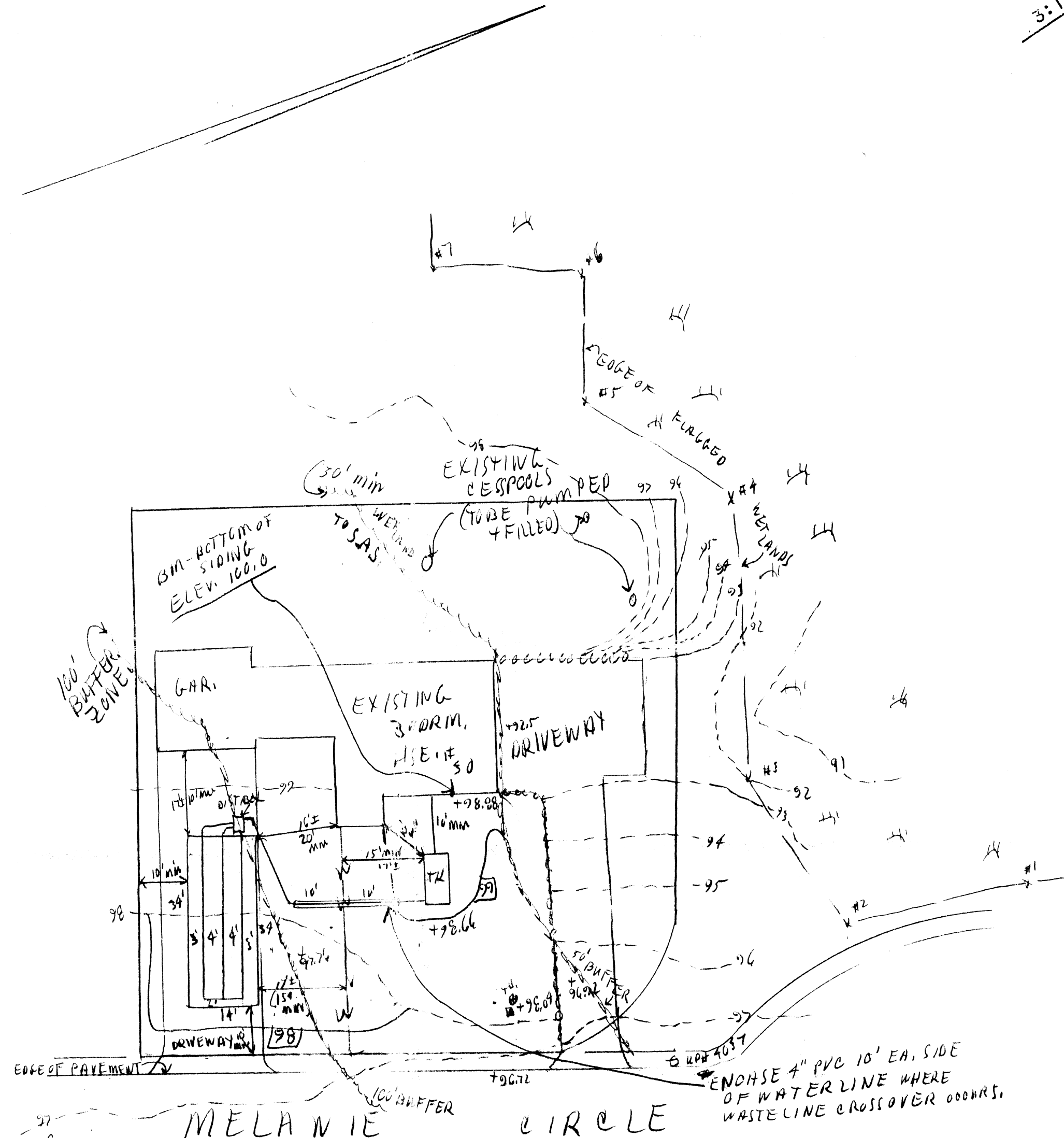

DESIGN CRITERIA: NO GARB. DISP. 1-34' x 14' x 10' FIELD 3 BED. X 110 GAL/BOX = 330 GPD BOT. 476.0 S.F. X 0.74 = 352.24 GAL

PROVIDED
 D. BOX: 5 OUTLETS WITH BAFFLE SEPTIC TANK: GALLONS = 1500 TANK TO HAVE 3-20' ACCESS COVERS AND ONE BROUGHT TO GRADE

SITE PREPARATION NOTES: (CHECK IF APPLICABLE)
 TOP, SUBSOIL AND OTHER DELETERIOUS MATERIALS IN, AND WITHIN 5 FEET OF THE LEACH SYSTEM ARE TO BE REMOVED PRIOR TO CONSTRUCTION AND REPLACED WITH SUITABLE MATERIAL AS REQUIRED UNDER SECTION 15.255 OF TITLE V. AS NEEDED

LEGEND:
 PERCOLATION TEST \oplus
 TEST HOLE \ominus
 EXISTING CONTOUR -100-
 PROPOSED CONTOUR -100-

CONSTRUCTION NOTES:
 1. ALL WORK SHALL CONFORM TO 310 CMR 15.00 STATE ENVIRONMENTAL CODE TITLE 5 RULES AND REGULATIONS ESTABLISHING MINIMUM STANDARDS RELATING TO LOCATION, DESIGN, CONSTRUCTION AND MAINTENANCE OF INDIVIDUAL SEWAGE DISPOSAL SYSTEMS AS OF THE LATEST AMENDMENT AND WITH THE REGULATIONS OF THE SEERONK BOARD OF HEALTH.

- THERE ARE NO KNOWN WELLS WITHIN 100' OF THE PROPOSED SEWAGE FIELD; THERE ARE NO KNOWN ISDS FOUND WITHIN 100'.
- THE INSTALLER SHALL VERIFY ALL ELEVATIONS AND DIMENSIONS PRIOR TO STARTING WORK. THE INSTALLER SHALL NOTIFY THE ENGINEER OF ANY DEVIATIONS FROM THE PLANS IN WRITING 10 DAYS BEFORE BEGINNING WORK.
- MINIMUM DISTANCE FROM EDGE OF SEWAGE FIELD TO PRESSURE WATER LINE = 10' AND 100' FROM A WELL.
- CARE SHALL BE TAKEN TO ASSURE THAT THE SOIL AT THE BOTTOM OF THE EXCAVATION IS NOT COMPACTED OR SWEALED.
- SUB-SURFACE DRAINS, FOUNDATION DRAINS AND STORM DRAINS SHALL BE 5' MINIMUM FROM THE SEPTIC TANK, 10' FROM THE SEWAGE FIELD.
- IT IS THE RESPONSIBILITY OF THE INSTALLER TO CONTACT THE ENGINEER 24 HOURS PRIOR TO BACKFILLING OF ANY PART OF THE SEPTIC SYSTEM SO THAT AN AS-BUILT CAN BE OBTAINED FOR THE BOARD OF HEALTH.
- NO PERMANENT STRUCTURE MAY BE CONSTRUCTED OVER 100% EXPANSION AREA D.R.S.A.S.
- DROWN ENVIRONMENTAL SERVICES WILL NOT BE RESPONSIBLE FOR THE PERFORMANCE OF THE SYSTEM UNLESS CONSTRUCTED AS SHOWN, ANY ALTERATIONS MUST BE APPROVED IN WRITING BY DROWN.
- LOT LINES SHALL BE VERIFIED BY A REGISTERED LAND SURVEYOR.
- TIGHT JOINT PIPING TO CONSIST OF POLYVINYL CHLORIDE PIPE (P.V.C.) SCHEDULE 40 UNLESS OTHERWISE NOTED.

ELEV. 'S & INV. 'S	PROPOSED	AS-BUILT	TEST PIT NO. 1	TEST PIT NO. 2	TEST PIT NO. 3	PERCOLATION TEST DATA
TOP OF FOUNDATION		100.10	0"			DATE OF TEST
FINISHED BASEMENT FLOOR			16			5/9/01
INV. OF PIPE AT FND.	97.90		2A			PERCOLATION RATE 2 MIN/IN CLASS I
INV. AT SEPTIC INLET	97.70					ELEV. OF BOT. OF PERC TEST HOLE 96.20
INV. AT SEPTIC OUTLET	97.45					
INV. AT D. BOX INLET	97.20					
INV. AT D. BOX OUTLET	97.0					
INV. AT END OF PIPES	96.75					
ELEV. AT BOT. OF STONE	96.25					

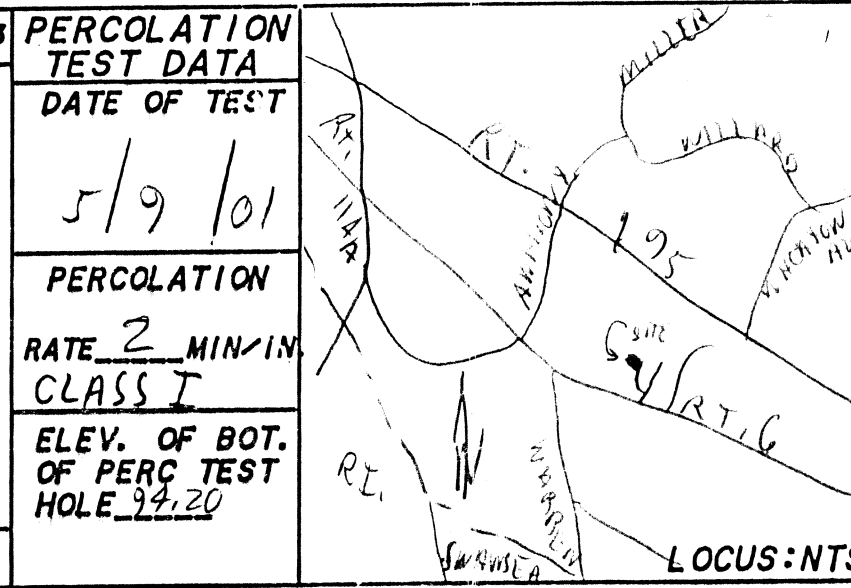

DROWN ENVIRONMENTAL SERVICES
 P. O. BOX 263
 REHOBOTH, MASSACHUSETTS 02769
 (508) 252-6274

PROPOSED SEWAGE DISPOSAL SYSTEM
 30 MELANIE CIRCLE

APPLICANT: MRS. FRANCES MARRAS
 SCALE: 1" = 20'
 DRAWN BY: KSD
 DATE: 7/25/01
 APPROVED BY: KSD
 JOB# 01-080R