

TRUE NORTH
BASED ON RTE. 136

11 square feet of replication
(excavated by hand)

EDGE OF WET LAND
(B.V.W.)

LEGEND:

- 115 Kv E-183E LINE
- 115 Kv F-184 LINE
- ⊗ EXISTING POLE
- PROPOSED POLE
- ≡≡≡ PROPOSED DOUBLE GUY
- ∇ WET LAND
- ▨ HAYBALE BARRIER (DOUBLE-STAKED)

NOTES:

1. INSTALL PROPOSED 35' NEW 3 POLES GUYED WOOD DEADEND STRUCTURE (#159A) ABOUT 26 FT OUTSIDE OF FENCE.
2. INSTALL PROPOSED NEW 35' 3 POLES GUYED WOOD DEADEND STRUCTURE (#3A) ABOUT 26 FT OUTSIDE OF FENCE.
3. Double-staked haybales to be installed at limit-of-work line prior to construction.

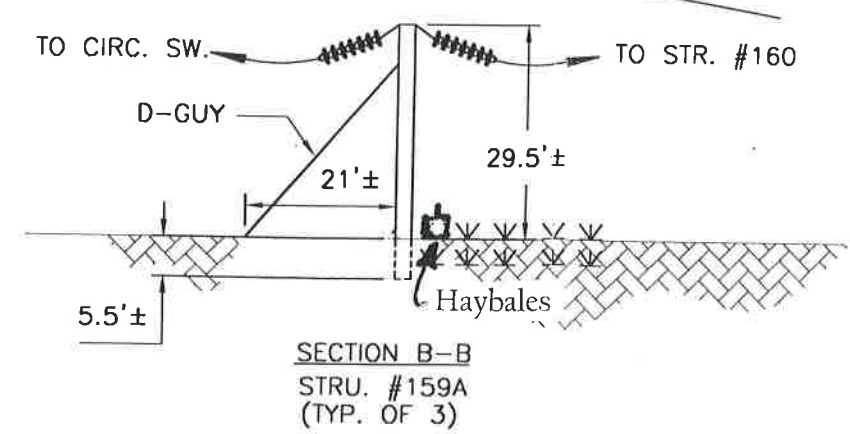
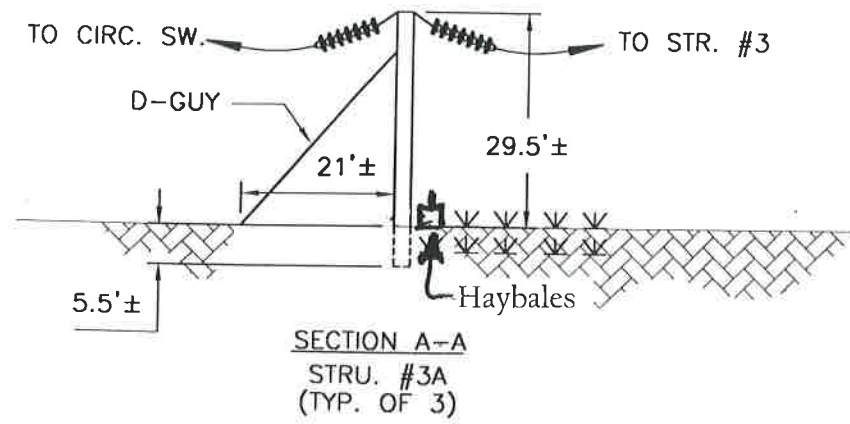
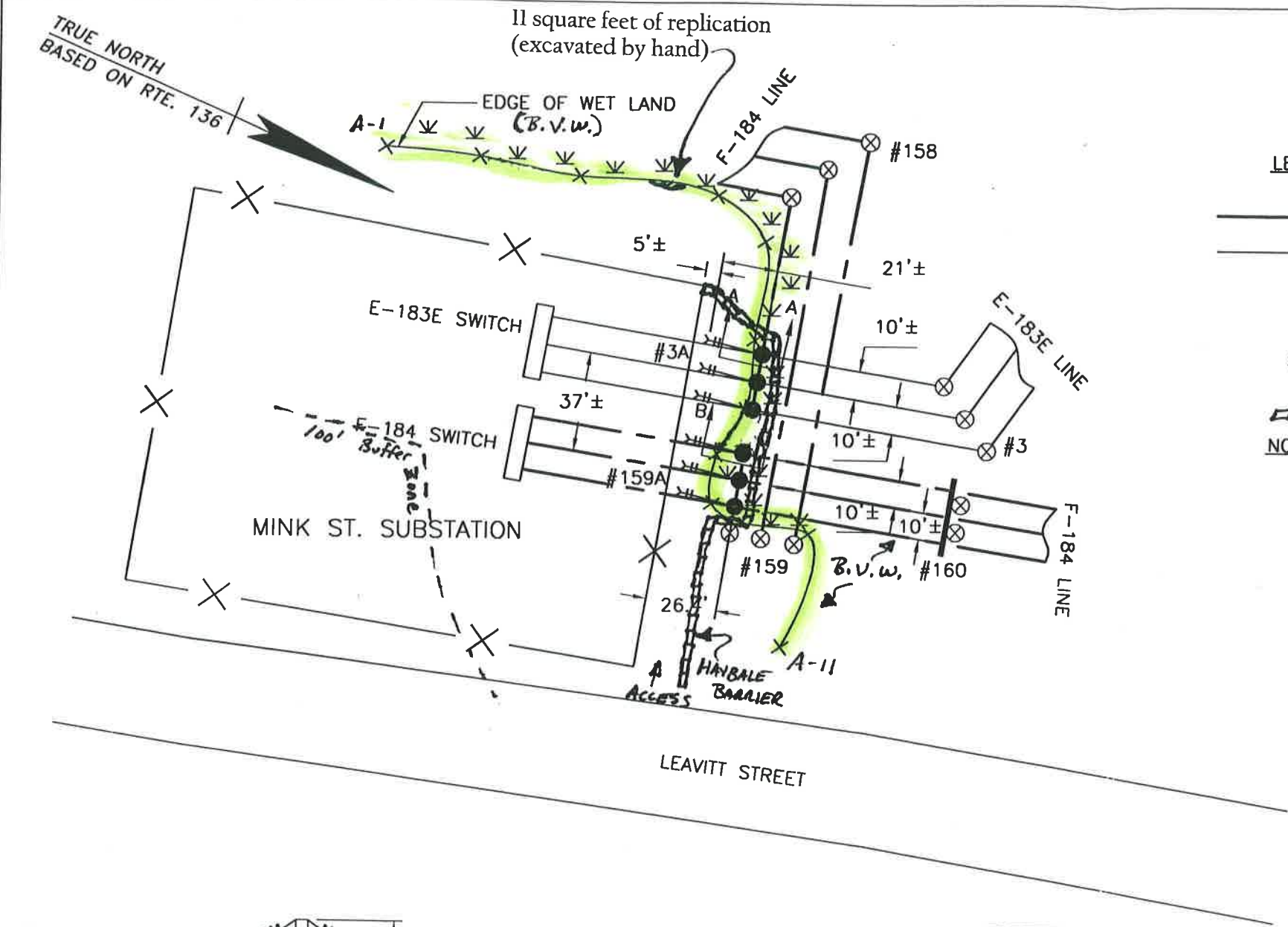

69-555

REF-T3688

R.G. Vanderweil Engineers, Inc.
274 Summer Street - Boston, MA 02210

Project	NEW ENGLAND POWER COMPANY MINK ST. SUBSTATION E-183E & F-184 LINES	Scale	1" = 50'
Title	PROPOSED STRUCTURES FOR S&C CIRCUIT SWITCHER 115 KV LINES	Date	9/29/04 *
		Number	SKE-1

* NOTES ADDED BY VES 10/21/04