

TOWN OF SEEKONK ZONING ORDINANCE Section 10. Site Plan Review. 10.6.3 Landscaping

Description	Required	Provided
Minimum perimeter landscaping required	10 feet around perimeter (25 feet adjacent to residential)	0 feet to 640 feet
Parking island size	10 feet x 36 feet at end of double rows	5 feet x 39 feet
Parking island landscaping	Landscaping required every other double row	Yes
Parking lot shade requirement	Shade trees 30 feet in diameter (706 sf) shading 30% of the parking area 30% of 371,500 sf = 111,450 sf / 706 = 158 trees required	81 provided (request relief for 77 trees)
Shrub size	3 feet minimum	2 to 4 feet depending on species
Dumpster, utility and storage area buffer	Planted buffer strip 3 sides	Yes

PLANT SCHEDULE - SITE

BIO-RETENTION TREES	CODE	QTY	BOTANICAL NAME / COMMON NAME	CONT	CAL	SIZE
	SJ	16	Sophora japonica / Japanese Pagoda Tree FAC	B & B		2.5' Cal
DECIDUOUS TREES	CODE	QTY	BOTANICAL NAME / COMMON NAME	CONT	CAL	SIZE
	GB	20	Ginkgo biloba 'Princeton Sentry'	B & B		2.5' Cal
	GS	5	Gleditsia triacanthos 'Skyline' / Skyline Honey Locust	B & B		3.5' Cal
	UP	16	Ulmus parvifolia / Chinese Elm	B & B		2' Cal
EVERGREEN TREES	CODE	QTY	BOTANICAL NAME / COMMON NAME	CONT	CAL	SIZE
	TOT5	5	Thuja occidentalis 'Techny' / Techny Arborvitae	B & B		5' - 6' HT.
FLOWERING TREES	CODE	QTY	BOTANICAL NAME / COMMON NAME	CONT	CAL	SIZE
	PS9	7	Prunus sargentii / Sargent Cherry	B & B		2.5' Cal
	SI	5	Syringa reticulata 'Ivory Silk' / Ivory Silk Japanese Tree Lilac	B & B		2' Cal
SHRUBS	CODE	QTY	BOTANICAL NAME / COMMON NAME	CONT	CAL	SIZE
	HA2	21	Hydrangea arborescens 'Annabelle' / Annabelle Smooth Hydrangea	5 gal		
	HFS	28	Hypericum frondosum 'Sunburst' / Sunburst Hypericum	3 gal		
	ICS3	8	Ilex crenata 'Steads' / Steeds Japanese Holly	B&B; 4-5 FT.		
	JCK2	25	Juniperus chinensis 'Kallays Compact' / Kallay Compact Pfitzer Juniper	24" - 36"		
	PA3	24	Potentilla fruticosa 'Abbotswood' / Abbotswood Potentilla	3 gal		
	SB2	12	Spiraea x bumalda 'Anthony Waterer' / Anthony Waterer Spiraea	5 gal		
GROUND COVERS	CODE	QTY	BOTANICAL NAME / COMMON NAME	CONT	CAL	SIZE
	CATT	74	Cotoneaster adpressus 'Tom Thumb' / Early Cotoneaster	1 gal @ 30" oc		

EXISTING TREE TO REMAIN
EXISTING TREE TO BE REMOVED

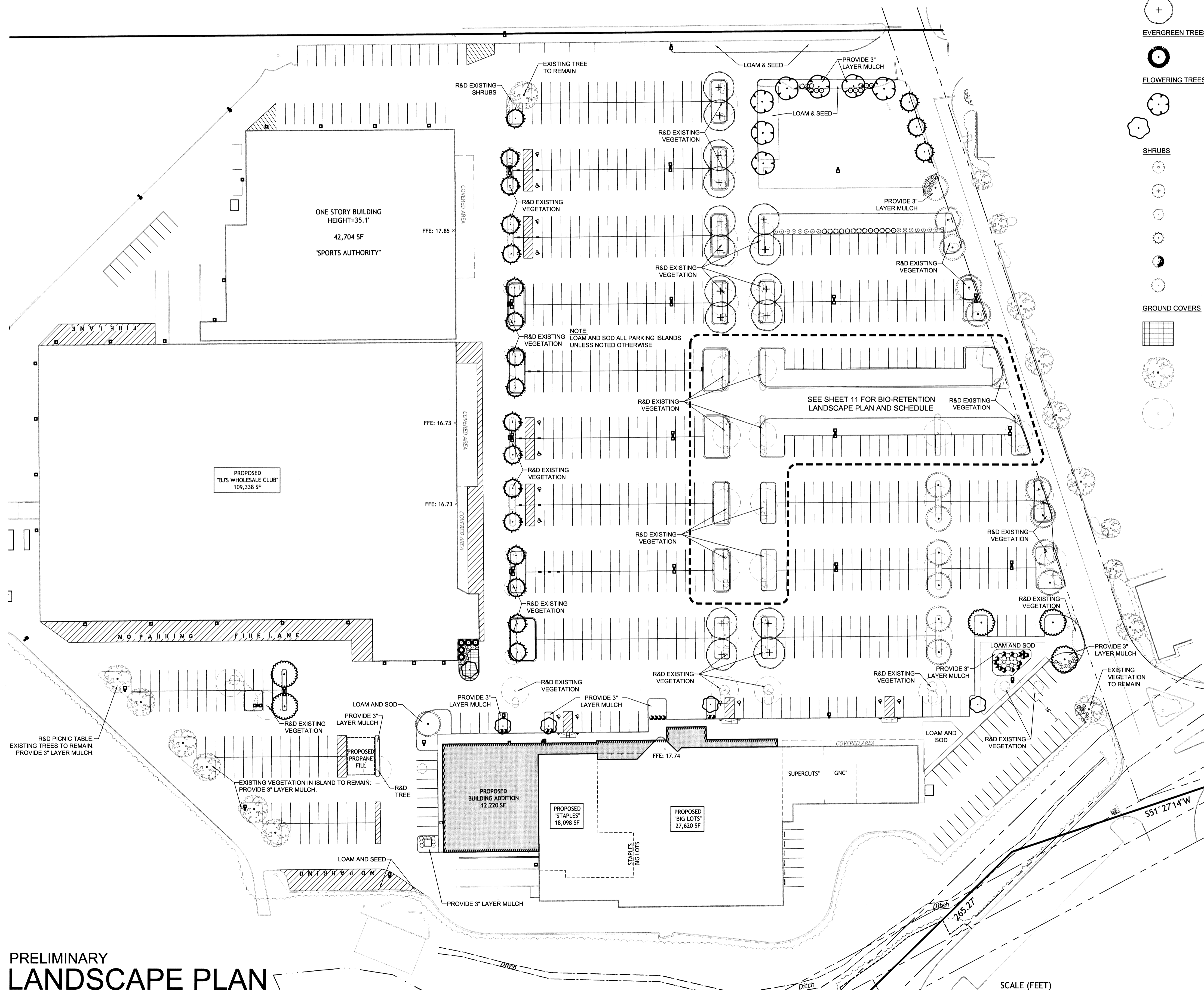

PRELIMINARY LANDSCAPE PLAN

1" = 50'

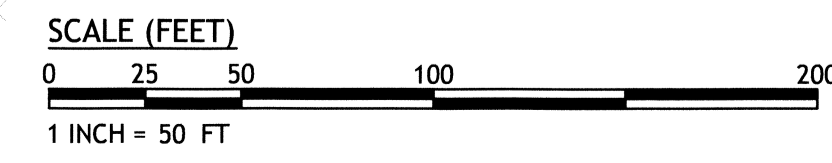

LANDSCAPE ARCHITECT:
DIANE C. SOULE & ASSOCIATES, ASLA
LANDSCAPE ARCHITECTURE • GRAPHICS • DESIGN
Smithfield, Rhode Island 401.231.0736 e-mail: diane@DCSA.ws
www.dianesouleandassociates.com

SEEKONK CROSSINGS
145-201 HIGHLAND AVENUE
SEEKONK, MASSACHUSETTS
AP 265, LOT 8

REVISIONS:

NO.	DATE	DESCRIPTION
1	04-11	PLANTINGS IN ISLANDS

DESIGNED BY: DCSA
DRAWN BY: DCS
CHECKED BY: DCSA
DATE: SEPT 2010
PROJECT NO: 10-08b

PRELIMINARY, NOT FOR CONSTRUCTION

LANDSCAPE PLAN

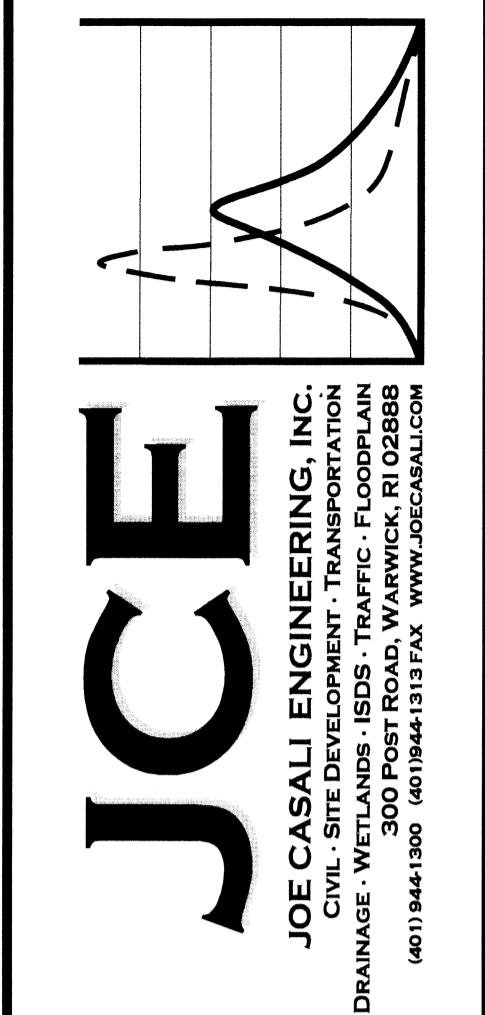

Q:\10-08_Crossings\Architects\10-08b-Seekonk Crossings-SUBCONSULTANT'S.dwg 4-11-11\landscape Plan REV 04-11-11.dwg Apr. 11, 2011 1:48pm