

- A = 1/8" TO 1/2" DOUBLE WASHED STONE (2" MINIMUM THICKNESS) OR GEOTEXTILE FABRIC.
  - B = 3/4" TO 1 & 1/2" DOUBLE WASHED STONE.
  - C = 4" SCHEDULE 40 PERFORATED PIPE.
  - D = DISTRIBUTION BOX.
  - E = 1500 GALLON SEPTIC TANK ON 6" OF CRUSHED STONE.
- ALL UNSUITABLE MATERIAL IS TO BE REMOVED FROM UNDER THE BED AND TO 5 FT. BEYOND AND REPLACED WITH SECTION 15.255 SAND.

**SYSTEM PROFILE**

6"	A	SL	35.0	10YR $\frac{3}{8}$
24"	B	SL	33.5	10YR $\frac{3}{8}$
30"	C	WEAVING	33.0	10YR $\frac{3}{8}$
48"	E	SAND	31.5	
96"		WATER	27.5	
108"			26.5	

1-22-13

SOIL SAMPLE LABORATORY SIEVE ANALYSIS INDICATED CLASS 1 SOIL.

A VARIANCE IS REQUIRED FOR DERIVING THE DESIGN PERCOLATION RATE BY RESULTS OF LABORATORY SIEVE ANALYSIS. 15.405(1)(11). A BED RESTRICTION IS, THEREFORE, REQUIRED, LIMITING THE HOUSE ON THIS LOT TO NO MORE THAN 3 BEDROOMS.

**SOIL LOG**

- NOTES:
1. SOIL EVALUATION PERFORMED BY EDWARD KINGMAN AND WITNESSED BY BETH HALLAL ON 1-22-13.
  2. DESIGN PERCOLATION RATE = 8 MIN. PER INCH.
  3. DESIGN FLOW = 330 G.P.D.
  4. REQUIRED LEACHING AREA = 330 x 1.515 = 500.0 S.F. SELECT BED SIZE 1.4' x 36" = 50.4 S.F.
  5. NOT DESIGNED FOR USE OF GARBAGE GRINDER.
  6. ALL PIPE 4" SCHEDULE 40 EXCEPT AS NOTED.
  7. APPLY MAGNETIC TAPE TO ALL COMPONENTS.
  8. PUMP OUT SEPTIC TANK AT 3 YEAR OR LESS INTERVALS. CLEAN FILTER YEARLY.

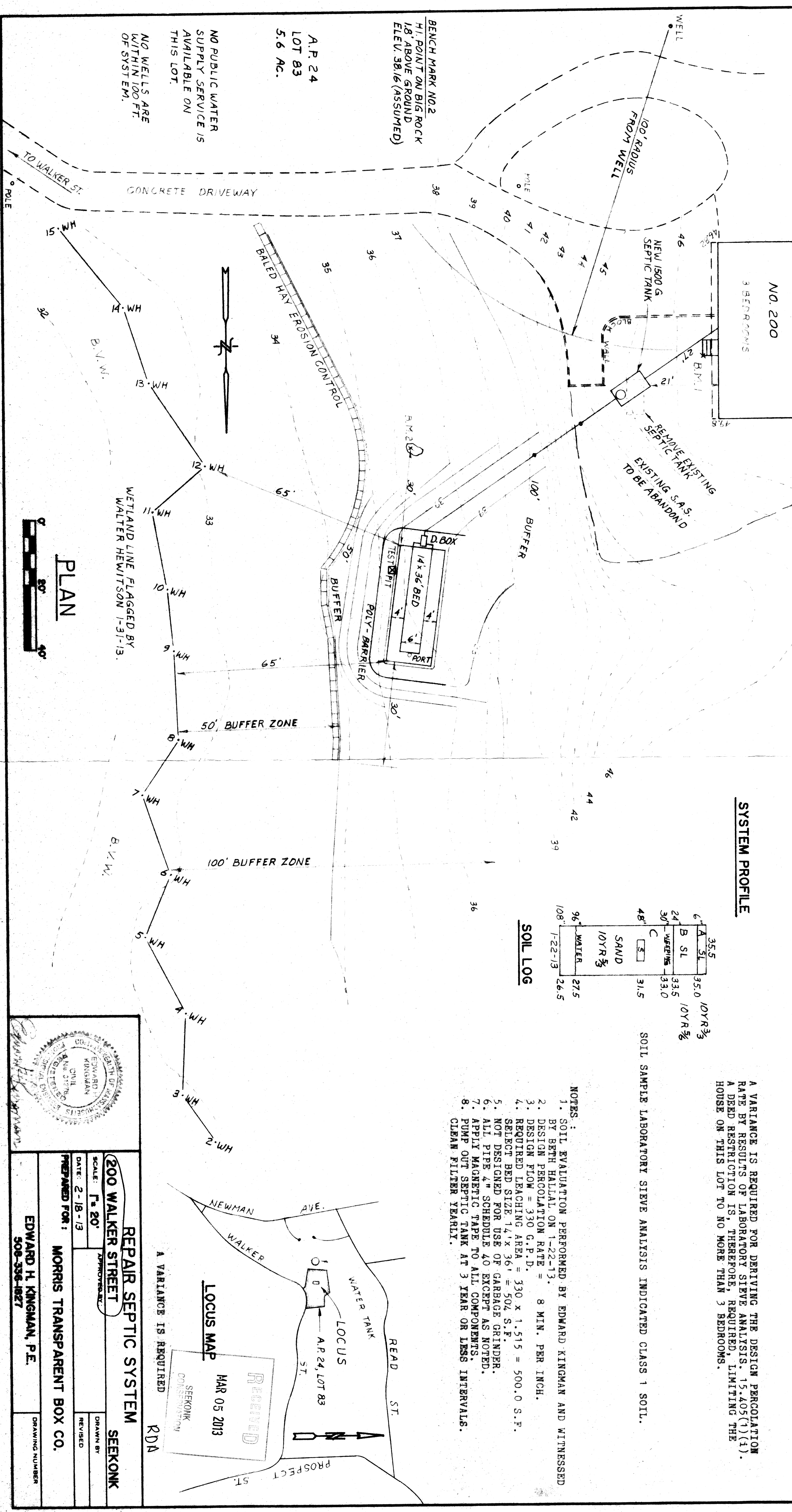

**PLAN**

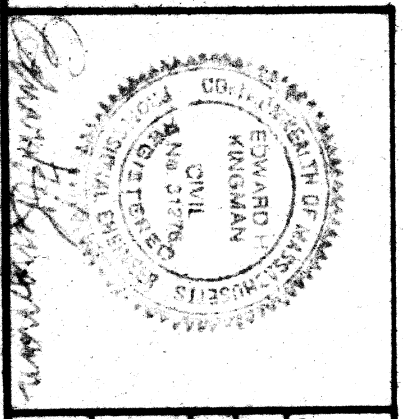

**REPAIR SEPTIC SYSTEM**  
SEEKONK  
SCALE: 1" = 20'  
DATE: 2-18-13  
DRAWN BY: [REDACTED]  
REVISIONS: [REDACTED]  
PREPARED FOR: MORRIS TRANSPARENT BOX CO.  
EDWARD H. KINGMAN, P.E.  
508-356-1827  
DRAWING NUMBER: [REDACTED]

