

TOP OF FOUNDATION ELEV. 51.62 ±

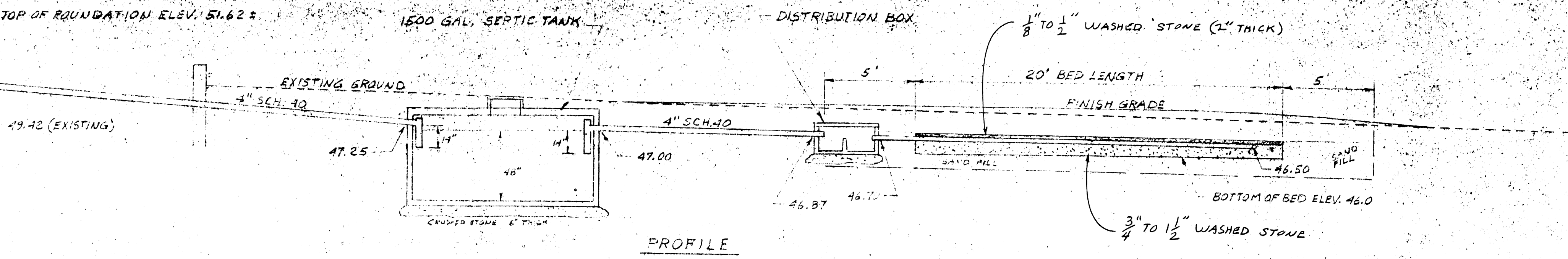

SOIL LOG

46.0	TOPSOIL	
24"	SUBSOIL	44.0
36"	WATER	43.0
	SAND	
	SAND	
20"		38.0

NOTES:

- DESIGN PERCOLATION RATE: 5 MIN. PER INCH
- ESTIMATED DAILY FLOW = 330 GAL.
- REQUIRED LEACHING AREA = $330 \times 1.55 = 446$ S.F.
- BED SIZE $20' \times 23' = 460$ S.F.
- ALL UNSUITABLE MATERIAL, INCLUDING ANY EXISTING LEACHING FACILITIES AND BUILDING FOUNDATIONS, IS TO BE REMOVED FROM UNDER THE BED AND TO 5 FT. ALL AROUND THE BED. THIS SPACE IS TO BE FILLED WITH CLEAN SAND HAVING A PERC RATE OF LESS THAN 2 M.P.I.
- A 6" D. SILENT FOR USE OF GARBAGE GRINDER.
- ALL DEMOLISHED BUILDING MATERIAL AND ASPHALT PAVEMENT WITHIN THE DESIGNATED BUFFER ZONE IS TO BE REMOVED FROM THE SITE.

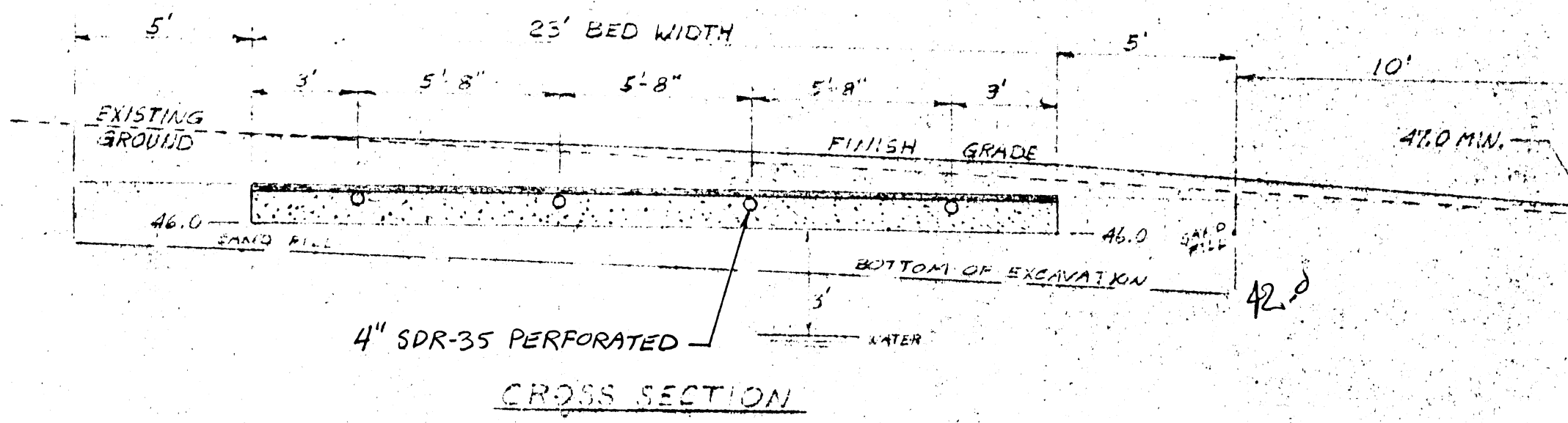

TAUNTON AVE.

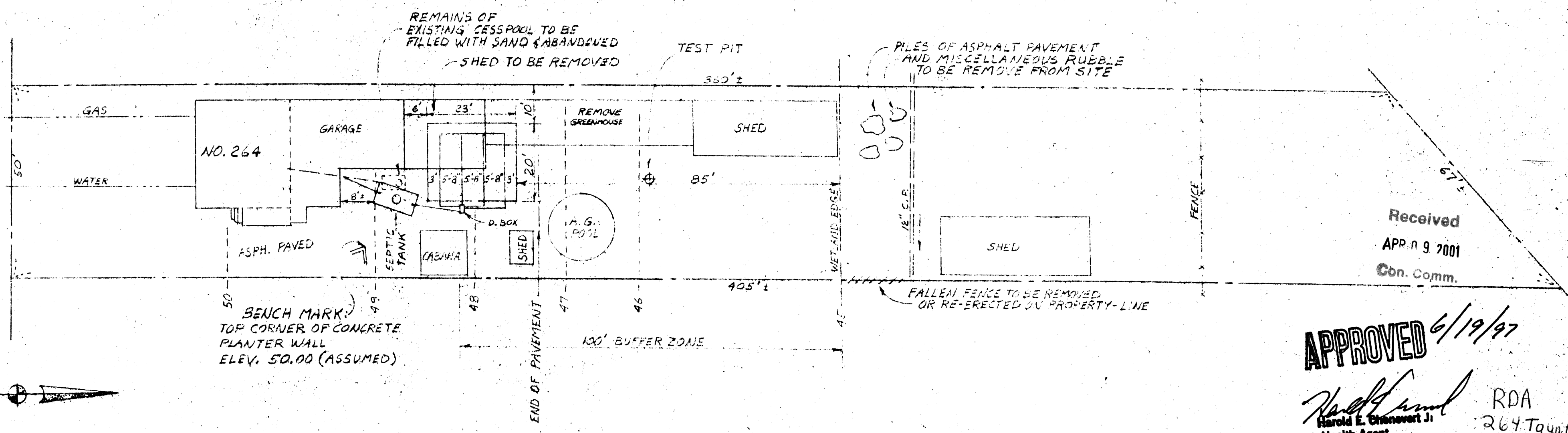

PLAN
SCALE: 1" = 20'

Received
APP. 9 2001
Con. Comm.

APPROVED 6/19/97

Harold E. Chenevert Jr.
Health Agent
RDA
264 Taunton

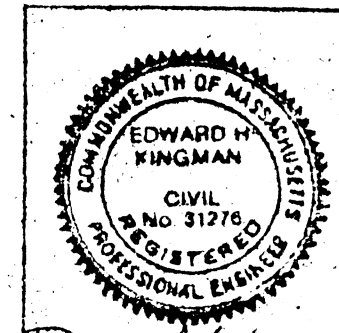

UPGRADE SEPTIC SYSTEM		264 TAUNTON AVENUE, SEEKONK, MASS.	
SCALE: 1" = 20'	APPROVED BY:	DRAWN BY:	
DATE: 6-17-97		REVISED:	
PREPARED FOR:		BANK UNITED OF TEXAS	
3336 RICHMOND STA. 150 HOUSTON TX. 77098			
EDWARD H. KINGMAN REGISTERED PROFESSIONAL ENGINEER 299 SUTTON ST. BOSTON, MASS. 02249		PROJECT NUMBER 508-336-6934	