

JOSEPH K. and DOROTHY E. NUNES

NOTES:

1. Set staked haybales prior to construction and maintain in place until loam & seed is established.
2. Place 6" of loam & seed on all disturbed areas.
3. The cellar floor elevation shown has been suggested as a minimum based upon observed groundwater conditions. Since groundwater levels fluctuate annually, no warranty of a dry cellar is expressed or implied.
4. Strip all top & subsoil in the area of the trench and 25' beyond in all directions and replace with clean gravel.

PROFILE
SCALE: HOR. 1" = 20'
VERT. 1" = 4'

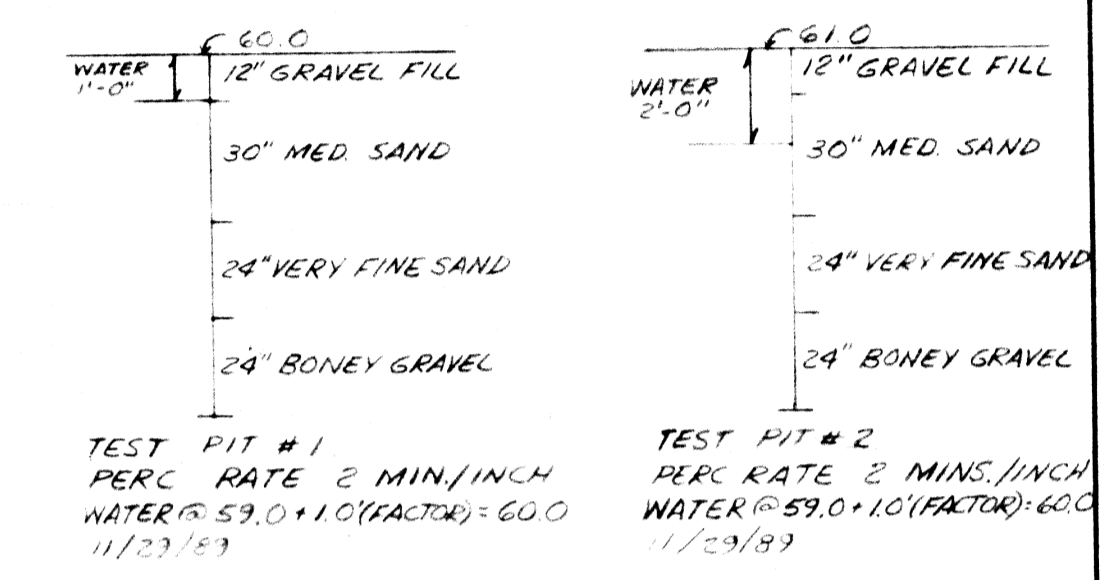
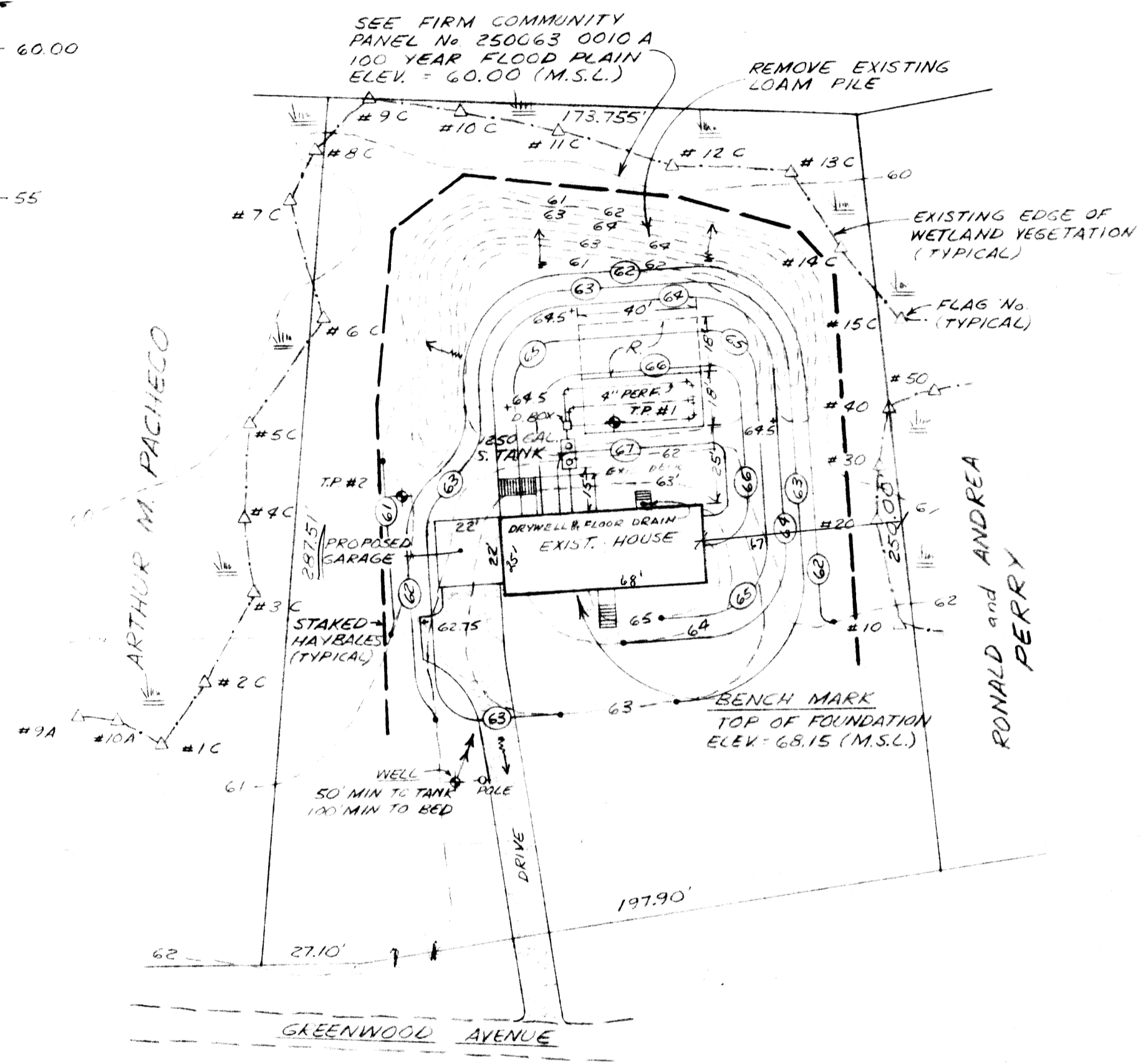

DESIGN DATA
4 BEDROOMS = 660 G.P.D.
PERC RATE = 2 MINS./INCH
USE BED @ 10 S.F./GAL
18' WIDE x 40' LONG = 720 GALS.

INVERTS	
OUT HOUSE	65.30
INTO S. TANK	65.15
OUT S. TANK	64.90
INTO D. BOX	64.85
OUT D. BOX	64.70
END BED	64.50
BOTTOM STONE	64.00
WATER TABLE	60.00
TOP FOUNDATION	68.15
CELLAR FLOOR	64.15

PLAT 18
PART OF LOT 172
RECORD LOT B
AREA: 53,451 S.F.
ZONE: R-2

	69-213 EXHIBIT A	
	SITE PLAN SEEKONK, MASSACHUSETTS FOR ARTHUR PACHECO	
CAPUTO AND WICK LTD. 1150 PAWTUCKET AVE. RUMFORD, R.I. 02916 401-434-8880	DATE 12/1/89	SHEET 1 OF 1

LOT B +/- 16' for w/l new now ARRISO #325 SF 69-213