

<b>TEST PIT #1</b> ELEV. 76.10 DATE: 4/15/94	<b>TEST PIT #2</b> ELEV. 76.37 DATE: 4/15/94
0" LOAM 12" COARSE GRAVEL PERC. 50-42	0" LOAM 12" COARSE GRAVEL PERC. 50-42
36" WATER @ 34" (4/15/94) (DRY @ 7/12/94)	36" WATER @ 34" (4/15/94) (DRY @ 7/12/94)
PERC. UNABLE TO SATURATE - 2 MPI	PERC. UNABLE TO SATURATE - 2 MPI
<b>TEST PIT #3</b> ELEV. 76.97 DATE: 2/10/87	<b>TEST PIT #4</b> ELEV. 75.37 DATE: 2/10/87
0" LOAM 12" GRAVEL FILL	0" SAND & GRAVEL FILL - SOME SILT
36" FINE SAND PERC. 48	36" MEDIUM COARSE GRAVEL PERC. 48
48" MEDIUM GRAVEL WATER @ 10" (4/15/94) WATER @ 10" (2/10/87)	48" MEDIUM GRAVEL WATER @ 10" (4/15/94) WATER @ 10" (2/10/87)
PERC. 2 MPI	PERC. 2 MPI

- SEWAGE DISPOSAL SYSTEM NOTES:**
- 1.) ALL WORK SHALL CONFORM TO THE 310 CMR 15.00 STATE ENVIRONMENTAL CODE TITLE 5 RULES AND REGULATIONS AND THE RULES AND REGULATIONS OF THE LOCAL BOARD OF HEALTH.
  - 2.) STRIP ALL TOPSOIL AND SUBSOIL (O, A, & B HORIZONS) AND ANY OTHER IMPERVIOUS OR SPECIFIED SOIL IN THE AREA OF THE SYSTEM AND 5 FEET BEYOND IN ALL DIRECTIONS WHERE POSSIBLE. REPLACE WITH GRAVEL MEETING LATEST SPECIFICATIONS OF 310 CMR 15.255(3).
  - 3.) ALL PIPE TO BE 4" P. V. C. SCHEDULE 40 UNLESS OTHERWISE NOTED.
  - 4.) PLACE 6" MINIMUM COMPACTED CRUSHED STONE UNDER SEPTIC TANK AND DISTRIBUTION BOX.
  - 5.) IF CONDITIONS ENCOUNTERED DURING CONSTRUCTION VARY SUBSTANTIALLY FROM THOSE SHOWN ON THIS PLAN, NOTIFY CAPUTO AND WICK, LTD. BEFORE PROCEEDING WITH CONSTRUCTION.

**DESIGN DATA**

**DAILY SEWAGE FLOW**  
75 GALLONS/1,000 S.F./DAY (OFFICE)  
2,500 S. F. X 75 (GAL/DAY)/1,000 = 188 GALLONS PER DAY  
15 GALLONS/PERSON/DAY (FACTORY)  
10 WORKERS X 15 GALLONS/DAY = 150 GALLONS/DAY  
TOTAL DAILY SEWAGE FLOW = 188 + 150 = 338 GALLONS/DAY

**SEPTIC TANK REQUIREMENTS**  
338 GALLONS PER DAY X 2 = 676 GALLONS  
USE 1,500 GALLON MINIMUM

**LEACHING AREA REQUIREMENTS**  
PERCOLATION RATE (ACTUAL) 2 MIN./INCH (DESIGN) 5 MIN./INCH  
SOIL TEXTURE & CLASS SAND - CLASS I  
EFFLUENT LOADING RATE 0.74 GALLONS/SQUARE FOOT/DAY  
USE - LEACHING FIELD 30 FEET X 18 FEET  
BOTTOM AREA = 540 SQUARE FEET  
TOTAL LEACHING AREA = 540 SQUARE FEET  
TOTAL LEACHING CAPACITY = 540 X 0.74 = 400 GALLONS/DAY

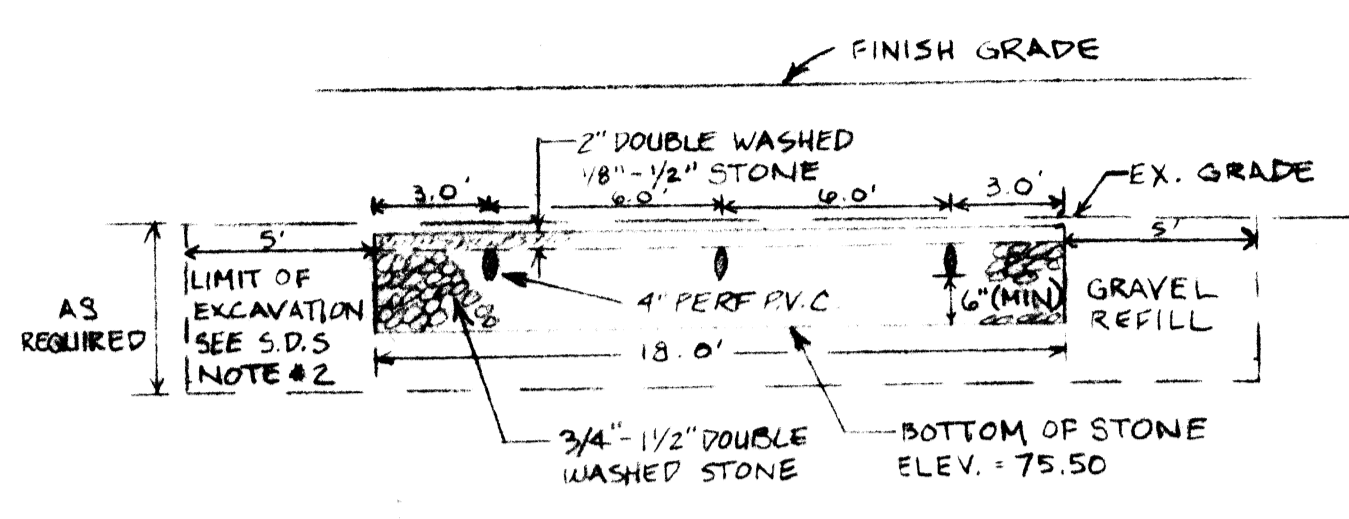

LEACHING FIELD CROSS SECTION  
SCALE: { HORIZ. 1" = 5' }  
{ VERT. 1" = 2' }

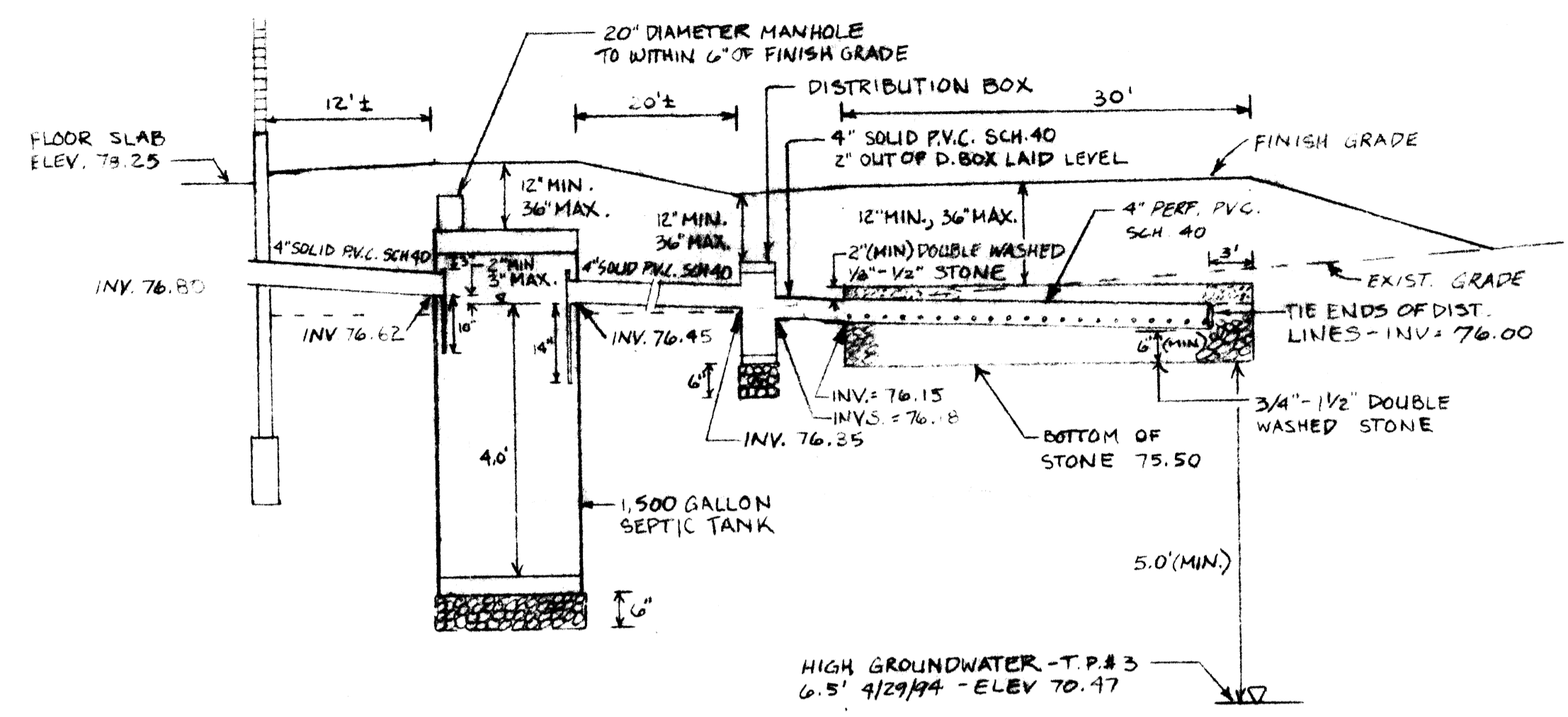

PROFILE  
SCALE: { HORIZ. 1" = 10' }  
{ VERT. 1" = 2' }

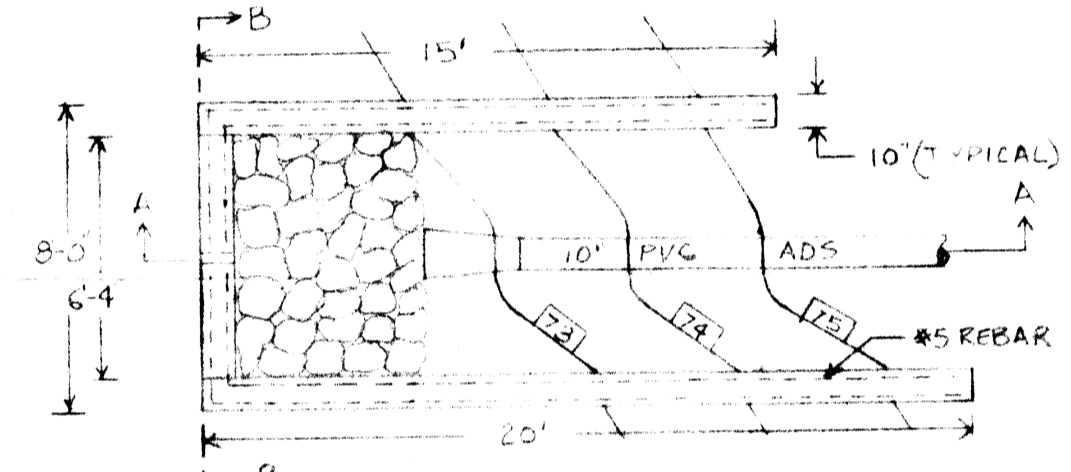
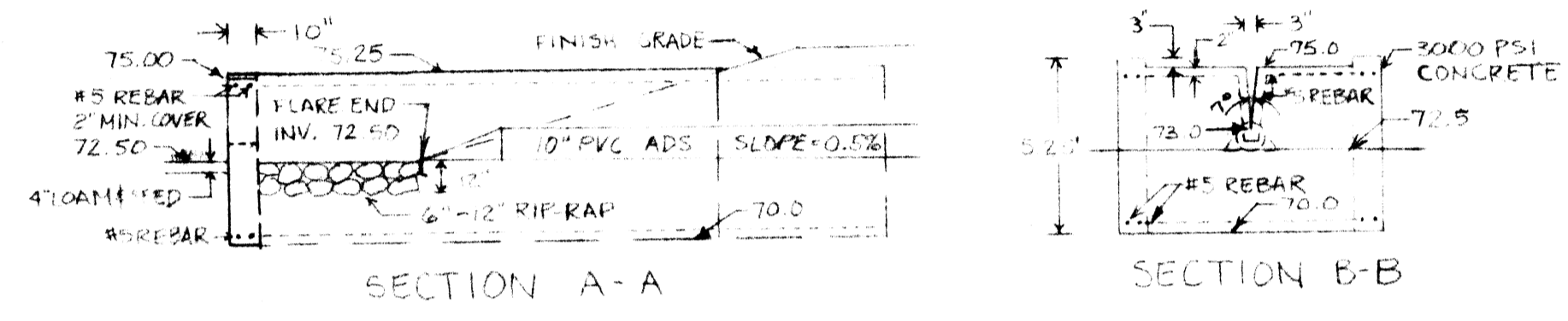

DETAIL - OUTLET CONTROL DEVICE  
SCALE 1" = 5'

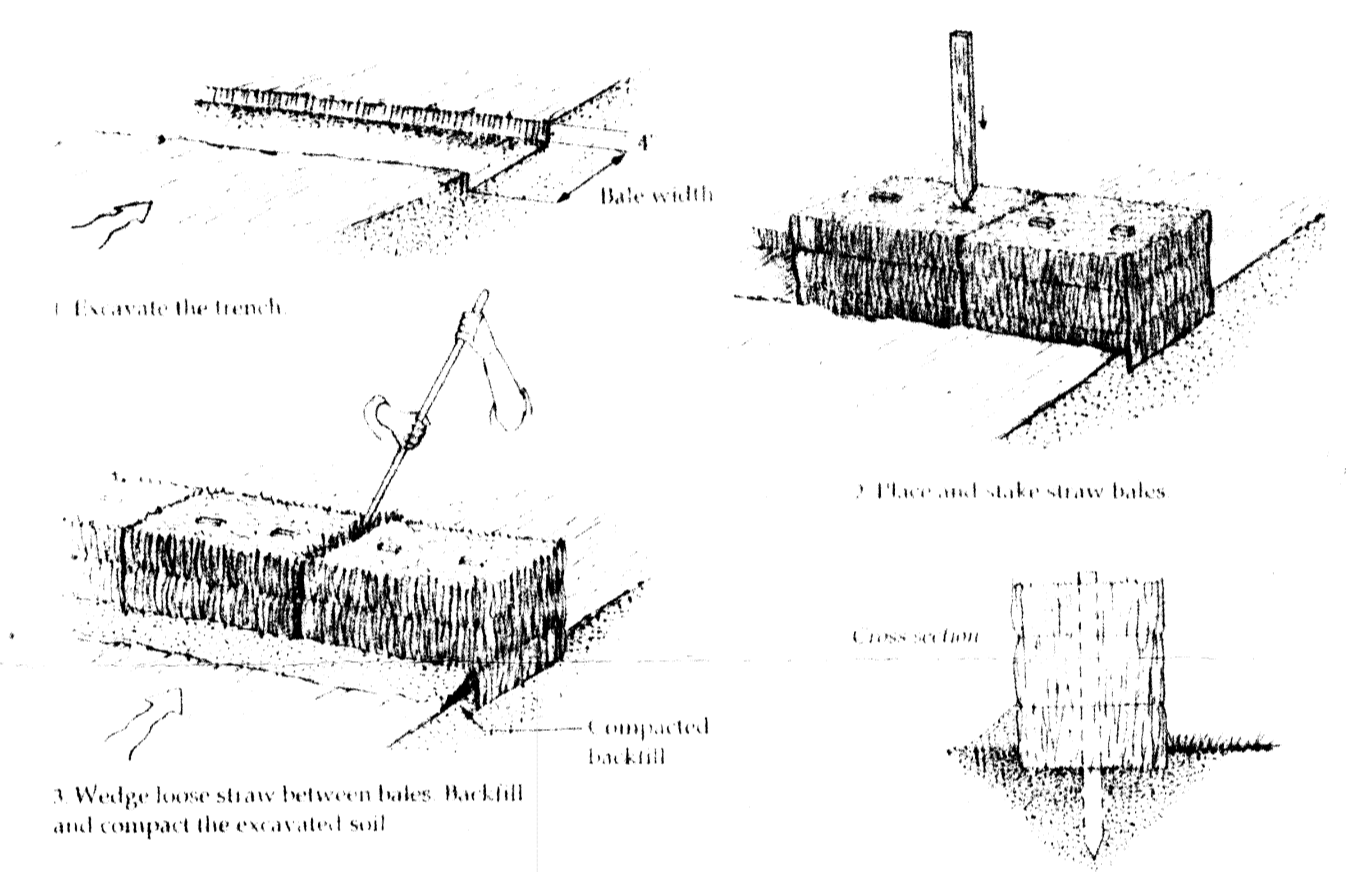

Figure 5-3: Placement and Construction of a Straw Bale Barrier  
Adapted from U.S. Department of Agriculture, Soil Conservation Service, Storm Control

**GENERAL NOTES:**

- 1.) All work and materials to conform with the Massachusetts Department of Public Works Standard Specifications for Highways and Bridges (1988) with latest addenda/revisions and the local Seekonk Standards.
- 2.) Underground utility locations are based on record data and are considered to be approximate. Contact "Dig-Safe" and/or local utilities for actual location prior to excavating.
- 3.) Install and maintain erosion controls in all areas required to prevent siltation.
- 4.) Install M. D. P. W. Standard 1-1/2" bituminous binder (Modified), and 1-1/2" bituminous surface course (Type I-1) over 12" of gravel borrow in area designated for pavement.
- 5.) Install 4" of loam and seed in all areas disturbed by construction and not designated for other surface treatment. Install in conformance with M. D. P. W. Standard Specification for Highways and Bridges (1988) with latest addenda/revisions. Use Grassplots and Island seed mix, except where slopes are 3:1 or steeper use Slopes and Shoulders seed mix.

**PARKING REQUIREMENTS**

One parking space per employee  
3 Office employees + 9 Factory employees = 12 Employees  
12 Parking Spaces proposed plus 1 handicapped spaces

**LANDSCAPING REQUIREMENTS**

Landscaping area requirements - 20 % of paved area  
Proposed pavement area - 12,894 Square Feet  
Landscaped area - 2,580 Square Feet (Minimum)  
Landscaping to meet the requirements of Section 10.5 (Parking Lot Layout)  
- Town of Seekonk Zoning By-Laws

**GROUNDWATER AQUIFER PROTECTION DISTRICT REQUIREMENTS**

Area of Lot - 97,125 Square Feet  
Maximum Wastewater Allowed - 6 Gallons per 1,000 Square Feet per Day  
Maximum volume of wastewater - 97,125 X 6 = 582 Gallons per Day  
Wastewater volume proposed - 338 Gallons per Day  
Maximum Impervious Area Allowed - 20 % of Lot Area  
Maximum impervious area - 97,125 X 0.20 = 19,425 Square Feet  
Impervious area proposed - 19,294 Square Feet

**EROSION AND SEDIMENTATION CONTROL**

- 1.) All perimeter erosion and sedimentation controls must be installed prior to the commencement of earthwork.
- 2.) Accessible reserves of hay bales and stakes are to be maintained on site for routine maintenance and in the event of unanticipated problems requiring emergency response.
- 3.) Hay bales should be installed in accordance with the details provided.
- 4.) No work is to occur on the wetland side of the perimeter erosion and sedimentation controls. All perimeter controls serve as the project limit of disturbance.
- 5.) No stones, brush, construction debris, litter, or other materials are to be deposited on the wetland side of the erosion and sedimentation controls.
- 6.) All disturbed soils not designated for other surface treatment are to be loamed and seeded immediately following final grading.
- 7.) Appropriate precautions should be taken to prevent the transport of soil off site from construction equipment.
- 8.) All perimeter erosion and sedimentation controls must be properly maintained and must remain in place until the soils have been stabilized to the satisfaction of the Engineer and the Town of Seekonk Conservation Commission or their agent.
- 9.) BOTTOM OF DETENTION BASIN TO BE FINISH GRADED WITH 4" SAND/LOAM TOPSOIL AND SEEDED WITH SEED MIX CONSISTING 60% BY WEIGHT CREEPING RED FENUGREK AND 50% REED CANARYGRASS. APPLY AT A RATE OF 10.0 LBS/1,000 S.F.

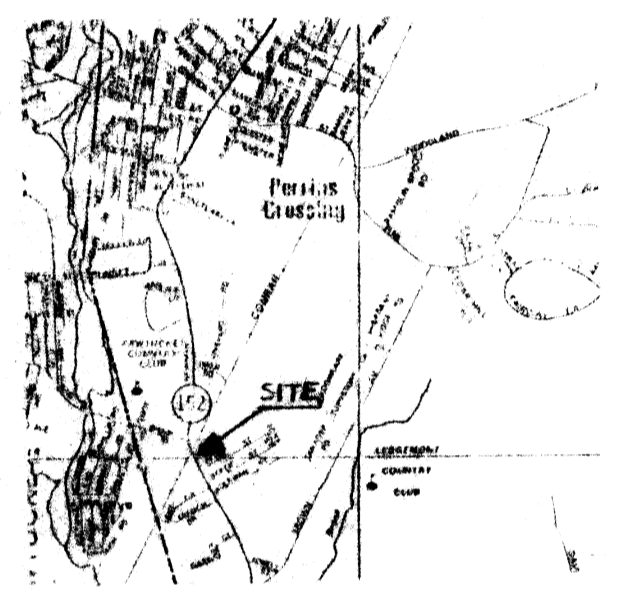

LOCUS MAP

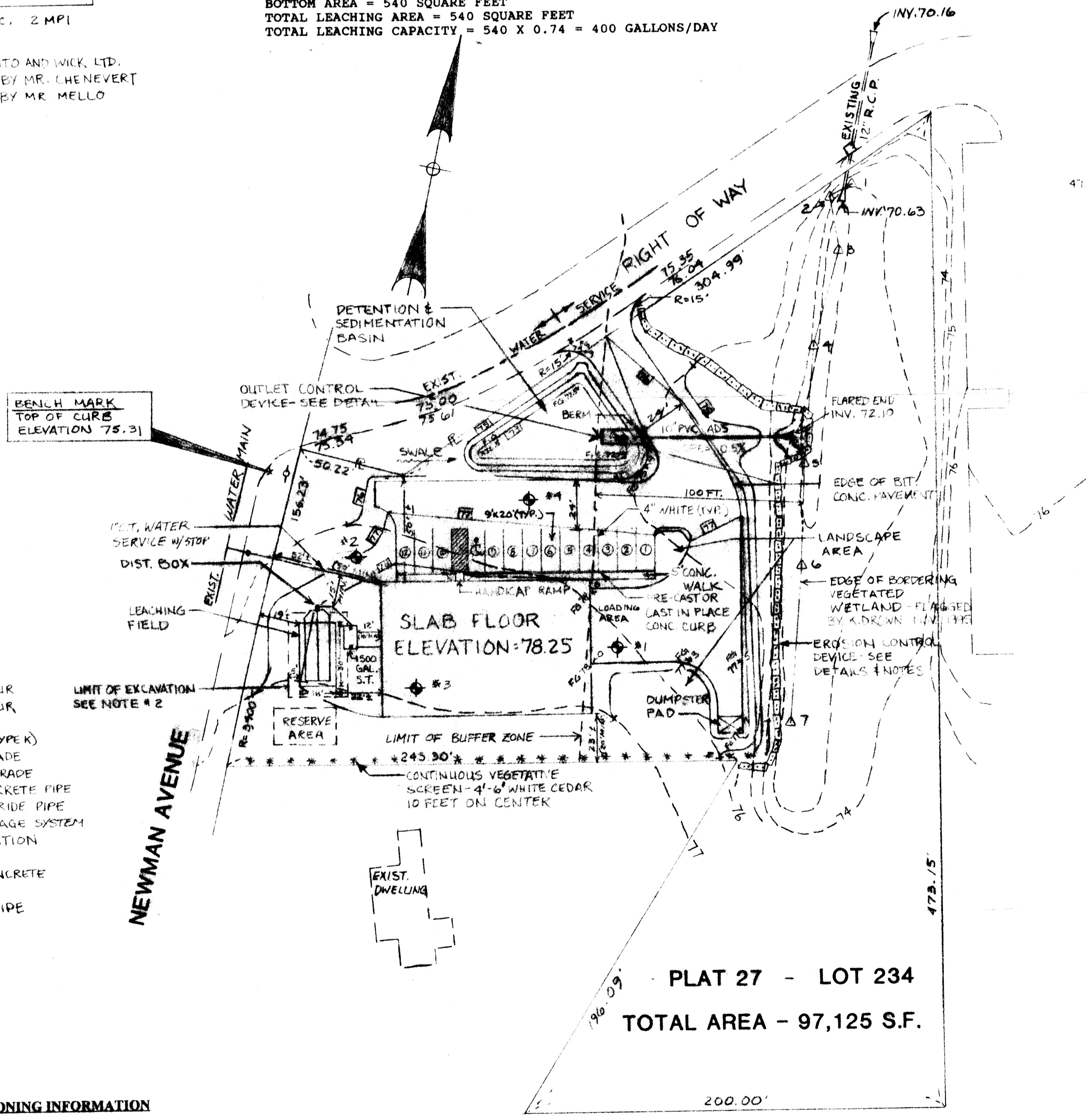

SCALE 1" = 40'

**ZONING INFORMATION**

Zoning - Industrial	20,000 Square Feet
Minimum Area	50 Feet
Minimum Width at Street Line	50 Feet
Minimum Depth of Front Yard	20 Feet
Minimum Side and Rear Yard	50 % of Lot Area
Maximum Building Coverage	

69-347  
EXHIBIT "A"

CAPUTO AND WICK LTD. 1150 PAWTUCKET AVE RUMFORD, R.I. 02916 401-434-8880		DATE JAN. 1996
SHEET		