

**NOTES:**

- 1) ALL WORK SHALL CONFORM TO THE 310 CMR 15.00 STATE ENVIRONMENTAL CODE - TITLE 5 AND THE RULES AND REGULATIONS OF THE SEEKONK BOARD OF HEALTH.
- 2) STRIP ALL TOPSOIL, SUBSOIL AND UNSUITABLE MATERIAL (AT LEAST 3" INTO THE C&B (99" - 123") HORIZON, TREE ROOTS AND STUMPS AND ANY OTHER IMPERVIOUS OR SPECIFIED SOIL IN THE AREA OF THE SYSTEM AND 5 FEET BEYOND IN ALL DIRECTIONS, WHERE POSSIBLE. REPLACE WITH GRANULAR FILL MEETING THE LATEST SPECIFICATIONS OF 310CMR15.255(3).
- 3) ALL PIPE TO BE 4" P. V. C. SCHEDULE 40 UNLESS OTHERWISE NOTED.
- 4) PLACE 6" MINIMUM COMPACTED CRUSHED STONE UNDER SEPTIC TANK AND DISTRIBUTION BOX.
- 5) IF CONDITIONS ENCOUNTERED DURING CONSTRUCTION VARY SUBSTANTIALLY FROM THOSE SHOWN ON THIS PLAN, NOTIFY CAPUTO AND WICK, LTD. BEFORE PROCEEDING WITH CONSTRUCTION.
- 6) GARBAGE GRINDER IS NOT ALLOWED WITH THIS DESIGN.
- 7) IT IS RECOMMENDED THAT THE SEPTIC TANK BE INSPECTED TWICE A YEAR, AND BE CLEANED WHEN THE SOLIDS EQUAL ONE THIRD THE LIQUID DEPTH.
- 8) BREAKOUT ELEVATION = 104.70. NO FINISHED GRADE BELOW 104.70 FOR 15 FEET (MINIMUM) FROM THE EDGE OF THE LEACHING AREA.
- 9) CONTRACTOR SHALL CONTACT "DIG-SAFE" PRIOR TO CONSTRUCTION. LOCATION OF UTILITIES ON THIS PLAN ARE FROM EXISTING INFORMATION, BUT ARE ONLY TO BE CONSIDERED APPROXIMATE.
- 10) THE CELLAR FLOOR ELEVATION SHOWN HAS BEEN SUGGESTED AS A MINIMUM BASED ON OBSERVED GROUNDWATER CONDITIONS. SINCE THE GROUNDWATER LEVELS FLUCTUATE ANNUALLY, NO WARRANTY OF A DRY CELLAR IS EXPRESSED OR IMPLIED.
- 11) ALL STONE USED FOR CONSTRUCTION OF THE SOIL ABSORPTION SYSTEM MUST BE DOUBLE WASHED AS SPECIFIED BY 310 CMR 15.247. ACTUAL STONE MATERIAL MAY ALSO BE SUBJECT TO APPROVAL BY THE DESIGN ENGINEER AND/OR SEEKONK HEALTH AGENT.

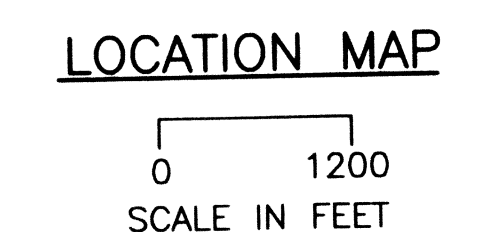

**DESIGN DATA**

DAILY SEWAGE FLOW  
 PROPOSED BEDROOMS = FOUR  
 DAILY FLOW = 110 GAL./DAY/BEDROOM x 4 BEDROOMS = 440 GALLONS PER DAY  
 SEPTIC TANK REQUIREMENTS  
 VOLUME = 2 x DAILY FLOW = 880 GALLONS - MINIMUM SIZE = 1500 GALLONS  
 LEACHING AREA REQUIREMENTS  
 PERCOLATION RATE = 8 MINUTES PER INCH - DESIGN FOR 10 MINUTES PER INCH - SOIL TEXTURE CLASS - II  
 EFFLUENT LOADING RATE = 0.60 GAL. PER S. F.  
 SIDEWALL AREA = N/A  
 BOTTOM AREA = 24' x 35' = 840 SQUARE FEET  
 TOTAL LEACHING AREA = 840 SQUARE FEET  
 TOTAL LEACHING CAPACITY = 840 S. F. x 0.60 GAL./DAY/S. F. = 504 GAL./DAY > 440 GPD

**EROSION AND SEDIMENTATION CONTROL**

- 1) ALL PERIMETER EROSION AND SEDIMENTATION CONTROLS MUST BE INSTALLED PRIOR TO THE COMMENCEMENT OF EARTHWORK.
- 2) ACCESSIBLE RESERVES OF HAY BALES AND STAKES ARE TO BE MAINTAINED ON SITE FOR ROUTINE MAINTENANCE AND IN THE EVENT OF UNANTICIPATED PROBLEMS REQUIRING EMERGENCY RESPONSE.
- 3) HAY BALES SHOULD BE INSTALLED IN ACCORDANCE WITH THE DETAILS PROVIDED.
- 4) NO WORK IS TO OCCUR ON THE WETLAND SIDE OF THE PERIMETER EROSION AND SEDIMENTATION CONTROLS. ALL PERIMETER CONTROLS SERVE AS THE PROJECT LIMIT OF DISTURBANCE.
- 5) NO STONES, BRUSH, CONSTRUCTION DEBRIS, LITTER, OR OTHER MATERIALS ARE TO BE DEPOSITED ON THE WETLAND SIDE OF THE EROSION AND SEDIMENTATION CONTROLS.
- 6) ALL DISTURBED SOILS NOT DESIGNATED FOR OTHER SURFACE TREATMENT ARE TO BE LOAMED AND SEEDED IMMEDIATELY FOLLOWING FINAL GRADING.
- 7) APPROPRIATE PRECAUTIONS SHOULD BE TAKEN TO PREVENT THE TRANSPORT OF SOIL OFF SITE FROM CONSTRUCTION EQUIPMENT.
- 8) ALL PERIMETER EROSION AND SEDIMENTATION CONTROLS MUST BE PROPERLY MAINTAINED AND MUST REMAIN IN PLACE UNTIL THE SOILS HAVE BEEN STABILIZED TO THE SATISFACTION OF THE ENGINEER AND THE SEEKONK CONSERVATION COMMISSION.

**DEEP OBSERVATION HOLE #13**

DEPTH	SOIL TYPE	REMARKS
0	10' A	S. L. - GRANULAR, FRIABLE 10 YR 3/3
8'	8" Bw	SANDY LOAM - MASSIVE, FRIABLE 15 YR 5/8
30"	30" Cd1	FINE S. L. - MASSIVE, FRIABLE 2.5 Y 6/3
45"	45" Cd2	SANDY LOAM - MASSIVE, FIRM 2.5 Y 4/3 - GRAVELLY, COBBLE 2.5 Y 4/3 - GRAVELLY, COBBLE
96"	96" Cd3	FINE - CRS. L. S. - MASS. FRIA 2.5 Y 4/3 - GRAVELLY, COBBLE
180"	180" Cd4	LOAMY SAND WITH SOME CLAY 2.5 Y 4/3 - MASSIVE, FRIABLE

PERC. DEPTH: 108"/128"  
 PERC. RATE: 8 MINUTES PER INCH  
 DATE: 10/14/97  
 KEEPING GW: 186'  
 DATE: 10/14/97 (D. O. H.)  
 MOTTLES @ 45" 15YR 5/8 & 25Y 6/2 - C3P  
 WATER DEPTH: 20'  
 DATE: 3/17/98  
 EST. HIGH GW: 20' (ELEV. - 99.1)  
 WITNESS: MR. CHENEVERT  
 PERFORMED BY: CAPUTO AND WICK

**DEEP OBSERVATION HOLE #14**

DEPTH	SOIL TYPE	REMARKS
0	0' A	S. LOAM - GRANULAR, FRIABLE 10 YR 3/3
8"	8" Bw	SANDY LOAM - MASSIVE, FRIABLE 10 YR 6/8
24"	24" Cd1	FINE S. L. - MASSIVE, FRIABLE 2.5 Y 1/3
30"	30" Cd2	SANDY LOAM - MASSIVE, FIRM 2.5 Y 4/3 - GRAVELLY, COBBLE 2.5 Y 4/3 - GRAVELLY, COBBLE
120"	120" Cd3	FINE - CRS. L. S. - MASS. FRIA 2.5 Y 4/3 - GRAVELLY, COBBLE
148"	148" Cd4	FINE - CRS. L. S. - MASS. FRIA 2.5 Y 4/3 - GRAVELLY, COBBLE

PERC. DEPTH: 120"/138"  
 PERC. RATE: 7 MINUTES PER INCH  
 DATE: 10/14/97  
 KEEPING GW: 186'  
 DATE: 10/14/97 (D. O. H.)  
 WATER DEPTH: 20'  
 DATE: 3/17/98  
 EST. HIGH GW: 20' (ELEV. - 99.3)  
 WITNESS: MR. CHENEVERT  
 PERFORMED BY: CAPUTO AND WICK

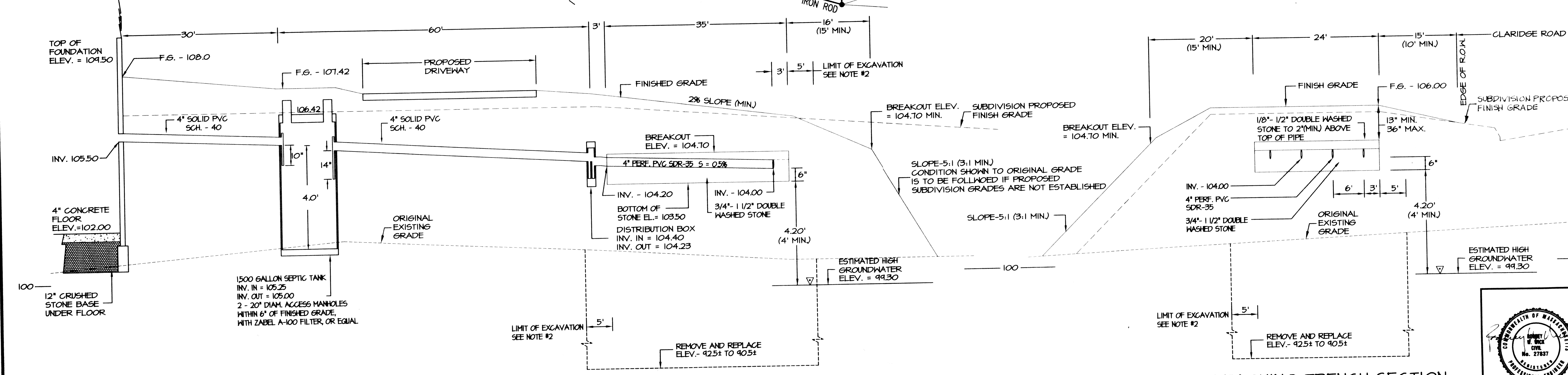
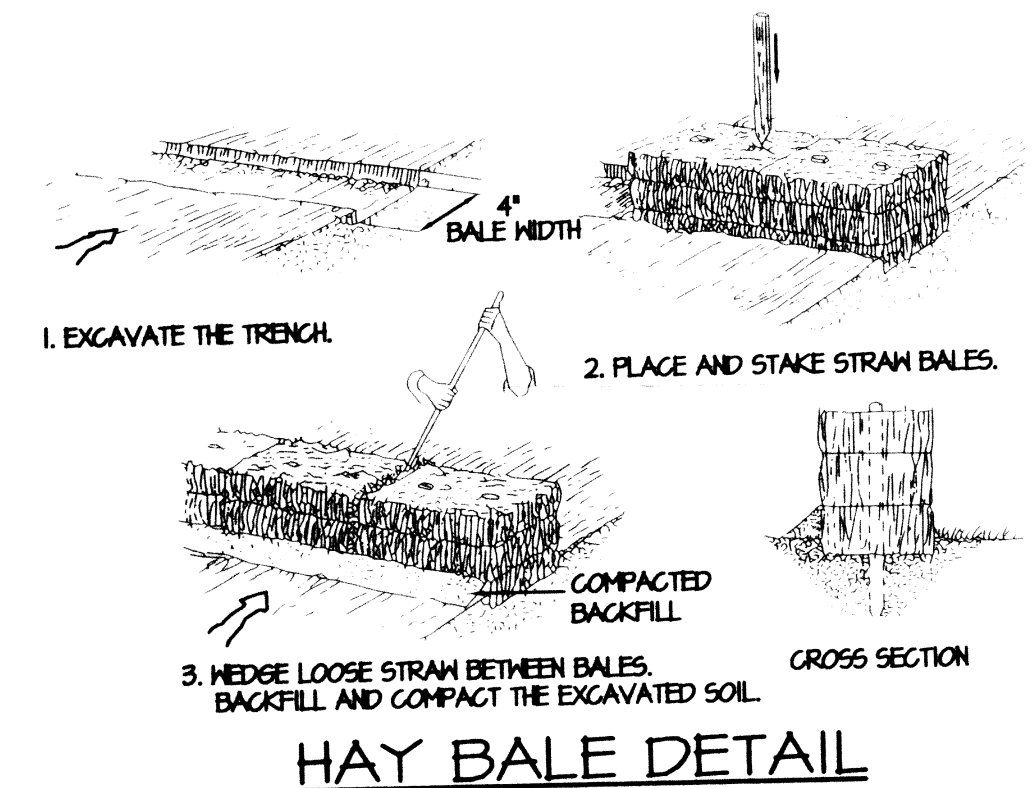

**LEACHING TRENCH PROFILE**  
 SCALE: HORIZONTAL: 1"=10'  
 VERTICAL: 1"=2'

**LEACHING TRENCH SECTION**  
 SCALE: HORIZONTAL: 1"=10'  
 VERTICAL: 1"=2'

**LEGEND**

- 100-- EXISTING CONTOUR
- 100-- PROPOSED CONTOUR
- MA, STD. MASSACHUSETTS STANDARD
- INV. INVERT OF PIPE
- P. V. C. POLYVINYL CHLORIDE PIPE
- S. D. R. STANDARD DIMENSION RATIO
- R. C. P. REINFORCED CONCRETE PIPE
- CONC. CONCRETE (BT. OR P. C.)
- BIT. BITUMINOUS
- P. C. PORTLAND CEMENT
- TYP. TYPICAL
- F.G. 100x00 FINISHED SPOT GRADE
- 100x00 EXISTING SPOT GRADE
- T. C. TOP OF CURB
- B. C. BOTTOM OF CURB
- P. PROPERTY LINE
- x-CLF-x- CHAIN LINK FENCE
- ST SEPTIC TANK
- DB DISTRIBUTION BOX
- DEEP OBSERVATION HOLE
- EXISTING EDGE OF WOODS

**ZONING INFORMATION**

ASSESSOR'S PLAT 25  
 LOT 309  
 AREA = 74,879 S.F.  
 ZONE: R4  
 SETBACKS:  
 FRONT YARD: 50'  
 SIDE YARD: 35' +5' PER STORY  
 REAR YARD: 80'  
 MAXIMUM HEIGHT: 3 STORIES OR 40 FEET  
 MINIMUM AREA: 62,500 S.F.

69-462  
 Received  
 FEB 20 2001  
 Con. Comm.  
**RECORD LOT 6**

**SEWAGE DISPOSAL SYSTEM**  
 TELMO daSILVA  
 CLARIDGE ROAD  
 SEEKONK, MASSACHUSETTS

CAPUTO AND WICK LTD.  
 1150 PAWTUCKET AVE.  
 RUMFORD, R.I. 02916  
 401-434-8880

DATE: FEBRUARY 14, 2001  
 SHEET: 1 OF 1

