

DESIGN CRITERIA: NO GARB. DISP.
 1-3" L x 1" W FIELD
 3 BED. X 110 GAL/BED = 330 GPD
 BOT. 976.03 F x 0.74 = 3522 GPD

PROVIDED
 D. BOX: 5 OUTLETS WITH BAFFLE
 SEPTIC TANK: GALLONS = 1500
 TANK TO HAVE 3-20" ACCESS
 COVERS AND ONE BROUGHT TO GRADE

SITE PREPARATION NOTES:
 (CHECK IF APPLICABLE)
 TOP, SUBSOIL AND OTHER
 DELETERIOUS MATERIALS IN,
 AND WITHIN 5 FEET OF THE
 LEACH SYSTEM ARE TO BE
 REMOVED PRIOR TO
 CONSTRUCTION AND REPLACED
 WITH SUITABLE MATERIAL AS
 REQUIRED UNDER SECTION
 15.255 OF TITLE V. STRIP TO
 ELEV. 90.5 ± AND REPLACE TO
 ELEV. 95.0 ± WITH 2" MPI
 MATERIAL AS NEEDED

LEGEND:
 PERCOLATION TEST \oplus
 TEST HOLE \ominus
 EXISTING CONTOUR — 100 —
 PROPOSED CONTOUR — 100 —

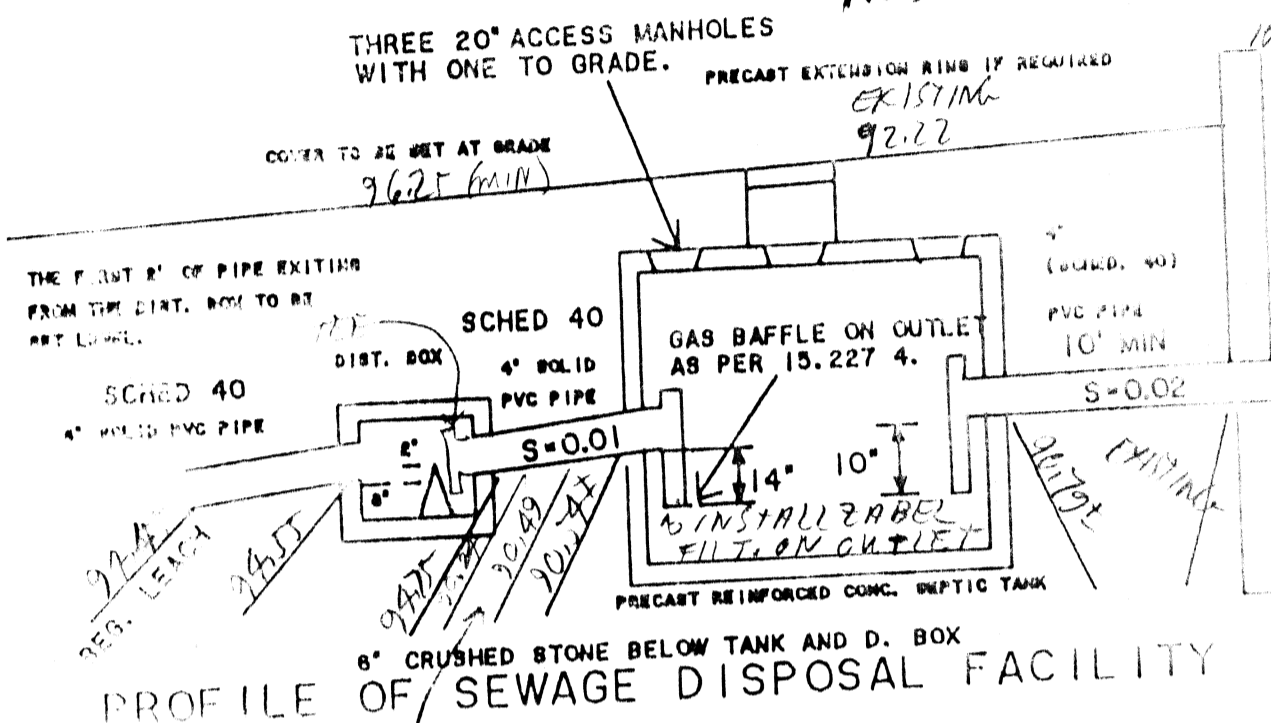
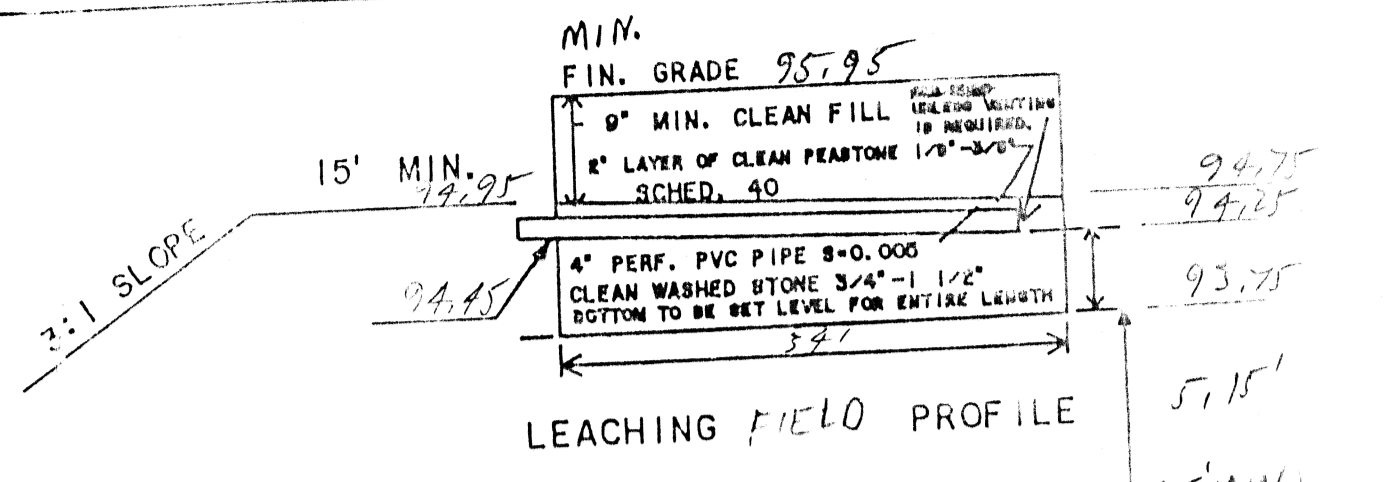

- CONSTRUCTION NOTES:
- ALL WORK SHALL CONFORM TO 810 CMR 15.00 STATE ENVIRONMENTAL CODE TITLE 5 RULES AND REGULATIONS ESTABLISHING MINIMUM STANDARDS RELATING TO LOCATION, DESIGN, CONSTRUCTION AND MAINTENANCE OF INDIVIDUAL SEWAGE DISPOSAL SYSTEMS AND OF THE LATEST ORDINANCE AND WITH THE REGULATIONS OF THE SEEKONK BOARD OF HEALTH.
 - THERE ARE NO KNOWN WELLS WITHIN 100' OF THE PROPOSED SEEPAGE FIELD; THERE ARE NO KNOWN S.A.C. FOUND WITHIN 100'.
 - THE INSTALLER SHALL VERIFY ALL ELEVATIONS AND DIMENSIONS PRIOR TO STARTING WORK. THE INSTALLER SHALL NOTIFY THE ENGINEER OF ANY DEVIATIONS FROM THE PLANS IN WRITING 10 DAYS BEFORE BEGINNING WORK.
 - MINIMUM DISTANCE FROM EDGE OF SEEPAGE FIELD TO PRESSURE WATER LINE = 10' AND 100' FROM A WELL.
 - CARE SHALL BE TAKEN TO ASSURE THAT THE SOIL AT THE BOTTOM OF THE EXCAVATION IS NOT COMPACTED OR SMOORED.
 - SUB-SURFACE DRAINS, FOUNDATION DRAINS AND STORM DRAINS SHALL BE 5' MINIMUM FROM THE SEPTIC TANK, 10' FROM THE SEEPAGE FIELD.
 - IT IS THE RESPONSIBILITY OF THE INSTALLER TO CONTACT THE ENGINEER 24 HOURS PRIOR TO BACKFILLING OF ANY PART OF THE SEPTIC SYSTEM SO THAT AN AS-BUILT CAN BE OBTAINED FOR THE BOARD OF HEALTH.
 - NO PERMANENT STRUCTURE MAY BE CONSTRUCTED OVER 100% EXPANSION AREA/DRAINAGE.
 - DROWN ENVIRONMENTAL SERVICES WILL NOT BE RESPONSIBLE FOR THE PERFORMANCE OF THE SYSTEM UNLESS CONSTRUCTED AS SHOWN. ANY ALTERATIONS MUST BE APPROVED IN WRITING BY DROWN.
 - LOT LINES SHALL BE VERIFIED BY A REGISTERED LAND SURVEYOR.
 - TIGHT JOINT PIPING TO CONSIST OF POLYVINYL CHLORIDE PIPE (P.V.C.) SCHEDULE 40 UNLESS OTHERWISE NOTED.
 - ALL PERMITS ARE THE RESPONSIBILITY OF THE APPLICANT.

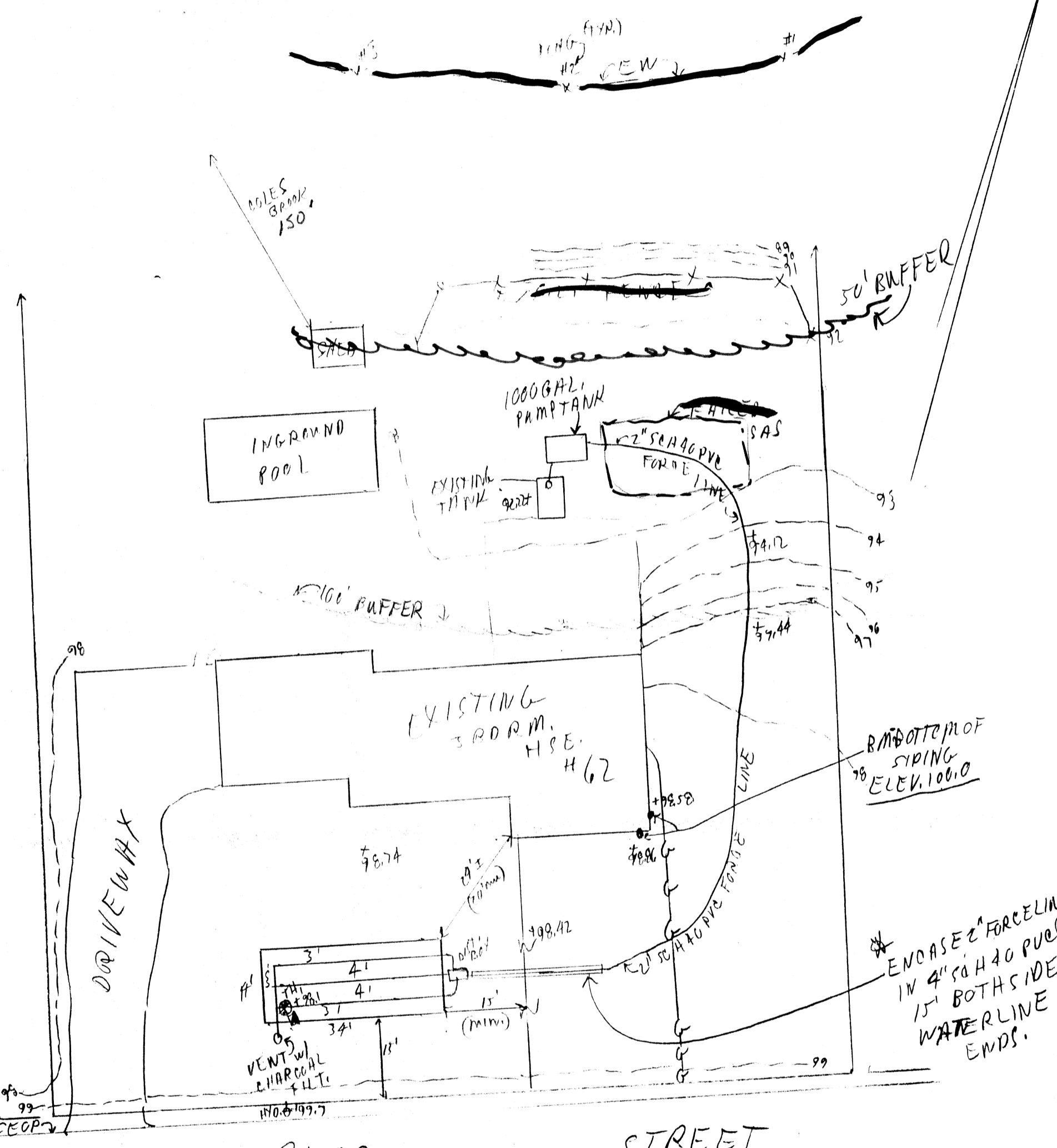

EV.'S & INV.'S	PROPOSED	AS-BUILT	TEST PIT NO. 1	TEST PIT NO. 2	TEST PIT NO. 3	PERCOLATION TEST DATA
OF FOUNDATION		100.17	98.1			DATE OF TEST
ISHED BASEMENT FLOOR			60" FILL	95.1		3/14/05
OF PIPE AT FND.	EXISTING	96	LOAMY SAND			PERCOLATION RATE
AT SEPTIC INLET		90.79 ±	10x21/5/420.6			5 MIN/IN
AT SEPTIC OUTLET		90.54 ±	SAND			CLASS I
AT D. BOX INLET	94.75	95.76	10x21/5/3			ELEV. OF BOT. OF PERC. TEST HOLE
AT D. BOX OUTLET	94.55	95.56				98.6
AT END OF PIPES	94.25	95.28				
AT BOT. OF STONE	93.75					

APPROVED BY:

DROWN ENVIRONMENTAL SERVICES
 P.O. BOX 263
 REHOBOTH, MASSACHUSETTS 02769
 508-252-6274

69-593

PROPOSED SEWAGE DISPOSAL SYSTEM
 62 READ STREET

APPLICANT: MR. BRADSHAW
 62 READ STREET
 SEEKONK, MA.

SCALE: 1" = 20'

DATE: 6/4/05

APPROVED BY: KSD

JOB# 05-02CR

PAGE 1 OF 2