

**ARTICLE 19. Petitioned Article**

To see if the Town will vote to require the Board of Selectmen to appropriate funding for improvements to the existing door at the elevator entrance and two additional doors accessing the entrance to the ground level of the Veterans Memorial Building for the purpose of making them more accessible to individuals with limited capabilities.

9 West Third Street  
South Boston, MA 02127  
Phone 617-269-7110  
Fax 617-269-9415  
MA License # 1313C

## QUOTE

Date	Quote #
10/13/16	16J13A26

Ms. Mary Russo  
Town of Millis  
900 Main Street  
Millis, MA 02054

Town of Millis  
Veterans Memorial Building  
900 Main Street  
Millis, MA 02054

Re: Veterans Memorial Bldg. - ADA Door Operators

Pasek Corporation is pleased to submit the following proposal to furnish and install three (3) ADA door operators, six (6) push switches and boxes, three (3) receivers, three (3) on/off switch and three (3) transmitters.

Pasek will install the ADA door operators on the main entrance, vestibule and elevator ground entrance.

We will reuse the existing rim exit devices that are dogged down during regular business hours.

We will provide an on/off toggle switches to lock down the outside push switch after hours.

Town of Millis will provide 120VAC power for the door operator.

**\*\*MHEC Contract # MC09-E05\*\***

Qty	Description	Manufacturer	Model
3	DOOR OPERATORS	RECORD	6101-36-C-STD
3	900MHZ - DIGITAL RECEIVERS	BEA	10RD900
6	PUSH PLATES 4.5	BEA	10PBR451
6	SURFACE MOUNT BOXES	BEA	10BOX45RND5M
3	DIGITAL TRANSMITTERS 900MHZ	BEA	10TD900PB
3	TOGGLES	CAMDEN	CM-190/5
1	MISCELLANEOUS MATERIAL		

---

Total Material and Installation	\$6,764.85
---------------------------------	------------

---

Exclusions:

- \* 120VAC power to be done by others.

Terms:

- \* Payment net 30 days from date of invoice.

Notes:

- \* The labor provided is based on Monday-Friday, 8:00am-4:30pm.
- \* This proposal is valid for 60 days.
- \* Please furnish a purchase order upon acceptance of this proposal.
- \* Warranty is one year for parts and labor.

**Warranty**

All system hardware, software and labor are guaranteed for one (1) full year from date of installation. Excluded from warranty is equipment subjected to the following: vandalism, voltage surges, brownouts, lightning, water damage, fire, explosion, weather related damage, negligence/misuse or acts of aggression. Equipment under warranty, which is modified by vendors other than Pasek or by Pasek approved vendors, will void warranty of that product and any related equipment that may be adversely affected.

Thank you for the opportunity to provide this proposal. Please review and Email or fax back a signed copy with your purchase order to confirm your acceptance. Should you have any questions, please do not hesitate to call me at 617-269-7110 or Email to [fhowe@pasek.com](mailto:fhowe@pasek.com).

Accepted By: \_\_\_\_\_

Signature: \_\_\_\_\_

Date: \_\_\_\_\_

PO#: \_\_\_\_\_

Fred Howe  
Security and Safety Sales

Town of Millis / 16J13A26





**NEW ENGLAND AUTOMATIC DOOR**

**1-844-DOORS-NE**

24/7/365

(1-844-366-7763)

*Proposal Package To Automate The Exterior  
Ramp Entrance At:*

*White Church On Aging  
500 Main Street  
Mills, MA 02084*

*04/01/2016*





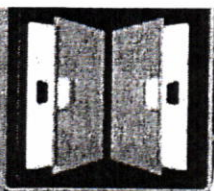

# NEW ENGLAND AUTOMATIC DOOR

*Heavy duty automatic door operator.  
Advanced computer control.  
Quick integration with new or existing access control devices.*

**MADE IN THE U.S.A.**

AUTOMATIC  
**CAUTION**  
DOOR

ACTIVATE SWITCH  
TO OPERATE



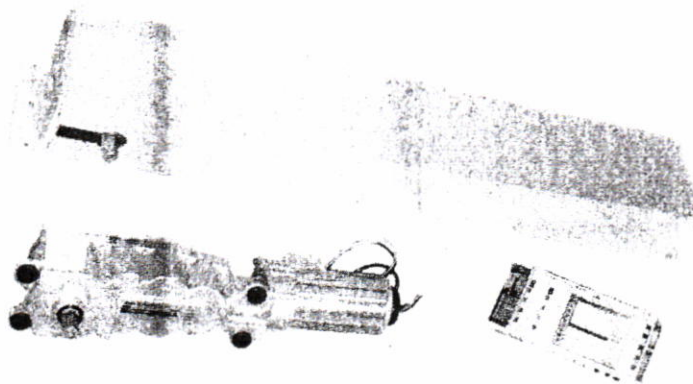

*Our automatic door system can be used as a high or low energy operator. Built to last with oversized bearings and solid steel gears, these automatic door systems meet the demands of the most severe pedestrian traffic. The advanced control provides flexibility over all aspects of the door's performance while operating within ANSI guidelines.*

### Equipment Includes:

- ✓ Heavy duty aluminum header with sizes from 32-110."
- ✓ Arms for In-Swing, Out-Swing & Overhead Concealed.
- ✓ Optional reduced "Low Force" opening operator.
- ✓ Guide rails, sensors and push buttons sold separately.
- ✓ OSHA approved UL 325 & CSA C22.2; MET/e113016.

**Superior Performance  
Heavy Duty Gearbox & Motor  
Advanced Digital Control  
Quiet Operation  
Our Units are the only  
Automatic**

**door units that are built with  
high strength steel gears.**

### Great Features

- One control for single or door pairs; high or low energy; and low force/energy applications.
- Power boost to manage building stack pressure; and closed-loop wind-load detection to manage wind gusts.
- Push-N-Go with a separate hold open timer.
- Adjustable closing speeds as standard, along with selectable obstruction detection (auto-reverse, stop or slow).
- Built-in 10A lock relay for all your electric lock and strike needs.
- On-board accessory power for sensors.
- Built-in lock-out function for header sensors, and wall detection avoidance for door mounted sensors.
- Built-in "secondary activate zone" when using push plates in hospital corridors &/or when using door-mounted sensors. Safeguards "trailing" traffic while preventing unintended activations during manual use.
- 100% solid steel gears for long life and the ability to drive 400lb doors. Extra large bearings for the most abusive traffic.
- Standard arm swing up to 180° for your "max-open" needs.
- Integrated line filter and double overload protection to safeguard your customers & equipment.

***Our versatility automatic door system provides the performance you need in Homes, Airports, Schools & Universities, Retail Centers, Office Buildings, Hospitals, Government & Public Buildings.***

### Standard Configurations

- High or low energy; and low force/energy operation.
- Headers for singles or pairs.
- Surface applied or overhead concealed.
- Right or left hand operation.
- Clear or dark bronze anodized.
- Additional finishes are available.



***High Energy Operators must be installed with the appropriate guide rails and safety sensors.***

Rev G



**N.E. Automatic Door Inc.**

188 Lake Shore Drive

East Weymouth, MA

contact@newenglandautomaticdoor.com

www.newenglandautomaticdoor.com

**NEW ENGLAND AUTOMATIC DOOR****PROPOSAL**

Order Number: 0133413475772989

Company: Millis Council On Aging		Date: 4/1/16
Contact First Name: Mary	Contact Last Name: Russo	
Address: 900 Main Street		
City: Millis	State: MA	Zip Code 02054
Phone: (508) 376-7051	Email: <a href="mailto:mjones@millis.net">mjones@millis.net</a>	

Proposal to automate the exterior ramp entrance	
N.E.A.D. proposes to furnish & install 1 single right hand out swinging automatic ADA compliant swing door system.	
These doors will activate by wireless 4.5" by 4.5" ADA wall switches. with surface boxes.	
Because the exit device latches even when unlocked, an electric strike will need to be installed.	
Electrician must be obtained by customer to supply 120vac power to each unit.	
Door will open automatically and stay in open position for a minimum of 6 seconds to meet ADA specifications.	

1	M/A ADA Compliant 36" CLR Auto door opener RH (see discount below)	\$ 2,550.00	\$ 2,550.00
1	Dual RC wall switch package with radio receivers	\$ 283.50	\$ 283.50
1	Adams Rite - 74R1-130 - Electric Strike, 2400 lb	\$ 327.00	\$ 327.00
1	On/Off/ Hold open switch as requested	\$ -00	\$ -00
1	Discount on each automatic door unit	\$ (300.00)	\$ (300.00)
Parts/Equipment Subtotal:			\$ 2,860.50
5	Service Labor	70	\$ 350.00
1	Service Travel (Discounted. Usually \$70 per hour)	0	\$ -00
Massachusetts State Tax (Parts/Equipment only) TAX EXEMPT		0.00%	\$ -00

50% deposit is due upon approval of this proposal. Remaining balance is due on the date of installation.	Total	\$ 3,210.50
All equipment comes with a 1 year limited warranty which covers manufacturer defects		
N.E.A.D. is not responsible for any permits needed to perform work proposed.		
Electrician needs to be hired by customer to supply units with 120vac		
N.E.A.D. is not responsible for existing defective equipment (physical door hardware)		
There may be as much as a 2 week lead time after initial deposit has been made		

N.E.A.D. Authorized Signature

Date:

4/1/16

I have read this estimate. I understand that this estimate is based on evaluation and does not include material price increases, additional labor and or materials that may be needed to complete this work due to hidden damage or scope changes. THIS PROPOSAL IS VALID FOR THIRTY DAY FROM THE DATE IT WAS CREATED.

Authorized Customer's Signature:

Date:

# Door Concepts, Inc.



MA Office: 115 Hillside Ave, Quincy MA 02170  
Toll Free 866-522-6876 Tel 617-639-5841 Fax 617-639-5572  
Main Office: 8 Delta Dr. Unit D, Londonderry, NH 03038  
Tel 866-428-8636 Fax 888-375-8855  
Web Site: [www.doorconceptsne.com](http://www.doorconceptsne.com)

Proposal Submitted To:

6/14/16

Contact: Mary Russo PM  
Customer: Millis Sr. Center  
990 Main Street  
Millis, MA

Phone: 774-272-2628  
Job Name: Millis Sr. Center  
Location: 990 Main Street  
City: Millis, MA  
Email/Fax: [mjones@milli.net](mailto:mjones@milli.net)

POWER ASSIST DOOR UNITS

We hereby submit specifications and estimates for:

- 3 Horton series 7100LE swing door operators for existing doors to building. Rear Main Entrance -- Interior Main Entrance and Elevator Side Entrance.
- 3 Horton Headers x RHR == LHR ===LHR door swings
- 3 Regular push arms
- 3 ON/Off Switches
- 3 Door safety decal kits
- 6 BEA press wall switches x SS x HP logo engrave on plate
- 6 BEA radio transmitters with surface wall boxes x black
- 3 BEA radio receivers for wireless control of doors
- 1 Aluminum door arm bar for elevator door due to low clearances

Finish: Clear andodized finished

Finish: Clear andodized finished

NOTES: Finish work, all electrical and security wiring by others.

EXCLUSIONS: Electrical Wiring, Preparation of Opening,

We Propose hereby to furnish material and labor- complete in accordance with above specifications, for the sum of:

\$5,765.00

**Five Thousand Seven Hundred Sixty Five Dollars and No Cents**

Payment to be made as follows:

**UPON COMPLETION**

Sales Tax: none

Net 30 days for materials stored in warehouse or delivered to job site and / or labor performed. Interest will be charged at 1 1/2% per month on all past due invoices.  
All legal and collection fees incurred for the collection of this contract will be paid by

Customer

Authorized

Signature:

*Jay Stearns*

Jay Stearns/ Doorologist

[Jay.Stearns@doorconceptsne.com](mailto:Jay.Stearns@doorconceptsne.com)

Note: This proposal may be withdrawn by us if not accepted within 30 days.

Signature: \_\_\_\_\_

Title: \_\_\_\_\_

Date: \_\_\_\_\_

Please sign and return one copy →

**Acceptance of Proposal** The above prices, specifications and conditions are satisfactory and are hereby accepted. You are authorized to do the work as specified. Payment will be made as outlined above



# Low Energy Swing Door Operators

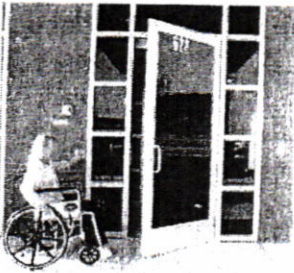

## EasyAccess®

Once the activating switch is pressed, the Series 7100 operator slowly opens the door and holds it open for an adjustable, delayed length of time. This creates a barrier-free doorway and gives the pedestrian time to pass through the door before it slowly closes using spring force of less than 15 pounds (67 N.)

### Installation and Operation

#### Electrical Requirements:

120, 220 VAC, 50 - 60 Hz,  
single phase, 15 amp service.  
Current draw - 3.15 amps.

#### Adjustments:

- Opening speed: 3 to 6 sec. to 80° (Open check)
- Closing speed: 3 to 6 sec. from 90° to 10° (Close Check)
- Time delay: 2 to 30 sec. (ANSI A156.19 requires 5 sec. minimum time delay).

Activating device to be located on each side of opening for two-way traffic as per ANSI Safety Standard A117.1

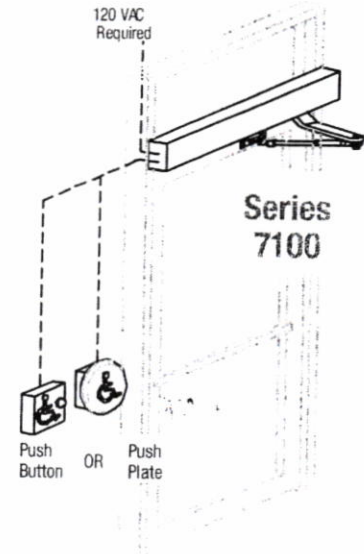
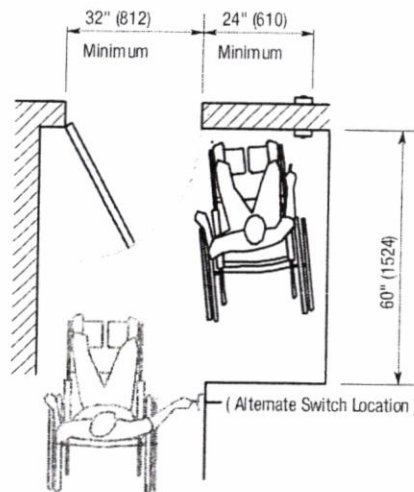

#### Selection Guide

##### Standard Single Units

Door Width	Header Width
3'-0" (914)	3'-3" (991)
3'-6" (1067)	3'-9" (1143)

##### Standard Pair Units

Pair Width	Header Width
5'-0" (1524)	5'-3" (1600)
6'-0" (1829)	6'-9" (1905)
7'-0" (2133)	7'-3" (2210)

**Maximum Door Width:**  
3'-6" (1067)

**Maximum Door Weight:**  
200 lbs (91kg)

#### Architectural Details

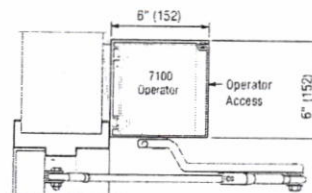

Optional 6" x 6" Header  
with Outswinging Arm Assembly

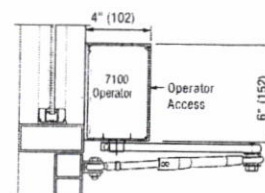

Standard 4" x 6" Header  
with Standard Inswinging Arm Assembly

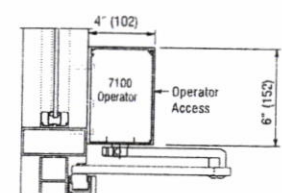

Standard 4" x 6" Header  
with Parallel Inswinging Arm Assembly

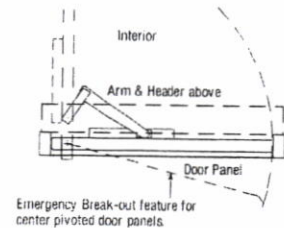
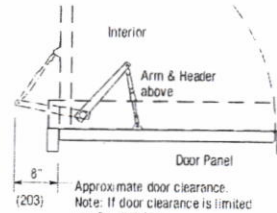
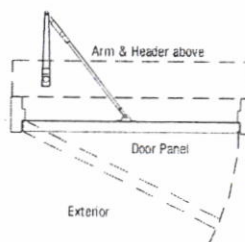

4242 Baldwin Boulevard  
Corpus Christi, Texas 78405-3399 USA  
Phone: 800-531-3111, 361-888-5591  
Fax: 361-888-6510  
www.hortondocors.com

Unit A, Hortonwood 31  
Telford, Shropshire, England TF1-7YZ  
Phone: 01952 670169  
Fax: 01952 670181

Specify ✓  
**HORTON**

A Division of  
**Overhead Door Corporation**  
A Sanwa Shutter Company

# Low Energy Swing Door Operators

## EasyAccess®

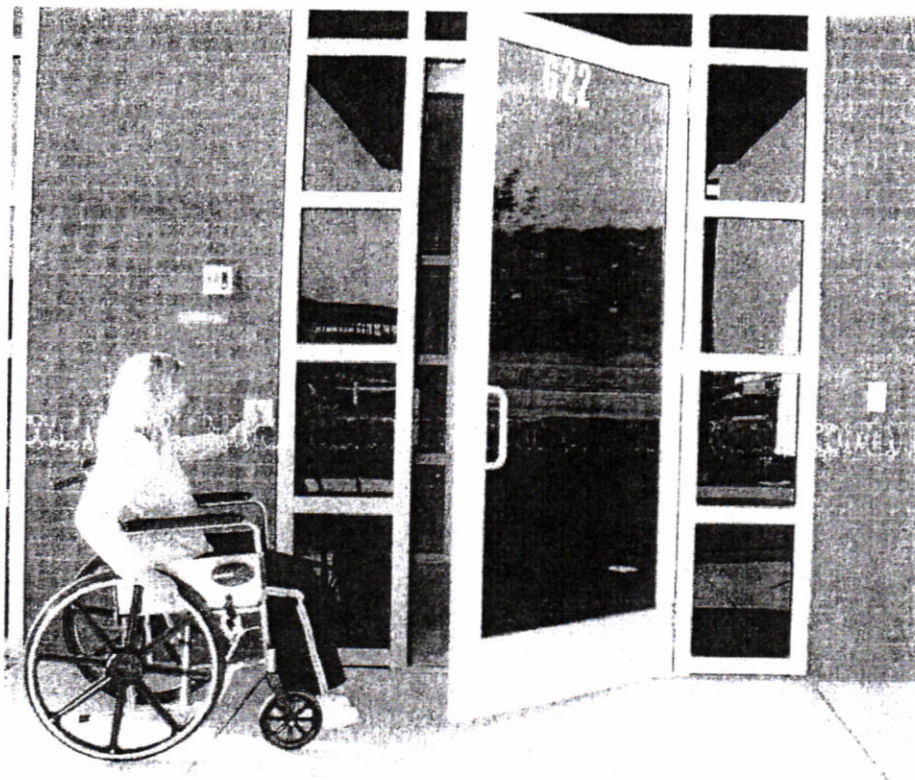

### Door system for standard ADA low energy applications

Compliant with ANSI A156.19, A117.1 and Americans With Disabilities Act of 1990

Standard system features & benefits:

- Heavy duty motor designed for standard handicap applications
- Surface mount 4" x 6" side access header. Optional 6" x 6" side access available.
- Available for butt hung and center pivoted door assemblies
- Installs easily with no structural changes required



Handicap Accessible

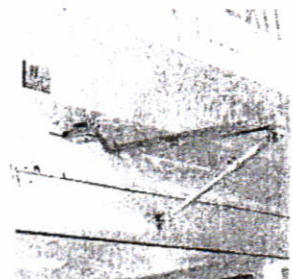

Surface Applied Operator

#### Additional Features/Benefits

- Push-N-Go® automatic activation by pushing or pulling door panel
- SoftTouch® reversing and obstruction sensing
- Automatic opening with push button or push plate
- Easily adjustable opening & closing speeds
- Manual operation in case of power failure
- Available in a variety of anodized, paint or clad finishes



Specify Horton and demand AAADM certified installation

**AAADM** American Association of Automatic Door Manufacturers

#### Did You Know?



Low energy operators move the door slowly at a rate considered intrinsically safe.



Automatic Doors Senior Center

Thu 4/14/2016 7:42 PM

**From:** Bill Anderson

**To:** mjones@millis.net



---

Attn: Mary Russo

We are pleased to the following quote for your consideration.

Wire in three automatic doors for the Senior Center, Town Hall, Millis, MA.

Price includes all necessary electrical material and wire for complete electrical installation.

Price.....\$1615.00

If you have any questions concerning this quote please call me on my cell phone @ 781-258-1519.

Very truly yours,

William E. Anderson  
President

Bill Anderson  
walcointru@aol.com