



Londonderry Conservation Commission
Tuesday, March 27, 2012
Minutes
Page 1 of 3

1 Present: Deb Lievens, Mike Considine, Paul Nickerson, and Truda Bloom

2

3 Also present: Resident Marge Badois

4

5 D. Lievens called the meeting to order at 7:30 PM.

6

7 American Tire Distributor Warehouse site plan, 17-45-3- At the March 13, 2012 meeting, the LCC
8 reviewed this site plan as part of the Town's Design Review Committee (DRC). Project engineer Kevin
9 Riggs of Cole & Associates, Inc. was joined at this meeting by Certified Wetland Scientist Bruce Gilday
10 to address the concerns expressed by the Commission in their DRC comments. Those remarks and
11 the associated responses are as follows:

- 12
- 13 • "Cons Comm notes there will be a Dredge and Fill permit for wetland northwest of the
14 building; Cons Comm cannot recommend final approval until we are sure what the State
15 requires for a D+F. We feel the applicant should have a meeting with Cons Comm. The
16 footnote says no jurisdictional wetlands on the property. See subdivision plan="open water"
 - 17 ○ B. Gilday explained that when surveyors create the "existing conditions" map as part
18 of the larger site plan, they note general features of the property along with the
19 dimensions of the lot. In this case, an area of standing water was observed and noted
20 on the plan, however surveyors are not qualified to make any determination regarding
21 wetlands. What was identified as "open water" on the plan was reexamined by B.
22 Gilday, a botanical expert, and a certified soil scientist. Their conclusion was that the
23 area was a portion of upland that was excavated during the 1930's and 40's when the
24 site was used as a practice track for harness racing. B. Gilday submitted a report to the
25 Commission (see attached) which details the determination that the soils in the
26 depressed area do not have the soil and hydrology characteristics associated with a
jurisdictional wetland.
 - 27 • "The Conservation Commission would like to see storm water infiltration plans; Given the
28 proximity to wetland, will the management plan prohibit the use of salt?"
 - 29 ○ The Commission reviewed the closed drainage system with K. Riggs, who detailed the
30 various forms of stormwater treatment that are designed to exceed the requirements
31 of the NH Department of Environmental Services (DES). He also alerted members to
32 correspondence from DES stating the Alteration of Terrain permit for the project has
33 been issued.
 - 34 • "Where is the snow storage for concrete and asphalt paving northwest of the building?"
 - 35 ○ K. Riggs identified the snow storage areas that have been coordinated with the
36 landscaping plan. He illustrated how the melted snow will be treated just as the
37 stormwater will be.
 - 38 • "Is the dedicated area considered to be part of the open space?"
 - 39 ○ The dedicated area is an easement that will be deeded entirely to the Town for
40 purposes of water quality management for Clark Road and Jack's Bridge Road. It is
41 therefore completely separate from the proposed project.



Londonderry Conservation Commission
Tuesday, March 27, 2012
Minutes
Page 2 of 3

42 The consensus of the Commission was to supplement their original DRC comments in order to
43 indicate the resolution by the applicant of the aforementioned issues.

44
45 Sunnycrest Phase I- The deed reassigning the Sunnycrest Phase I easement to the Rockingham County
46 Conservation District has been signed by the Town Manager and notarized. At their February 14,
47 2012 meeting, the Commission voted to approve the deed. When the signed deed is mailed back to
48 RCCD, a one-time donation of \$7,319 to RCCD's stewardship fund will accompany it and the transfer
49 will be complete. **P. Nickerson made a motion to authorize the Chair to expend an amount not to
50 exceed \$7,319 from the Open Space fund to cover the stewardship fee associated with the
51 reassignment of the Sunnycrest Phase I easement to the Rockingham County Conservation District.
52 M. Considine seconded. The motion was approved, 4-0-0.**

53
54 Joint Negotiating Committee- Two Commissioners have been appointed to this committee that will
55 review all future land transactions. Two Town Councilor positions have yet to be filled. The Town
56 Manager informed D. Lievens that he would be placing the issue on one of the Council's April meeting
57 agendas. An At-Large position remains vacant as well.

58
59 Trail work days- M. Considine stated that a trail work day in the Musquash is scheduled for April 14
60 from 8 AM to 12 PM at the Hickory Hill trailhead. Maintenance tasks will include bridging, blazing,
61 and rerouting trails.

62
63 Target Practice in the Musquash- M. Considine reported to LCC members at the February 14 meeting
64 that individuals using an abandoned trailer in the Musquash Conservation Area for target practice
65 were subsequently shooting in the direction of the Betty Mack trail (see February 14 and March 13
66 minutes). As the Musquash land was purchased in part with Land and Water Conservation Fund
67 grant money, P. Nickerson investigated what party is responsible for safety on that property. He
68 reported that the "local entity," i.e. the Town, is responsible.

69
70 Musquash Management Plan- D. Lievens will contact Town Forester Charlie Moreno about the
71 completion of this plan. She also hopes to follow up with him regarding potential sites in the
72 Musquash where the State can attempt to establish habitat for the endangered New England
73 Cottontail.

74
75 Membership- D. Lievens reported that full member George Herrmann will be resigning in the near
76 future, as he can no longer devote sufficient time to the Commission. Commissioners spoke with
77 Marge Badois about the possibility of her joining as an alternate member. If she is interested, D.
78 Lievens will forward her a copy of the Handbook for New Hampshire Municipal Conservation
79 Commissions published by the NH Association of Conservation Commissions (NHACC). **P. Nickerson
80 made a motion to authorize the Chair to expend an amount not to exceed \$40 from the line item
81 budget to cover the cost of two NHACC handbooks (one for M. Badois and another for a future
82 member). T. Bloom seconded. The motion was approved, 4-0-0.**



Londonderry Conservation Commission
Tuesday, March 27, 2012
Minutes
Page 3 of 3

83

84 DRC- Elliot Medical Phase 4 & 5 Site Plan Amendment (ground sign), Map 6, Lot 31:

85 No comments.

86

87 Litchfield Road routine roadway and railway maintenance- The Commission reviewed three NH DES
88 applications from the Town for routine roadway and railway maintenance activities near 11, 19, and
89 22 Litchfield Road. A culvert pipe will be replaced to provide proper drainage flow and headwalls
90 with stone aprons will be installed. The Commission had no comments.

91

92 March 13, 2012 minutes- T. Bloom made a motion to approve the minutes of the March 13, 2012
93 public session as written. P. Nickerson seconded. The motion was approved, 4-0-0.

94

95 T. Bloom made a motion to go into Non-Public Session per RSA 91-A:3 for the purpose of discussing
96 the potential release of portions of non-public minutes regarding possible land acquisitions. M.
97 Considine seconded.

98

99 Roll call vote: Aye, Truda Bloom; Aye, Paul Nickerson; Aye, Mike Considine, and Aye, Deb Lievens.

100

101 T. Bloom made a motion to go out of Non-Public Session. P. Nickerson seconded. The motion was
102 approved, 4-0-0.

103

104 T. Bloom made a motion to seal the minutes of the Non-Public Session indefinitely. P. Nickerson
105 seconded. The motion was approved, 4-0-0.

106

107 T. Bloom made a motion to release the previously redacted portions of the non-public minutes as
108 discussed in the non-public session. P. Nickerson seconded. The motion was approved, 4-0-0.

109

110 T. Bloom made a motion to adjourn. P. Nickerson seconded. The motion was approved, 4-0-0.

111

112 The meeting adjourned at 8:50 PM.

113

114 Respectfully submitted,

115

116

117

118 Jaye Trottier

119 Secretary



LAND CONSULTANTS

March 27, 2012

Deb Lievens, Chair
Londonderry Conservation Commission
269 Mammoth Road – Town Hall
Londonderry, NH 03053

RE: American Tire Distributors
Clark & Jack's Bridge Roads [Map 17; Lot 45-3]

Dear Madame Chair:

SUBJECT: ONSITE JURISDICTIONAL WETLAND STUDIES

I have traversed and studied the above-referenced property on numerous occasions over the past two (2) years and more importantly over the past three (3) months.

I have studied the depressions onsite and recorded the vegetative species with the assistance of botanical expert Chris Kane, Concord, NH.

I have studied the soils and hydrology onsite with the assistance of certified soil scientist and wetland scientist Randall Shuey, Epsom, NH.

Utilizing the Army Corps data sheets we have all been drawn to the conclusion that the depressions in the topography are man-made excavations that took place in naturally occurring uplands. The soils that are in the depressions have not taken on the hydric soil characteristics and seasonal water that collects after snow melt and rain falls does not stay for long durations during the growing season in Rockingham County.

We all conclude that these depressions are not jurisdictional wetlands in the State of NH.

Respectfully submitted,

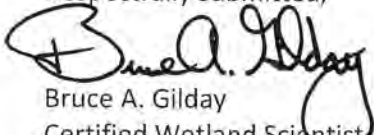
Bruce A. Gilday
Certified Wetland Scientist
Certified Soil Scientist



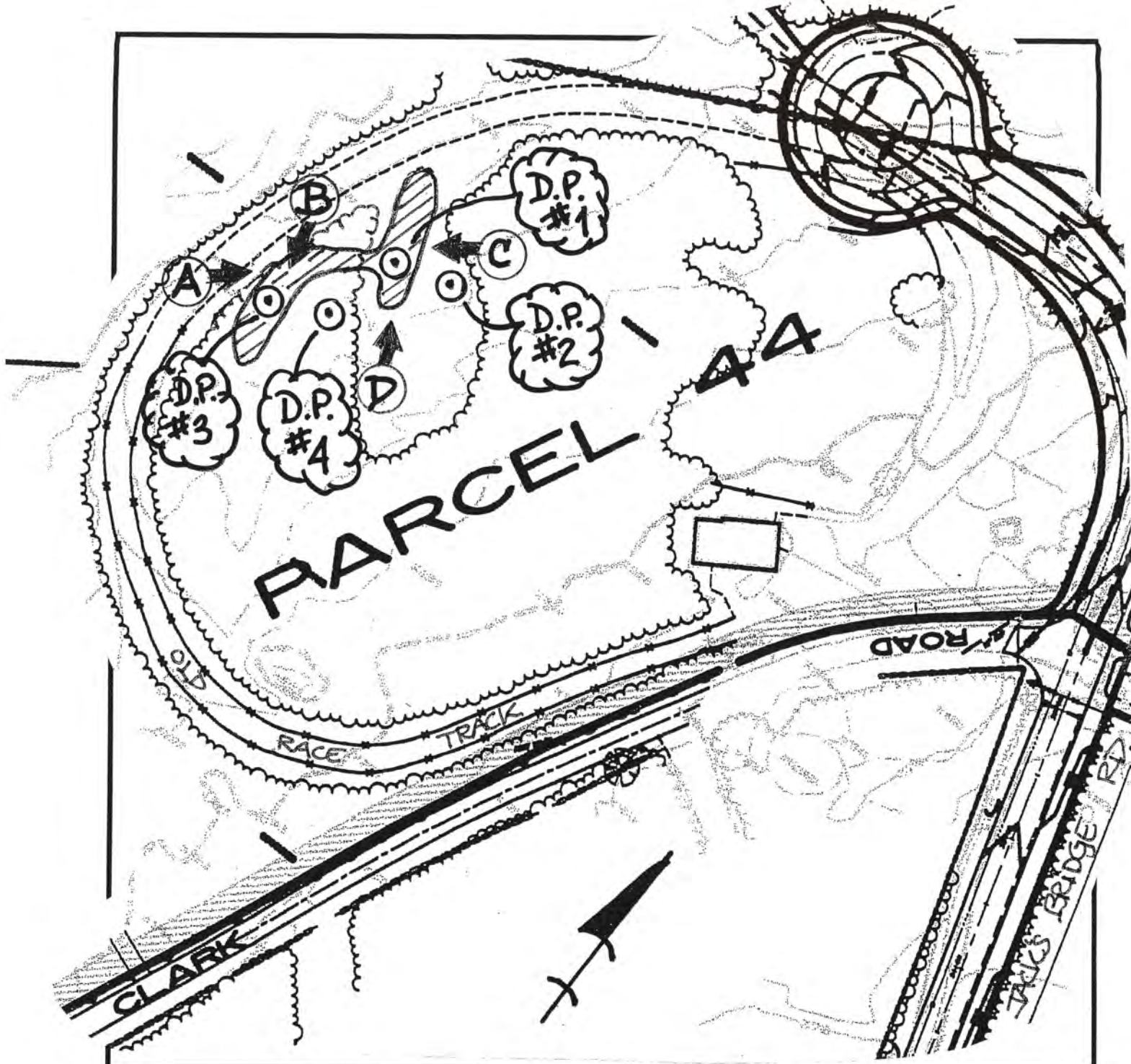

NH JURISDICTIONAL WETLAND DELINEATION SKETCH PLAN	
Evans Family Limited Partnership	
Map 17; Lot 44; Londonderry, NH	
31-Aug-10	B A G
1" = 100'	LAND CONSULTANTS
Job # 2115	43 Rockingham St., Concord, NH 03301
Figure # 1	603-228-5775

- LEGEND**
-  = Wetland Data Plot (typical)
 -  = Study Limits
 -  = Photo Location & Direction

PROJECT TITLE: EVANS Parcel 44; LONDONberry TRANSECT: _____ PLOT: D.P.#1
 DELINEATOR(S): BAG LAND Consultants DATE: 8-5-10

VEGETATION	Stratum and Species	Dominance Ratio	Percent Dominance	DOM	NWI Status
<u>Herb</u>	<u>Spiraea latifolia (Meadowsweet)</u>	<u>10.5/16.5</u>	<u>64%</u>	<u>Y</u>	<u>FAC+</u>
	<u>Populus tremula (Quaking Aspen)</u>	<u>3/16.5</u>	<u>18%</u>	<u>N</u>	<u>---</u>
	<u>Onoclea sensibilis (Sensitive Fern)</u>	<u>3/16.5</u>	<u>18%</u>	<u>N</u>	<u>---</u>
	<u>Panic Grass</u>	<u>TRACE</u>	<u>---</u>		
	<u>Reed CANARY GRASS</u>	<u>TRACE</u>	<u>---</u>		
	<u>Soft Rush</u>	<u>TRACE</u>	<u>---</u>		
	<u>HAIR CAP MOSS</u>	<u>TRACE</u>	<u>---</u>		
<u>Shrub</u>	<u>Alnus incana (Alder)</u>	<u>TRACE</u>	<u>---</u>		
	<u>Ilex verticillata (Winterberry)</u>	<u>TRACE</u>	<u>---</u>		
<u>Saplings & Trees</u>	<u>None recorded.</u>				

HYDROPHYTES				NON-HYDROPHYTES		
<u>1</u>						
OBL	FACW	FAC	*OTHER	FAC-	FACU	UPL
Hydrophytes Subtotal (A): <u>1</u>				Non-hydrophytes Subtotal (B): <u>0</u>		
PERCENT HYDROPHYTES (100A/A+B): <u>100</u>						

HYDROLOGY

RECORDED DATA
 Stream, lake, or tidal gage Identification: _____
 Aerial photography Identification: _____
 Other Identification: _____

NO RECORDED DATA

OBSERVATIONS:
 Depth to Free Water: > 30"
 Depth to Saturation (including capillary fringe): > 30"
 Altered Hydrology (explain): EXCAVATED DITCH/TRENCH

Inundated Saturated in upper 12" Water Marks Drift Lines Sediment Deposits Drainage Patterns within Wetland

OTHER (explain): WATER-STAINED LEAVES PRESENT / NO PRIMARY INDICES.

SOIL Sketch landscape position of this plot. Indicate relative position of other plot(s) and the wetland flag if not on plan.



Submission of photo of plot is encouraged.

DEPTH	HORIZON	MATRIX COLOR	REDOXIMORPHIC FEATURES (color, abundance, size, contrast)	COMMENTS (USDA texture, nodules, concretions, masses, pore linings, restrictive layers, root distribution, soil water, etc.)
0-1"	A	10YR 3/3	—	Weak Fine GRANULAR; Fine SANDY LOAM; Very Friable FLAT; Fine S. LOAM; FIRM Glacial Till
1-30"	C	2.5Y 5/3	—	

HYDRIC SOIL INDICATOR(S):

No REDOX observed @ 30"

REFERENCE(S):

OPTIONAL SOIL DATA

Taxonomic subgroup:

Soil drainage class: Moderate Well Drained

Depth to active water table:

NTCHS hydric soil criterion:

REFERENCE(S):

Montauk soil series
(USDA Rockingham County)

CONCLUSIONS

	YES	NO	REMARKS:
Hydrophytic vegetation criterion met?	<input checked="" type="checkbox"/>	<input type="checkbox"/>	
Hydric soils criterion met?	<input type="checkbox"/>	<input checked="" type="checkbox"/>	
Wetland hydrology criterion met?	<input type="checkbox"/>	<input checked="" type="checkbox"/>	
IS THIS DATAPOINT IN A WETLAND?	<input type="checkbox"/>	<input checked="" type="checkbox"/>	

PROJECT TITLE:

EVANS Parcel 44; Londondeeny

TRANSECT:

PLOT:

D.P. #1

PROJECT TITLE: EVANS Parcel (44); Londonderry TRANSECT: _____ PLOT: D.P.#2
 DELINEATOR(S): BAG LAND Consultants DATE: 8-5-10

VEGETATION	Stratum and Species	Dominance Ratio	Percent Dominance	DOM	NWI Status
<u>Herb</u>					
	<u>Celastrus orbiculatus (Bittersweet)</u>	<u>105/165</u>	<u>64%</u>	<u>Y</u>	<u>UPL</u>
	<u>Vaccinium angustifolium (Lowbush Blue)</u>	<u>3/16.5</u>	<u>18%</u>	<u>N</u>	<u>---</u>
	<u>ARONIA MELANOCARPA (Chokeberry)</u>	<u>3/16.5</u>	<u>18%</u>	<u>N</u>	<u>---</u>
	<u>CAREX debilis (Sedge)</u>	<u>TRACE</u>	<u>---</u>		
	<u>MAIANthemum CANADENSE (Wild Lily)</u>	<u>TRACE</u>	<u>---</u>		
	<u>Mitchella repens (Partridgeberry)</u>	<u>TRACE</u>	<u>---</u>		
	<u>Rubus flagellaris (Prickly Dewberry)</u>	<u>TRACE</u>	<u>---</u>		
	<u>White Ash</u>	<u>TRACE</u>	<u>---</u>		
	<u>Red Oak</u>	<u>TRACE</u>	<u>---</u>		
	<u>White Pine</u>	<u>TRACE</u>	<u>---</u>		

HYDROPHYTES				NON-HYDROPHYTES		
<u>---</u>	<u>---</u>	<u>---</u>	<u>---</u>	<u>---</u>	<u>1</u>	<u>---</u>
OBL	FACW	FAC	*OTHER	FAC-	FACU	UPL
Hydrophytes Subtotal (A): <u>---</u>				Non-hydrophytes Subtotal (B): <u>---</u>		
PERCENT HYDROPHYTES (100A/A+B): <u>0</u>						

HYDROLOGY

RECORDED DATA
 Stream, lake, or tidal gage Identification: _____
 Aerial photography Identification: _____
 Other Identification: _____

NO RECORDED DATA

OBSERVATIONS:
 Depth to Free Water: > 30"
 Depth to Saturation (including capillary fringe): > 30"
 Altered Hydrology (explain): _____

Inundated Saturated in upper 12" Water Marks Drift Lines Sediment Deposits Drainage Patterns within Wetland

OTHER (explain): _____

SOIL Sketch landscape position of this plot. Indicate relative position of other plot(s) and the wetland flag if not on plan.

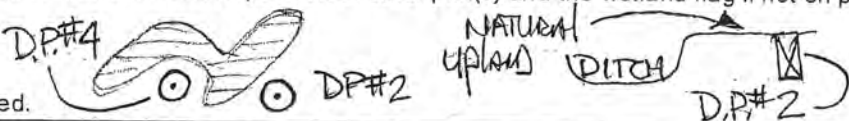

Submission of photo of plot is encouraged.

DEPTH	HORIZON	MATRIX COLOR	REDOXIMORPHIC FEATURES (color, abundance, size, contrast)	COMMENTS (USDA texture, nodules, concretions, masses, pore linings, restrictive layers, root distribution, soil water, etc.)
0-5"	A	10YR 4/3	—	Weak Fine Granular; Fine Sandy Loam; Very Friable
5-11"	Bw ₁	10YR 6/4	—	Weak Fine Granular; F.S. Loam Very Friable
11-25"	Bw ₂	10YR 6/6	—	Weak F. Granular; F.S. L. Very Friable
25-30"	C	10YR 7/4	—	Weak F. Granular; F.S. L. Very Friable Glacial Till

HYDRIC SOIL INDICATOR(S):

None observed.

REFERENCE(S):

OPTIONAL SOIL DATA

Taxonomic subgroup: Moderate Well Drained
 Soil drainage class: Moderate Well Drained
 Depth to active water table:
 NTCHS hydric soil criterion:

REFERENCE(S):

Montauk soil series (Rockingham County)

CONCLUSIONS

	YES	NO	REMARKS:
Hydrophytic vegetation criterion met?	<input type="checkbox"/>	<input checked="" type="checkbox"/>	
Hydric soils criterion met?	<input type="checkbox"/>	<input checked="" type="checkbox"/>	
Wetland hydrology criterion met?	<input type="checkbox"/>	<input checked="" type="checkbox"/>	
IS THIS DATAPOINT IN A WETLAND?	<input type="checkbox"/>	<input checked="" type="checkbox"/>	

PROJECT TITLE: EVANS Parcel (A); Londonderry TRANSECT:

PLOT: D.P.#2

PROJECT TITLE: Evans Parcel (44); Lombardy TRANSECT: _____ PLOT: D.P.#3
 DELINEATOR(S): BAG LAND CONSULTANTS DATE: 8-5-10

VEGETATION	Stratum and Species	Dominance Ratio	Percent Dominance	DOM	NWI Status
<u>Herbs</u>					
	<u>Scirpus cyperinus (Wool-grass)</u>	<u>20.5/44</u>	<u>47%</u>	<u>Y</u>	<u>FACW+</u>
	<u>Onoclea sensibilis (Sensitive Fern)</u>	<u>20.5/44</u>	<u>47%</u>	<u>Y</u>	<u>FACW</u>
	<u>Bidens sp. (Beggar-Ticks)</u>	<u>3/44</u>	<u>6%</u>	<u>N</u>	<u>—</u>
	<u>Fireweed</u>	<u>TRACE</u>	<u>—</u>		
	<u>Lady's Thumb</u>	<u>TRACE</u>	<u>—</u>		
	<u>GREEN Foxtail</u>	<u>TRACE</u>	<u>—</u>		
<hr/>					
<u>Others (>5' radius)</u>					
	<u>REED CANARY</u>	<u>TR</u>	<u>—</u>		
	<u>Prickly Dewberry</u>	<u>TR</u>	<u>—</u>		
	<u>Interrupted Fern</u>	<u>TR</u>	<u>—</u>		

HYDROPHYTES 2 NON-HYDROPHYTES _____
 OBL FACW FAC *OTHER FAC- FACU UPL
 Hydrophytes Subtotal (A): _____ Non-hydrophytes Subtotal (B): _____
 PERCENT HYDROPHYTES (100A/A+B): 100

HYDROLOGY

RECORDED DATA
 Stream, lake, or tidal gage Identification: _____
 Aerial photography Identification: _____
 Other Identification: _____

NO RECORDED DATA

OBSERVATIONS:
 Depth to Free Water: >30"
 Depth to Saturation (including capillary fringe): >30"
 Altered Hydrology (explain): EXCAVATED DITCH/TRENCH

Inundated Saturated in upper 12" Water Marks Drift Lines Sediment Deposits Drainage Patterns within Wetland

OTHER (explain): HARD PAN PERCHES WATER FOR SHORT DURATION.

SOIL Sketch landscape position of this plot. Indicate relative position of other plot(s) and the wetland flag if not on plan.

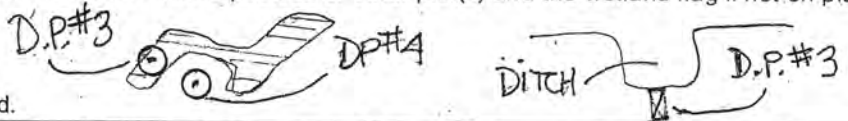

Submission of photo of plot is encouraged.

DEPTH	HORIZON	MATRIX COLOR	REDOXIMORPHIC FEATURES (color, abundance, size, contrast)	COMMENTS (USDA texture, nodules, concretions, masses, pore linings, restrictive layers, root distribution, soil water, etc.)
0-3"	A	10YR 3/3	—	Weak FINE GRANULAR; FSL VERY FRIABLE
3-13"	B/C	10YR 5/4	—	Moderate F. GRANULAR; FSL Friable
13-30"	C	2.5Y 5/3	7.5YR 3/4 MANY/Prominent @ 28"	Platy; FINE SANDY LOAM FIRM GLACIAL TILL

HYDRIC SOIL INDICATOR(S):

NON observed.

REFERENCE(S):

OPTIONAL SOIL DATA

Taxonomic subgroup:
Soil drainage class: Mod. Well DRAINED
Depth to active water table:
NTCHS hydric soil criterion:

REFERENCE(S): Montauk soil series
(Rockingham County)

CONCLUSIONS

	YES	NO	REMARKS:
Hydrophytic vegetation criterion met?	<input checked="" type="checkbox"/>	<input type="checkbox"/>	No shrubs, saplings, or tree species observed in EXCAVATION DITCH. No hydrology indicators of prim- ary No hydric soils present.
Hydric soils criterion met?	<input type="checkbox"/>	<input checked="" type="checkbox"/>	
Wetland hydrology criterion met?	<input type="checkbox"/>	<input checked="" type="checkbox"/>	
IS THIS DATAPOINT IN A WETLAND?	<input type="checkbox"/>	<input checked="" type="checkbox"/>	

PROJECT TITLE: EVANS Parcel 41; Londonderry TRANSECT: PLOT: D.P.#3

PROJECT TITLE: EVANS Parcel 4A; LONDONDERRY TRANSECT: _____ PLOT: D.P.# 4
 DELINEATOR(S): BAG LAND CONSULTANTS DATE: 8-5-10

VEGETATION	Stratum and Species	Dominance Ratio	Percent Dominance	DOM	NWI Status
<u>Herb:</u>	<u>Rubus hispidus (Bristle Dewberry)</u>	<u>38/54.5</u>	<u>69%</u>	<u>Y</u>	<u>FACW</u>
	<u>Vaccinium angustifolium (Lowbush Blue)</u>	<u>10.5/54.5</u>	<u>19%</u>	<u>N</u>	<u>FACU-</u>
	<u>Rubus allegheniensis (Blackberry)</u>	<u>3/54.5</u>	<u>—</u>		
	<u>Trientalis borealis (Starflower)</u>	<u>3/54.5</u>	<u>—</u>		
<u>Others:</u>	<u>Prickly Dewberry, Red Oak, W. Ash, W. Birch, Red Raspberry, Path Rush, Scarlet Oak, Carex sp., Potentilla sp., E. Hemlock, Red Oak, *Red Maple, *White Pine</u> <u>* denotes dominant species</u>				

HYDROPHYTES				NON-HYDROPHYTES		
<u>1</u>						
OBL	FACW	FAC	*OTHER	FAC-	FACU	UPL
Hydrophytes Subtotal (A): _____				Non-hydrophytes Subtotal (B): _____		
PERCENT HYDROPHYTES (100A/A+B): <u>100</u>						

HYDROLOGY

RECORDED DATA
 Stream, lake, or tidal gage Identification: _____
 Aerial photography Identification: _____
 Other Identification: _____

NO RECORDED DATA

OBSERVATIONS:
 Depth to Free Water: > 28"
 Depth to Saturation (including capillary fringe): > 28"
 Altered Hydrology (explain): _____

Inundated Saturated in upper 12" Water Marks Drift Lines Sediment Deposits Drainage Patterns within Wetland

OTHER (explain): _____

SOIL Sketch landscape position of this plot. Indicate relative position of other plot(s) and the wetland flag if not on plan.

D.P. #4



Submission of photo of plot is encouraged.

DEPTH	HORIZON	MATRIX COLOR	REDOXIMORPHIC FEATURES (color, abundance, size, contrast)	COMMENTS (USDA texture, nodules, concretions, masses, pore linings, restrictive layers, root distribution, soil water, etc.)
0-6"	A	10YR 4/2	—	Weak Fine Granular; Fine Sandy Loam; Very Friable
6-11"	Bw ₁	10YR 5/4	—	Weak F. GRAD; FSL; V. Fe.
11-22"	Bw ₂	10YR 6/6	—	Weak F. GRAD; FSL; V. Fe.
22-28"	C	2.5Y 6/2	—	Weak F. GRAD; FSL; V. Fe.
			No redox observed @ 28"	GLACIAL Till

HYDRIC SOIL INDICATOR(S):

None observed

REFERENCE(S):

OPTIONAL SOIL DATA

Taxonomic subgroup:
Soil drainage class: Mod. Well Drained
Depth to active water table:
NTCHS hydric soil criterion:

REFERENCE(S): Montauk soil series (Rockingham County)

CONCLUSIONS

	YES	NO	REMARKS:
Hydrophytic vegetation criterion met?	<input checked="" type="checkbox"/>	<input type="checkbox"/>	Upland natural setting with four (4) recent tree stumps of W. Pine & R. Maple
Hydric soils criterion met?	<input type="checkbox"/>	<input checked="" type="checkbox"/>	
Wetland hydrology criterion met?	<input type="checkbox"/>	<input checked="" type="checkbox"/>	
IS THIS DATAPOINT IN A WETLAND?	<input type="checkbox"/>	<input checked="" type="checkbox"/>	

PROJECT TITLE: EVANS Parcel 44; land survey TRANSECT:

PLOT: D.P.#4



