

CITY COUNCIL MEETING

AGENDA ITEM II



CITY OF FRANKLIN
COUNCIL AGENDA REPORT

November 5, 2012

From: Elizabeth A. Dragon

Subject: Stanley Weglarz request to approach the Council regarding his desire to have the City Donate Right of Way land to him along Industrial park drive.

Recommended Action:

Staff Recommends the City keep the Right of Way property for Industrial park drive intact and Deny Mr. Weglarz request.

Discussion: Included in the Council packet is a letter from Mr. Weglarz requesting moving boundary lines on property he purchased just over a year ago which abuts Industrial park drive. He requests the City Donate this property to him. Also included in the packet is a map of the area and a letter from DOT which discusses how Mr. Weglarz driveway was moved as part of the US Route 3/Industrial Park Drive intersection project.

I received Mr. Weglarz letter in September and asked that Director Lewis and Director Sullivan review the request. As written staff does not recommend giving right of way land alongside Industrial drive to Mr. Weglarz and sees no benefit from doing so.

This was communicated to Mr. Weglarz and when asked what would be the reason the City would make such a donation to private property owner. The only reason he gave was increased tax revenue. However, this is such a small piece of property any increase in tax revenue would be negligible and the possible issues with right of way maintenance for Industrial park drive certainly outweighs any benefit.

Mr. Weglarz had also attended a Municipal Services Committee meeting back in May of 2012 and made the same request. The committee made no recommendation and told him to come before the City Council.

Stanley Weglarz
602 S. Main St.
Franklin, NH 03235

4/17/2012 & 9/28/12

Tel 934 3439

City of Franklin

The intersection of route 3 and industrial park drive has been redesigned and work is scheduled for 2014. Address 605 so main st lot 162-012-00 will be significantly impacted. The eastern boundary abutting route 3 will be moved away from the road to provide better sighting for the intersection. The lot loss will be on a line 11 feet from the south point to 16 feet northern point.

I have requested that the 605 driveway be moved from route 3 to the industrial park drive in order to improve safety. This has been approved by the state highway design dept. pending city approval.

In conjunction with these plans I request that the southern boundary (that abutting industrial park drive) be moved south to the shoulder margin usually reserved for city roads. Also that this boundary move extend the entire length of the 605 lot or ⁵⁴⁶~~211~~ feet to the Webster Valve boundary line.

I have owned this lot for the past 1 year and have improved its appearance

Stanley Weglarz



THE STATE OF NEW HAMPSHIRE
DEPARTMENT OF TRANSPORTATION



CHRISTOPHER D. CLEMENT,
SR.
COMMISSIONER

JEFF BRILLHART, P.E.
ASSISTANT COMMISSIONER

FRANKLIN
X-A000(737)
13928A
US Route 3/Industrial Park Drive Intersection Improvement

Bureau of Highway Design
Room 200
Tel. (603) 271-2297
Fax (603) 271-7025

September 20, 2012

Ms. Elizabeth Dragon
Franklin City Manager
316 Central Street
Franklin, NH
03235

Dear Ms. Dragon:

As part of the US Route 3/Industrial Park Drive intersection project, the drive at the north west corner of the intersection to the Weglarz property will be impacted. At the November 3, 2011 Public Hearing, Mr. Weglarz requested the driveway be relocated to Industrial Drive. We will accommodate this request provided that the City of Franklin also concurs. We have drafted a revised driveway, highlighted on the attached plan. This will provide for safer access and allow vehicles to turn around to head out of the driveway where today there is no accommodation to turn around. In addition, a break in the median island could be provided to allow lefts out of the subject driveway.

Would you please review this with appropriate City staff and provide us any comments. If you have any questions or comments, please write or call.

Sincerely,

Alexander V. Vogt, P.E.
Project Manager

AVV/avv

S:\FRANKLIN\13928A\LETTERS\ED9202012.DOC

102
011

93/535
14 AC. ±

FRANKLIN
13928A
US 3/Industrial Park Dr.

Preliminary Plans
Subject to change

Steve Wolf
9/20/2012

ASE. BENEFITS
DEVELOPMENTS.

EXISTING
ROW

APPROX. EXIST.
ROW

APPROX. EXIST. ROW

N 62°-06'-09.1" W

optional break in median

APPROX. EXIST. ROW

Relocated Driveway

APPROX. EXIST.
ROW

EXISTING
ROW

WEGLARZ,
STANLEY

11

3252/1802
2.28 AC. ±

102
012

P.C.L.S. 13. 14
15 HAVE ACC
RIGHTS TO
ROADWAY

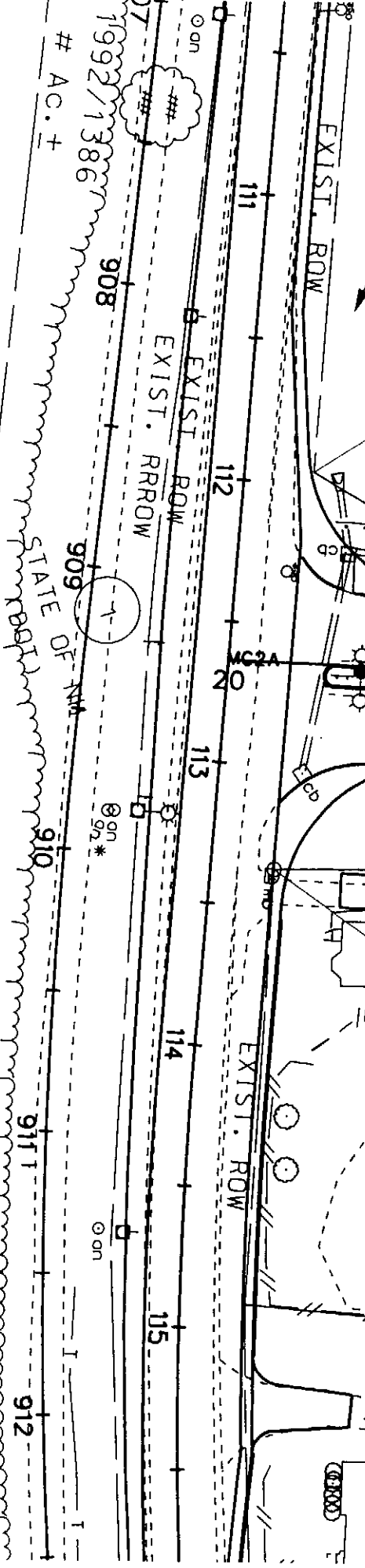

AC. ±
1992/1386

STATE OF NM

911

912

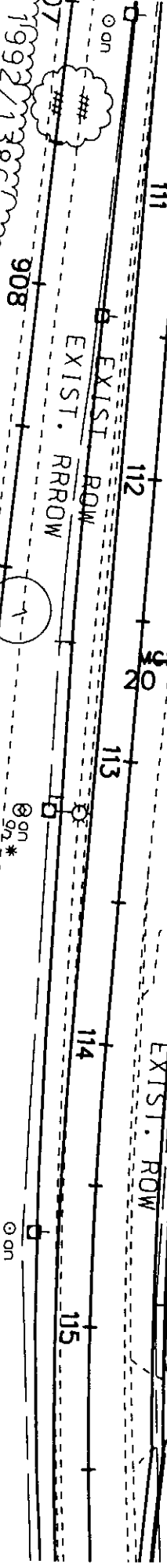

MC2A
20

ROW
post

ROW
post