

PLUMMER MOTZ LIBRARY
FALMOUTH, MAINE

REVISIONS		
#	DATE	DESCRIPTION
1	10-06-12	PRELIMINARY PRICING

DATE:	10.06.12
PROJECT #:	050212
DRAWN BY:	KW
CHECKED BY:	RLD
DRAWING SCALE:	1/8"=1'-0"

SHEET TITLE
SCHEMATIC FIRST FLOOR PLAN

A100

© COPYRIGHT 1985-2008
REPRODUCTION OR USE OF THIS DOCUMENT WITHOUT WRITTEN PERMISSION OF GAWRON TURGEON ARCHITECTS IS PROHIBITED.

AI SCHEMATIC FIRST FLOOR PLAN
1/8"=1'-0" 15,220 SF (5,000 SF ADDITION)

1301200212 - Plummer Motz Library - Architecture & Interior Design Development 05/12 - Plummer Motz, 2012 Aug. 1st Floor - Schematic. 10/06/12 11:41:11 PM. 0400

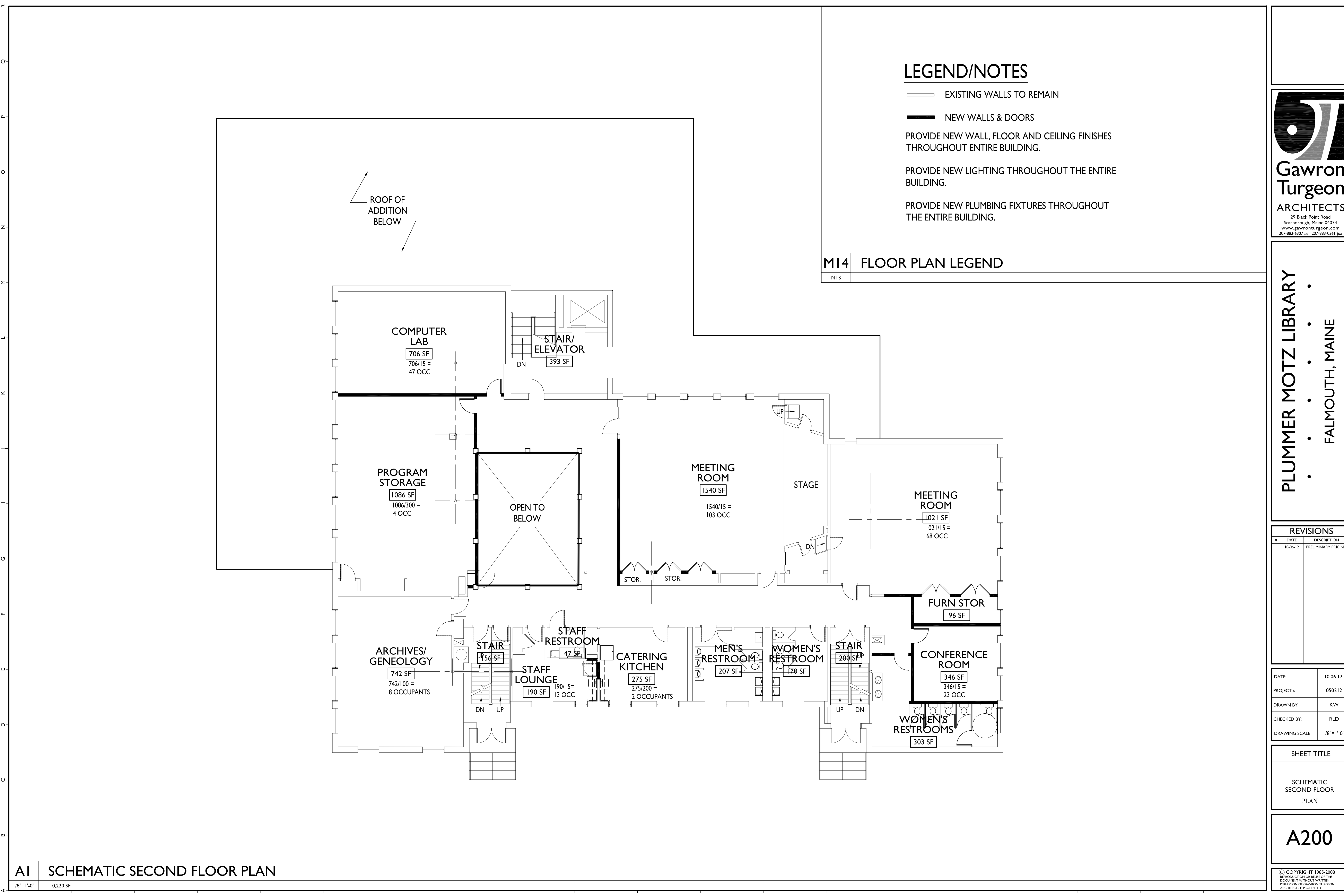

LEGEND/NOTES

— EXISTING WALLS TO REMAIN

— NEW WALLS & DOORS

PROVIDE NEW WALL, FLOOR AND CEILING FINISHES THROUGHOUT ENTIRE BUILDING.

PROVIDE NEW LIGHTING THROUGHOUT THE ENTIRE BUILDING.

PROVIDE NEW PLUMBING FIXTURES THROUGHOUT THE ENTIRE BUILDING.

M14 FLOOR PLAN LEGEND

NTS



PLUMMER MOTZ LIBRARY
FALMOUTH, MAINE

REVISIONS

#	DATE	DESCRIPTION
1	10.06.12	PRELIMINARY PRICING

DATE:	10.06.12
PROJECT #:	050212
DRAWN BY:	KW
CHECKED BY:	RLD
DRAWING SCALE:	1/8"=1'-0"

SHEET TITLE
SCHEMATIC SECOND FLOOR PLAN

A200

© COPYRIGHT 1985-2008
REPRODUCTION OR USE OF THIS
DOCUMENT WITHOUT WRITTEN
PERMISSION OF GAWRON TURGEON
ARCHITECTS IS PROHIBITED.

AI SCHEMATIC SECOND FLOOR PLAN

1/8"=1'-0" 10,220 SF

