

## Ross Povenmire

---

**From:** Kirt Macneill <kirtmacneill@yahoo.com>  
**Sent:** Monday, December 12, 2016 3:37 PM  
**To:** Ross Povenmire  
**Subject:** Re: Boxford DNI for removal of trees

Hi Ross, This is Kirt MacNeill emailing you to request a determination of negligible impact for the tree removal previously discussed at 10 Fish Brook Rd. in Boxford. You have photos of the three trees in question and I would like to facilitate the removal of these trees by attending a meeting on Thursday the 15th. I will bring a check for \$50 for the application fee momentarily. Thank you very much for your time.  
Sincerely, Kirt

Sent from my iPhone

On Dec 6, 2016, at 1:19 PM, Ross Povenmire <[dircons@town.boxford.ma.us](mailto:dircons@town.boxford.ma.us)> wrote:

Hello Kirt,

Sorry about the delay in getting back to you. As stated at the site walk, please send me a letter or email requesting a "Determination of Negligible Impact" for the removal of trees as discussed. I have photos and will prepare a rudimentary site map showing the location of the trees. The application fee is \$50, check made out to Town of Boxford. If I have this by 2:00 on the 13<sup>th</sup> I can get you on the agenda for the 15<sup>th</sup>.

Ross

DNI 2016-30

40-05-07

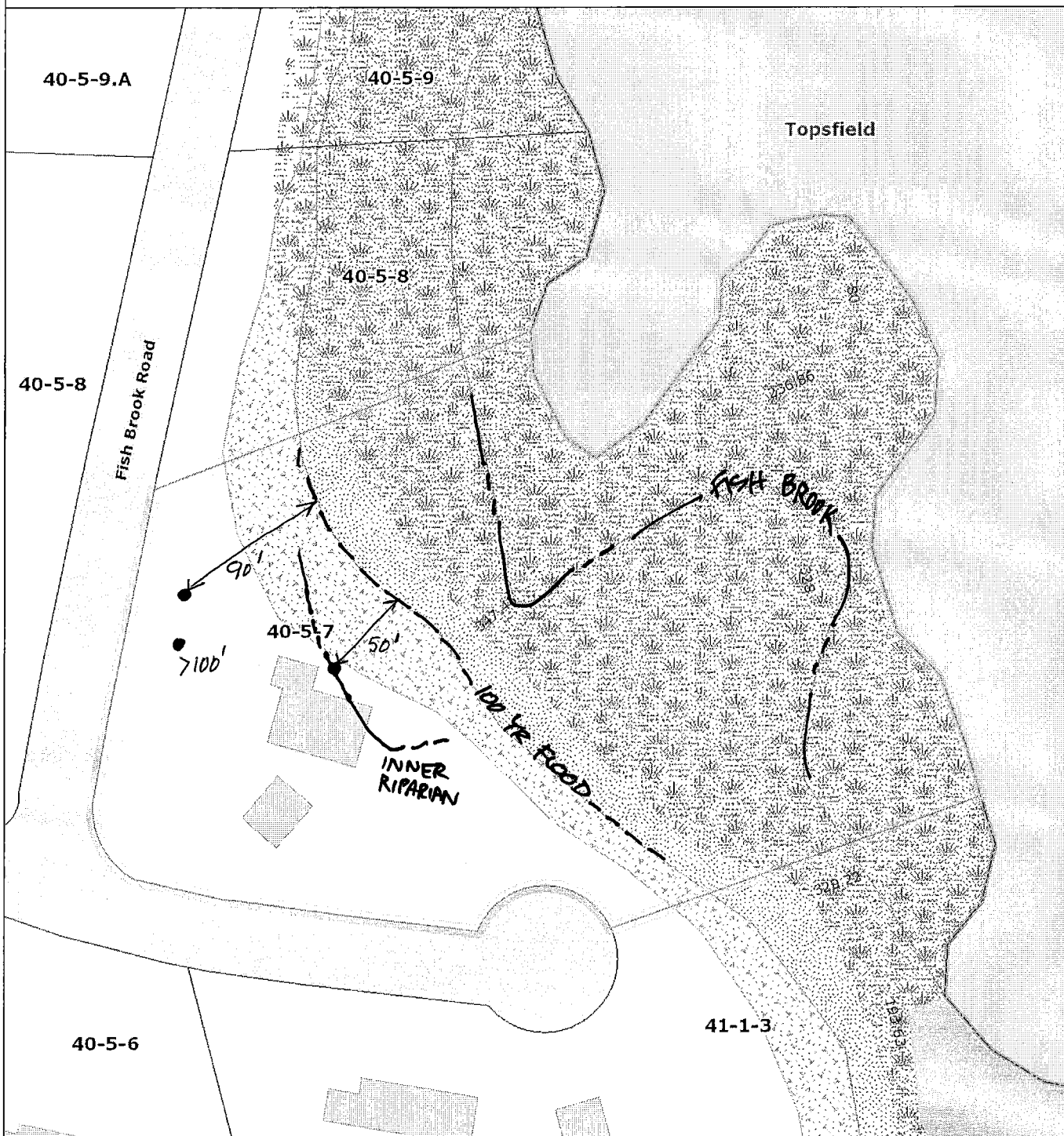

- Municipal
- Building Footprints
- Parcels
- Easements
- Trails
- Road Right of Way
- Hydrographic Features
- Streams
- Floodplain
- 100-Year Floodplain
- 500-Year Floodplain
- Wetlands
- Commercial and Industrial Land Use
- Commercial Land Use
- Industrial Land Use

1" = 77 ft



- Exempt Lands - State
- Exempt Lands - County
- Exempt Lands - Municipal
- Exempt Lands - Private



Horizontal Datum: MA Stateplane Coordinate System, Datum NAD83, Meters Data Sources: The data for this map was produced by Merrimack Valley Planning Commission (MVPC) using data provided by the Town of Boxford. Additional data provided by the Executive Office of Environmental Affairs/MassGIS. The information depicted on this map is for planning purposes only. It may not be adequate for legal boundary definition or regulatory interpretation. THE TOWN OF BOXFORD MAKES NO WARRANTIES, EXPRESSED OR IMPLIED, CONCERNING THE ACCURACY, COMPLETENESS, RELIABILITY, OR SUITABILITY OF THESE DATA. THE TOWN OF BOXFORD DOES NOT ASSUME ANY LIABILITY ASSOCIATED WITH THE USE OR MISUSE OF THIS INFORMATION.