

LEGEND

- EXISTING GROUND CONTOUR
- EXISTING SPOT ELEVATION
- PROPOSED GRADE
- PROPOSED SPOT GRADE
- STORM DRAIN & MANHOLE
- STORM DRAIN & HEADWALL
- STORM DRAIN & END SECTION
- UTILITY POLE WITH GUY SUPPORT
- OVERHEAD ELECTRIC & TELEPHONE
- TREE LINE
- STONE WALL
- PAVEMENT SAWCUT
- REINFORCED CONCRETE
- PROPOSED FULL-DEPTH PAVEMENT
- RIPRAP / STONE
- ROCK/BOULDER
- CONIFEROUS TREE
- DECIDUOUS TREE

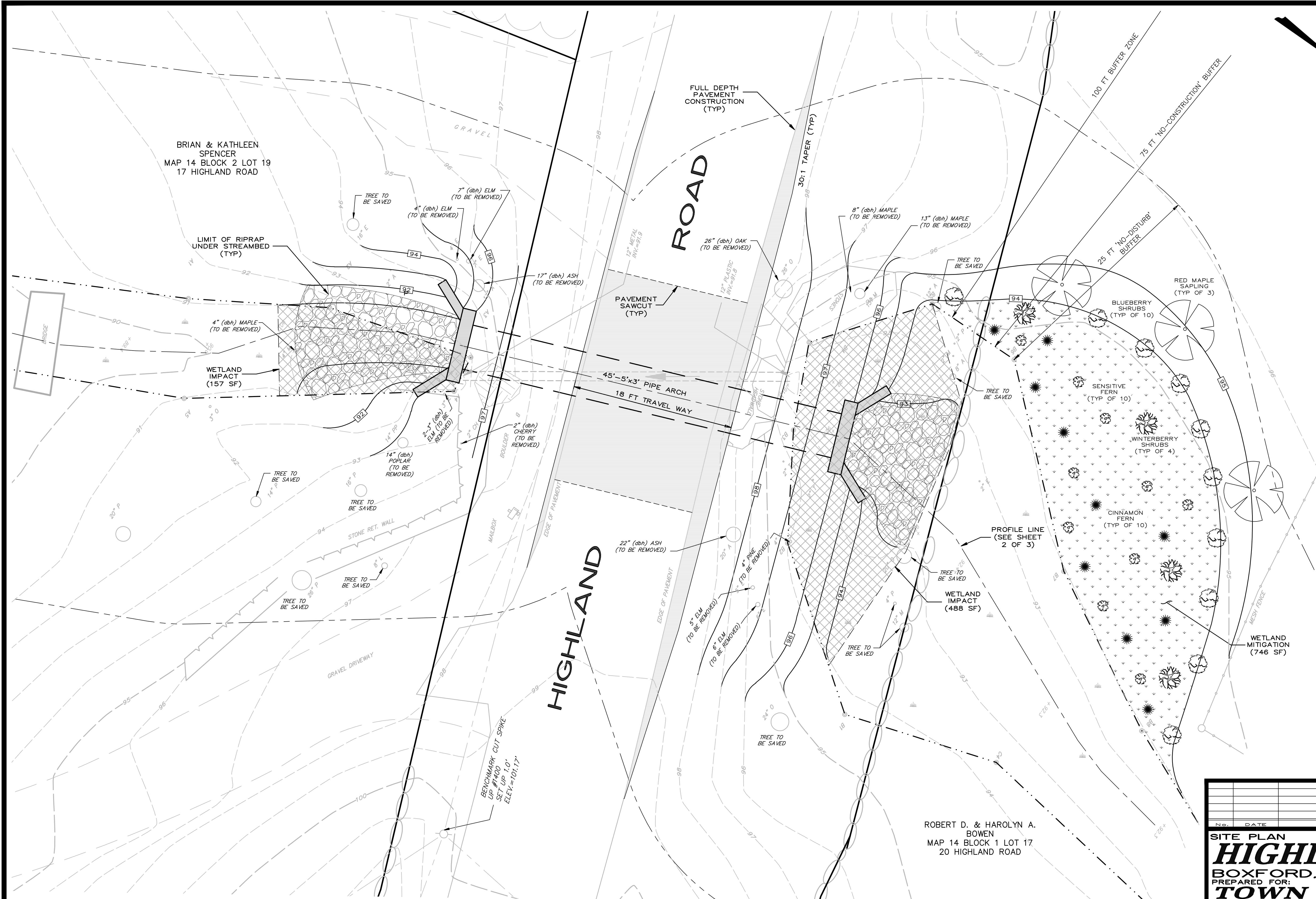

BRIAN & KATHLEEN SPENCER
MAP 14 BLOCK 2 LOT 19
17 HIGHLAND ROAD

ROBERT D. & HAROLYN A. BOWEN
MAP 14 BLOCK 1 LOT 17
20 HIGHLAND ROAD

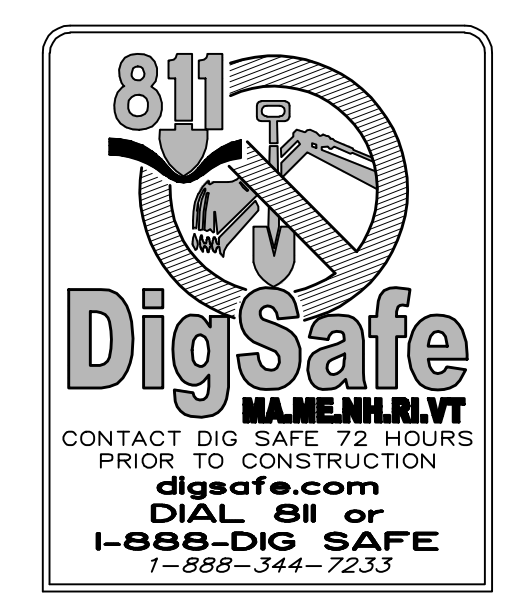

UTILITY NOTE
THE UNDERGROUND UTILITIES DEPICTED HEREON HAVE BEEN LOCATED FROM FIELD SURVEY INFORMATION AND PLOTTED FROM EXISTING DRAWINGS. THE SURVEYOR MAKES NO GUARANTEES THAT THE UNDERGROUND UTILITIES DEPICTED COMPRISE ALL SUCH UTILITIES IN THE AREA, EITHER IN SERVICE OR ABANDONED. THE SURVEYOR FURTHER DOES NOT WARRANT THAT THE UNDERGROUND UTILITIES SHOWN ARE IN THE EXACT LOCATION INDICATED ALTHOUGH THEY ARE LOCATED AS ACCURATELY AS POSSIBLE FROM THE INFORMATION AVAILABLE. THE SURVEYOR HAS NOT PHYSICALLY LOCATED THE UNDERGROUND PORTIONS OF THE UTILITIES.

- WETLAND PLANTING PLAN**
- SAPLINGS
 - RED MAPLE (3)
 - SHRUBS
 - BLUEBERRY (10)
 - WINTERBERRY (4)
 - HERBS
 - CINNAMON FERN (10)
 - SENSITIVE FERN (10)

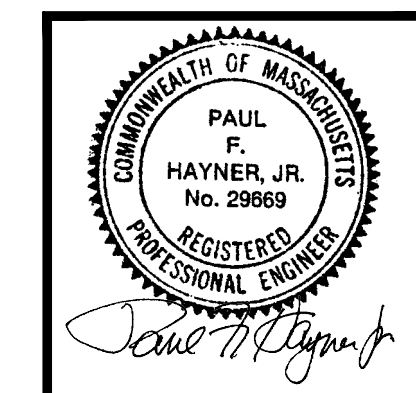

<p>SITE PLAN HIGHLAND ROAD BOXFORD, MASSACHUSETTS PREPARED FOR: TOWN OF BOXFORD 78 SPOFFORD RD. BOXFORD, MASSACHUSETTS 01921 (978) 352-6555</p>	<p>SCALE: 1"=5 Feet 1"=1.524 Meters</p> <p>17 NOVEMBER 2016</p> <p>HSI Hayner/Swanson, Inc. Three Congress Street Nashua, New Hampshire 03062-3301 Tel (603) 883-2057 www.haynerswanson.com Fax (603) 883-5057</p>
<p>FIELD BOOK: _____ DRAWING NAME: 5387 FQ22</p> <p>DRAWING LOCATION: C:\Q\5387.DWG</p>	<p>5387 1 OF 3</p> <p>File Number Sheet</p>

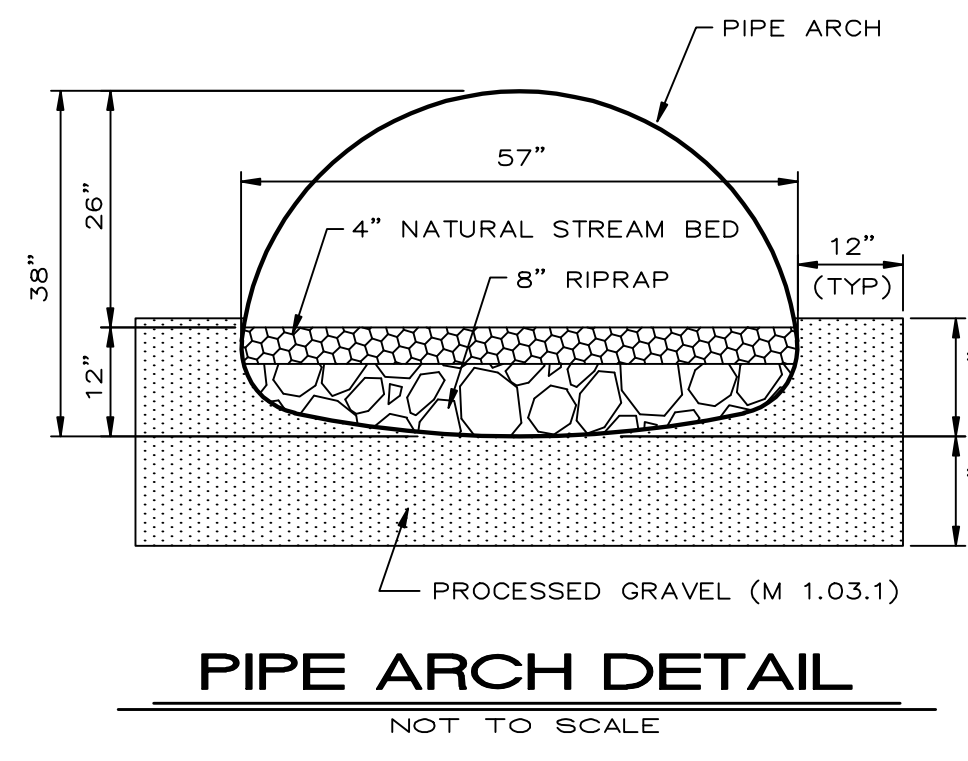
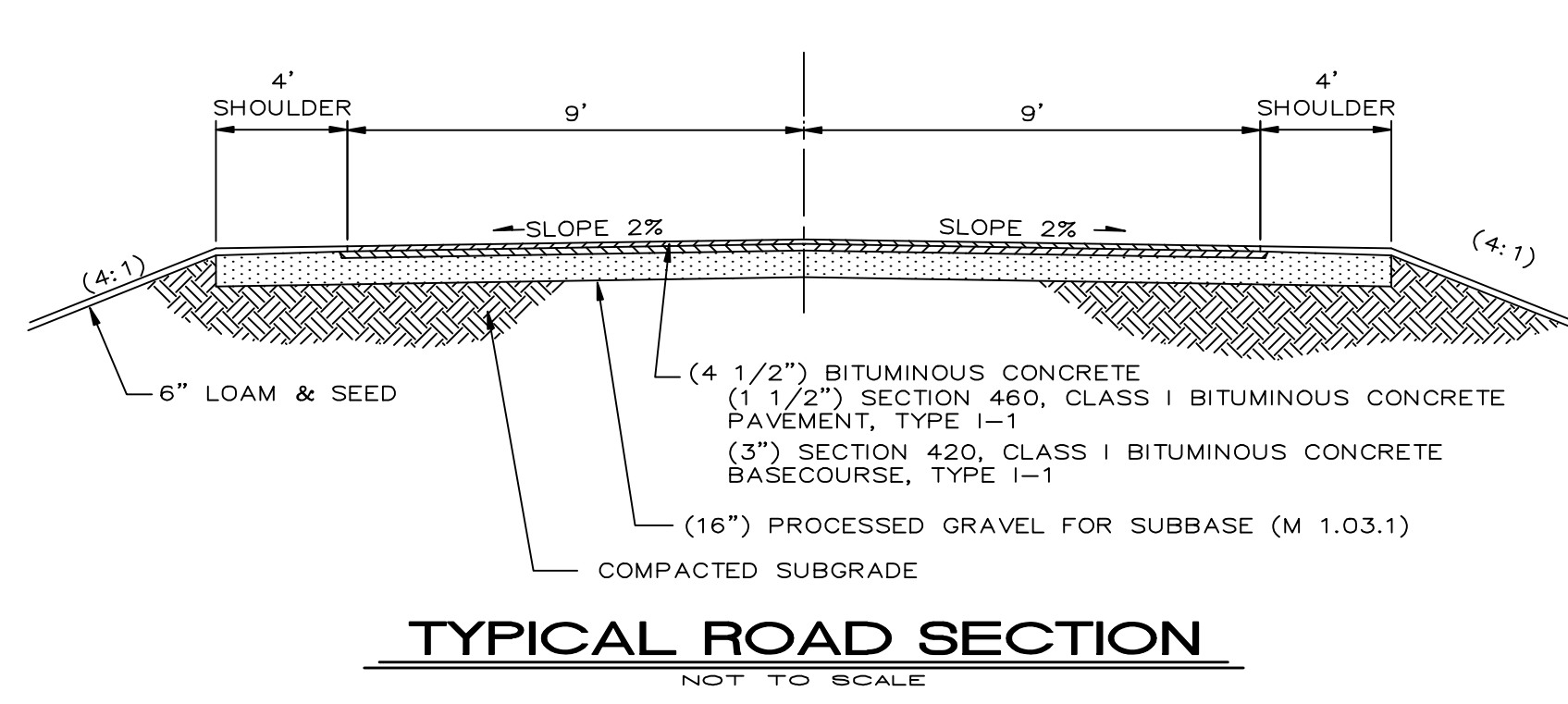
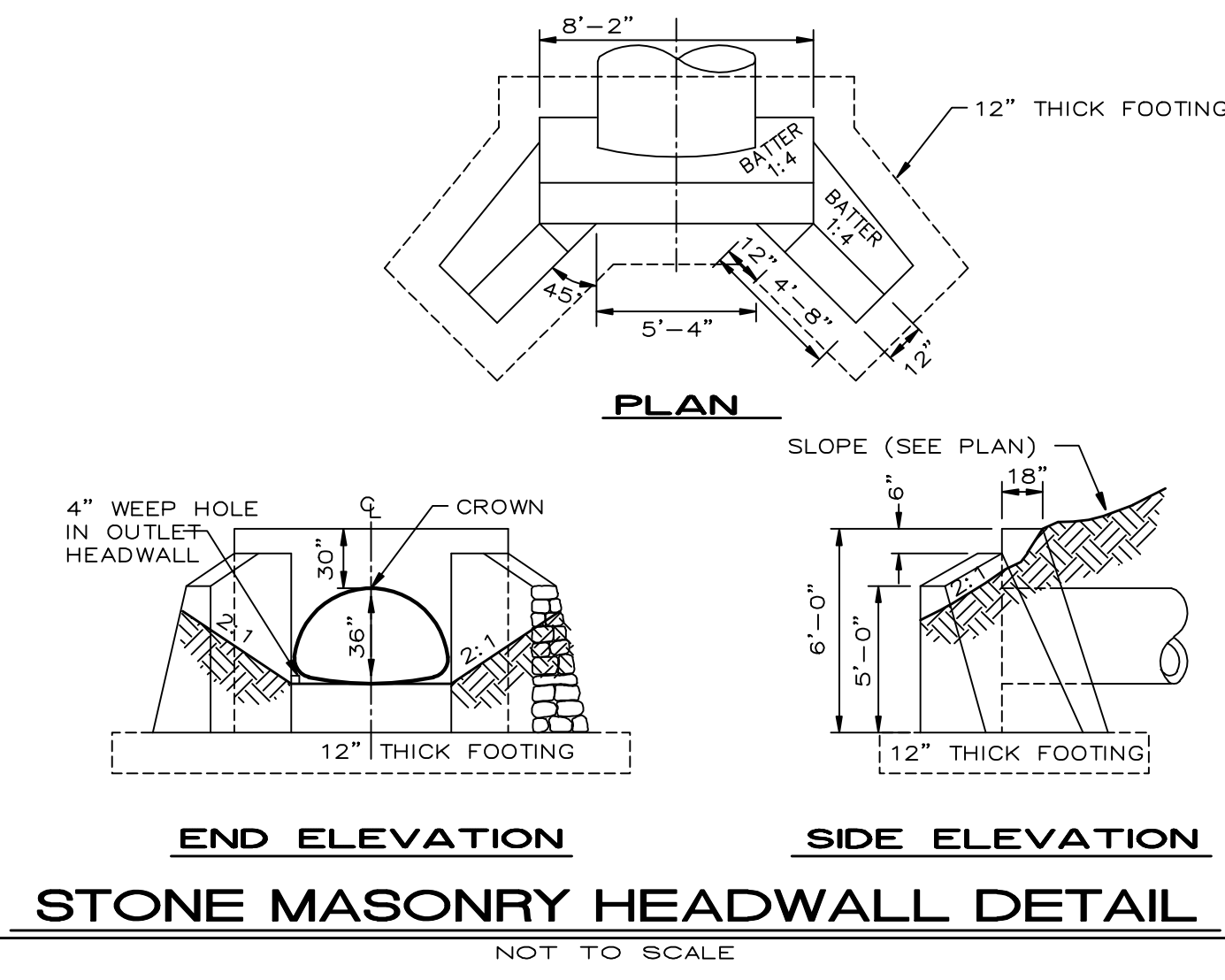
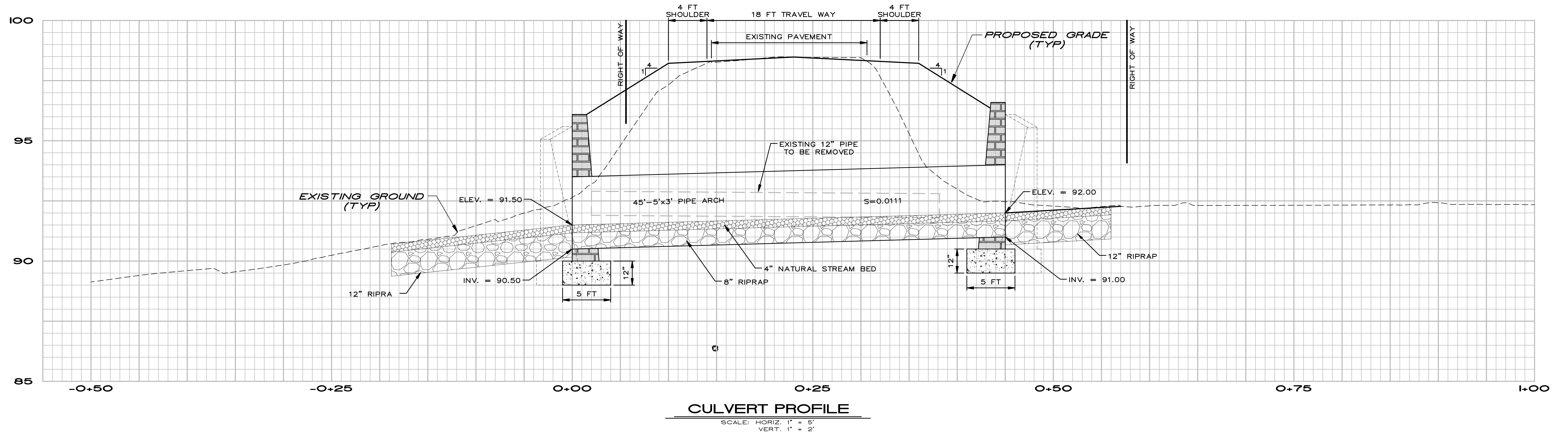

CONSTRUCTION NOTES & SEQUENCING OF CONSTRUCTION:

1. ALL WORK SHALL CONFORM TO THE PLANS, SPECIFICATIONS AND THE ORDER OF CONDITIONS FROM THE BOXFORD CONSERVATION COMMISSION.
2. THE CONTRACTOR SHALL SCHEDULE AND COORDINATE ALL WORK WITH THE BOXFORD DEPARTMENT OF PUBLIC WORKS (DPW). THE CONTRACTOR SHALL SUBMIT A PLAN FOR ANY NECESSARY ROAD CLOSURES TO THE TOWN DPW FOR REVIEW AND APPROVAL. ROAD CLOSURES SHALL BE MINIMIZED TO THE MAXIMUM EXTENT POSSIBLE, AND PUBLIC NOTICE SHALL BE GIVEN 7 DAYS IN ADVANCE OF ANY ROAD CLOSURE.
3. ALL SEDIMENTATION AND EROSION CONTROL DEVICES SHALL BE INSTALLED BY THE CONTRACTOR PRIOR TO CONSTRUCTION, AND INSPECTED BY THE TOWN DPW OR DESIGNEE PRIOR TO COMMENCEMENT OF WORK.
4. THE WORK SHALL BE SCHEDULED TO OCCUR IN THE DRY SEASON DURING PERIODS OF MINIMAL OR NO FLOW IN THE STREAM BED. THE CONTRACTOR SHALL SUBMIT A WORK PLAN AND SCHEDULE TO THE BOXFORD DPW AND CONSERVATION COMMISSION FOR REVIEW AND APPROVAL PRIOR TO CONSTRUCTION. THE WORK PLAN SHALL TAKE INTO CONSIDERATION PREDICTED WEATHER CONDITIONS DURING THE CONSTRUCTION PERIOD. THE WORK PLAN SHALL INCLUDE SUMPS IN EXCAVATED TRENCH FOR NEW CULVERT (AS NEEDED) AND DISCHARGE TO DE-WATERING BAGS PLACED ON DOWNSLOPE SIDE OF CULVERT AS SHOWN ON THE PLANS, AND HAVE CONTINGENCY PLANS FOR UNEXPECTED STORM EVENTS. THE CONTRACTOR SHALL BE RESPONSIBLE FOR THE CONTROL OF GROUND WATER AND STORMWATER AT ALL TIMES DURING CONSTRUCTION INCLUDING MAINTAINING ALL EROSION CONTROL DEVICES AS NEEDED TO PREVENT SEDIMENT FROM LEAVING THE SITE AND ENTERING WETLAND RESOURCE AREAS.
5. EXISTING STREAMBED MATERIAL SHALL BE SALVAGED FOR REUSE IN THE PROPOSED STREAMBED AS SHOWN ON THE PLANS.
6. UPON COMPLETION OF THE CULVERT INSTALLATION, EXCAVATE AND GRADE THE WETLAND REPLICATION AREA. REPLICATION AREA AND SIDE SLOPES ARE TO BE OVER EXCAVATED TO RECEIVE 6" TO 8" OF LOAM TO REACH PROPOSED FINISH GRADE. PLANT REPLICATION AREA WITH LISTED SPECIES, AND THEN SEED WITH A WETLAND MEADOW SEED MIX. INSTALL ADDITIONAL EROSION CONTROL MEASURES ALONG THE UPSLOPE AND DOWN SLOPE SIDES OF THE REPLICATION AREA AFTER COMPLETION OF GRADING OPERATIONS.
7. ALL EROSION AND SEDIMENTATION CONTROL DEVICES SHALL BE REMOVED UPON COMPLETION OF THE WORK SUBJECT TO APPROVAL OF THE BOXFORD CONSERVATION COMMISSION AND BOXFORD DPW.

No.	DATE	REVISION	BY

DETAIL SHEET
HIGHLAND ROAD
BOXFORD, MASSACHUSETTS
PREPARED FOR:
TOWN OF BOXFORD
78 SPOFFORD RD. BOXFORD, MASSACHUSETTS 01921 (978) 352-6555

SCALE AS SHOWN

17 NOVEMBER 2016

Hayner/Swanson, Inc.
Three Congress Street Nashua, New Hampshire 03062-3301
Tel (603) 883-2057 www.haynerswanson.com Fax (603) 883-5057

FIELD BOOK: ---
DRAWING LOCATION: C:\Q\5387\DWG

DRAWING NAME: 5387 FQ22
File Number: 5387
Sheet: 2 OF 3

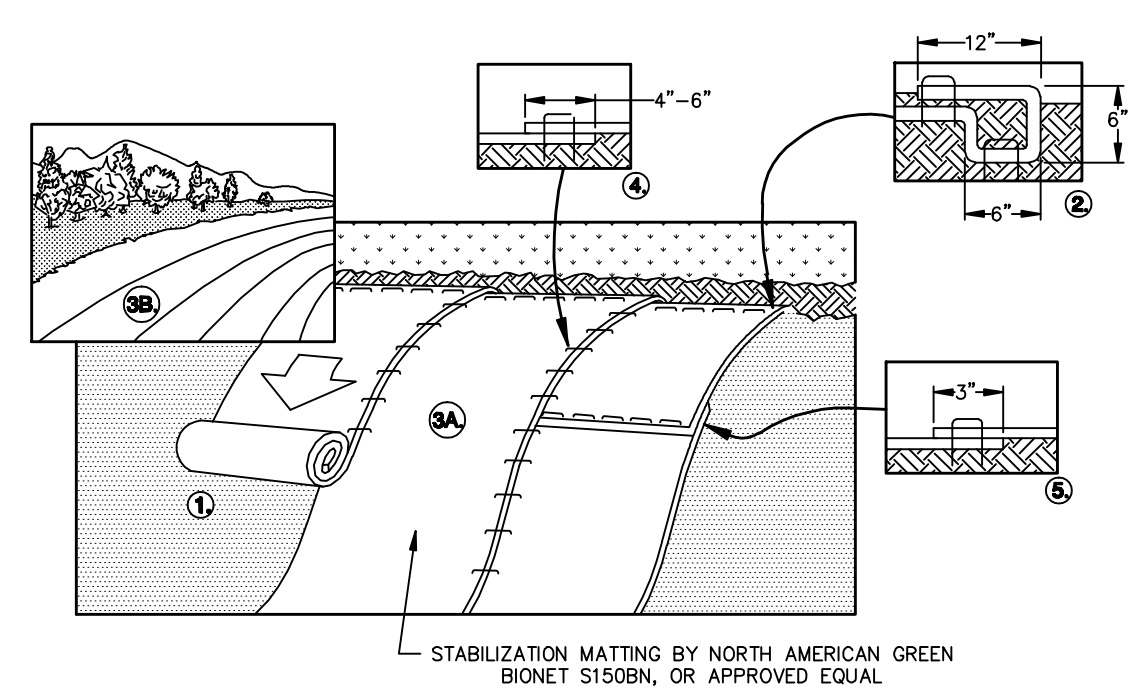
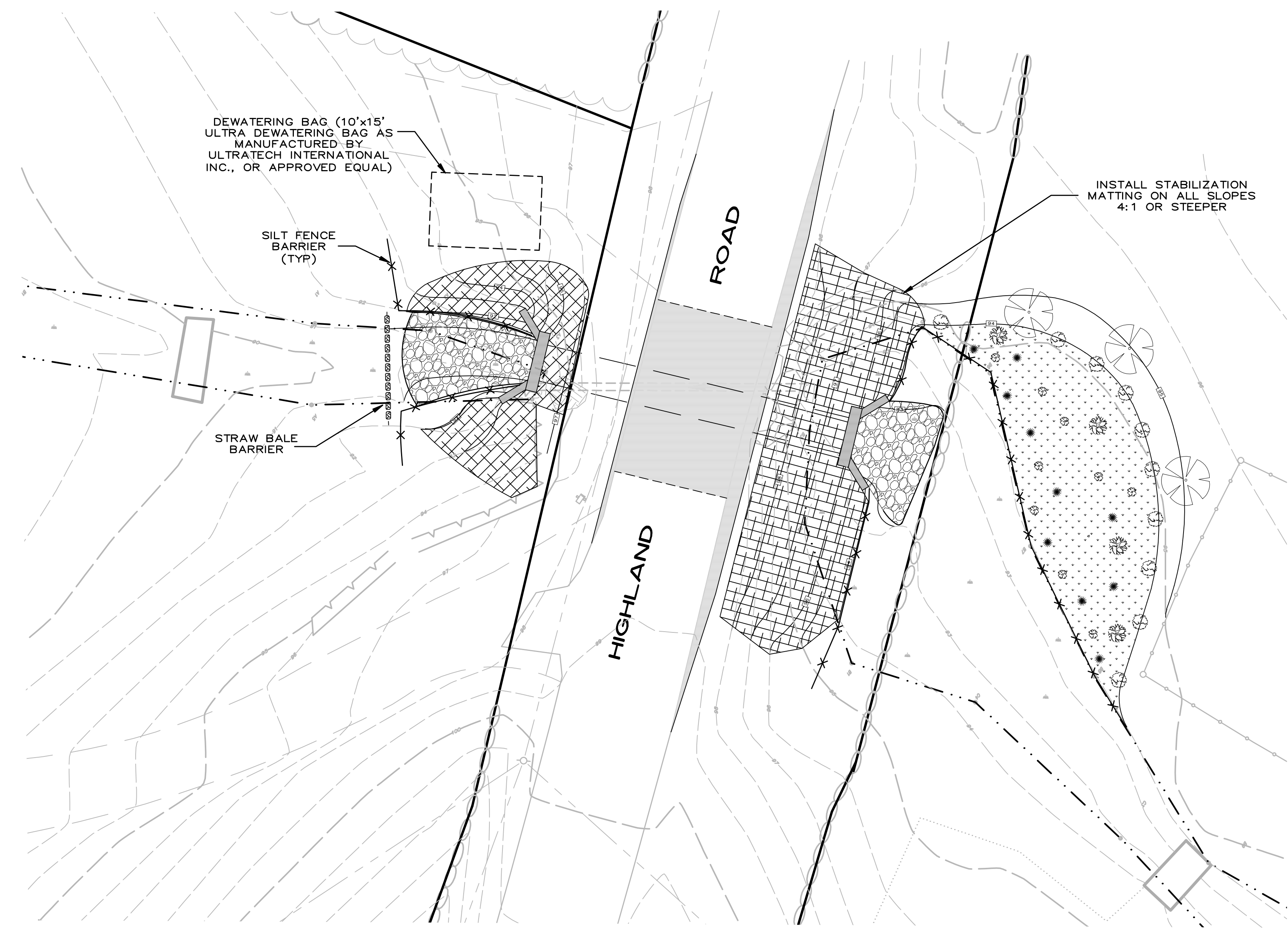
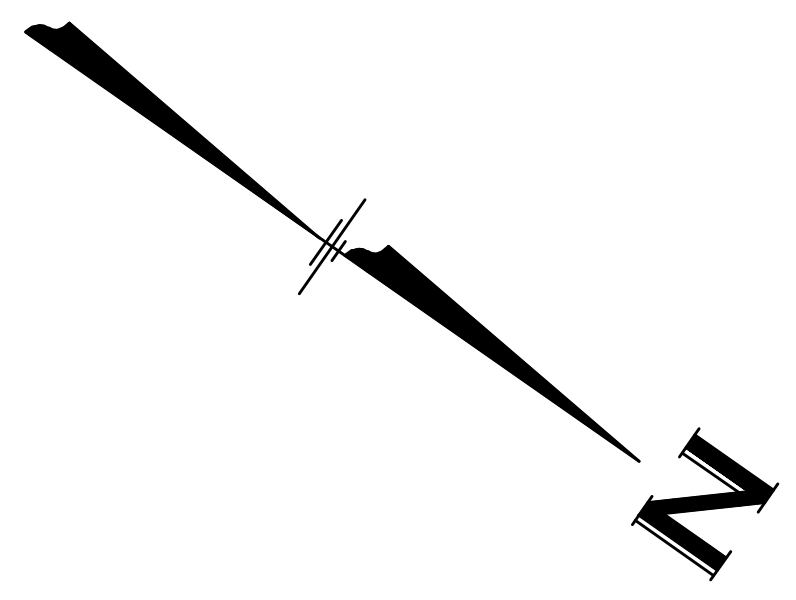

1. PREPARE SOIL BEFORE INSTALLING BLANKETS, INCLUDING ANY NECESSARY APPLICATION OF LIME, FERTILIZER, AND SEED.
 2. BEGIN AT THE TOP OF THE SLOPE BY ANCHORING THE BLANKET IN A 6" DEEP X 6" WIDE TRENCH WITH APPROXIMATELY 12" OF BLANKET EXTENDED BEYOND THE UP-SLOPE PORTION OF THE TRENCH. ANCHOR THE BLANKET WITH A ROW OF STAPLES/STAKES APPROXIMATELY 12" APART IN THE BOTTOM OF THE TRENCH. BACKFILL AND COMPACT THE TRENCH AFTER STAPLING. APPLY SEED TO COMPACTED SOIL AND FOLD REMAINING 12" PORTION OF BLANKET BACK OVER SEED AND COMPACTED SOIL. SECURE BLANKET OVER COMPACTED SOIL WITH A ROW OF STAPLES/STAKES SPACED APPROXIMATELY 12" APART ACROSS THE WIDTH OF THE BLANKET.
 3. ROLL THE BLANKETS (A.) DOWN OR (B.) HORIZONTALLY ACROSS THE SLOPE. BLANKETS WILL UNROLL WITH APPROPRIATE SIDE AGAINST THE SOIL SURFACE. ALL BLANKETS MUST BE SECURELY FASTENED TO SOIL SURFACE BY PLACING STAPLES/STAKES IN APPROPRIATE LOCATIONS AS PER MANUFACTURER'S RECOMMENDATION.
 4. THE EDGES OF PARALLEL BLANKETS MUST BE STAPLED WITH MINIMUM 6" OVERLAP. TO ENSURE PROPER SEAM ALIGNMENT, PLACE THE EDGE OF THE OVERLAPPING BLANKET (BLANKET BEING INSTALLED ON TOP) EVEN WITH THE SEAM STITCH ON THE PREVIOUSLY INSTALLED BLANKET.
 5. CONSECUTIVE BLANKETS SPICED DOWN THE SLOPE MUST BE PLACED END OVER END (SHINGLE STYLE) WITH AN APPROXIMATE 3" OVERLAP. STAPLE THROUGH OVERLAPPED AREA, APPROXIMATELY 12" APART ACROSS ENTIRE BLANKET WIDTH.
 6. PLACE STAPLES/STAKES PER MANUFACTURE RECOMMENDATION FOR THE APPROPRIATE SLOPE BEING APPLIED.
- NOTE: IN LOOSE SOIL CONDITIONS, THE USE OF STAPLE OR STAKE LENGTHS GREATER THAN 6" MAY BE NECESSARY TO PROPERLY SECURE THE BLANKETS.

STABILIZATION MATTING DETAIL
NOT TO SCALE

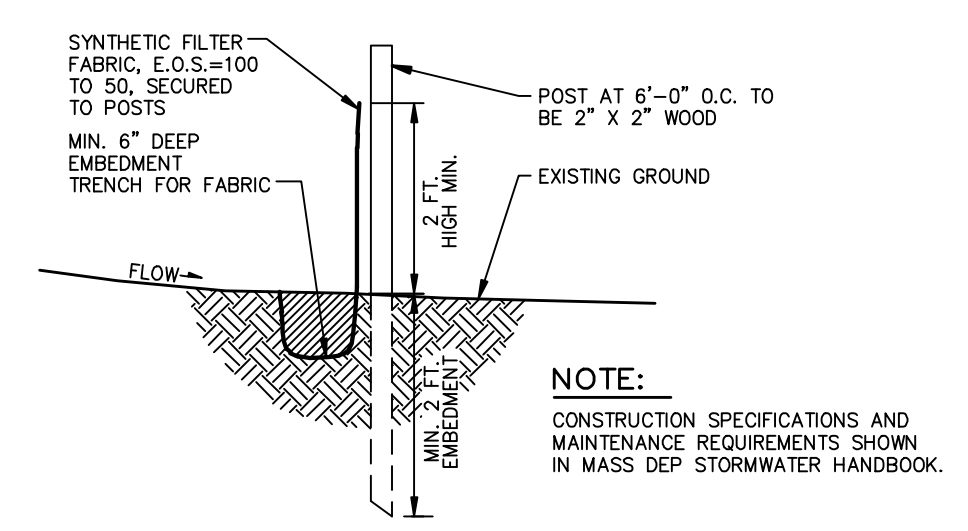

SILT FENCE DETAIL
NOT TO SCALE

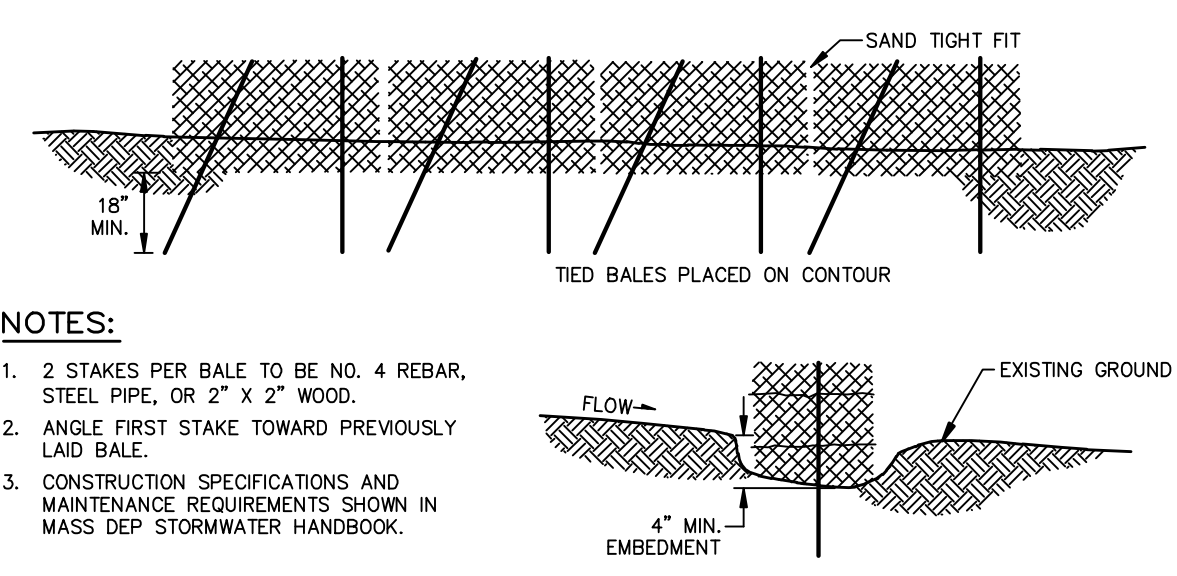

STRAW BALE BARRIER DETAIL
NOT TO SCALE

No.	DATE	REVISION	BY

EROSION CONTROL PLAN
HIGHLAND ROAD
BOXFORD, MASSACHUSETTS
PREPARED FOR:
TOWN OF BOXFORD
7B SPOFFORD RD. BOXFORD, MASSACHUSETTS 01921 (978) 352-6555

SCALE: 1"=10 Feet
1"=3.048 Meters

17 NOVEMBER 2016

HSI Hayner/Swanson, Inc.
Three Congress Street Nashua, New Hampshire 03062-3301
Tel (603) 883-2057 www.haynerswanson.com Fax (603) 883-5057

FIELD BOOK: --- DRAWING NAME: 5387 FQ22
DRAWING LOCATION: C:\Q\5387.DWG

5387 3 OF 3
File Number Sheet

