

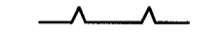

ASSESSORS: 18 - 2 - 4  
 REFERENCES:  
 DEED - BK. 2836 PG. 494  
 PLAN - UNRECORDED PLAN BY OTTE & DWYER, INC.  
 DATED: FEBRUARY 6, 1995

VERTICAL DATUM: N.A.V.D. 1988  
 FEMA: ZONE A - NO FLOOD ELEVATION  
 MAP NO. 25009C0233F (7/3/2012)  
 SPILLWAY ELEV. AT SOUTH-WEST  
 END OF STILES POND = 132.4'

**LEGEND & SYMBOLS**

- ELEV. ELEVATION
- INV. INVERT
-  RETAINING WALL
-  UTILITY POLE
-  CHAIN LINK FENCE

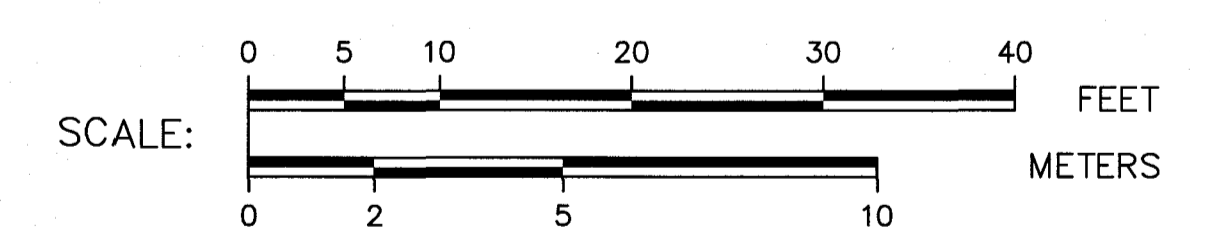

ADDRESS: 372 IPSWICH ROAD

**SITE PLAN**  
 IN  
**BOXFORD, MA**  
 PROPERTY OF  
**CAMP ROTARY, INC.**

SCALE: 1" = 10' DECEMBER 16, 2016  
**DONOHUE SURVEY, INC.**  
 363 BOSTON ST. TOPSFIELD, MA  
 (978) 887-6161

*Paul J. Donohue*  
 12/16/16

**STILES POND**  
 WATER ELEV. = 133.8' (12/7/16)  
 ELEV. OF SPILLWAY AT SOUTH-WEST  
 END OF POND = 132.4'  
 ELEV. TOP OF CONCRETE DAM AT  
 SOUTH-WEST END OF POND = 136.2'  
 (SINCE NO FEMA FLOOD ELEV. HAS  
 BEEN ESTABLISHED, 136.2' IS BEING  
 USED AS THE FLOOD ELEVATION)

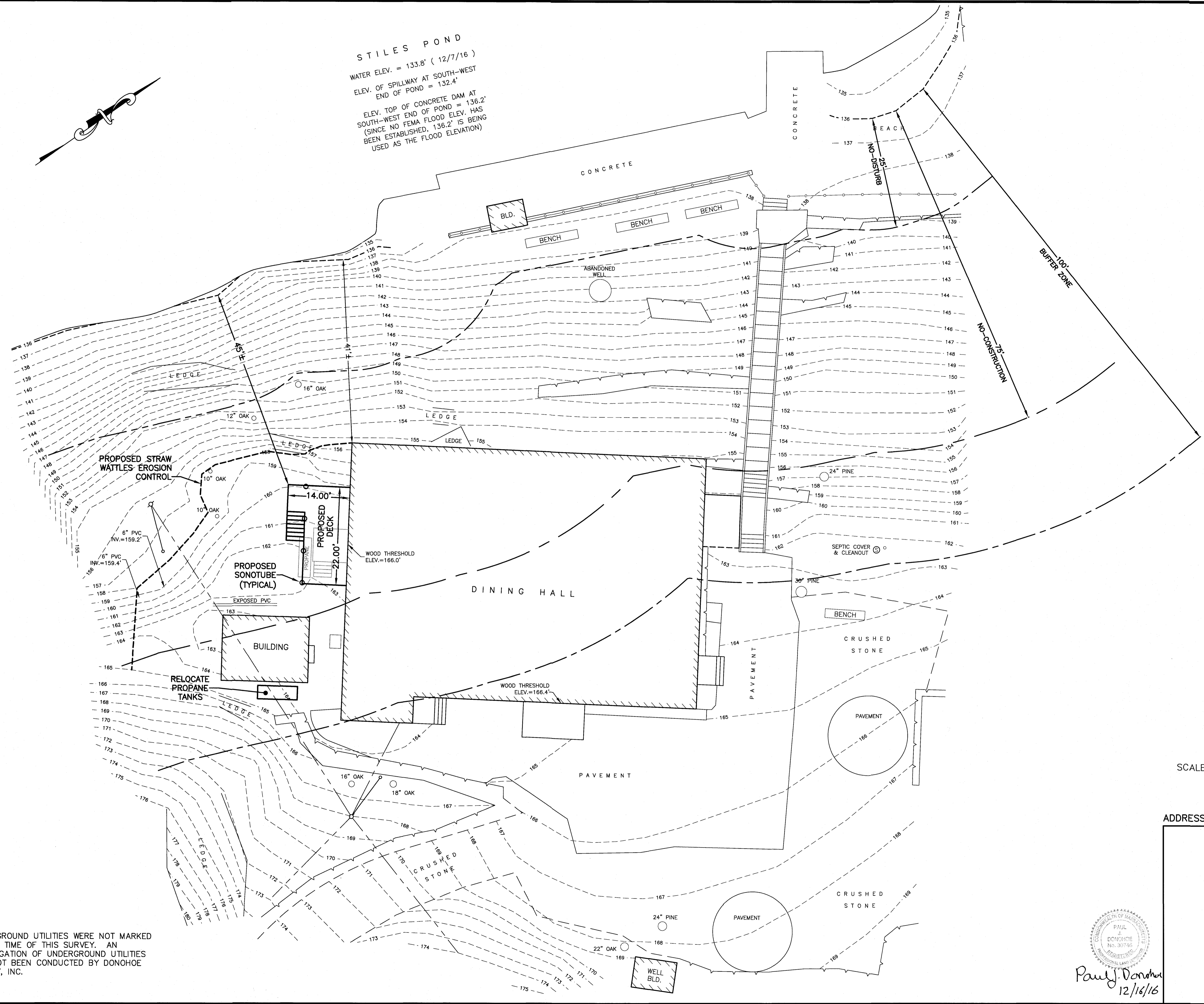
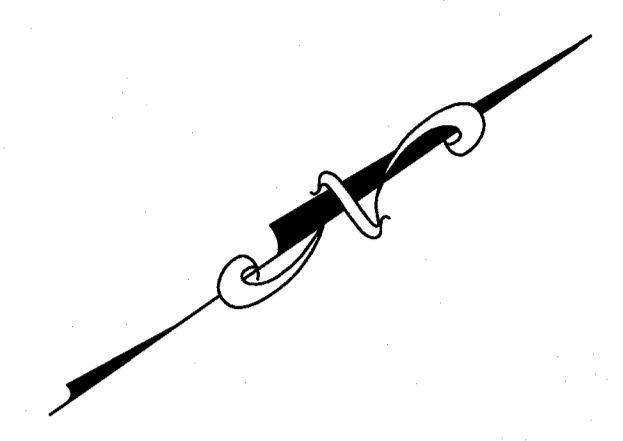

**NOTE:**  
 UNDERGROUND UTILITIES WERE NOT MARKED  
 AT THE TIME OF THIS SURVEY. AN  
 INVESTIGATION OF UNDERGROUND UTILITIES  
 HAS NOT BEEN CONDUCTED BY DONOHUE  
 SURVEY, INC.