

TRANSMITTAL

Tighe&Bond

Project No.: B-0761-4-03
Date: November 1, 2016
Re: Spofford Road Solar 1, LLC Project Correspondance
To: Boxford Conservation Commission
c/o Ross Povenmire
7A Spofford Road
Boxford, MA 01921

Copy:

FOR SIGNATURE FOR FILE AS REQUESTED FOR REVIEW PLEASE REPLY

NO. COPIES	DESCRIPTION
8	Request for Determination of Negligible Impact, with Figure 1

Dear Mr. Povenmire:

On behalf of Spofford Road Solar 1, LLC, please find enclosed 8 copies of the Request for a Determination of Negligible Impact to the Conservation Commission for work associated with installation of a utility pole in buffer zone. Please let me know if you need additional information. Tighe & Bond will attend the Conservation Commission meeting on November 3, 2016 to discuss the request. Thank you.

Very truly yours,
Tighe & Bond, Inc.

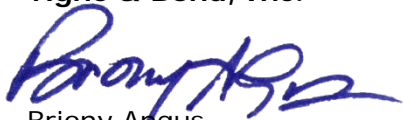

Briony Angus
Senior Project Manager/ Associate

B-0761
November 1, 2016

Boxford Conservation Commission
c/o Ross Povenmire
7A Spofford Road
Boxford, MA 01921

Re: Spofford Road Solar 1, LLC Project
Request for Determination of Negligible Impact

Dear Members of the Commission:

On behalf of Spofford Road Solar 1, LLC, Tighe & Bond is pleased to submit this request to the Boxford Conservation Commission regarding the proposed solar project at the Boxford Landfill, at 7 Spofford Road.

The project received permits in 2015 including a Special Permit from the Boxford Zoning Board of Appeals and a Post-Closure Use Permit from the Massachusetts Department of Environmental Protection (MassDEP). When the project was permitted, no work was proposed to occur in jurisdictional wetland resource areas or the buffer zone thereto, and no approval was sought from the Conservation Commission. Since the project design associated with electrical interconnection has advanced to construction level design, one proposed overhead utility pole is proposed to be located in the buffer zone to Bordering Vegetated Wetlands.

Based on consultation with Mr. Povenmire, we are requesting that the Conservation Commission issue a Determination of Negligible Impact for the proposed buffer zone work, finding that it does not require a Determination of Applicability or Order of Conditions. Additional information about the project site and proposed work are provided below.

Existing Conditions

Jurisdictional wetlands in proximity to the proposed work area were delineated by a Professional Wetlands Scientist on October 17, 2016. Flag Series A-1 through A-24 on the attached Figure 1 demarcate the limits of a Bordering Vegetated Wetland (BVW) within the parcel limits. The wetland is classified as a Palustrine Forested/ Shrub Wetland, Broad-leaved Deciduous vegetation. Dominant wetland vegetation includes *Typha latifolia* (cattails), *Osmunda regalis* (royal fern) and *Onoclea sensibilis* (sensitive fern). The 100' buffer zone to the wetland is depicted on Figure 1.

Proposed Work

As shown on the attached figure, one proposed overhead utility pole (P2795-14) is proposed to be located within the 100' buffer zone to the A-series BVW. Installation of the utility pole will occur with the use of an auger to excavate to the depth required. The native soils will be used as backfill and any additional materials will be spread at the location of the poles. It is expected that approximately 6 cubic yards of material will be excavated for each pole. As shown on Figure 1, erosion control will be placed around each utility pole to protect adjacent wetland resource areas.

Due to the minor nature of the work proposed to occur in the outer 50' of the buffer zone, and proposed construction period controls, we believe the work will result in a negligible



impact to jurisdictional wetlands and the buffer zone. Through this letter, we are seeking the Conservation Commission's confirmation of this opinion.

We look forward to discussing this matter with the Commission at its November 3, 2016 meeting. We understand that there is a \$50 application fee associated with this request. The fee will be provided to the Town under separate cover from Spofford Road Solar 1, LLC. Should you require any additional information please contact me, or Brian Huntley at 413.875.1301 or bshuntley@tighebond.com.

Very truly yours,
TIGHE & BOND, INC.

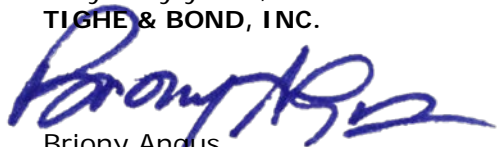

Briony Angus
Senior Project Manager/ Associate

t: 617.640.2055
e: bangus@tighebond.com

Enclosures: Figure 1 (8 Copies)

Copy: Zac Osgood, Spofford Road Solar 1, LLC

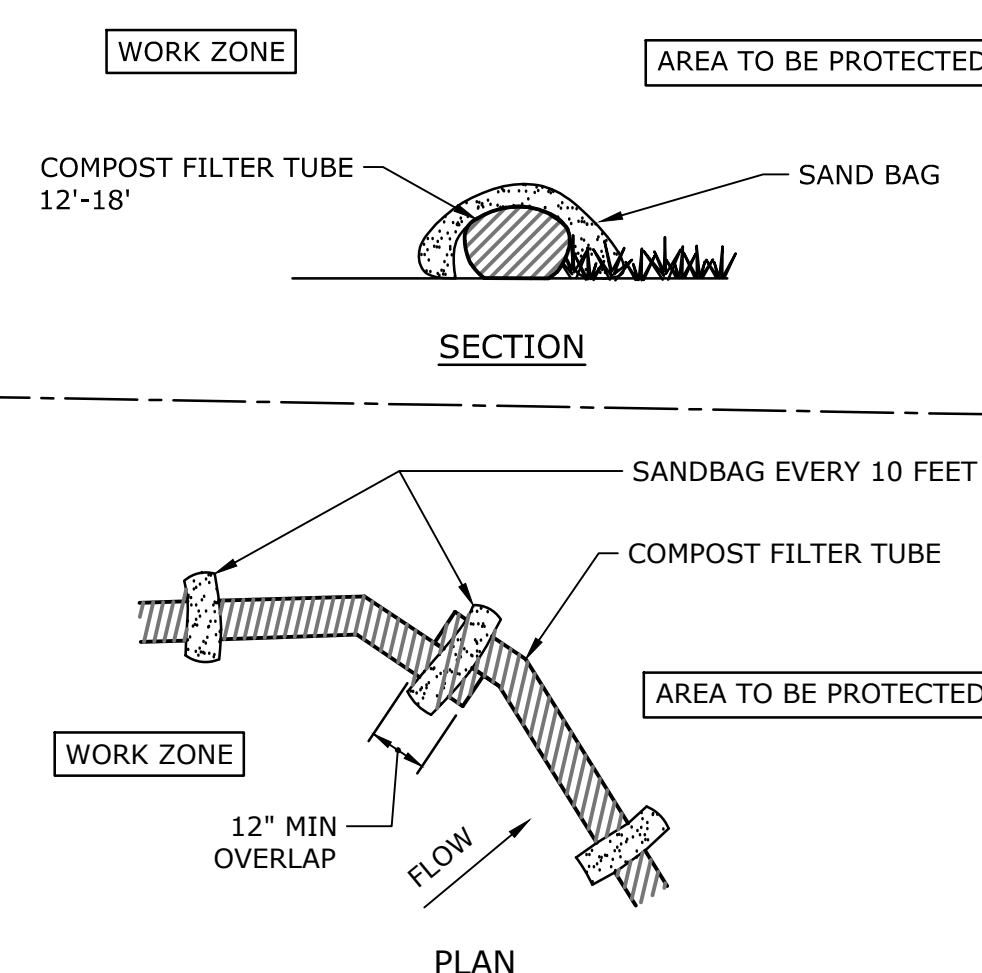
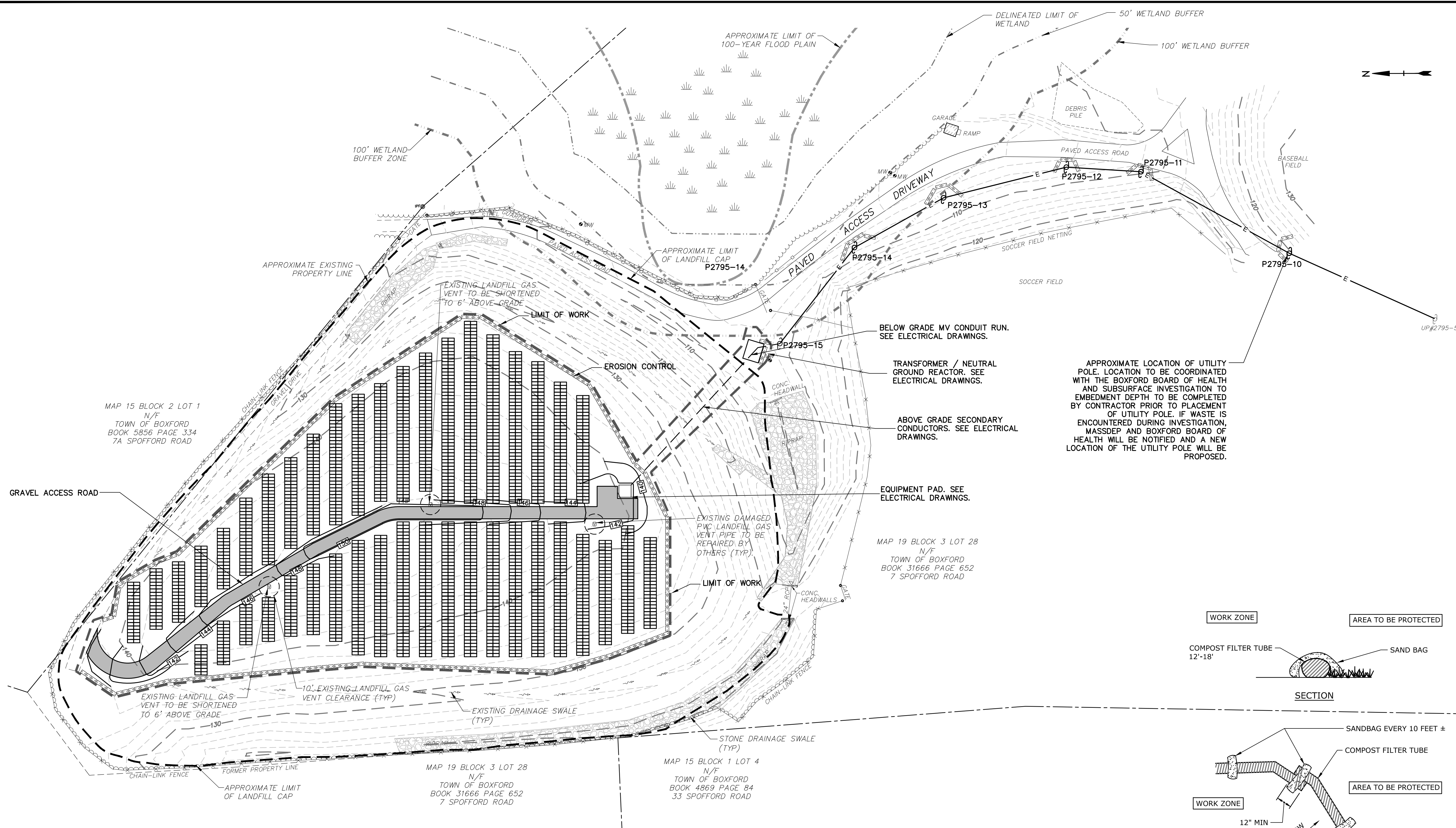

FOR BUILDING PERMIT



BOXFORD DIMENSIONAL AND DENSITY REGULATIONS						
DISTRICT	LOT AREA (REQUIRED/PROVIDED)	LOT FRONTAGE (REQUIRED/PROVIDED)	FRONT SET BACK (REQUIRED/PROVIDED)	SIDE SET BACK (REQUIRED/PROVIDED)	REAR SET BACK (REQUIRED/PROVIDED)	LOT WIDTH (REQUIRED/PROVIDED)
OFFICIAL OR OPEN SPACE (O) ZONING DISTRICT	NONE DEFINED / 45.3 AC.	50' / 996'	50' / 61'	NONE DEFINED / 343'	NONE DEFINED / 296'	100' / 920'

- NOTES:**
1. WORK AREA SHALL BE GRADED IN A MANNER THAT DOES NOT IMPEDE STORMWATER FLOW AND WILL NOT CREATE PONDING.
 2. UTILITY POLES AND GUY WIRES WILL BE PLACED OFF THE HDPE LANDFILL CAP. DURING THE PLACEMENT OF UTILITY POLES ENGINEER WILL WORK ALONG SIDE OF CONTRACTOR TO VERIFY LIMITS OF LANDFILL AND ENSURE WASTE IS NOT ENCOUNTERED.
 3. EXISTING PVC LANDFILL GAS VENTS TO BE CUT AND SHORTENED TO 6 FEET ABOVE GRADE.
 4. WETLAND RESOURCE AREA WERE DELINEATED BY A TIGHE & BOND WETLAND SCIENTIST ON OCTOBER 17, 2016

- NOTES:**
1. TUBES FOR COMPOST FILTERS SHALL BE JUTE MESH OR APPROVED BIODEGRADABLE MATERIAL.
 2. TAMP TUBES IN PLACE TO ENSURE GOOD CONTACT WITH SOIL SURFACE.
 3. PROVIDE 3" MINIMUM OVERLAP AT ENDS OF TUBES TO JOIN IN A CONTINUOUS BARRIER AND MINIMIZE UNIMPEDED FLOW.
 4. COMPOST MATERIAL TO BE DISPERSED ON SITE WITHIN LIMITS OF WORK, AS DIRECTED.
 5. SECURE ENDS OF TUBES WITH SAND BAGS SPACED AT A MAXIMUM OF 10' APART.
 6. INSTALL TUBES ALONG CONTOURS AND PERPENDICULAR TO SHEET OR CONCENTRATED FLOW.
 7. DO NOT INSTALL IN PERENNIAL, EPHEMERAL OR INTERMITTENT STREAMS.
 8. CONFIGURE TUBES AROUND EXISTING SITE FEATURES TO MINIMIZE SITE DISTURBANCE AND MAXIMIZE CAPTURE AREA OF STORMWATER RUN-OFF.

EROSION CONTROL BARRIER
 NO SCALE

PROPOSED SITE PLAN
 SCALE: 1"=50'
FIGURE 1

Tighe & Bond, Inc. v. 10/10/2016 Barrage Solar Multiple Sites Drawings - Boxford, Major Mos (B) Boxford - revised 10/10/2016 Nov 01, 2016 9:19am Plotted By: jlgroce