

HEALTH AGENT - KENDALL LONGO  
SOIL EVALUATOR - ROBERT GRASSO  
DATE: 09-15-2016

TEST PIT # 01  
ELEV = 142.71  
FULL

TEST PIT # 02  
ELEV = 143.11  
FULL

ROBERT M. GRASSO, P.L.S., SE#933 DATE 10-21-16  
USDA - S.C.S. SOIL TYPES  
THE ENTIRE SITE IS MAPPED AS:  
H1B - HINCKLEY

DIMENSION TABLE:

PIPE SEPARATION = 0.50'  
LINE LENGTH = 40.0'  
PIPE CENTER O.C. = 1.75'  
BED WIDTH = 25.0'  
BED LENGTH = 32.0'

TEST PIT #	DATE	RESULTS
01	09-15-2016	FULL
02	09-15-2016	FULL

WATER TABLE: NONE OBSERVED

PERCOLATION TESTS: NONE OBSERVED

DATE: 09-15-2016

INVERT TABLE

AT BLDG	EXIST
TANK IN	137.0 ±
TANK OUT	136.00
PUMP IN	135.75
PUMP OUT	135.70
D-BOX IN	142.52
D-BOX OUT	142.35
BEG 4" PIPE	142.18
END 4" PIPE	142.18
TOP 12" PIPE	142.60
12" PIPE INV	141.60
BOTTOM BED	141.10
GROUNDWATER	136.1' ADJ @ EL. 143.1'

DESIGN CRITERIA USE 0.74 GPD/S.F. - CL I ( SAND )  
NUMBER OF BEDROOMS: 3 DESIGN FLOW: 165 GALLONS PER BEDROOM  
TOTAL No. ROOMS: 6 GPD. LEACHING AREA: 669 S.F.  
TOTAL DAILY FLOW: 495 GPD. LEACHING AREA: 669 S.F.  
MIN. 225 L.F. OF ENVIRO PIPE REQ'D. 423 S.F. - MIN PRESBY SAND BED SIZE MIN. 1.50' O.C. PIPE SPACING

NO GARBAGE GRINDER TO BE USED.  
ACTUAL LEACHING AREA PROVIDED: 441 S.F.  
SAND BED SIZE: 10.5'w x 42.0'l = 441 S.F.  
CALCULATED DAILY FLOW: 240 L.F. x 2.20 GAL/L.F. AT <2 MPI = 528 GPD = 495 GPD REQ'D. 6 LINES ( 40.0'L - 1.50' O.C. + 1.0' SAND AROUND )

NOTES:  
REMOVE ALL UNSUITABLE SOIL MATERIAL FOR A MINIMUM OF 5' ALL AROUND LEACH AREA AND ( 42' ) BELOW EXISTING GRADE, AND REPLACE WITH CLEAN FILL MEETING TITLE 5, 310 CMR 15.25(3).  
INSTALL FLOW LEVELERS AT DISTRIBUTION BOX OUTLETS. (GRAVITY ONLY) DIMENSIONS, DETAILS, AND SHAPE OF SEPTIC TANK AND DISTRIBUTION BOX WILL VARY SLIGHTLY WITH MANUFACTURER.  
ALL UNITS SHALL CONFORM WITH THE REGULATIONS OF TITLE 5 OF THE MASSACHUSETTS ENVIRONMENTAL CODE, AND WITH ALL APPLICABLE LOCAL BOARD OF HEALTH REQUIREMENTS.  
PRESBY ENVIRO-SEPTIC SYSTEM CANNOT BE USED WITH A PRESSURE DISTRIBUTION SYSTEM.  
THIS SYSTEM REQUIRES 1 CELLS OF ENVIRO-SEPTIC PIPES. EACH CELL HAS 6 DIST. LINES 40.0' IN LENGTH.

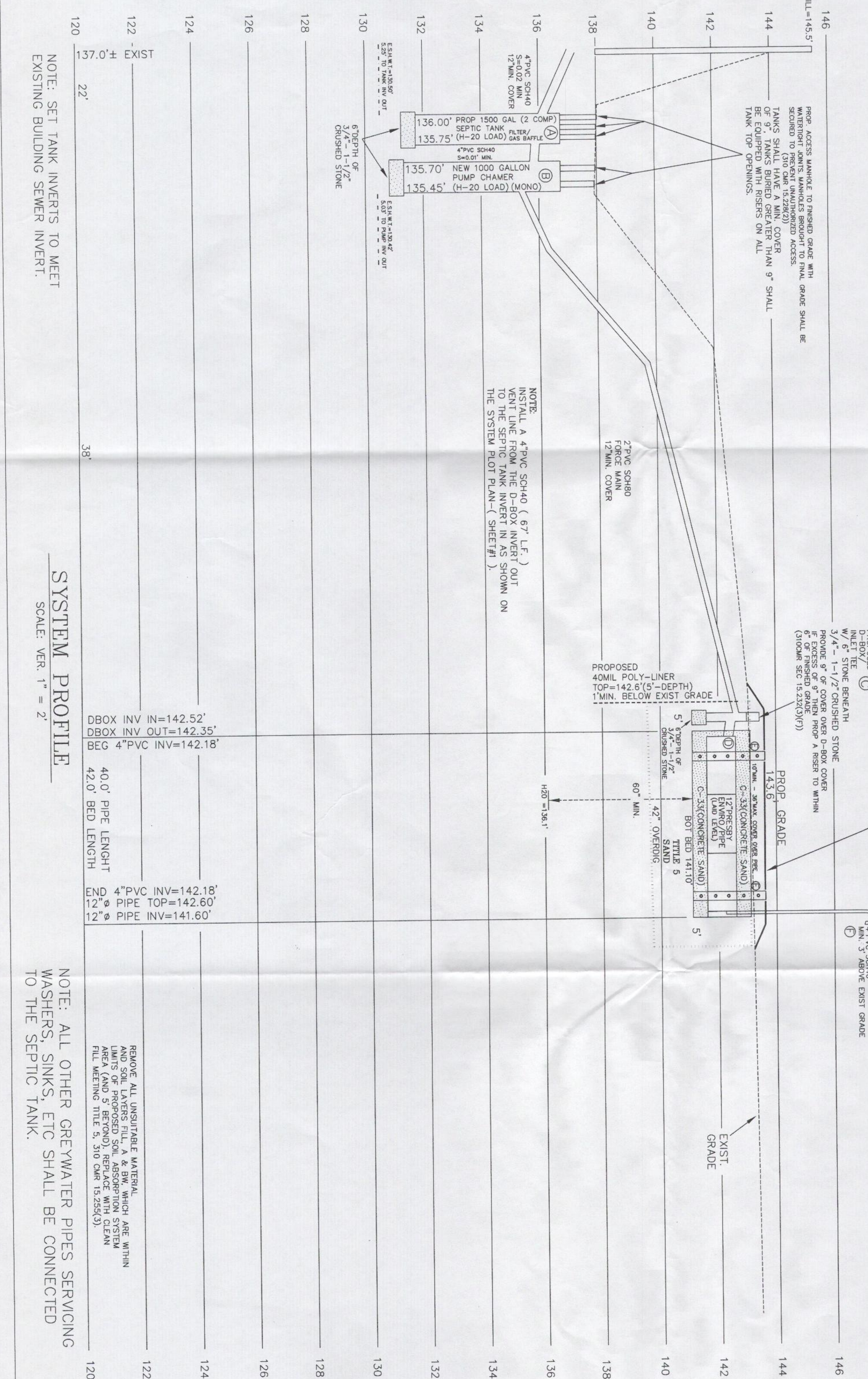
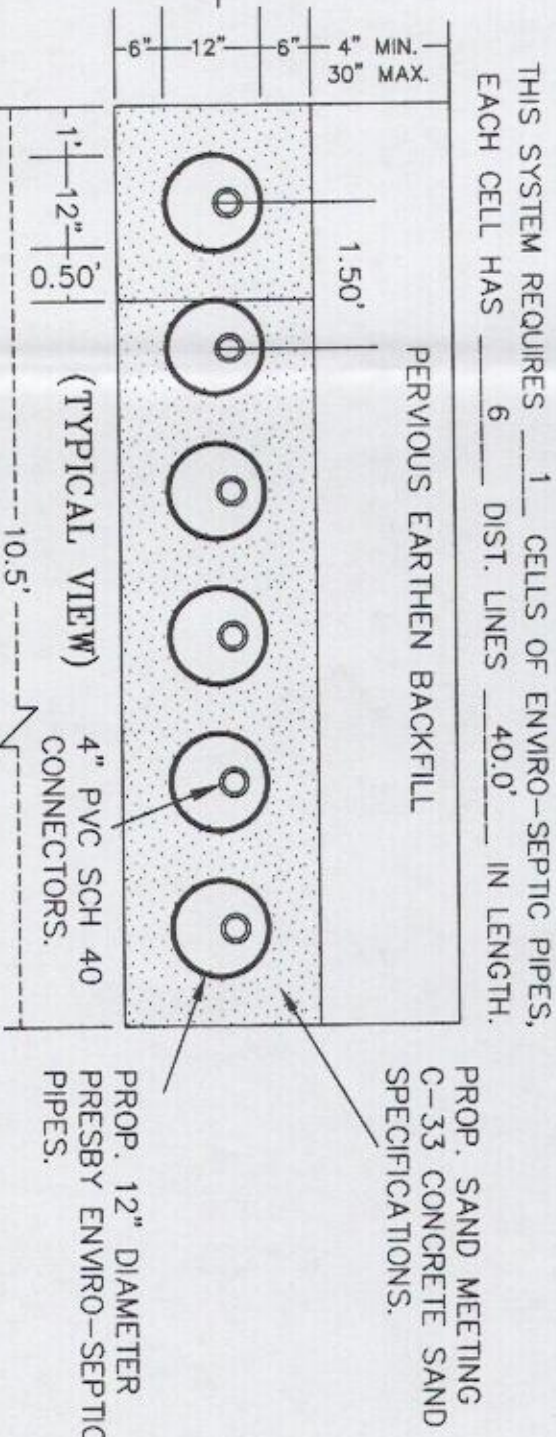

SYSTEM PROFILE  
SCALE: VER. 1" = 2'

NOTE: SET TANK INVERTS TO MEET EXISTING BUILDING SEWER INVERT.

Engineering Land Services, LLC  
P.O. BOX 41  
WEST NEWBURY, MA 01985  
TEL: 978-815-6744 & FAX: 978-462-6800  
EMAIL: MASSPLSRG@AOL.COM

OWNER: JAMES & EILEEN LYDON  
TAX MAP 09 BLK 02 LOT 25  
LOCUS DEED: BK 24037 PG 393

LOCATION: 610 MAIN STREET  
BOXFORD, MA 01921

Engineering Land Services, LLC  
Professional Seal: ROBERT M. GRASSO, P.L.S., SE#933, No. 40215, State of Massachusetts, License No. 28881, dated 10-21-16.

STANTON WARREN  
Professional Seal: No. 28881, dated 10-21-16.

DATE: 10-21-2016

DRAWN: RMG  
CHECKED: SWB  
SCALE: AS NOTED  
DATE: 10-21-2016  
DWG No. VACADREP/BOX/010MAN

REVISIONS:

SHEET No. 2 OF 3