

PLANTING PLAN
 #17 PYE BROOK LANE
 IN
 BOXFORD, MA 01921

0' 5' 10' 20'
 SCALE: 1"=10'
 JANUARY 12, 2016

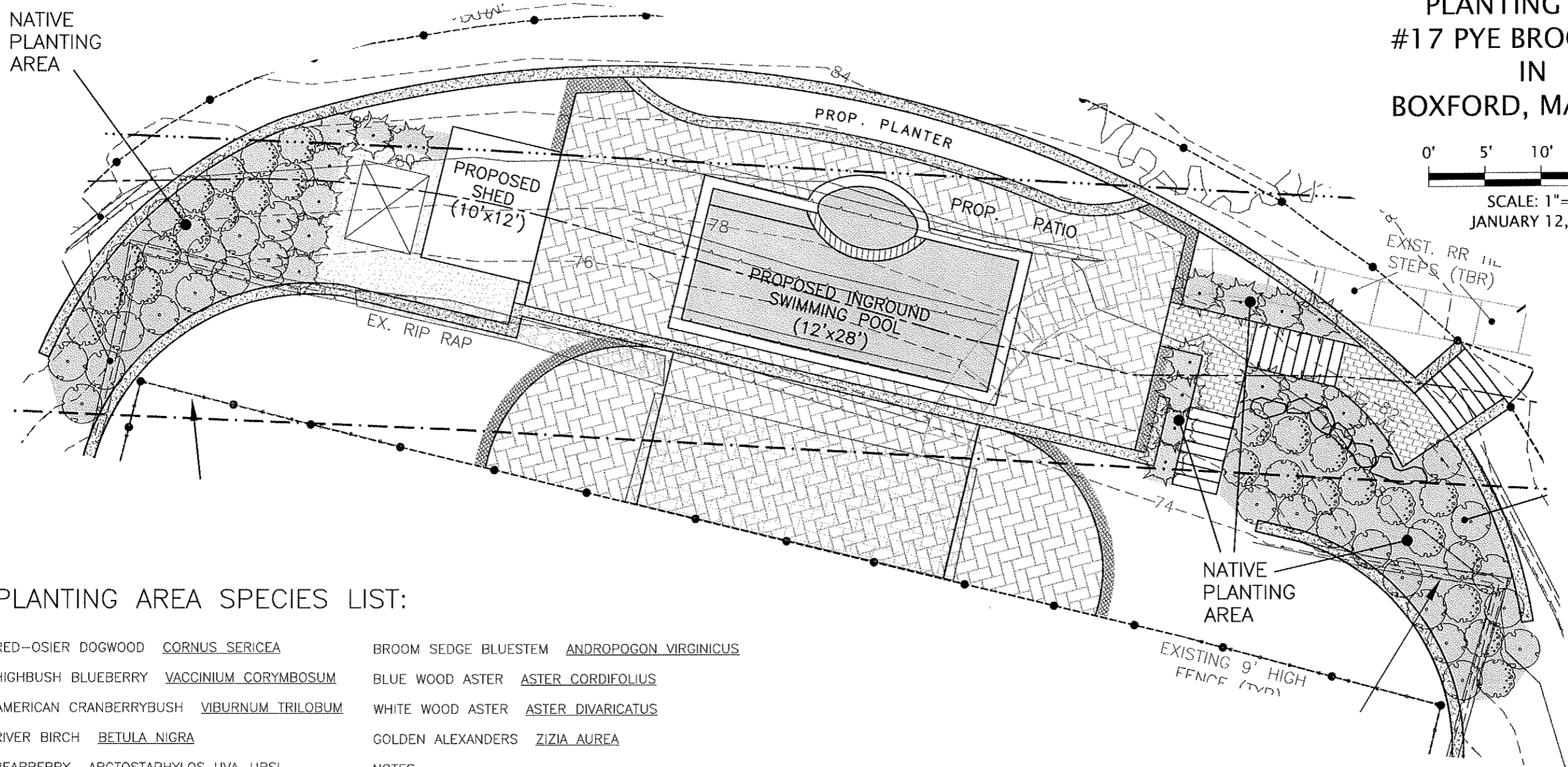

PLANTING AREA SPECIES LIST:

- RED-OSIER DOGWOOD CORNUS SERICEA
- HIGHBUSH BLUEBERRY VACCINIUM CORYMBOSUM
- AMERICAN CRANBERRYBUSH VIBURNUM TRILOBUM
- RIVER BIRCH BETULA NIGRA
- BEARBERRY ARCTOSTAPHYLOS UVA-URSI
- SWEET PEPPERBUSH CLETHRA ALNIFOLIA
- INKBERRY ILEX GLABRA
- WINTERBERRY HOLLY ILEX VERTICILLATA
- WILD RAISIN VIBURNUM CASSINOIDES
- MAPLE LEAF VIBURNUM VIBURNUM ACERIFOLIUM
- AMERICAN CRANBERRYBUSH VIBURNUM TRILOBUM
- MAIDENHAIR FERN ADIANTUM PEDATUM
- CHRISTMAS FERN POLYSTICHUM ACROSTICHOIDES

- BROOM SEDGE BLUESTEM ANDROPOGON VIRGINICUS
- BLUE WOOD ASTER ASTER CORDIFOLIUS
- WHITE WOOD ASTER ASTER DIVARICATUS
- GOLDEN ALEXANDERS ZIZIA AUREA

NOTES:

1. THE SURFACE OF THE ENHANCEMENT AREA SHALL BE MULCHED WITH BARK MULCH.
2. SHRUBS PLANTED WITHIN NATIVE PLANTING AREAS SHALL BE A MINIMUM OF THREE (3) FEET. THERE SHALL BE A MINIMUM OF TWENTY-EIGHT (28) SHRUBS.
3. THERE SHALL BE A MINIMUM OF FOUR (4) TREES PLANTED WITHIN THE NATIVE PLANTING AREAS. TREES SHALL BE A MINIMUM OF SIX (6) FEET IN HEIGHT.
4. THERE SHALL BE A MINIMUM OF TEN (10) HERBACEOUS SPECIES PLANTED WITHIN THE AREAS AS WELL.
5. ONLY NATIVE SPECIES SHALL BE PLANTED IN THE NATIVE PLANTING AREAS.