

# NOTICE OF INTENT

Project Address:  
10 Maple Avenue  
Boxford, MA 01921

Assessors Info:  
Map 17, Block 2, Parcel 19

Applicant:  
Derek & Leigh Repucci  
10 Maple Avenue  
Boxford, MA 01921

Date:  
November 4, 2014

Project Number:  
BOXF-0024

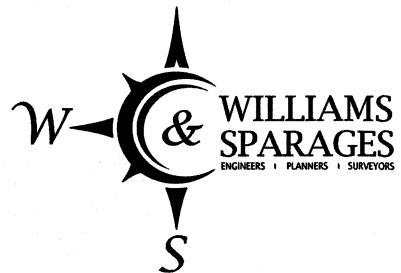

189 N. Main Street, Suite 101  
Middleton, MA 01949  
Office Tel: 978-539-8088  
Fax: 978-539-8200  
[www.wsengineers.com](http://www.wsengineers.com)

## TABLE OF CONTENTS

WPA FORM 3 – NOTICE OF INTENT

1-8

### ATTACHMENTS

---

- NARRATIVE
- WETLAND FIELD DATA FORMS
- ABUTTERS NOTICE
- ABUTTERS LIST
- AFFIDAVIT OF SERVICE
- USGS MAP
- FEE TRANSMITTAL

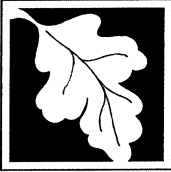

**Massachusetts Department of Environmental Protection**  
**Bureau of Resource Protection - Wetlands**

**WPA Form 3 – Notice of Intent**

Massachusetts Wetlands Protection Act M.G.L. c. 131, §40

Provided by MassDEP:

MassDEP File Number \_\_\_\_\_

Document Transaction Number \_\_\_\_\_

Boxford  
 City/Town

**Important:**  
 When filling out forms on the computer, use only the tab key to move your cursor - do not use the return key.



**Note:**  
 Before completing this form consult your local Conservation Commission regarding any municipal bylaw or ordinance.

**A. General Information**

1. Project Location (**Note:** electronic filers will click on button to locate project site):

10 Maple Avenue  
 a. Street Address

Boxford  
 b. City/Town

01921  
 c. Zip Code

Latitude and Longitude:  
 42.6853  
 d. Latitude

-71.0469  
 e. Longitude

Map 17  
 f. Assessors Map/Plat Number

Block 2, Lot 19  
 g. Parcel /Lot Number

2. Applicant:

Derek & Leigh  
 a. First Name

Repucci  
 b. Last Name

c. Organization

10 Maple Avenue  
 d. Street Address

Boxford  
 e. City/Town

MA  
 f. State

01921  
 g. Zip Code

(857) 241-8356  
 h. Phone Number

i. Fax Number

derekr\_1999@yahoo.com  
 j. Email Address

3. Property owner (required if different from applicant):  Check if more than one owner

a. First Name

b. Last Name

c. Organization

d. Street Address

e. City/Town

f. State

g. Zip Code

h. Phone Number

i. Fax Number

j. Email address

4. Representative (if any):

Greg  
 a. First Name

Hochmuth  
 b. Last Name

Williams & Sparages LLC  
 c. Company

189 North Main Street  
 d. Street Address

Middleton  
 e. City/Town

MA  
 f. State

01949  
 g. Zip Code

(978) 539-8088  
 h. Phone Number

(978) 539-8200  
 i. Fax Number

ghochmuth@wsengineers.com  
 j. Email address

5. Total WPA Fee Paid (from NOI Wetland Fee Transmittal Form):

\$110.00  
 a. Total Fee Paid

\$42.50  
 b. State Fee Paid

\$67.50  
 c. City/Town Fee Paid



# WPA Form 3 – Notice of Intent

Massachusetts Wetlands Protection Act M.G.L. c. 131, §40

Provided by MassDEP:
MassDEP File Number
Document Transaction Number
Boxford
City/Town

## A. General Information (continued)

6. General Project Description:

To construct an addition onto the existing dwelling within 100 feet of Bordering Vegetated Wetlands.

7a. Project Type Checklist:

- |   |   |
|---|---|
| 1. <input checked="" type="checkbox"/> Single Family Home     | 2. <input type="checkbox"/> Residential Subdivision                   |
| 3. <input type="checkbox"/> Limited Project Driveway Crossing | 4. <input type="checkbox"/> Commercial/Industrial                     |
| 5. <input type="checkbox"/> Dock/Pier                         | 6. <input type="checkbox"/> Utilities                                 |
| 7. <input type="checkbox"/> Coastal Engineering Structure     | 8. <input type="checkbox"/> Agriculture (e.g., cranberries, forestry) |
| 9. <input type="checkbox"/> Transportation                    | 10. <input type="checkbox"/> Other                                    |

7b. Is any portion of the proposed activity eligible to be treated as a limited project subject to 310 CMR 10.24 (coastal) or 310 CMR 10.53 (inland)?

1.  Yes  No    If yes, describe which limited project applies to this project:

2. Limited Project

8. Property recorded at the Registry of Deeds for:

Essex South District

a. County

28706

c. Book

b. Certificate # (if registered land)

141

d. Page Number

## B. Buffer Zone & Resource Area Impacts (temporary & permanent)

- Buffer Zone Only – Check if the project is located only in the Buffer Zone of a Bordering Vegetated Wetland, Inland Bank, or Coastal Resource Area.
- Inland Resource Areas (see 310 CMR 10.54-10.58; if not applicable, go to Section B.3, Coastal Resource Areas).

Check all that apply below. Attach narrative and any supporting documentation describing how the project will meet all performance standards for each of the resource areas altered, including standards requiring consideration of alternative project design or location.

For all projects affecting other Resource Areas, please attach a narrative explaining how the resource area was delineated.

Resource Area	Size of Proposed Alteration	Proposed Replacement (if any)
a. <input type="checkbox"/> Bank	1. linear feet	2. linear feet
b. <input type="checkbox"/> Bordering Vegetated Wetland	1. square feet	2. square feet
c. <input type="checkbox"/> Land Under Waterbodies and Waterways	1. square feet 3. cubic yards dredged	2. square feet



# WPA Form 3 – Notice of Intent

Massachusetts Wetlands Protection Act M.G.L. c. 131, §40

Provided by MassDEP:
MassDEP File Number
Document Transaction Number
Boxford
City/Town

## B. Buffer Zone & Resource Area Impacts (temporary & permanent) (cont'd)

<u>Resource Area</u>	<u>Size of Proposed Alteration</u>	<u>Proposed Replacement (if any)</u>
d. <input type="checkbox"/> Bordering Land Subject to Flooding	1. square feet	2. square feet
	3. cubic feet of flood storage lost	4. cubic feet replaced
e. <input type="checkbox"/> Isolated Land Subject to Flooding	1. square feet	
	2. cubic feet of flood storage lost	3. cubic feet replaced
f. <input type="checkbox"/> Riverfront Area	1. Name of Waterway (if available)	
	2. Width of Riverfront Area (check one):	
	<input type="checkbox"/> 25 ft. - Designated Densely Developed Areas only	
	<input type="checkbox"/> 100 ft. - New agricultural projects only	
	<input type="checkbox"/> 200 ft. - All other projects	
	3. Total area of Riverfront Area on the site of the proposed project: _____ square feet	
	4. Proposed alteration of the Riverfront Area:	
	a. total square feet	b. square feet within 100 ft.
		c. square feet between 100 ft. and 200 ft.
	5. Has an alternatives analysis been done and is it attached to this NOI? <input type="checkbox"/> Yes <input type="checkbox"/> No	
	6. Was the lot where the activity is proposed created prior to August 1, 1996? <input type="checkbox"/> Yes <input type="checkbox"/> No	

3.  Coastal Resource Areas: (See 310 CMR 10.25-10.35)

Check all that apply below. Attach narrative and supporting documentation describing how the project will meet all performance standards for each of the resource areas altered, including standards requiring consideration of alternative project design or location.

<u>Resource Area</u>	<u>Size of Proposed Alteration</u>	<u>Proposed Replacement (if any)</u>
a. <input type="checkbox"/> Designated Port Areas	Indicate size under Land Under the Ocean, below	
b. <input type="checkbox"/> Land Under the Ocean	1. square feet	
	2. cubic yards dredged	
c. <input type="checkbox"/> Barrier Beach	Indicate size under Coastal Beaches and/or Coastal Dunes below	
d. <input type="checkbox"/> Coastal Beaches	1. square feet	2. cubic yards beach nourishment
e. <input type="checkbox"/> Coastal Dunes	1. square feet	2. cubic yards dune nourishment

Online Users:  
Include your document transaction number (provided on your receipt page) with all supplementary information you submit to the Department.

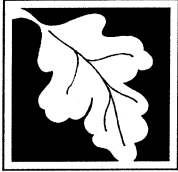

# WPA Form 3 – Notice of Intent

Massachusetts Wetlands Protection Act M.G.L. c. 131, §40

Provided by MassDEP:
MassDEP File Number
Document Transaction Number
Boxford
City/Town

## B. Buffer Zone & Resource Area Impacts (temporary & permanent) (cont'd)

	Size of Proposed Alteration	Proposed Replacement (if any)
f. <input type="checkbox"/> Coastal Banks	1. linear feet	
g. <input type="checkbox"/> Rocky Intertidal Shores	1. square feet	
h. <input type="checkbox"/> Salt Marshes	1. square feet	2. sq ft restoration, rehab., creation
i. <input type="checkbox"/> Land Under Salt Ponds	1. square feet	
	2. cubic yards dredged	
j. <input type="checkbox"/> Land Containing Shellfish	1. square feet	
k. <input type="checkbox"/> Fish Runs	Indicate size under Coastal Banks, inland Bank, Land Under the Ocean, and/or inland Land Under Waterbodies and Waterways, above	
	1. cubic yards dredged	
l. <input type="checkbox"/> Land Subject to Coastal Storm Flowage	1. square feet	
4. <input type="checkbox"/> Restoration/Enhancement	If the project is for the purpose of restoring or enhancing a wetland resource area in addition to the square footage that has been entered in Section B.2.b or B.3.h above, please enter the additional amount here.	
	a. square feet of BVW	b. square feet of Salt Marsh
5. <input type="checkbox"/> Project Involves Stream Crossings		
	a. number of new stream crossings	b. number of replacement stream crossings

## C. Other Applicable Standards and Requirements

### Streamlined Massachusetts Endangered Species Act/Wetlands Protection Act Review

1. Is any portion of the proposed project located in **Estimated Habitat of Rare Wildlife** as indicated on the most recent Estimated Habitat Map of State-Listed Rare Wetland Wildlife published by the Natural Heritage and Endangered Species Program (NHESP)? To view habitat maps, see the *Massachusetts Natural Heritage Atlas* or go to [http://maps.massgis.state.ma.us/PRI\\_EST\\_HAB/viewer.htm](http://maps.massgis.state.ma.us/PRI_EST_HAB/viewer.htm).

a.  Yes  No **If yes, include proof of mailing or hand delivery of NOI to:**

Natural Heritage and Endangered Species Program  
Division of Fisheries and Wildlife  
100 Hartwell Street, Suite 230  
West Boylston, MA 01583

MASSGIS NOV  
2014



# WPA Form 3 – Notice of Intent

Massachusetts Wetlands Protection Act M.G.L. c. 131, §40

Provided by MassDEP:
MassDEP File Number
Document Transaction Number
Boxford
City/Town

## C. Other Applicable Standards and Requirements (cont'd)

If yes, the project is also subject to Massachusetts Endangered Species Act (MESA) review (321 CMR 10.18). To qualify for a streamlined, 30-day, MESA/Wetlands Protection Act review, please complete Section C.1.C, and include requested materials with this Notice of Intent (NOI); OR complete Section C.1.d, if applicable. *If MESA supplemental information is not included with the NOI, by completing Section 1 of this form, the NHESP will require a separate MESA filing which may take up to 90 days to review (unless noted exceptions in Section 2 apply, see below).*

1. c. Submit Supplemental Information for Endangered Species Review\*

- 1.  Percentage/acreage of property to be altered:
  - (a) within wetland Resource Area \_\_\_\_\_ percentage/acreage
  - (b) outside Resource Area \_\_\_\_\_ percentage/acreage
- 2.  Assessor's Map or right-of-way plan of site
- 3.  Project plans for entire project site, including wetland resource areas and areas outside of wetlands jurisdiction, showing existing and proposed conditions, existing and proposed tree/vegetation clearing line, and clearly demarcated limits of work \*\*\*\*
  - (a)  Project description (including description of impacts outside of wetland resource area & buffer zone)
  - (b)  Photographs representative of the site
  - (c)  MESA filing fee (fee information available at <http://www.mass.gov/eea/agencies/dfg/dfw/natural-heritage/regulatory-review/mass-endangered-species-act-mesa/mesa-fee-schedule.html>). Make check payable to "Commonwealth of Massachusetts - NHESP" and **mail to NHESP** at above address  
*Projects altering 10 or more acres of land, also submit:*
  - (d)  Vegetation cover type map of site
  - (e)  Project plans showing Priority & Estimated Habitat boundaries

d. OR Check One of the Following

- 1.  Project is exempt from MESA review. Attach applicant letter indicating which MESA exemption applies. (See 321 CMR 10.14, <http://www.mass.gov/eea/agencies/dfg/dfw/laws-regulations/cmr/321-cmr-1000-massachusetts-endangered-species-act.html#10.14>; the NOI must still be sent to NHESP if the project is within estimated habitat pursuant to 310 CMR 10.37 and 10.59.)
- 2.  Separate MESA review ongoing.
 

	a. NHESP Tracking # _____	b. Date submitted to NHESP _____
--	---------------------------	----------------------------------

\* Some projects not in Estimated Habitat may be located in Priority Habitat, and require NHESP review (see <http://www.mass.gov/eea/agencies/dfg/dfw/natural-heritage/regulatory-review/>). Priority Habitat includes habitat for state-listed plants and strictly upland species not protected by the Wetlands Protection Act.

\*\* MESA projects may not be segmented (321 CMR 10.16). The applicant must disclose full development plans even if such plans are not required as part of the Notice of Intent process.



# WPA Form 3 – Notice of Intent

Massachusetts Wetlands Protection Act M.G.L. c. 131, §40

Provided by MassDEP:
MassDEP File Number
Document Transaction Number
Boxford
City/Town

## C. Other Applicable Standards and Requirements (cont'd)

3.  Separate MESA review completed.  
Include copy of NHESP "no Take" determination or valid Conservation & Management Permit with approved plan.
2. For coastal projects only, is any portion of the proposed project located below the mean high water line or in a fish run?
- a.  Not applicable – project is in inland resource area only
- b.  Yes    No    If yes, include proof of mailing or hand delivery of NOI to either:
- |   |  |
|---|--|
| South Shore - Cohasset to Rhode Island, and the Cape & Islands:   | North Shore - Hull to New Hampshire:   |
| Division of Marine Fisheries - Southeast Marine Fisheries Station<br>Attn: Environmental Reviewer<br>1213 Purchase Street – 3rd Floor<br>New Bedford, MA 02740-6694 | Division of Marine Fisheries - North Shore Office<br>Attn: Environmental Reviewer<br>30 Emerson Avenue<br>Gloucester, MA 01930 |

Also if yes, the project may require a Chapter 91 license. For coastal towns in the Northeast Region, please contact MassDEP's Boston Office. For coastal towns in the Southeast Region, please contact MassDEP's Southeast Regional Office.

3. Is any portion of the proposed project within an Area of Critical Environmental Concern (ACEC)?
- a.  Yes    No    If yes, provide name of ACEC (see instructions to WPA Form 3 or MassDEP Website for ACEC locations). **Note:** electronic filers click on Website.
- b. ACEC
4. Is any portion of the proposed project within an area designated as an Outstanding Resource Water (ORW) as designated in the Massachusetts Surface Water Quality Standards, 314 CMR 4.00?
- a.  Yes    No
5. Is any portion of the site subject to a Wetlands Restriction Order under the Inland Wetlands Restriction Act (M.G.L. c. 131, § 40A) or the Coastal Wetlands Restriction Act (M.G.L. c. 130, § 105)?
- a.  Yes    No
6. Is this project subject to provisions of the MassDEP Stormwater Management Standards?
- a.  Yes. Attach a copy of the Stormwater Report as required by the Stormwater Management Standards per 310 CMR 10.05(6)(k)-(q) and check if:
1.  Applying for Low Impact Development (LID) site design credits (as described in Stormwater Management Handbook Vol. 2, Chapter 3)
  2.  A portion of the site constitutes redevelopment
  3.  Proprietary BMPs are included in the Stormwater Management System.
- b.  No. Check why the project is exempt:
1.  Single-family house

**Online Users:**  
Include your document transaction number (provided on your receipt page) with all supplementary information you submit to the Department.





# WPA Form 3 – Notice of Intent

Massachusetts Wetlands Protection Act M.G.L. c. 131, §40

Provided by MassDEP:
MassDEP File Number
Document Transaction Number
Boxford
City/Town

## C. Other Applicable Standards and Requirements (cont'd)

- 2.  Emergency road repair
- 3.  Small Residential Subdivision (less than or equal to 4 single-family houses or less than or equal to 4 units in multi-family housing project) with no discharge to Critical Areas.

## D. Additional Information

Applicants must include the following with this Notice of Intent (NOI). See instructions for details.

**Online Users:** Attach the document transaction number (provided on your receipt page) for any of the following information you submit to the Department.

- 1.  USGS or other map of the area (along with a narrative description, if necessary) containing sufficient information for the Conservation Commission and the Department to locate the site. (Electronic filers may omit this item.)
- 2.  Plans identifying the location of proposed activities (including activities proposed to serve as a Bordering Vegetated Wetland [BVW] replication area or other mitigating measure) relative to the boundaries of each affected resource area.
- 3.  Identify the method for BVW and other resource area boundary delineations (MassDEP BVW Field Data Form(s), Determination of Applicability, Order of Resource Area Delineation, etc.), and attach documentation of the methodology.
- 4.  List the titles and dates for all plans and other materials submitted with this NOI.

### Plan to Accompany a Notice of Intent

a. Plan Title	Williams & Sparages, LLC	Richard L. Williams
b. Prepared By		c. Signed and Stamped by
	Novemeber 6, 2014	1" = 20'
d. Final Revision Date		e. Scale

f. Additional Plan or Document Title	g. Date
--------------------------------------	---------

- 5.  If there is more than one property owner, please attach a list of these property owners not listed on this form.
- 6.  Attach proof of mailing for Natural Heritage and Endangered Species Program, if needed.
- 7.  Attach proof of mailing for Massachusetts Division of Marine Fisheries, if needed.
- 8.  Attach NOI Wetland Fee Transmittal Form
- 9.  Attach Stormwater Report, if needed.



**Massachusetts Department of Environmental Protection**  
**Bureau of Resource Protection - Wetlands**

**WPA Form 3 – Notice of Intent**

Massachusetts Wetlands Protection Act M.G.L. c. 131, §40

Provided by MassDEP:  
 \_\_\_\_\_  
 MassDEP File Number  
 \_\_\_\_\_  
 Document Transaction Number  
 \_\_\_\_\_  
 Boxford  
 \_\_\_\_\_  
 City/Town

**E. Fees**

1.  Fee Exempt: No filing fee shall be assessed for projects of any city, town, county, or district of the Commonwealth, federally recognized Indian tribe housing authority, municipal housing authority, or the Massachusetts Bay Transportation Authority.

Applicants must submit the following information (in addition to pages 1 and 2 of the NOI Wetland Fee Transmittal Form) to confirm fee payment:

_____	_____
2. Municipal Check Number	3. Check date
1134	11/5/14
_____	_____
4. State Check Number	5. Check date
1133	11/5/14
_____	_____
6. Payor name on check: First Name	7. Payor name on check: Last Name
Derek	Reucci

**F. Signatures and Submittal Requirements**

I hereby certify under the penalties of perjury that the foregoing Notice of Intent and accompanying plans, documents, and supporting data are true and complete to the best of my knowledge. I understand that the Conservation Commission will place notification of this Notice in a local newspaper at the expense of the applicant in accordance with the wetlands regulations, 310 CMR 10.05(5)(a).

I further certify under penalties of perjury that all abutters were notified of this application, pursuant to the requirements of M.G.L. c. 131, § 40. Notice must be made by Certificate of Mailing or in writing by hand delivery or certified mail (return receipt requested) to all abutters within 100 feet of the property line of the project location.

_____	_____
1. Signature of Applicant	2. Date
<i>[Signature]</i>	11-5-14
_____	_____
3. Signature of Property Owner (if different)	4. Date
<i>[Signature]</i>	11-5-14
_____	_____
5. Signature of Representative (if any)	6. Date

**For Conservation Commission:**

Two copies of the completed Notice of Intent (Form 3), including supporting plans and documents, two copies of the NOI Wetland Fee Transmittal Form, and the city/town fee payment, to the Conservation Commission by certified mail or hand delivery.

**For MassDEP:**

One copy of the completed Notice of Intent (Form 3), including supporting plans and documents, one copy of the NOI Wetland Fee Transmittal Form, and a copy of the state fee payment to the MassDEP Regional Office (see Instructions) by certified mail or hand delivery.

**Other:**

If the applicant has checked the "yes" box in any part of Section C, Item 3, above, refer to that section and the Instructions for additional submittal requirements.

The original and copies must be sent simultaneously. Failure by the applicant to send copies in a timely manner may result in dismissal of the Notice of Intent.

LEIGH M REPUCCI  
DEREK C REPUCCI  
10 MAPLE AVE  
BOXFORD, MA 01921

Fidelity Account®

1133

80-568/1012

11-5-14

Date

Pay to the  
Order of

Town of Bedford

\$67.50

Sixty seven and 50/100

Dollars



Security  
Features  
Details on  
Back.



UMB Bank, N.A.  
Warsaw, MO

For

*Paul Flynn*

MP

⑆ 10120568 ⑆ ⑆ ⑆ ⑆ 33 ⑆ 77 ⑆ 0534926280 ⑆

Harland Clarke

LEIGH M REPUCCI  
DEREK C REPUCCI  
10 MAPLE AVE  
BOXFORD, MA 01921

Fidelity Account®

1134

80-568/1012

11-5-14

Date

Pay to the  
Order of

Commonwealth of Massachusetts

42.50

Forty two and 50/100

Dollars



Security  
Features  
Details on  
Back.



UMB Bank, N.A.  
Warsaw, MO

For

*Paul Flynn*

MP

⑆ 10120568 ⑆ ⑆ ⑆ ⑆ 34 ⑆ 77 ⑆ 0534926280 ⑆

Harland Clarke

LEIGH M REPUCCI  
DEREK C REPUCCI  
10 MAPLE AVE  
BOXFORD, MA 01921

Fidelity Account®

1132

80-568/1012

11-5-14

Date

Pay to the  
Order of

Town of Bedford

\$200.00

Two hundred and 00/100

Dollars



Security  
Features  
Details on  
Back.



UMB Bank, N.A.  
Warsaw, MO

For

*Paul Flynn*

MP

⑆ 10120568 ⑆ ⑆ ⑆ ⑆ 32 ⑆ 77 ⑆ 0534926280 ⑆

Harland Clarke

# ATTACHMENTS

Project Narrative  
#10 Maple Avenue, Boxford, MA 01921  
November 6, 2014

**Introduction:**

The Repucci family purchased the above referenced property in June of 2009. The lot was created in 1964 and the dwelling was constructed in 1981. The Repucci's family is growing and they would like to construct an addition onto their existing dwelling.

There is an extensive wetland system that flows through the property and as a result almost all of the property is within the jurisdiction of the Boxford Conservation Commission and Massachusetts Department of Environmental Protection.

According to the Boxford Wetlands Protection Regulations, Additions are required to be located at least 75 feet from the wetlands on this property. More than  $\frac{3}{4}$  of the existing dwelling is located within the 75 foot no build zone from the adjacent Bordering Vegetated Wetlands, (BVW). The section of the dwelling that could be added onto that is outside of the no build zone is already at the minimum setback distance to the property line as well as the minimum setback to the septic tank and leaching facility.

In addition, the major part of the renovation involves the construction of a new garage with great room above. Moving the garage to the other side of the house would require a new driveway to be constructed and would not work with the current layout of the structure.

With the exception of a small area of the proposed addition that is located above wetland flag A-21, the majority of the addition is proposed over existing impervious surfaces.

The Boxford Conservation Commission presumes that alterations listed in the minimum setback distance chart and closer than the stated setbacks, will result in alteration of the wetland resource area.

According to Section 375-98.B.(2), the presumption is rebuttable and may be overcome only for the conversion of lawn or other significantly altered land to a structure requiring a building permit when said structure is accessory to an existing single-family dwelling legally in existence as of May 19, 1994, or when a wetlands permit application was filed for said single-family dwelling on or before May 19, 1994, by finding by the Commission, supported by a preponderance of the credible evidence, showing that the work proposed within the buffer zone, closer than the tabulated minimum setback distances, will not result in the alteration of any wetlands resource area.

As mentioned above, most of the proposed additions are proposed over existing impervious surfaces. Much of the property is maintained up to the resource areas and with the exception of the area behind the pool, the no disturb zone does not exist. It is, and has been actively maintained over the years.

Our clients are willing to halt maintenance in some of these areas as well as enhance them with native plantings as mitigation for the encroachment into the no build zone. We would like to

discuss this with the Commission and select an area or areas that would help the buffer zone further protect all of the applicable wetland resource area values.

**Bordering Vegetated Wetlands:**

There are Bordering Vegetated Wetlands associated with the intermittent stream that flows through the property. The A-Series is located on the west side of the driveway and the B-Series is located on the east side of the driveway. Both series were delineated using pink surveyors flagging.

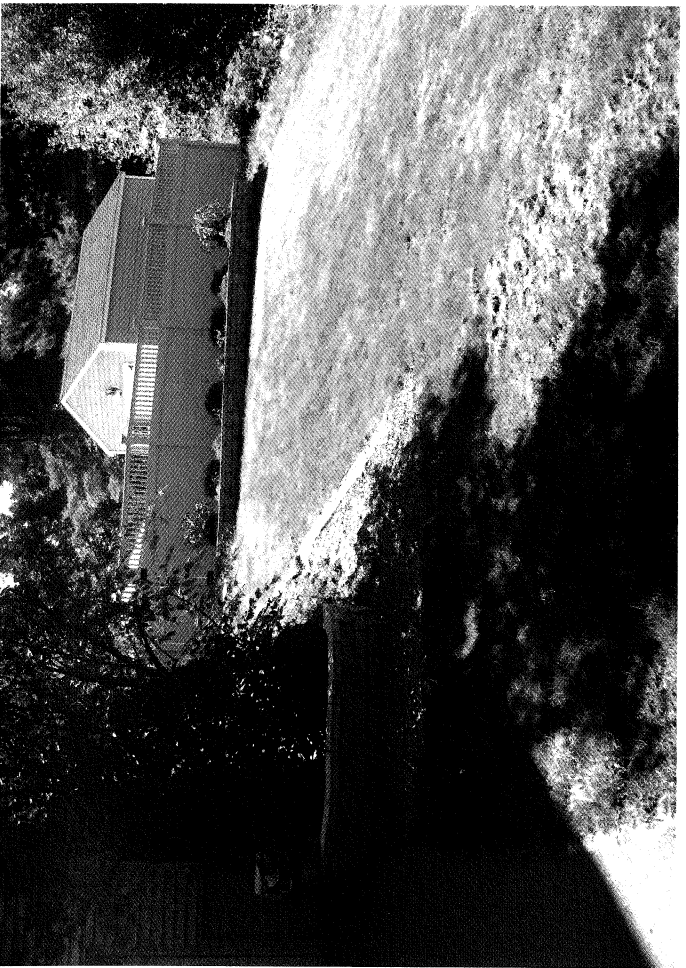

# MassDEP Bordering Vegetated Wetland (310 CMR 10.55) Delineation Field Data Form

Applicant: Derek Repucci Prepared by: Greg Hochmuth Project location: 10 Maple Avenue, Boxford, MA DEP File #: \_\_\_\_\_  
 Check all that apply:

- Vegetation alone presumed adequate to delineate BVW boundary: fill out Section I only
- Vegetation and other indicators of hydrology used to delineate BVW boundary: fill out Sections I and II
- Method other than dominance test used (attach additional information)

## Section I.

Vegetation	Observation Plot Number: A14-Upland	Transect Number: A14-Upland	Date of Delineation: 8/10/14
A. Sample Layer & Plant Species (by common/scientific name)	B. Percent Cover (or basal Area)	C. Percent Dominance	D. Dominant Plant (yes or no) E. Wetland Indicator Category*

### Trees

White Pine Pinus strobus	90%	75%	YES
Red Maple Acer rubrum	30%	25%	YES

### Shrubs

Multiflora Rose Rosa multiflora	50%	62%	YES
Poison Ivy Toxicodendron radicans	30%	37%	YES

### Ground Cover

Lawn (X)	95%	100%	YES
----------	-----	------	-----

\* Use an asterisk to mark wetland indicator plants: plant species listed in the Wetlands Protection Act (MGL c.131, s.40); plants in the genus Sphagnum; plants listed as FAC, FAC+, FACW-, FACW, FACW+, or OBL; or plants with physiological or morphological adaptations. If any plants are identified as wetland indicator plants due to physiological or morphological adaptations, describe the adaptation next to the asterisk.

### **Vegetation conclusion:**

Number of dominant wetland indicator plants: 3

Number of dominant non-wetland indicator plants: 2

Is the number of dominant wetland plants equal to or greater than the number of dominant non-wetland plants?    Yes

If vegetation alone is presumed adequate to delineate the BVW boundary, submit this form with the Request for Determination of Applicability or Notice of Intent



## Section II. Indicators of Hydrology

### Other Indicators of Hydrology: (check all that apply & describe)

- Site Inundated: \_\_\_\_\_
- Depth to free water in observation hole: \_\_\_\_\_
- Depth to soil saturation in observation hole: \_\_\_\_\_
- Water marks: \_\_\_\_\_
- Drift lines: \_\_\_\_\_
- Sediment Deposits: \_\_\_\_\_
- Drainage patterns in BWV: \_\_\_\_\_
- Oxidized rhizospheres: \_\_\_\_\_
- Water-stained leaves: \_\_\_\_\_
- Recorded Data (streams, lake, or tidal gauge; aerial photo; other):  
\_\_\_\_\_  
\_\_\_\_\_  
\_\_\_\_\_
- Other: \_\_\_\_\_

### Hydric Soil Interpretation

#### 1. Soil Survey

Is there a published soil survey for this site? yes  
 title/date: NRCS Web Soil Survey  
 map number:

soil type mapped: Ridgebury fine sandy loam  
 hydric soil inclusions: Poorly Drained

Are field observations consistent with soil survey? yes  
 Remarks:

#### 2. Soil Description

Horizon	Depth	Matrix Color
A	0-10"	10YR3/2
Bw	10-18"	7.5YR5/8

Mottles Color

Remarks:

#### 3. Other:

Conclusion: Is soil hydric? no

### Vegetation and Hydrology Conclusion

Yes No

Number of wetland indicator plants  
 ≥ # of non-wetland indicator plants

X

—

#### Wetland hydrology present:

Hydric soil present

—

X

Other indicators of hydrology present

—

X

Sample location is in a BWV

—

X

# MassDEP Bordering Vegetated Wetland (310 CMR 10.55) Delineation Field Data Form

Applicant: Derek Repucci Prepared by: Greg Hochmuth Project location: 10 Maple Avenue, Boxford, MA DEP File #: \_\_\_\_\_  
 Check all that apply:

- Vegetation alone presumed adequate to delineate BVW boundary: fill out Section I only
- Vegetation and other indicators of hydrology used to delineate BVW boundary: fill out Sections I and II
- Method other than dominance test used (attach additional information)

## Section I.

Vegetation	Observation Plot Number: A14-Wet	Transect Number: A14-Wet	Date of Delineation: 8/10/14
A. Sample Layer & Plant Species (by common/scientific name)	B. Percent Cover (or basal Area)	C. Percent Dominance	D. Dominant Plant (yes or no)
			E. Wetland Indicator Category*

### Trees

White Pine <i>Pinus strobus</i>	90%	75%	YES	FACU
Red Maple <i>Acer rubrum</i>	30%	25%	YES	FAC*

### Shrubs

Multiflora Rose <i>Rosa multiflora</i>	50%	62%	YES	FACU
Poison Ivy <i>Toxicodendron radicans</i>	30%	37%	YES	FAC*

### Ground Cover

Lawn (X)	95%	100%	YES	FAC*
----------	-----	------	-----	------

\* Use an asterisk to mark wetland indicator plants: plant species listed in the Wetlands Protection Act (MGL c.131, s.40); plants in the genus *Sphagnum*; plants listed as FAC, FAC+, FACW-, FACW, FACW+, or OBL; or plants with physiological or morphological adaptations. If any plants are identified as wetland indicator plants due to physiological or morphological adaptations, describe the adaptation next to the asterisk.

### **Vegetation conclusion:**

Number of dominant wetland indicator plants: 3

Number of dominant non-wetland indicator plants: 2

Is the number of dominant wetland plants equal to or greater than the number of dominant non-wetland plants?    Yes

If vegetation alone is presumed adequate to delineate the BVW boundary, submit this form with the Request for Determination of Applicability or Notice of Intent

## Section II. Indicators of Hydrology

**Other Indicators of Hydrology: (check all that apply & describe)**

- Site Inundated: \_\_\_\_\_
- Depth to free water in observation hole: \_\_\_\_\_
- Depth to soil saturation in observation hole: \_\_\_\_\_
- Water marks: \_\_\_\_\_
- Drift lines: \_\_\_\_\_
- Sediment Deposits: \_\_\_\_\_
- Drainage patterns in BW: \_\_\_\_\_
- Oxidized rhizospheres: \_\_\_\_\_
- Water-stained leaves: \_\_\_\_\_
- Recorded Data (streams, lake, or tidal gauge; aerial photo; other):  
\_\_\_\_\_  
\_\_\_\_\_  
\_\_\_\_\_
- Other: \_\_\_\_\_

### Hydric Soil Interpretation

#### 1. Soil Survey

Is there a published soil survey for this site? yes  
 title/date: NRCS Web Soil Survey  
 map number:

soil type mapped: Ridgebury fine sandy loam  
 hydric soil inclusions: Poorly Drained

Are field observations consistent with soil survey? yes  
 Remarks:

#### 2. Soil Description

Horizon	Depth	Matrix Color
A	0-8"	2.5Y2.5/1
Bw	8-18"	2.5Y5/2

Mottles Color  
 7.5YR5/8 15%

Remarks:

#### 3. Other:

Conclusion: Is soil hydric? Yes

### Vegetation and Hydrology Conclusion

Yes No

Number of wetland indicator plants  
 ≥ # of non-wetland indicator plants

X\_

Wetland hydrology present:

Hydric soil present

X\_

Other indicators of hydrology present

X\_

Sample location is in a BW

X\_

TOWN OF BOXFORD  
ABUTTER LIST

PARCEL # 17-02-19 ~ 10 MAPLE AVENUE ~ CONSERVATION COMMISSION 250'

Map/Lot	Location	Owner	Owner 2	Owner Address	Owner City/Town	Owner State	Zip Code
(17-2-16)	COLE DR MAPLE AVE	CANONICA P G, TRUSTEE	VATURRO MELINDA, TR	17 MAPLE AVE	BOXFORD	MA	01921
(17-2-18)	18 MAPLE AVE	CANONICA P G, TRUSTEE	VATURRO MELINDA, TR	17 MAPLE AVE	BOXFORD	MA	01921
(17-2-17)	17 MAPLE AVE	CANONICA P G, TRUSTEE	VATURRO MELINDA, TR	17 MAPLE AVE	BOXFORD	MA	01921
(17-2-20)	6 MAPLE AVE	COLE RICHARD N	MARY G COLE	6 MAPLE AVE	BOXFORD	MA	01921
(17-2-25)	363 MAIN ST	GRANT BARBARA J TR	363 MAIN ST RLT TR	363 MAIN ST	BOXFORD	MA	01921
(22-2-10.1)	361 MAIN ST	GRANT BARBARA J TR	361 MAIN STREET RT	363 MAIN ST	BOXFORD	MA	01921
(17-2-24)	356 MAIN ST	MINER JOSHUA & MARY, TRS	MINER REALTY TRUST	356 MAIN ST	BOXFORD	MA	01921
(22-2-10.2)	351 MAIN ST	PALOMBO RALPH J	PALOMBO WENDY L	351 MAIN ST	BOXFORD	MA	01921
(17-2-19)	10 MAPLE AVE	REPUCCI DEREK C	SCIUTO LEIGH M	10 MAPLE AVE	BOXFORD	MA	01921
(17-2-21)	378 MAIN ST	SHIEPE MAUREEN T		378 MAIN ST	BOXFORD	MA	01921
(17-2-22)	MAIN ST	TYSON CAROL	C/O TIM TYSON	97 SARATOGA ST	LOWELL	MA	01852

**CERTIFIED COPY**



AUGUST 13, 2014



Marquette Valley  
Fishing Commission

**Notes**

This map is for informational purposes only. It is not a legal document and should not be used for legal purposes. The information on this map is based on the most current information available to the Commission. The Commission is not responsible for any errors or omissions on this map. For legal information, please contact the Commission.

Scale: 1:24,000 1" = 200'

Map Date: 12/2011

Scale: 1:24,000 1" = 200'

**Town of Boxford  
Property Parcel Maps  
17**

Scale: 1:24,000 1" = 200'

Scale: 1:24,000 1" = 200'

Scale: 1:24,000 1" = 200'



**Legend**

Adopted Maps	Contour Interval
Water Features	State
Water Features	County
Water Features	City
Water Features	Township
Water Features	Parcel

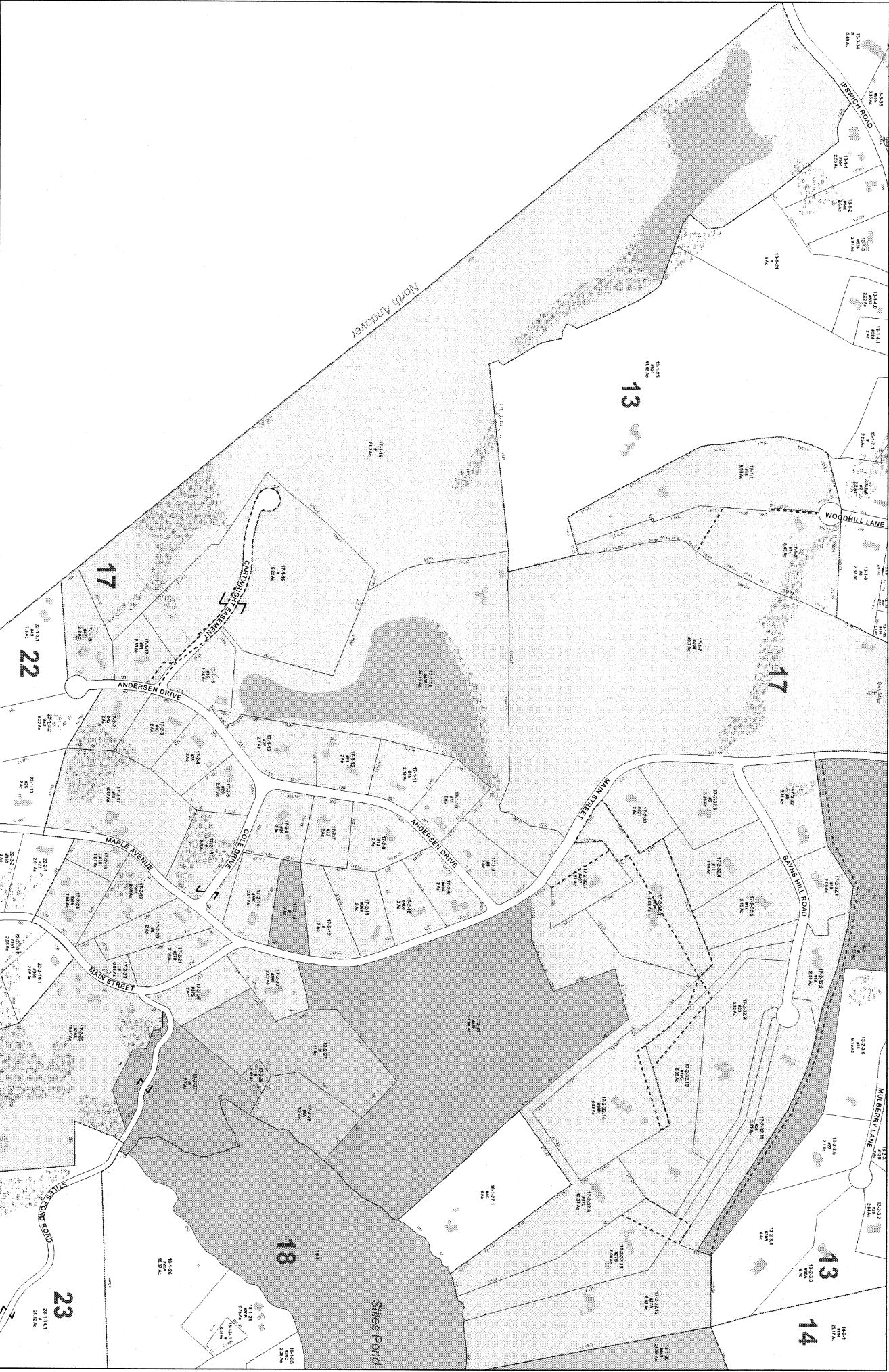
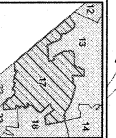

AFFIDAVIT OF SERVICE

Under the Massachusetts Wetlands Protection Act

(To be submitted to the Massachusetts Department of Environmental Protection and the Conservation Commission when filing a Notice of Intent)

I, Greg Hochmuth, hereby certify under the pains and penalties of perjury that on November 6, 2014 I gave notification to abutters in compliance with the second paragraph of Massachusetts General Law Chapter 131, Section 40, and the DEP Guide to Abutter Notification dated April 8, 1994, in connection with the following matter:

A Notice of Intent filed under Massachusetts Wetlands Protection Act by Derek & Leigh Repucci with the Boxford Conservation Commission on November 6, 2014 for property located at 10 Maple Avenue.

The form of the notification, and a list of the abutters to whom it was given and their addresses, are attached to this Affidavit of Service.

Greg Hochmuth  
Name

11/6/2014  
Date

WILLIAMS & SPARGES  
CIVIL ENGINEERING &  
LAND SURVEYORS

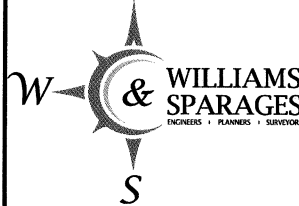

189 NORTH MAIN STREET  
SUITE 101  
MIDDLETON, MA 01949  
PHONE: (978) 539-8088  
FAX: (978) 539-8200

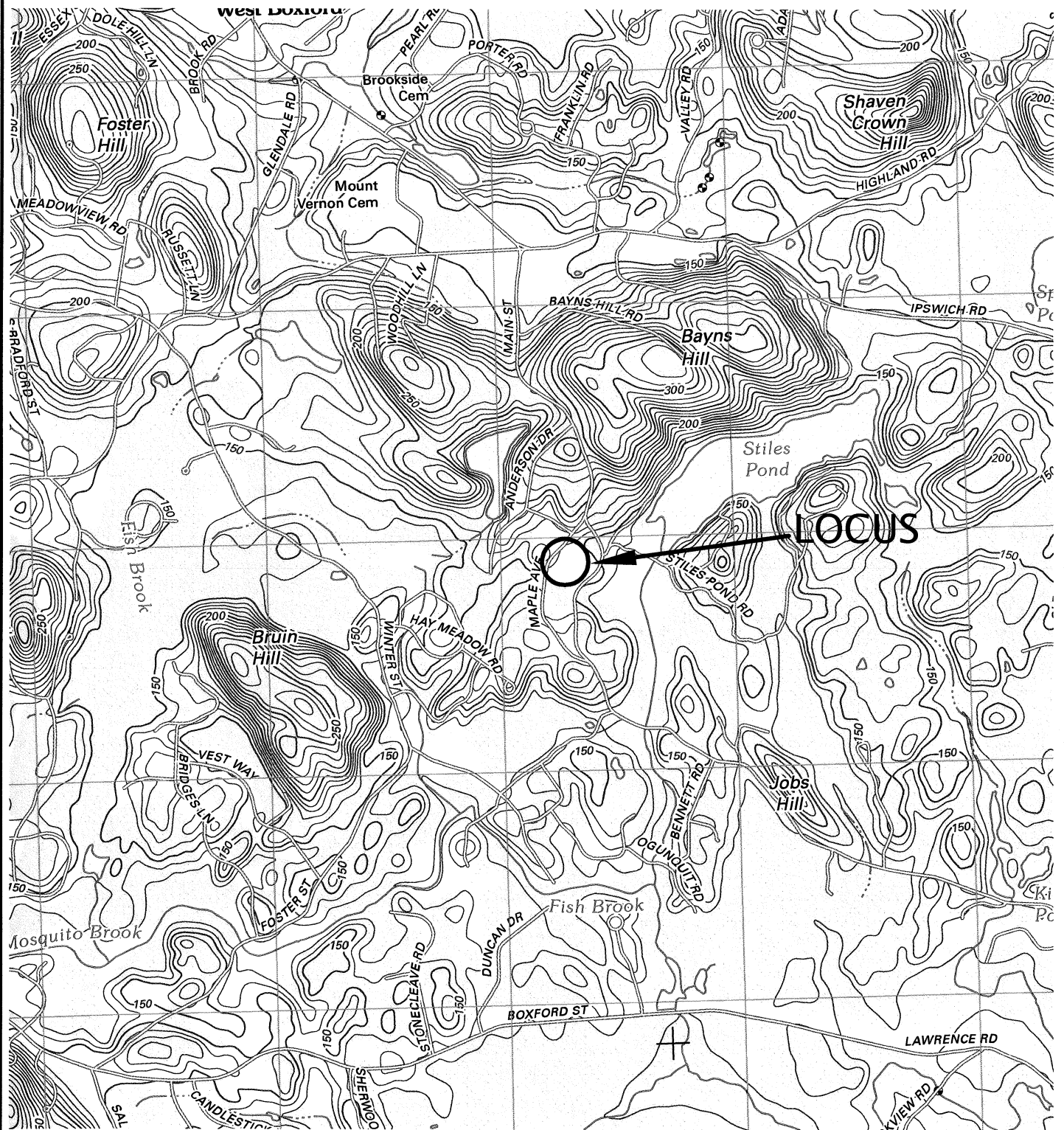

UNITED STATES GEOLOGIC SURVEY MAP  
SOUTH GROVELAND QUAD  
SCALE: 1"=2,000'

LOCUS MAP  
10 MAPLE AVENUE  
BOXFORD, MASSACHUSETTS

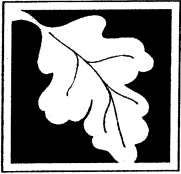

**Massachusetts Department of Environmental Protection**  
 Bureau of Resource Protection - Wetlands  
**NOI Wetland Fee Transmittal Form**  
 Massachusetts Wetlands Protection Act M.G.L. c. 131, §40

**Important:** When filling out forms on the computer, use only the tab key to move your cursor - do not use the return key.

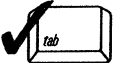

**A. Applicant Information**

1. Location of Project:

10 Maple Avenue

a. Street Address

Boxford

b. City/Town

1134

c. Check number

\$42.50

d. Fee amount

2. Applicant Mailing Address:

Dererk

a. First Name

Repucci

b. Last Name

c. Organization

10 Maple Avenue

d. Mailing Address

Boxford

e. City/Town

MA

f. State

01921

g. Zip Code

(857-241-8356

h. Phone Number

i. Fax Number

derekr\_1999@yahoo.com

j. Email Address

3. Property Owner (if different):

a. First Name

b. Last Name

c. Organization

d. Mailing Address

e. City/Town

f. State

g. Zip Code

h. Phone Number

i. Fax Number

j. Email Address

**B. Fees**

Fee should be calculated using the following process & worksheet. **Please see Instructions before filling out worksheet.**

**Step 1/Type of Activity:** Describe each type of activity that will occur in wetland resource area and buffer zone.

**Step 2/Number of Activities:** Identify the number of each type of activity.

**Step 3/Individual Activity Fee:** Identify each activity fee from the six project categories listed in the instructions.

**Step 4/Subtotal Activity Fee:** Multiply the number of activities (identified in Step 2) times the fee per category (identified in Step 3) to reach a subtotal fee amount. Note: If any of these activities are in a Riverfront Area in addition to another Resource Area or the Buffer Zone, the fee per activity should be multiplied by 1.5 and then added to the subtotal amount.

**Step 5/Total Project Fee:** Determine the total project fee by adding the subtotal amounts from Step 4.

**Step 6/Fee Payments:** To calculate the state share of the fee, divide the total fee in half and subtract \$12.50. To calculate the city/town share of the fee, divide the total fee in half and add \$12.50.

To calculate filing fees, refer to the category fee list and examples in the instructions for filling out WPA Form 3 (Notice of Intent).



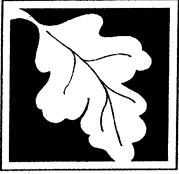

**Massachusetts Department of Environmental Protection**  
 Bureau of Resource Protection - Wetlands  
**NOI Wetland Fee Transmittal Form**  
 Massachusetts Wetlands Protection Act M.G.L. c. 131, §40

**B. Fees (continued)**

Step 1/Type of Activity	Step 2/Number of Activities	Step 3/Individual Activity Fee	Step 4/Subtotal Activity Fee
Category 1a.	1	\$110.00	\$110.00
_____	_____	_____	_____
_____	_____	_____	_____
_____	_____	_____	_____
_____	_____	_____	_____
_____	_____	_____	_____
_____	_____	_____	_____
_____	_____	_____	_____

**Step 5/Total Project Fee:** \_\_\_\_\_

**Step 6/Fee Payments:**

Total Project Fee:	\$110.00
State share of filing Fee:	\$42.50
City/Town share of filling Fee:	\$67.50
	a. Total Fee from Step 5
	b. 1/2 Total Fee less \$12.50
	c. 1/2 Total Fee plus \$12.50

**C. Submittal Requirements**

- a.) Complete pages 1 and 2 and send with a check or money order for the state share of the fee, payable to the Commonwealth of Massachusetts.

Department of Environmental Protection  
 Box 4062  
 Boston, MA 02211

- b.) **To the Conservation Commission:** Send the Notice of Intent or Abbreviated Notice of Intent; a copy of this form; and the city/town fee payment.

**To MassDEP Regional Office (see Instructions):** Send a copy of the Notice of Intent or Abbreviated Notice of Intent; a copy of this form; and a copy of the state fee payment. (E-filers of Notices of Intent may submit these electronically.)